

FOR EXPLANATION OF DIMENSIONING ETC., SEE
D.D. NOTE SHEET NO. 3 (LATEST ISSUE)

PARTICULARS OF PEGS

LENGTH IN INCHES	MATERIAL	FINISH
457.2	STEEL BS 970 PL 1985 OR IS 1570 SCH. 40 TUBULE C15 Min. 75	PAINTED WHITE.
228.6	"	PAINTED WHITE

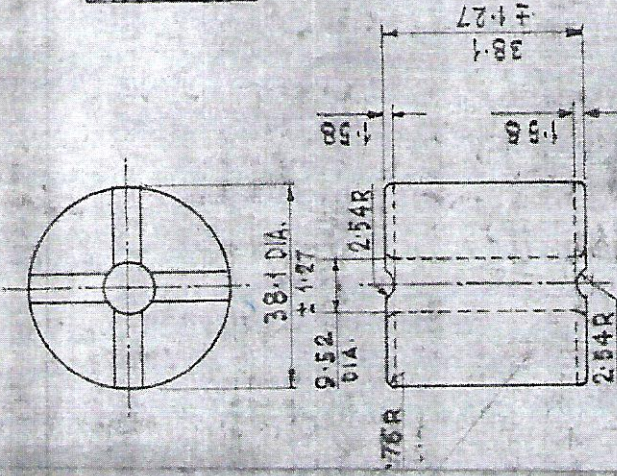

COLLAR

NOTE:-

FOR PAINT WHITE SEE INDISL 3256
FOR PAINT BLACK SEE INDISL 3247

ALL SHARP EDGES TO BE REMOVED.

MATERIAL:-

ALUMINIUM BS 1476 ETC.

FINISH:-

GROOVES AT ENDS PAINTED BLACK &
THE REMAINDER PAINTED WHITE.

MATERIAL:-

ALUMINIUM BS 1474-1987 DESIGNATION
1200 TEMPER °F.

METRIC

SEE THE COPY OF THE FROM
THE D.D. NO. 1000/1000/
REVISIONS
DATE: 25/9/24

NO.	DATE	NAME	ASSY. DRG. NO.	CQA(SA) (CHAPUR)
AD 215782A	01-11-99	E/1/2		
20852 SA	17/6/97			
20880 SA	13/10/90	E/1/2		
20878 SA	19/7/90			

DATE	ZONE	DATE	ZONE	SIG.
11/12/74				
11/12/74				

PEGS, NIGHT LINE
M.G. Mk. I



APPROVED: D/G: 9/12/74
(CL. NEG. RE-TRACED)
DESIGNER'S REF.
D-D (E) 1402
D.S. CAT. NO.
1005-000755

6.35 SQUARE
1.58 SQUARE

LENGTH 'A'

38.1

2.54R

9.52 DIA.

38.1 DIA.

1.27

2.54R

38.1

9.52 DIA.

2.54R

38.1

9.52 DIA.

2.54R

38.1