

DRAWING INDIANISED BASED ON RUSSIAN ORIGINAL ISSUE - 3

DRAWING NUMBER
315-637-9

10 ✓ (✓)

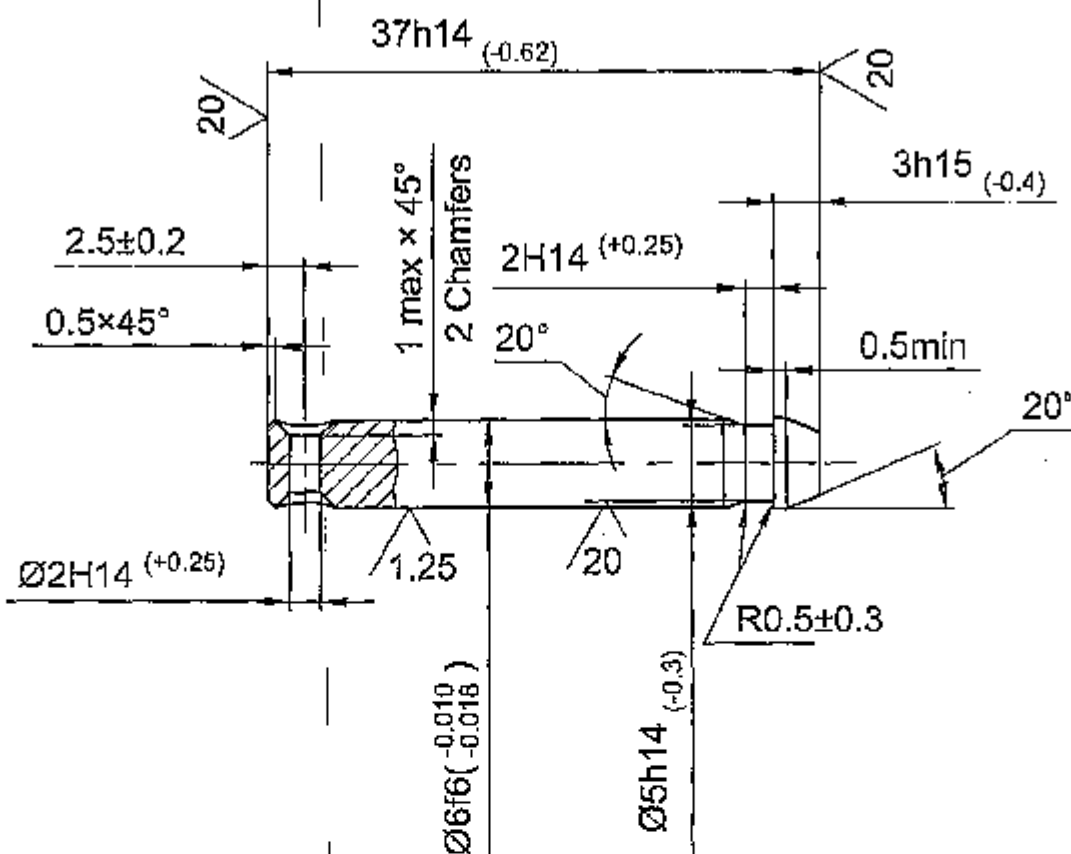

1. Inspection group is IV as per T T - 11.
2. 26...32 HRC_σ.
3. Chemically oxidised, oiled coating is carried out.

F5
72
283

PILOT SAMPLE SHOULD BE APPROVED BY A H S P BEFORE BULK PRODUCTION.

		EST. WT. (Kg) 0.008	TO BE STAMPED OR MARKED WHERE INDICATED THIS # (LETTERS)
		ALL SHARP EDGES AND CORNERS TO BE REMOVED UNLESS OTHERWISE STATED MACHINED CORNERS TO HAVE R OUTSIDE R INSIDE EQUIVALENT CHAMFERS ARE PERMISSIBLE.	
		MATERIAL :- Steel 45 GOST 1050-88.	USED ON :- CB 315 - 800 - 1
ISSUE	DATE	NATURE OF AMENDMENTS	CONTROLLERATE OF QUALITY ASSURANCE (HEAVY VEHICLES) AVADI
DRN <i>A. Ashu</i>		SCALE :- 2:1 DIMENSIONS IN mm	
APPD <i>[Signature]</i>		TOLERANCE ON DIMENSIONS UNLESS OTHERWISE STATED IS : 2102 - 69	TITLE :- LEVER PIN
DATE 21/3/07		ALL THREADS TO CONFORM TO	D S CAT NUMBER
SIZE A4			DRAWING NUMBER 315-637-9

DRAWING NUMBER
315-798

10
✓(✓)

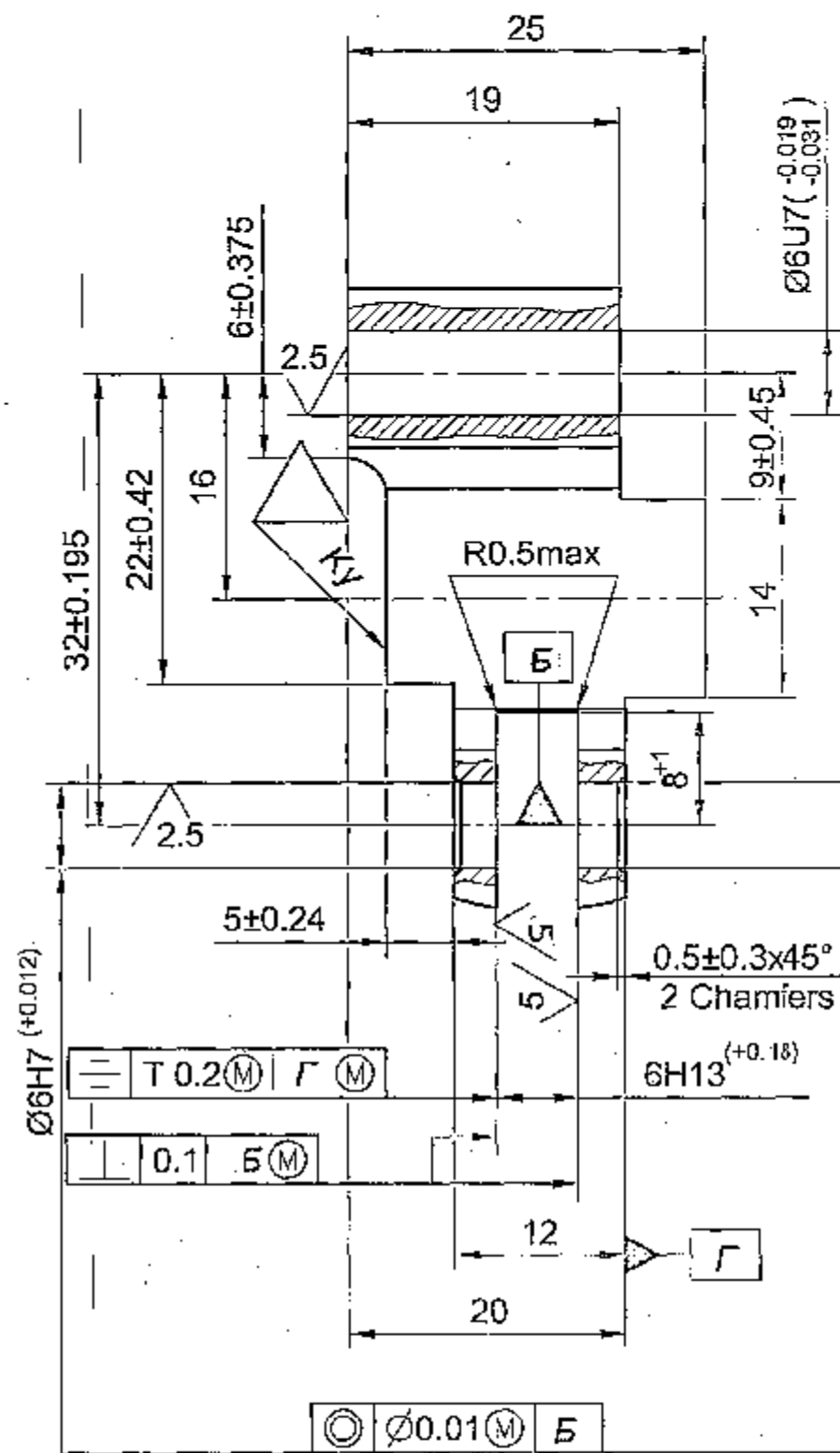
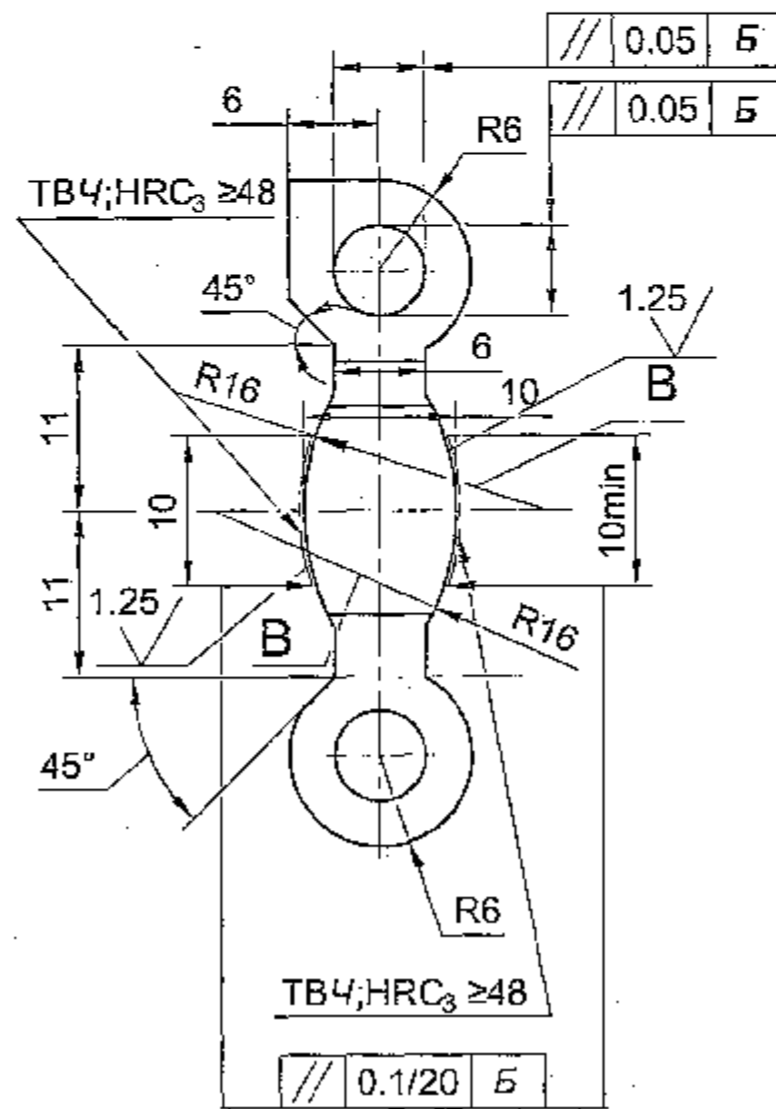

1. Blank: Steel forging to be carried out as per Gost 7505-89.
2. Unspecified forging radii are 2...3mm.
3. Spot depressions of not more than 0.5mm are allowed on unmachined surfaces.
4. Unspecified limit deviations of dimensions are: $h14$; $\frac{IT14}{2}$.
5. Circular marks, exceeding the roughness limits $\sqrt{2.5}$ are allowed on internal surfaces of holes.
6. Coating is Chemically oxidised oiled, as per instruction: ИП-681-87.
7. Allowed to make the part by machining without tapers.
8. Shift of centres of radii B from the symmetry axis of part should not be more than 0.3mm.
9. Previous machining marks are allowed, on surfaces of radii B.

(1:1) ALTERNATE

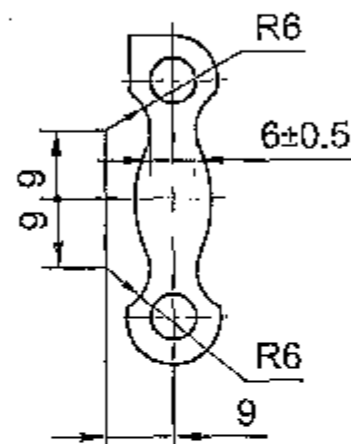

PILOT SAMPLE SHOULD BE APPROVED BY A H S P BEFORE BULK PRODUCTION.

EST. WT. (kg) 0.042 TO BE STAMPED OR MARKED WHERE INDICATED THUS # (LETTERS)

ALL SHARP EDGES AND CORNERS TO BE REMOVED UNLESS OTHERWISE STATED MACHINED CORNERS TO HAVE R OUT-SIDE R INSIDE EQUIVALENT CHAMFERS ARE PERMISSIBLE.

DRN	APPD	DATE	SCALE	DIMENSIONS IN mm	TOLERANCE ON DIMNS UNLESS OTHERWISE STATED IS : 2102-69	ALL THREADS TO CONFORM TO	ISSUE	DATE	NATURE OF AMENDMENTS
		20/3/07	2:1						
MATERIAL :- STEEL 45X GOST 4543-71			USED ON :- Cb 315-800-1			CONTROLLERATE OF QUALITY ASSURANCE (HEAVY VEHICLES) AVADI			
TITLE :-			CORRECTOR LEVER						
D S CAT NUMBER			DRAWING NUMBER 315-798						

DRAWING INDIANISED BASED ON RUSSIAN ORIGINAL ISSUE - 6

F-5
87
283
SIZE A2

