

COMMON TO T-72
 DRG. CANCELLED - ВВЕД. N OF A No. CGA(HV) T-90/36/002
 DRG. INDANISED BASED ON RUSSIAN ORIGINAL ISSUE - 7
 DRG. REINSTATED ВВЕД. N OF A No. CGA(HV) T-90/36/002

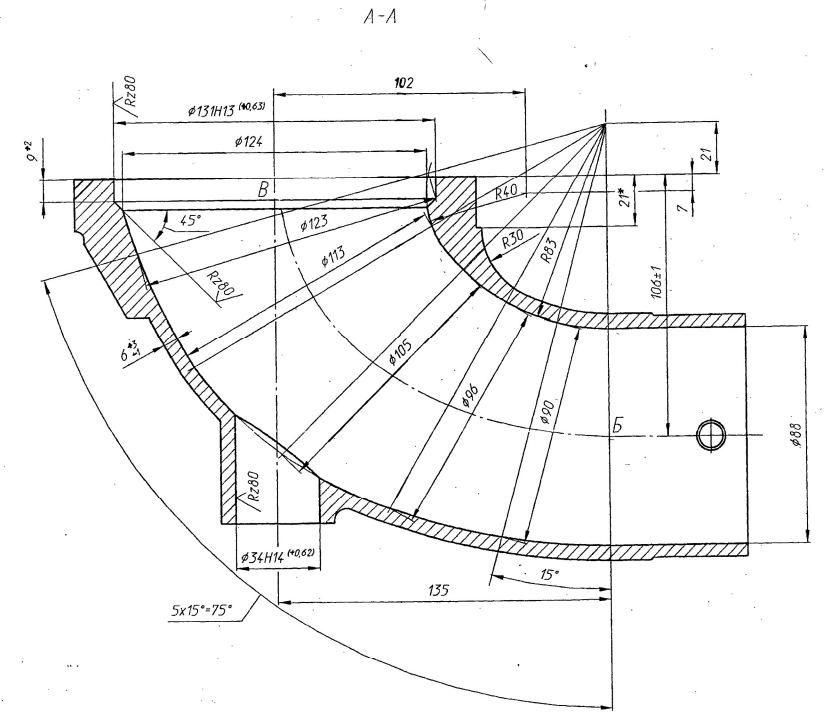
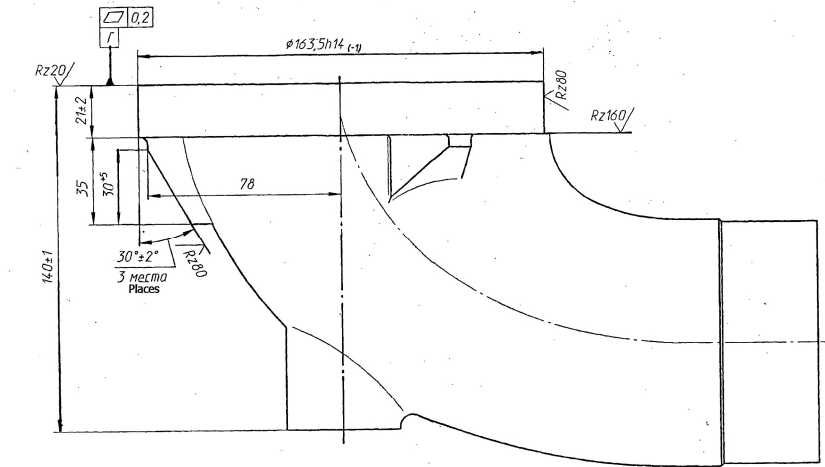
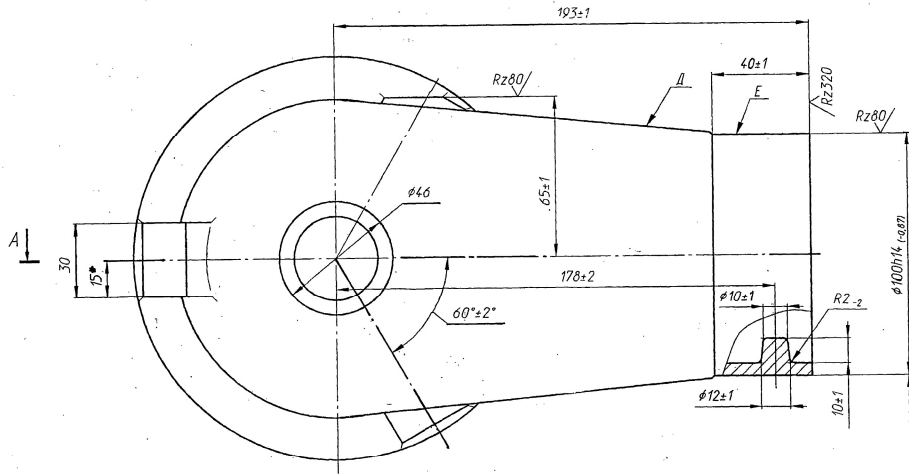

1. Casting of 1st group GOST 977-88.
2. Accuracy of casting 10-0-16-8 GOST 26645-85.
3. Requirements for casting should be as per specifications 172.TY4.
4. Draft 1°.
5. Un-specified casting radii to be 3rd mm.
6. Smooth passage on section B-B is to be provided.
7. Sinking in or projection of surface E relative to surface A is allowed.
8. Rectification of casting defects with depth not exceeding 1/3 of wall thickness in total area 50th cm² is allowed.
9. *Dimensions for reference.
10. To be tested for air tightness with water or air at a pressure 0.2nd MPa (2nd Kgf/cm²) for 3rd minutes. Leakage of air or water is not allowed.
11. Other requirements should be as per specifications 520.TY1.

1. Отливка 1-й группы ГОСТ 977-88.
2. Точность отливки 10-0-16-8 ГОСТ 26645-85
3. Требования к отливке по 172.ТУ4.
4. Литейные уклоны 1°.
5. Неуказанные литейные радиусы 3rd мм.
6. Обеспечить плавный переход на участке Б-В.
7. Допускается западание или выступание поверхности Е относительно поверхности А.
8. Допускаются с исправлением литейные дефекты глубиной не более трети толщины стенки суммарной площадью 50th см².
9. * Размер для справки.
10. Испытать на герметичность водой или воздухом давлением 0,2nd МПа (2nd кгс/см²) в течение 3rd мин. Течь воды или просачивание воздуха не допускается.
11. Остальные требования по 520 ТУ1.

356
SUPPLY CODE U-01-1-2
D00058
F-59
55
SIZE A1

PILOT SAMPLE SHOULD BE APPROVED BY A H S P BEFORE BULK PRODUCTION.

EST. WT. (kg)	TO BE STAMPED OR MARKED WHERE INDICATED THIS # (LETTERS)
5	
ALL SHARP EDGES AND CORNERS TO BE REMOVED UNLESS OTHERWISE STATED MACHINED CORNERS TO HAVE R OUT-SIDE R INSIDE EQUIVALENT CHAMFERS ARE PERMISSIBLE.	

DRN	CHD	APFD	DATE	SCALE	DIMENSIONS	TOLERANCE	ALL THREADS	D S CAT NUMBER	DRAWING NUMBER	
			26-10-06	1:1	IN MM	ON DIMS UNLESS OTHERWISE STATED IS: 2102-69	TO CONFORM TO		175.01.072-2A	
MATERIAL: Steel 3206# GOST 977-88				USED ON: 175.01.045cb-2Acb				CONTROLLERATE OF QUALITY ASSURANCE (HEAVY VEHICLES) AVADI		
TITLE: BRANCH PIPE										
7A		1B-1-10		N OF A No. CGA(HV) T-90/36/002		ISSUE DATE		NATURE OF AMENDMENTS		