

**OFB**

THIS DRAWING/DOCUMENT CONTAINS COMPANY PROPRIETARY INFORMATION. USE OR DISCLOSURE IN WHOLE OR IN PART SHALL NOT BE MADE WITHOUT THE WRITTEN PERMISSION OF OFB

DATE: 01.01.2007

ALTERNATE/INDIGENOUS MATERIAL SPCN: BS: 970 Pt-I-83 GDE 708 A25 The material shall be satisfy following mechanical properties Re=700 Mpa (min), Rm=900/1100Mpa, A=12% (min), KCV=45J, R of A=50%min. A separate test bar shall be heat treated to achieve the hardness 25-35 HRC. (REF: CQA(W) JABALPUR LNo. 3B2402/CQAW/011 Dt. 12 JULY 2005)

78  
JVM/CDD

**NOTE:**

1. Angular location between hexagons is not importante

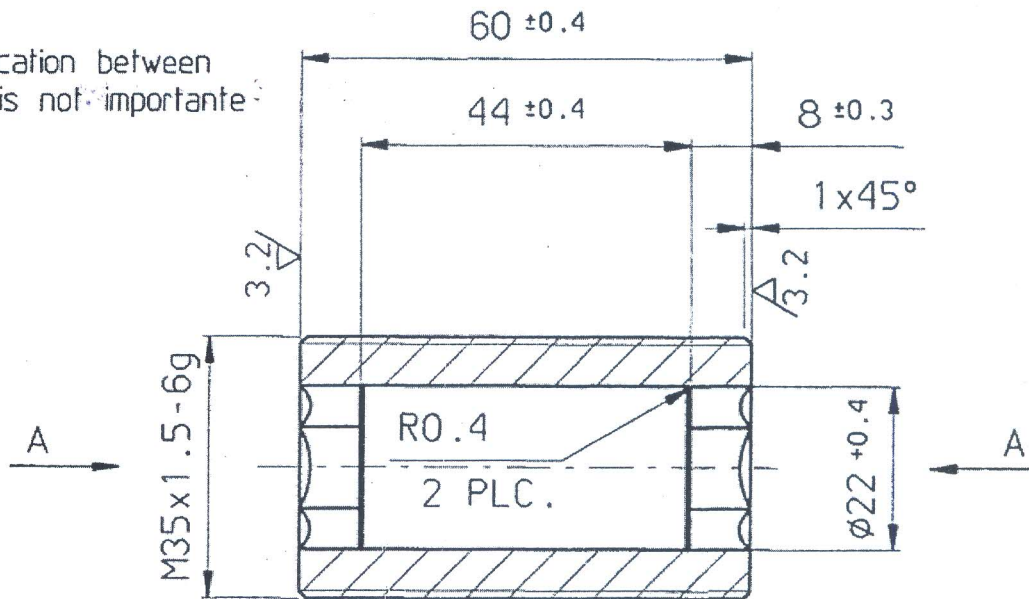

केवल निविदा हेतु  
सन्दर्भ मांग पत्र सं० 380159  
दिनांक 24-04-2018

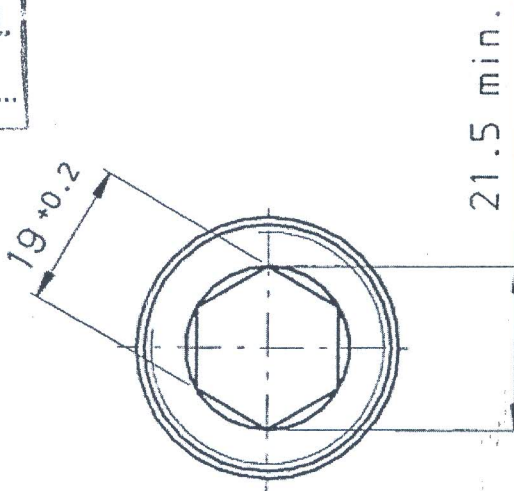

**VIEW A**

6.3 ( 3.2 )

D. No. 2086  
Location. 01/06/01

DRAWING SEALED  
CQA(W)  
JABALPUR  
Dt. 6-6-2005

**MACHINING INSTRUCTIONS**

UNSPECIFIED TOLERANCES FOR DIMENSIONS AND ANGLES DIMENSIONS

ANGLES

HEAT TREATMENT  
240-275 HB

FINISH PHOSPHATE COATING ACCORDING TO DDD-P-16232 TYPE M CL. 2

MATERIAL  
L=70  
Round 40 DIN668-25CrMo4

SHARANG 130/155MM\_UG\_OFB\_SLB  
PART NO. Sh: 1 of: 1

ASSEMBLY 176-8001  
SCALE 1:1 SIZE A4

NAME ADJUSTING BUSHING

PREP'D	JVM
CHKD	JVM
JVM/DO	JVM
APPROVED	
DO/DO	DIR/ODC
ORDNANCE DEVELOPMENT CENTRE, OFC, KANPUR	
PART NO.	161-702