

62 OF 28 SHEET DRAWING CONVENTIONS CONFORM TO IS: 696

ADRDE/1159-A2/SA6 GEN. TOL: AS SPECIFIED IN DRAWING

DRG. NO

MATERIAL :- STEEL TO SPECN. IS: 1570-40 NI-2, CY-1 MO 23

BS: 970, EN- 24.

HARDNESS :- 390 ± 20 H.V. (38-42 R.H.C)

WORKMANSHIP :-

- (i) ALL SHARP EDGES AND BURRS ARE TO BE REMOVED.
- (ii) DIMENSIONS ARE TO BE READ AS APPLYING AFTER COATING.
- (iii) SMOOTH SURFACE FINISH
- (iv) TO BE MACHINED FROM FORGED BAR

PROTECTIVE FINISH :- CADMIUM PLATED TO SPECN. IS: 1572, GD-B (cd 8P OR cd 8cy)

TOLERANCES :- AS SPECIFIED IN DRAWINGS

PACKING :- EACH PULLEY SHALL BE WRAPPED IN TISSU PAPER AND 10 NOS. THUS WRAPPED BE PACKED IN A SUITABLE CARTON. 10 SUCH CARTONS SHALL BE PACKED IN A C.W.P. (DULY LINED WITH PAPER PACKING WATERPROOF) EACH CARTON SHALL BE MARKED WITH THE INITIALS OF THE MANUFACTURER. BEFORE DESPATCH EACH PACKING CASE SHALL BE LEGIBLY AND INDELIBLY MARKED WITH THE FOLLOWING DETAILS :-

- (i) NOMENCLATURE, CAT. NO OF THE STORE AND THE YEAR OF MANUFACTURE
- (ii) TOTAL NOS OF PACKING CASES AND THE NO OF THE INDIVIDUAL PACKING CASE IN A CONSIGNMENT
- (iii) TOTAL QUANTITY IN EACH PACKING CASE THE TOTAL C. ANTI IN EACH PACKING CASE
- (iv) MASS OF THE PACKING CASE IN Kg
- (v) ADDRESS OF THE CONSIGNEE.
- (vi) ADDRESS OF THE CONSIGNOR.

NOMENCLATURE OR PLACE FOR MARKING MANUFACTURE INITIAL

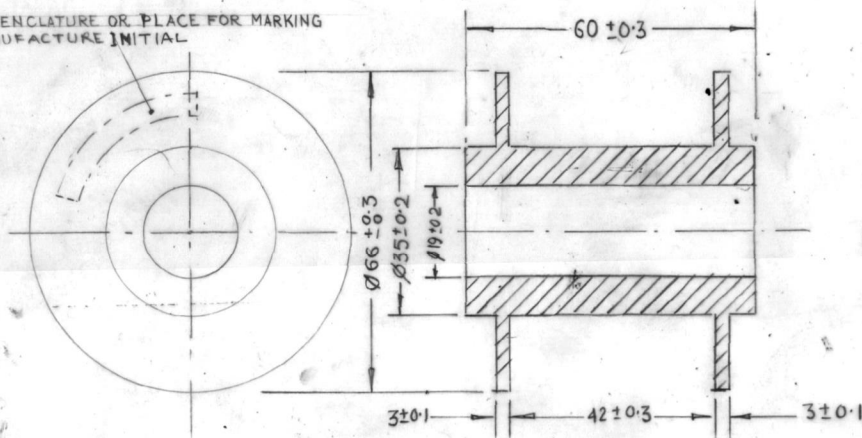

PULLEY
1-OFF

DRN <i>gma</i>	CHD <i>gma</i>	O/C DRG <i>gma</i>	PRO OFF <i>gma</i>
TRD	COMP	PASSED	
SCALE: - 1:1		APPROVED <i>gma</i> DH	
DIMENSIONS ARE IN mm		DIRECTOR	
DESIGN AUTHORITY			
ADRDE AGRA			
DRG NO			
ADRDE/1159-A2/SA 6(a)			
SHEET 28 OF 29			

RNo	DATE	AUTHORITY	BRIEF RECORD	ZONE	CD	O/C DRG

PARACHUTE SYSTEM FOR TAIL UNIT No TR-250

MA (MAIN PARACHUTE)