

DRG. No.:

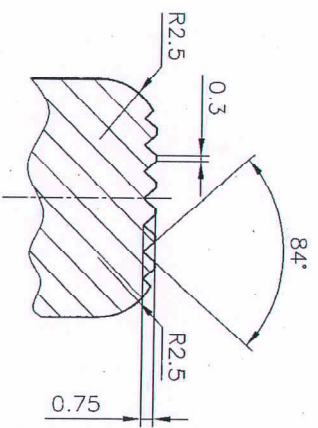
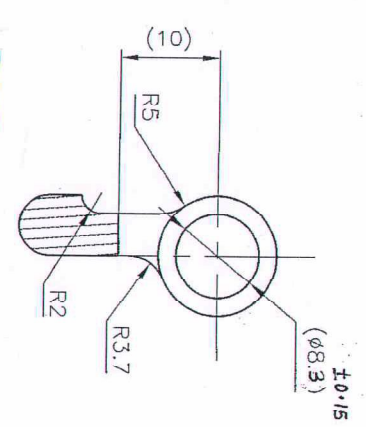
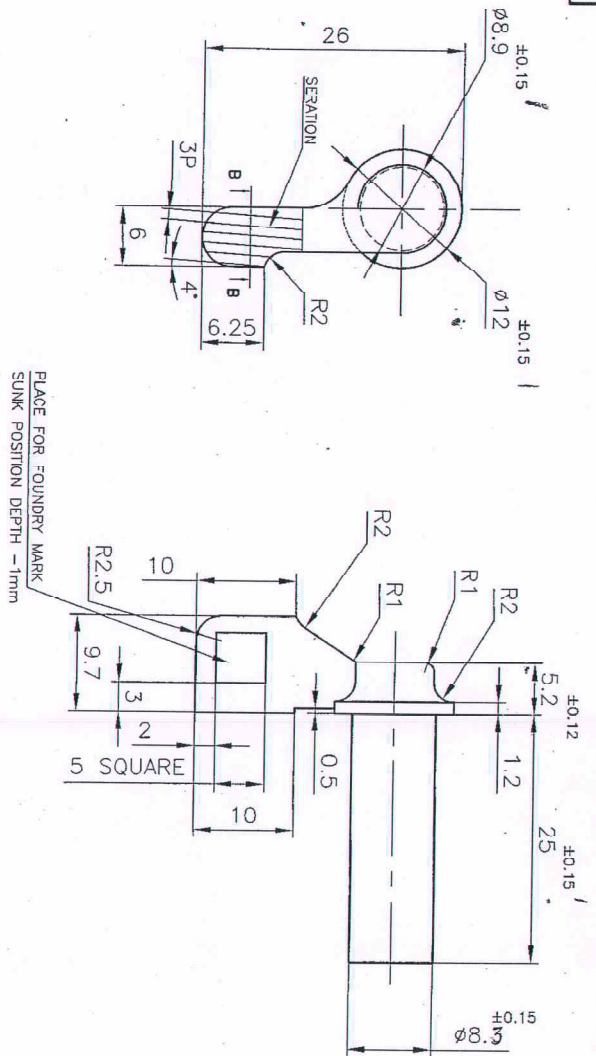

ENLARGED VIEW OF SECTION B-B

MATERIAL:---

BS:3146 PART-1, 1974

TYPE - CLASS 5, GRADE 'A'
(NON STRESSED COMPONENT)

RADIOGRAPHIC TEST AS PER ASTM-E-192

ACCEPTANCE STANDARD:

GAS HOLE & FOREIGN MATERIAL LEVEL - 5

SHRINKAGE (ALL TYPES) - LEVEL - 3

UNTOLERATED DIMS. ARE AS PER IS:11166-1984, CLASS-1

OF INVESTMENT CASTING. CASTING TO BE SUPPLIED IN

NORMALISED CONDITION.

CASTING SHOULD BE FREE FROM DEFECTS LIKE CRACKS.

SURFACE FINISH MUST BE SMOOTH.

DIMENSIONS ARE IN mm
DRAFT ANGLE FOR HOLES 1°
CASTING RADII R1mm

PART NO.	DESCRIPTIONS	NO OFF	MATERIAL	TREATMENT	REMARKS
DA No. 09/21	TRACED				
DA No. 019/17	DRAWN				
DA No. 09/2017	CHECKED				
DA No. 010/17	HOS/D&DO				
DA No. 119/3	MDL OFFICER				
DA No. 117/13	OFFICER/D&DO				
DA No. 09/2013	APPROVED ON. 02/2014				
SUB: INVESTMENT CASTING		NO. OFF: 40mm MGL		SCALE: 2:1	
FOR: CHANGE LEVER L.H.		DES. REF. NO.:		STORE DRG. NO. 30P 3036	
OF: 40mm MGL		DRG. TEND - 2257 *5		OPERATION NO.:	
ORDNANCE FACTORY TIRUCHIRAPPALLI-16.		SHEETS: 1		SHEET No.: 1	

UN CONTROLLED COPY
CERTIFIED CORRECT COPY OF APPROVED
DRAWINGS AT THIS DATE
DESIGN & DRAWING OFFICE

