

NO. QS/ISO-9000/DO/01 REV. NO. 00-DT. 09-06-2001	D.A. NO.	DATE	NATURE	SING
	56/08	10-09-2008	MATERIAL:- BS 970 Pt.1:1983 GD 700 M40(BS 970 EN 19A) & ALT. MATERIAL FROM IC ROUTE :- B.S. 3146 Pt. 1: 1974 TYPE CLA 12 Gd.'A':- ADDED	<i>Singh</i> 10-9-08

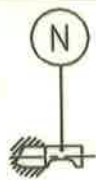

ACTUAL SIZE

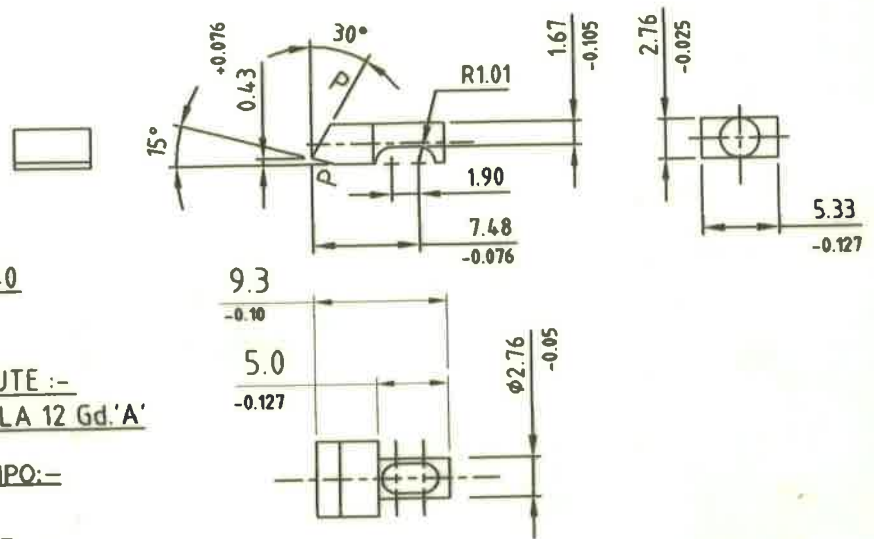

MATERIAL:-
BS 970 Pt.1:1983 GD 780 M40
(BS 970 EN 19A)

ALT. MATERIAL FROM IC ROUTE :-
B.S. 3146 Pt. 1: 1974 TYPE CLA 12 Gd.'A'

ALT.MATERIAL FOR MIM COMPO:-
MIM 46.30(MODIFIED)

C 0.2-0.5% Fe-BALANCE
Ni 6-8% DENSITY 7.5 g/cm Min.
MO 0.5% MAX
OTHERS 1% MAX

HARDNESS:~

LETTER	VHN
N	400-500

COMPONENT MUST CONFORM TO THE FOLLOWING HARDNESS NUMERALS AT THE POSITION INDICATED.

SURFACE MARKED 'P' TO BE POLISHED.

SURFACE INDICATED THUS "////" TO BE FINISH SMOOTH. ▽▽▽▽

NOTE:~
ALL SHARP EDGES TO BE REMOVED
THE COMPONENT SHALL BE SAND BLASTED,
CLEANED AND OILED AFTER HEAT TREATMENT

DIMENSIONS ARE IN mm.



REVOLVER 32 (7.65mm) MK-III

CATCH TRIGGER

DRAWN	TRACED	CHKD.
<i>Amal</i>		<i>Amal</i>
DATE	01-02-2008	
APPROVED	<i>Singh</i> 17-2-08 JWM/DO	
DRG.NO.	PHMK-III-7-2 ALT	
SHEET	1	OF 1

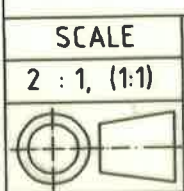

SMALL ARMS FACTORY
KANPUR