

THIS DOCUMENT AND THE INFORMATION CONTAINED IN IT ARE PROPRIETARY AND CONFIDENTIAL TO OFT. NO PERSON IS ALLOWED TO COPY, REPRINT, REPRODUCE OR PUBLISH ANY PART OF THIS DOCUMENT NOR DISCLOSE ITS CONTENTS TO OTHERS, NOR MAKE ANY USE OF IT, NOR ALLOW OR ASSIST OTHERS TO MAKE ANY USE OF IT, UNLESS BY THE PRIOR WRITTEN EXPRESS AUTHORIZATION OF OFT AND THEN ONLY TO THE EXTENT AUTHORIZED.

Tolerance class	Designation	Description	Permissible deviations for basic size range							
			0.5 UP TO 3	over 3 UP TO 6	over 6 UP TO 30	over 30 UP TO 120	over 120 UP TO 400	over 400 UP TO 1000	over 1000 UP TO 2000	over 2000 UP TO 4000
f	fine		±0.05	±0.05	±0.1	±0.15	±0.2	±0.3	±0.5	-
m	medium		±0.1	±0.1	±0.2	±0.3	±0.5	±0.8	±1.2	±2
c	coarse		±0.2	±0.3	±0.5	±0.8	±1.2	±2	±3	±4
v	very coarse		-	±0.5	±1	±1.5	±2.5	±4	±6	±8

For nominal sizes below 0.5 mm, the deviations shall be indicated adjacent to the relevant size(s)

NOTES :

- INTERPRET THIS DRAWING IAW ASME Y14.100M.
- MATERIAL: STEEL ALLOY BAR SAE 4130 PER SAE-AMS-S-6758 OR SAE 4340 PER SAE-AMS-S-5000. (EQUIVALENT MATERIAL IS PERMITTED AFTER ELBIT APPROVAL).
- HEAT TREATMENT: QUENCH AND TEMPER ENTIRE PART; HARDNESS 35 ± 4 HRC PER AMS 2759/1.
- DEBURR AND REMOVE SHARP EDGES APPROX. 0.3X45°.
- GENERAL TOLERANCES ACCORDING TO ISO 2768-m.
- PHOSPHATE COATING TYPE M, CLASS 2, 0.005-0.010 MM THICK PER MIL-DTL-16232.
- THE DIMENSIONS ARE BEFORE COATING.
- QUALITY ASSURANCE PROVISIONS: 8.1 QUALITY ASSURANCE PROVISIONS FOR THIS ITEM PER RDMQD00012P.
- PACKAGING AND PACKING: THE FINISHED PART SHALL BE PRESERVED AND PACKAGED IN ACCORDANCE WITH COMMERCIAL PRACTICE.
- IDENTIFY PER MIL-STD-130 PARA 4.1.B, BY LABELING ITS CONTAINER WITH THE PART NUMBER. CHARACTERS MINIMUM TEXT HEIGHT 1.25 MM.

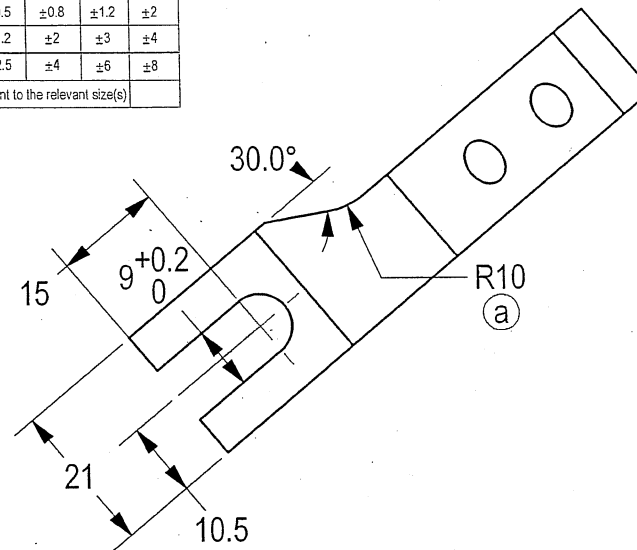

VIEW A-A

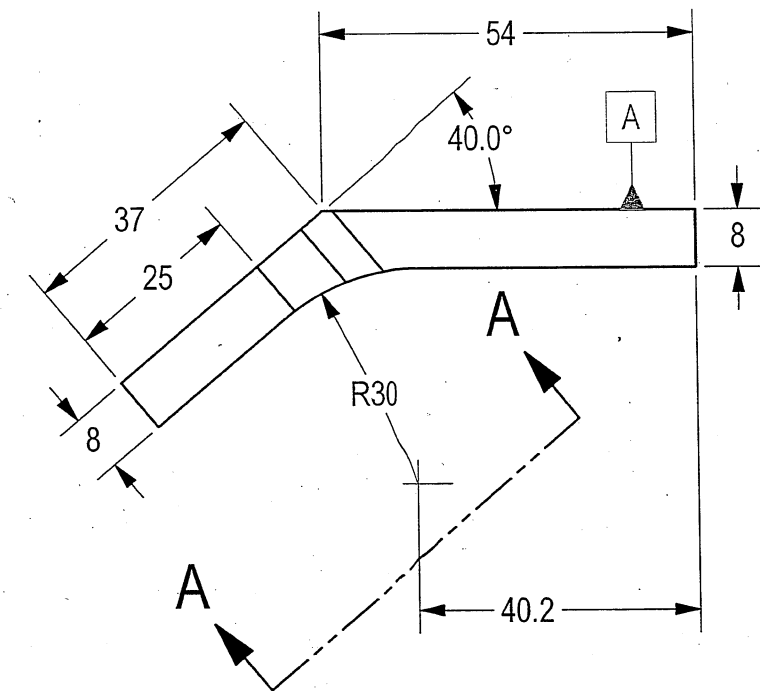
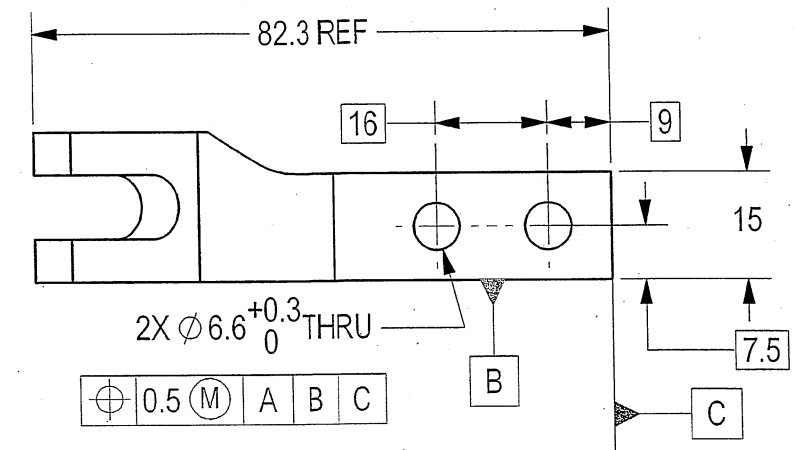

SEE ATTACHED MEDIA

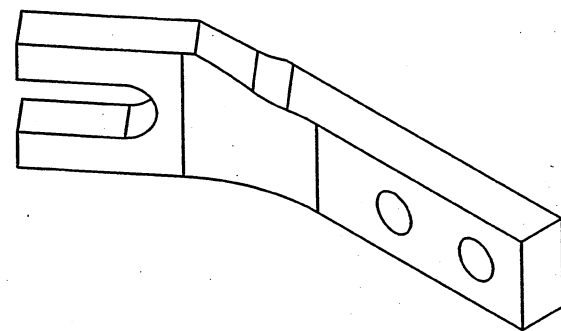

(WEIGHT APPROX.: 0.082 Kg.)

[Signature]
PROJECT OFFICER

UN CONTROLLED COPY
CERTIFIED CORRECT COPY OF APPROVED
DRAWINGS AT THIS DATE... 27/09/2022
DESIGN & DRAWING OFFICE,
ORDNANCE FACTORY, TIRUCHIRAPPALLI - 620 016.

(a)D.A.No.02/22	<i>[Signature]</i>	26/09/2022
AMENDMENTS	SIGNATURE	DATE

Material:	3.2/	DWG Details		SUB: BELLEVILLE, LEVER TRAVERSE	
Alt. Material:	DRAWN	SIGN	DATE	FOR: TRAVERSE ASSY	Do not scale Drawing
Hardness:	CHECKED	<i>[Signature]</i>	26/09/22	PROJ.: SRCG	
Finish:	HOS/D&DO	Div. Officer Prodn		Design Ref	All Dimensions are in mm
Un tolerated dimensions IS:2102 Medium	Div. Officer QC	Div. Officer DDO		DWG. No.: - 062346A-00	A3 QPG -
				ORDNANCE FACTORY TIRUCHIRAPPALLI-16.	Wt. (Appx) gm
					SHEET: 1 OF 1