

11

149

CAT/PART NO.	NOMENCLATURE	QTY. OF PARTS	DRAWING NO.
	MOUNTING BRACKET ASSEMBLY	1	142 1 01 03 04 05 000
	MOUNTING BRACKET	1	142 1 01 03 04 05 M01
	POST 2 FOR RC CARD	4	142 1 01 03 04 05 M02
	COVER LOGIC CARD	1	142 1 01 03 04 05 M03
	CMOS MOUNT	1	142 1 01 03 04 05 M04
	TEFLON WASHER 2MM	20	142 1 01 03 04 05 M05
	TEFLON WASHER 4MM	20	142 1 01 03 04 05 M06
	TEFLON WASHER 6MM	20	142 1 01 03 04 05 M07
	C CLAMP FOR L3 CCD	1	142 1 01 03 04 05 M08
TRADE ITEMS			
	HEX. SOCKET HD CAP SCREW M2.5x25 IS:2269 'A2' S.S.	4	
	HEX. SOCKET HD CAP SCREW M2.5x12 IS:2269 'A2' S.S.	4	
	HEX. SOCKET HD CAP SCREW M2.5x8 IS:2269 'A2' S.S.	12	
	HEX. SOCKET HD CAP SCREW M5.0x12 IS:2269 'A2' S.S.	6	
	GUIDE PIN Ø8.0 X 10 IS:6689 'A2' S.S.	1	
	GUIDE PIN Ø5.0 X 10 IS:6689 'A2' S.S.	1	
	FLAT WASHER M2.5 IS:2016 'A2' S.S.	22	
	SPRING WASHER M2.5 IS:3063 'A2' S.S.	22	
	FLAT WASHER M5 IS:2016 'A2' S.S.	6	
	SPRING WASHER M5 IS:3063 'A2' S.S.	6	
	HELICOIL INSERT M2x2.5D 'A2' S.S.	4	
	HELICOIL INSERT M2.5x2D 'A2' S.S.	34	
	HELICOIL INSERT M2.5x2.5D 'A2' S.S.	4	
	COUNTER SUNK SLOTTED HD SCREW M2.5x15 'A2' S.S.	20	

FOR TRADE ITEM
 Date of Issue *06/10/2020*
Rajiv

ISSUE	AUTH.	DATE	USED ON	NAME & SIG.	DATE
				DESIGNED BY	
				DRAWN BY	
				CHECKED BY	
				APPROVED BY	
				BASED ON	

ALL DIMENSIONS ARE IN MM.

TITLE: MOUNTING BRACKET ASSEMBLY

IRDE INSTRUMENTS RESEARCH & DEVELOPMENT ESTABLISHMENT, DEHRA DUN

DRG. NO. 142 1 01 03 04 05 000

SHT OF

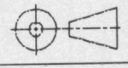

12

143

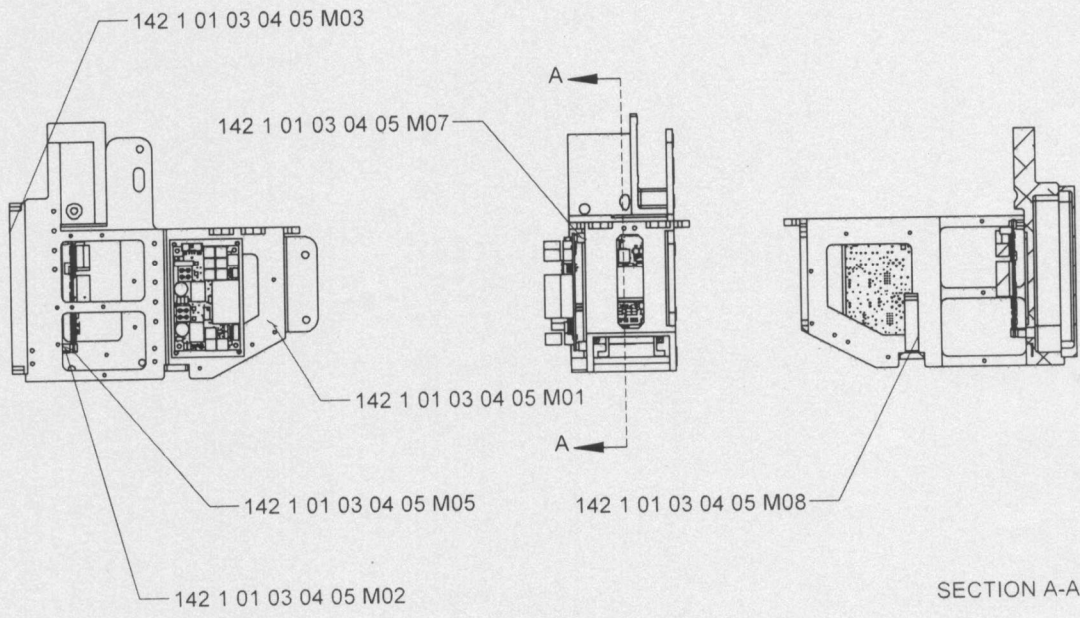
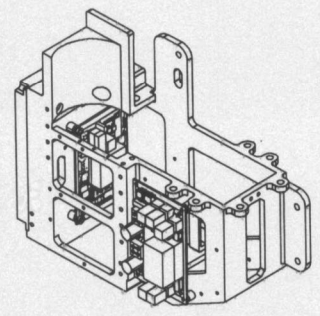
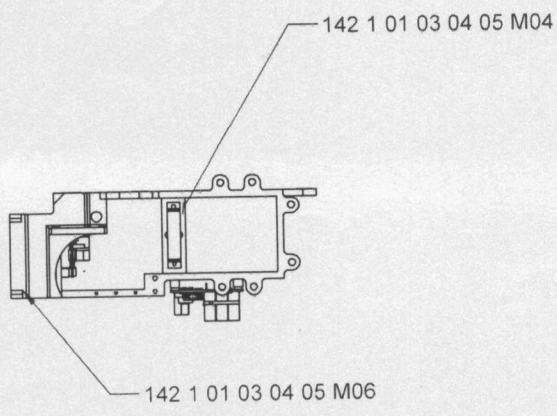

103 TRADE CHM
 Date of Issue: 06/10/20 w/ Ref

					MATERIAL : SEE DETAIL DRG							
					FINISH : SEE DETAIL DRG							
					GENERAL MACHINING TOLERANCE :					AUTHORITY		
					LINEAR UP TO 30 >30-120 >120-315 >315					DESIGNED BY		
					±0.2 ±0.3 ±0.5 ±0.8					DRAWN BY		
					ANGULAR ±30'					CHECKED BY		
					POSITION ±0.1					APPROVED BY		
					CONCENTRICITY ±0.1					CAT/ PT. NO.		
					SURFACE FINISH <12.5 μm					BASED ON		
					CORNER RADIUS 0.5(MAX.)					USED ON		
					CHAMFER ON EDGES 0.5X0.5							
			ORIGINAL		ROUGHNESS SYMBOL	~	▽	▽▽	▽▽▽	▽▽▽▽		
SYMBOL	ZONE	ISSUE	AUTH.	DATE	ROUGHNESS VALUE (μm)	50 - 25	25 - 6.3	6.3 - 0.8	0.8 - 0.1	< 0.1		
ALL DIMENSIONS ARE IN mm UNLESS OTHERWISE SPECIFIED		TITLE: MOUNTING BRACKET ASSEMBLY					INSTRUMENTS RESEARCH & DEVELOPMENT ESTABLISHMENT, DEHRA DUN DRG. NO.142 1 01 03 04 05 000 SCALE: 1.5 SHEET 1 OF 1					

14

146

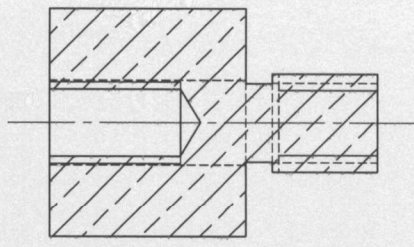
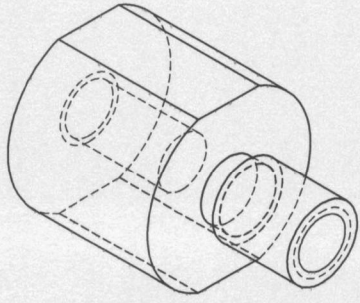

SECTION A-A

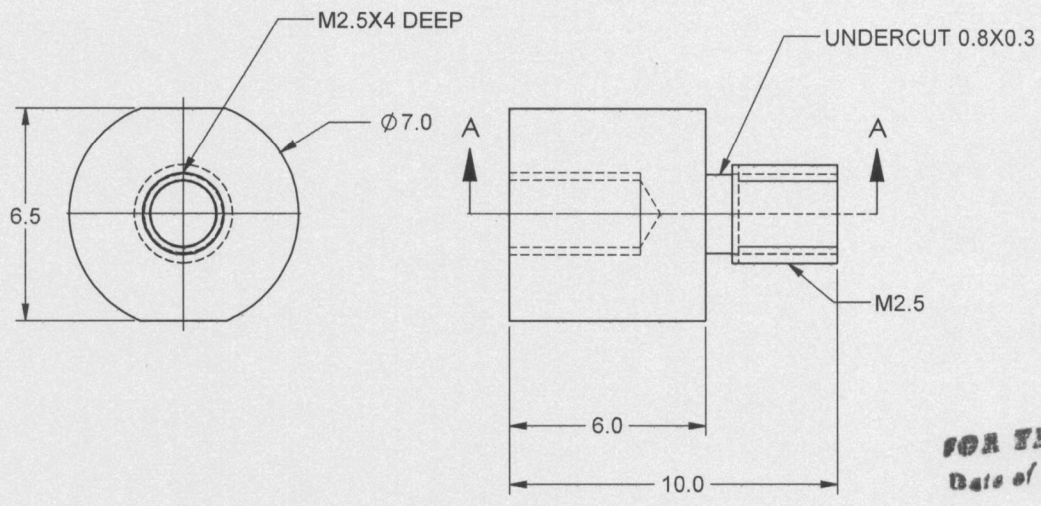

FOR TRADE OFFER
Date of Issue 30/09/2020
Ajji

Nos. off 04

					MATERIAL : BRASS IS: 319							
					FINISH : BRONZE BLACK							
					GENERAL MACHINING TOLERANCE :					AUTHORITY		
					LINEAR UP TO 30 >30-120 >120-315 >315					NAME & SIGN		
					±0.2 ±0.3 ±0.5 ±0.8					DATE		
					ANGULAR ±30'					DESIGNED BY		
					POSITION ±0.1					DRAWN BY		
					CONCENTRICITY ±0.1					CHECKED BY		
					SURFACE FINISH <12.5 μm					APPROVED BY		
					CORNER RADIUS 0.5(MAX.)					CAT/ PT. NO.		
					CHAMFER ON EDGES 0.5X0.5					BASED ON		
					ROUGHNESS SYMBOL ~ ▽ ▽ ▽ ▽ ▽					USED ON		
					ROUGHNESS VALUE (μm) 50 - 25 25 -6.3 6.3-0.8 0.8-0.1 < 0.1							
SYMBOL		ZONE		ISSUE		AUTH.		DATE		TITLE:		
				ORIGINAL						POST 2 FOR RC CARD		
ALL DIMENSIONS ARE IN mm UNLESS OTHERWISE SPECIFIED										IRDE INSTRUMENTS RESEARCH & DEVELOPMENT ESTABLISHMENT, DEHRA DUN		
										DRG. NO. 142 1 01 03 04 05 M02		
										SCALE: 5:1 SHEET OF		

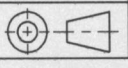

15

145

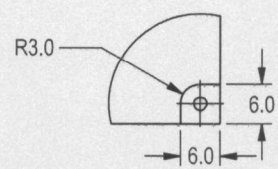
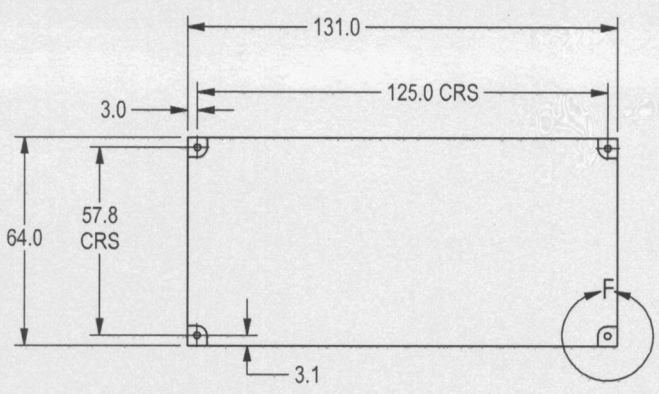
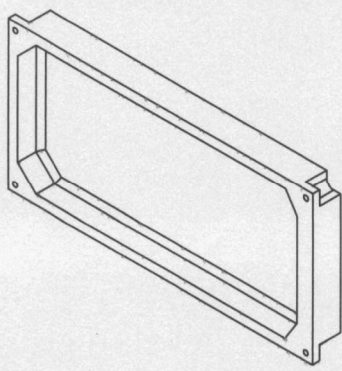

DETAIL F

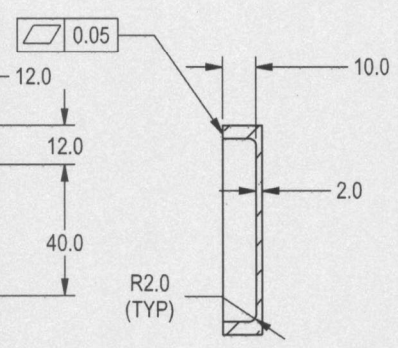
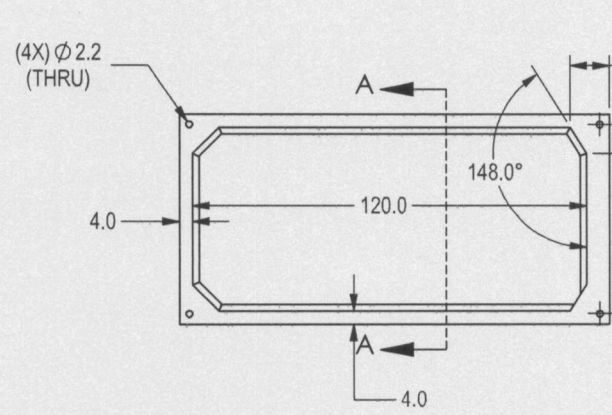
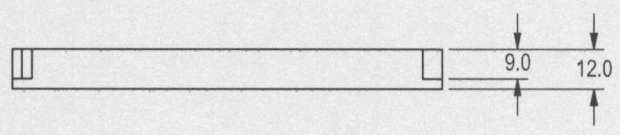

SECTION A-A

FOR TRADE ONLY
Date of issue 30/09/2020
Raj

					MATERIAL : AL ALLOY 7075 T651							
					FINISH : OLIVE GREEN							
					GENERAL MACHINING TOLERANCE :					AUTHORITY	NAME & SIGN	DATE
					LINEAR UP TO 30 >30-120 >120-315 >315 ±0.2 ±0.3 ±0.5 ±0.8					DESIGNED BY		
					ANGULAR ±30'					DRAWN BY		
					POSITION ±0.1					CHECKED BY		
					CONCENTRICITY ±0.1					APPROVED BY		
					SURFACE FINISH <12.5 µm					CAT/ PT. NO.		
					CORNER RADIUS 0.5(MAX.)					BASED ON		
					CHAMFER ON EDGES 0.5X0.5					USED ON		
					ROUGHNESS SYMBOL	~	▽	▽▽	▽▽▽	▽▽▽▽		
SYMBOL	ZONE	ISSUE	AUTH.	DATE	ROUGHNESS VALUE (µm)	50 - 25	25 -6.3	6.3-0.8	0.8-0.1	< 0.1		
ORIGINAL												
ALL DIMENSIONS ARE IN mm UNLESS OTHERWISE SPECIFIED					TITLE: COVER_LOGIC CARD					IRDE INSTRUMENTS RESEARCH & DEVELOPMENT ESTABLISHMENT, DEHRA DUN		
										DRG. NO. 142 1 01 03 04 05 M03		
										SCALE: 1:1 SHEET OF		



18

144

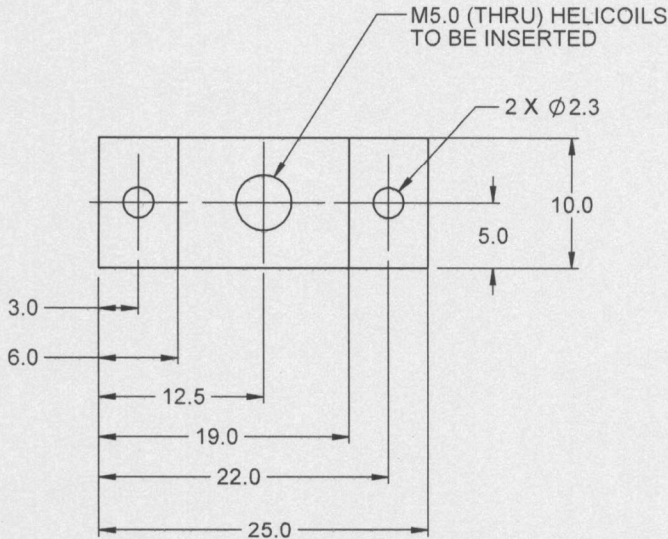
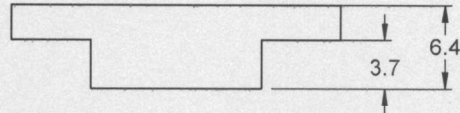
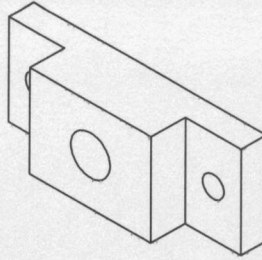

FOR TRADE OFF
Date of Issue 2.01.2020
[Signature]

					MATERIAL : AL ALLOY 7075 T651							
					FINISH : ANODISED BLACK							
					GENERAL MACHINING TOLERANCE :					AUTHORITY		
					LINEAR UP TO 30 >30-120 >120-315 >315 ±0.2 ±0.3 ±0.5 ±0.8					NAME & SIGN		
					ANGULAR ±30'					DATE		
					POSITION ±0.1					DESIGNED BY		
					CONCENTRICITY ±0.1					DRAWN BY		
					SURFACE FINISH <12.5 µm					CHECKED BY		
					CORNER RADIUS 0.5(MAX.)					APPROVED BY		
					CHAMFER ON EDGES 0.5X0.5					CAT/ PT. NO.		
					ROUGHNESS SYMBOL					BASED ON		
					~ ▽ ▽ ▽ ▽ ▽					USED ON		
					ROUGHNESS VALUE (µm)							
					50 - 25 25 - 6.3 6.3 - 0.8 0.8 - 0.1 < 0.1							
SYMBOL		ZONE		ISSUE		AUTH.		DATE		IRDE INSTRUMENTS RESEARCH & DEVELOPMENT ESTABLISHMENT, DEHRA DUN		
				ORIGINAL						DRG. NO. 142 1 01 03 04 05 M04		
										SCALE: 2:1 SHEET 1 OF 1		
										TITLE: CMOS MOUNT		

ALL DIMENSIONS ARE IN mm UNLESS OTHERWISE SPECIFIED

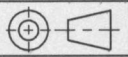

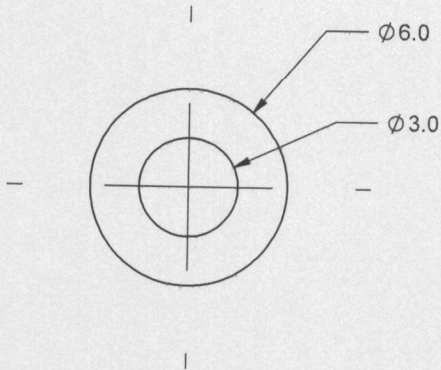

17

143

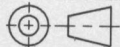

FOR TRADE ONLY
Date of Issue 20/07/2020
kgi

NOS. OFF - 20

					MATERIAL : PTFE								
					FINISH : CLEAN								
					GENERAL MACHINING TOLERANCE :			AUTHORITY		NAME & SIGN	DATE		
					LINEAR UP TO 30 >30-120 >120-315 >315 ±0.2 ±0.3 ±0.5 ±0.8			DESIGNED BY					
					ANGULAR POSITION ±30'			DRAWN BY					
					CONCENTRICITY ±0.1			CHECKED BY					
					SURFACE FINISH <12.5 μm			APPROVED BY					
					CORNER RADIUS 0.5(MAX.)			CAT/ PT. NO.					
					CHAMFER ON EDGES 0.5X0.5			BASED ON					
					ROUGHNESS SYMBOL	~	▽	▽▽	▽▽▽	▽▽▽▽	USED ON		
SYMBOL	ZONE	ISSUE	AUTH.	DATE	ROUGHNESS VALUE (μm)	50 - 25	25 - 6.3	6.3 - 0.8	0.8 - 0.1	< 0.1			
ALL DIMENSIONS ARE IN mm UNLESS OTHERWISE SPECIFIED 					TITLE: TEFLON WASHER 2MM					 INSTRUMENTS RESEARCH & DEVELOPMENT ESTABLISHMENT, DEHRA DUN		DRG. NO. 142 1 01 03 04 05 M05	
					SCALE:	5:1							

18

142

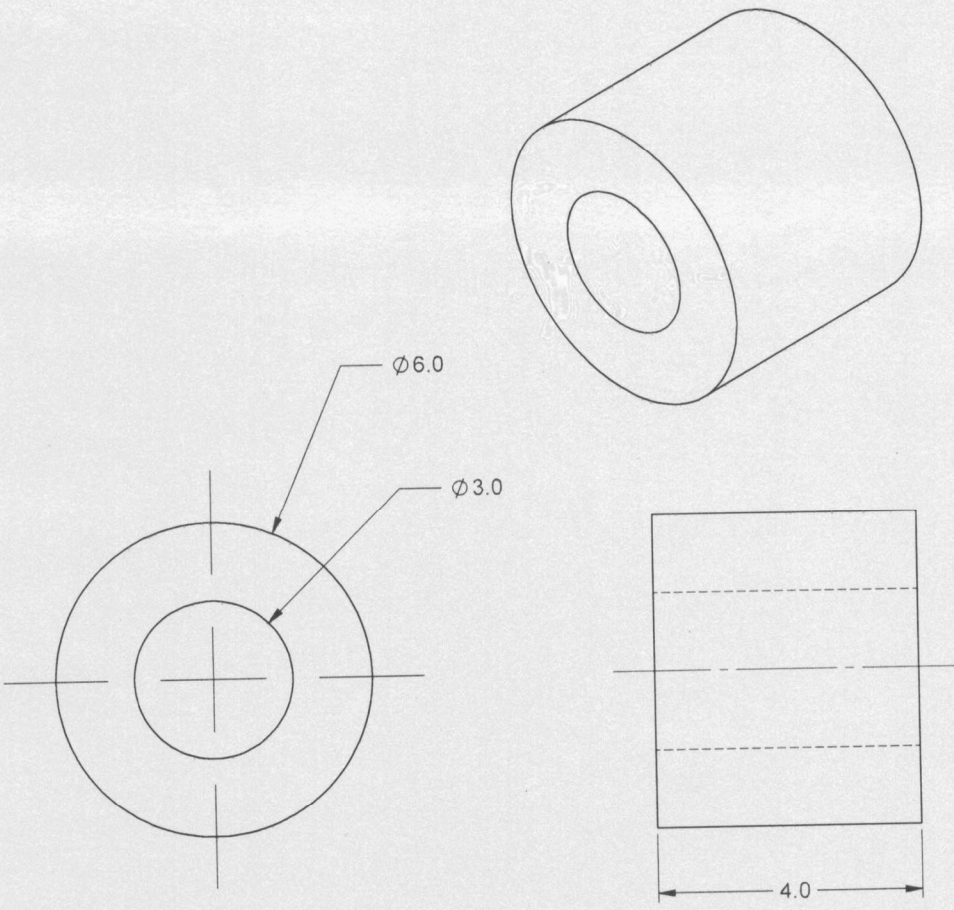

NOS. OFF -20

FOR TRADE USE
 Date of Issue 06/10/2020
Raj

MATERIAL : PTFE					AUTHORITY :			NAME & SIGN		DATE	
FINISH : CLEAN					DESIGNED BY						
GENERAL MACHINING TOLERANCE :					DRAWN BY			CHECKED BY		APPROVED BY	
LINEAR UP TO 30 ±0.2					>30-120 ±0.3			>120-315 ±0.5		>315 ±0.8	
ANGULAR ±30'					POSITION ±0.1			CONCENTRICITY ±0.1		SURFACE FINISH <12.5 μm	
CORNER RADIUS 0.5(MAX.)					CHAMFER ON EDGES 0.5X0.5			CAT/ PT. NO.		BASED ON	
ROUGHNESS SYMBOL					~			▽		▽▽	
ROUGHNESS VALUE (μm)					50 - 25			25 - 6.3		6.3 - 0.8	
					0.8 - 0.1			< 0.1		USED ON	

ALL DIMENSIONS ARE IN mm UNLESS OTHERWISE SPECIFIED

TITLE: **TEFLON WASHER 4 MM**

IRDE INSTRUMENTS RESEARCH & DEVELOPMENT ESTABLISHMENT, DEHRA DUN

DRG. NO. 142 1 01 03 04 05 M06

SCALE: 10:1

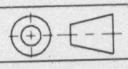

19

14

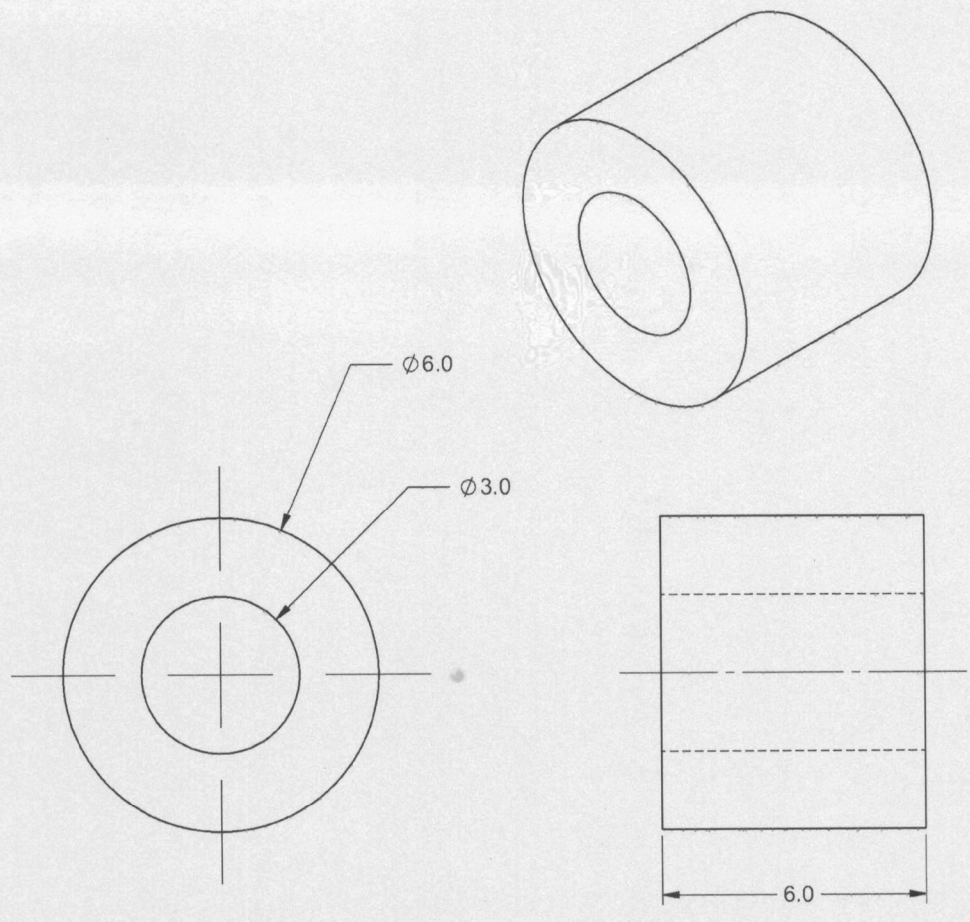

FOR TRADY
Date of Issu 30/09/2020
Rg

NOS. OFF - 20

					MATERIAL : PTFE							
					FINISH : CLEAN							
					GENERAL MACHINING TOLERANCE :					AUTHORITY	NAME & SIGN	DATE
					LINEAR UP TO 30 ±0.2					DESIGNED BY		
					>30-120 ±0.3					DRAWN BY		
					>120-315 ±0.5					CHECKED BY		
					>315 ±0.8					APPROVED BY		
					ANGULAR ±30'					CAT/ PT. NO.		
					POSITION ±0.1					BASED ON		
					CONCENTRICITY ±0.1					USED ON		
					SURFACE FINISH <12.5 μm							
					CORNER RADIUS 0.5(MAX.)							
					CHAMFER ON EDGES 0.5X0.5							
					ROUGHNESS SYMBOL	~	▽	▽▽	▽▽▽	▽▽▽▽		
SYMBOL	ZONE	ISSUE	AUTH.	DATE	ROUGHNESS VALUE (μm)	50 - 25	25 - 6.3	6.3 - 0.8	0.8 - 0.1	< 0.1		
ALL DIMENSIONS ARE IN mm UNLESS OTHERWISE SPECIFIED		TITLE: TEFLON WASHER 6 MM					IRDE INSTRUMENTS RESEARCH & DEVELOPMENT ESTABLISHMENT, DEHRA DUN					
							DRG. NO. 142 1 01 03 04 05 M07					
							SCALE: 10:1					

