

50
2040

EKKI

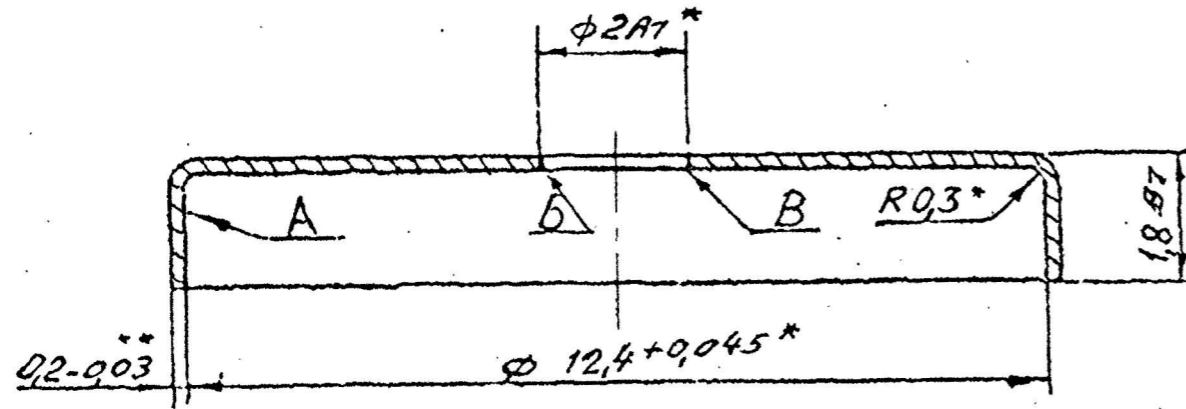

1. Alternate material is band 08kπ^{-H-} BH-3-0.2 GOST 503-81.
2. *Dimensions ensured by tools.
3. **Dimensions for reference, in one setting.
4. ^{Finish} Perform surface A and B once clamped.
5. Coating Cu3.Sn3.
6. The following is allowed :
 - a) Coating Alloy Cu Zn(70%)3μ Sn 3μ;
 - b) Unevenness of edges within the limits of dimension 1,898;
 - c) Presence of burrs (except edge B), corrugations as against the standard sample established by manufacture and agreed by customer representative at manufacturing plant;
 - d) Reduction in the thickness of copper or brass under ^{layer} up to 1MKM, provided the total thickness of coating up to 6MKM (micron) and porosity as per the requirements of GOST 9,301-78.
7. Other requirements are as per GOST B 84-264-81.

8. INDIGENOUS MATL:-

~~IS 513 2008 GR CR 3 OR GD 1 C3 OF BS 1449 SECTION 1.1.1994~~
DESIGNATION DCO3(1.0347), SYMBOL C590 OR ALTERNATIVELY C490 WORK HARDENED OF SPEC. BS EN 10139:1998.

DATE	AUTHORITY	REVISION.	SIG. AHSP.	SIG. D.O.
26.11.19	DC 37539-A	INDIGENOUS MATL. AMENDED.	R	
05-01-2011	DGQA S O Sec I Chap 10 para 40	Drg. scan, clean & edit without change & m/c replaced in supersession of existing dilapidated copy of same No.		
08-11-10	DC. 37271-A	INDIGENOUS MATL ADDED AS NOTE NO 8 ✓		
24-9-87	DCI 34241-A	DRG PROV. SEALED.		

APPROVED		3-0105875	A3-BF-032A
<i>[Signature]</i> FOR: CQA(A)		ELB. 635.063	
AHSP:- CQA(A) KIRKEE			
SPEC. DOC NO	SIGN	DATE	
DRAWN			
EDIT/CHKD			
F/M, DC			
DIV. OFFR			
NAME	SIGN	DATE	

SHEET WEIGHT SCALE

A	10.2g	10:1
---	-------	------

ORDNANCE FACTORY, HYDERABAD

Band 08kπ-BH-3-0.2
GOST 503-81 (steel)