

GENERAL ARRANGEMENT  
(FOR REFERENCE ONLY)

\* PROVIDED RIB IN SUCH A WAY THAT STACKING & LOCATION OF TRAY ONE OVER ANOTHER IS POSSIBLE

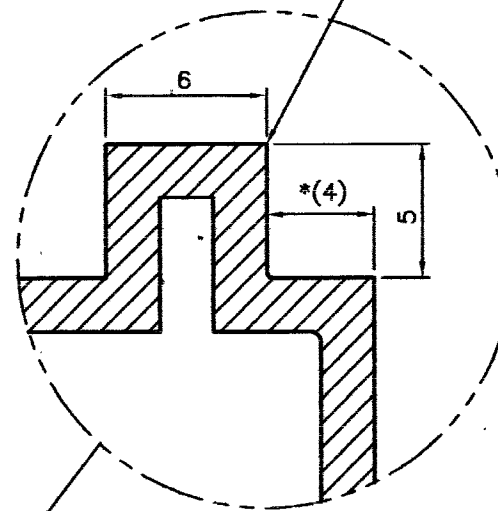

(SCALE 5:1)  
DETAIL OF LOCATING RIB

NOTE:-

- 1) TRAY IS TO BE MANUFACTURED AS PER STANDARD INJECTION/VACUUM MOULDING PRACTICE.
- 2) TRAY IS TO BE STRESS FREE, RIGID, DURABLE, CORROSION PROOF, IMPACT & WEAR RESISTANT AND SUITABLE TO USE FOR LONG PERIOD OF YEARS WITHOUT CRACKING
- 3) THE TRAY SHOULD ABLE TO CARRY A LOAD OF 25 Kg MIN.
- 4) PROVIDE SUFFICIENT RIBS & FILLETS WHEREVER NECESSARY FOR STRENGTHENING OF THE TRAY.
- 5) TOTAL 8 TRAYS AS SHOWN TO BE STACKED ONE OVER ANOTHER IN A CORRUGATED FIREBOARD PACKING BOX TO DRG NO: FS-2692 (L/ISSUE)

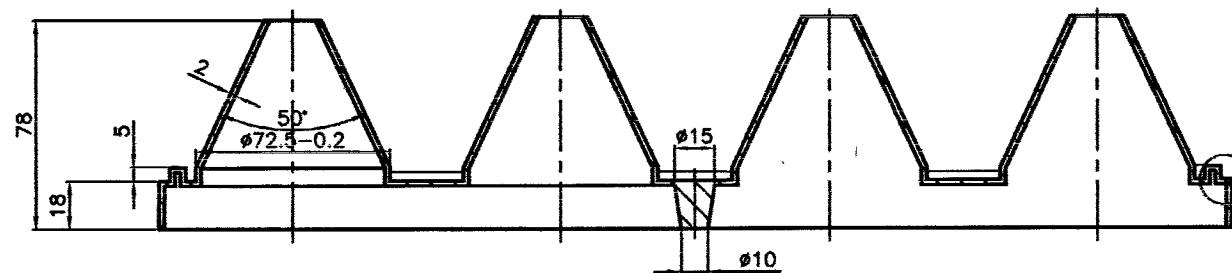

THICKNESS=2mm ALL OVER UNLESS OTHERWISE SPECIFIED.

SECTION A-A

WEIGHT OF LINER+ SCREW=161+2=163 g  
TOTAL WEIGHT= 16X163=26 kg

146 22		31 10 22		Material JSS 9330-03:2019 Type 1 OR Type 2 was HDPE TO SPECN. JSS 9330-03:2007. Drg. adv. to 'B'		DIMENSIONS ARE IN mm THIRD ANGLE PROJECTION SCALE - NTS		MATERIAL: JSS 9330-03:2019 Type 1 OR Type 2 (HDPE)		आर्मेन्स फेक्टरी अम्बाजारी ORDNANCE FACTORY, AMBAJARI	
B		A		New negative mod. sd - Design Revised		CHECKED JWM/CDD		NOMENCLATURE MOULDED PLASTIC TRAY		DRAWING NO. FS-2995 B	
REV		DATE		DESCRIPTION		SIGN		M/C-		SHEET NO.- 1	
AMENDMENTS								STORE		NO.OF SHEETS - 1	
								84mm MARK III AMMN		OPERATION -	
										COMPT: LINER OR (LINER & LINER SCREW ASSY)	