

PART No

ISM 346

FOR EXPLANATION SEE D.D NOTE SHEET No. 3. ADDL NOTE SHEET No. 4
THIRD ANGLE PROJECTION. DIMENSIONS ARE IN MILLIMETRES.

TOL. NOTE:-

WHERE TOLERANCES ARE NOT SHOWN
DIMENSIONS IN WHOLE NUMBER OR WITH
ONE DECIMAL PLACE ± 0.27 mm.
DIMENSIONS WITH TWO DECIMAL PLACES ± 0.13 mm.

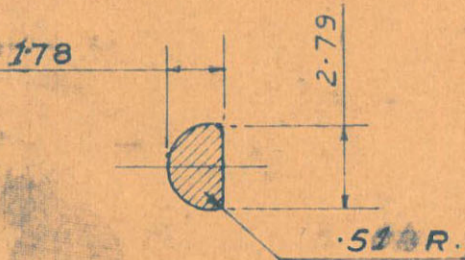

ENLARGED PART SECTION AT 'X'

BRISTLE :- PHOSPHOR BRONZE WIRE TO SPECN. BS 384 PB
~~1020 100 DIA TENSILE STRENGTH 55-90 kg/mm² TO 90 kg/mm²~~
BS 2873:1969 PB102 WITH UTS 55-90 kg/mm² 100 DIA

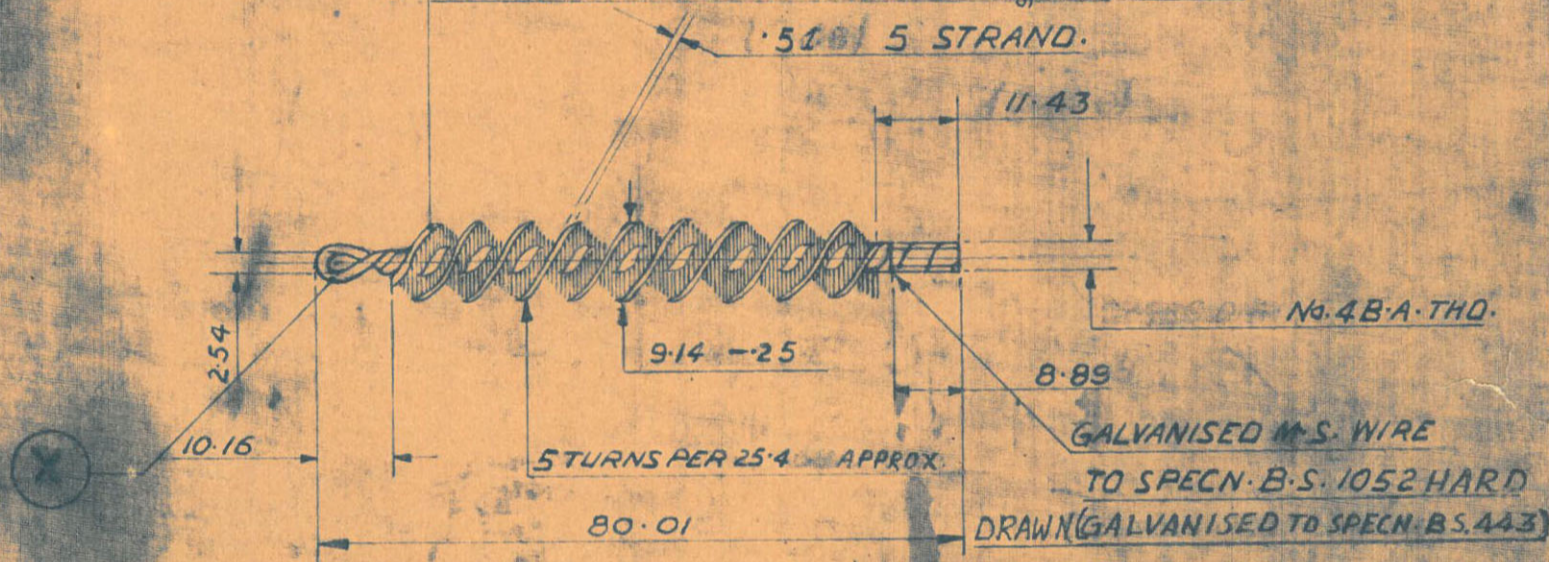

METRIC

ASSLY. DRG. D.S. CAT No. 1005-005473				
INSP. INSTRS.				
16-9-92	21966-SA	MATERIAL AMENDED	MAJ	DRAWN. CHECKED. TRACED. TRN. CHD.
25.8.77	15296-SA	MATL. FOR BRISTLE AMENDED	MAJ	
20.11.76	14905-SA	PART No. DELETED & D.S. CAT No. ADDED	DSS	APPROVED.
15.5.74	12021-SA	DRAWING SEALED	DSS	
DATE.	AUTHY.	ZONE	NATURE	SIG. MAJ FOR CISA.
AMENDMENTS.				
SEALED :- DC(I) 12021-SA DT. 15.5.74				
MATERIAL :- AS STATED.				
PROTECTIVE FINISH :-				
ESTIMATED WEIGHT :-				
SCALE :- 1/1				
BRUSH				
DATE :- 27.6.67. DESIGNER'S REF. CISA/170				
D.S. CAT NO. 1005-005473				
CISA. ICHAPU				