

SECTION 'AA'
SCALE - 5:1

- Ø 1011 AS PER OCT 3-1901-85
- SILICATE-SILVER ELECTRODES HAVING A THICKNESS OF 0.01 TO 0.03mm. SHOULD BE APPLIED TO THE CURRENT CONDUCTING COATING ALONG THE WHOLE LENGTH.
- PLATE WITH ELECTRODES SHOULD BE HARDENED. DEGREE OF HARDENING SHOULD NOT BE LESS THAN 0.7N/cm.
- BUSBARS DET.NO.1 SHOULD BE GLUED WITH CURRENT-CONDUCTING ADHESIVE WITH NICKEL FILLER.
- SUBLAYER ПС-4 ТУ 6-05-041-805-83, SHOULD BE APPLIED TO SURFACE 'B' ALONG THE WHOLE LENGTH OF PLATE.
- THE REST OF THE TECHNICAL REQUIREMENTS ARE ACCORDING TO ТУ 6-05-041-805-83

DRG. No.	RESISTANCE OF CURRENT CONDUCTING COATING, Ohms.
MCT-1618/1	REQUIREMENTS OF POINT 1 OF DRG. NO. MCT-1630 SHOULD BE OBSERVED.
MCT-1618A/1	REQUIREMENTS OF POINT 1 OF DRG. NO. MCT-1674/1 SHOULD BE OBSERVED

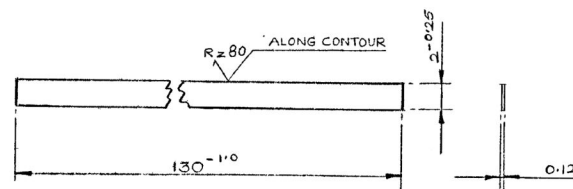

- HEAT TREATMENT: VACUUM ANNEALING. DEGREE OF ANNEALING SHOULD BE CHECKED ACCORDING TO GOST 1173-77, ON TWO SPECIMENS, 20 x 60mm, TAKEN FROM EACH BATCH.
- DEFORMATION AND BURRS ARE NOT ALLOWED.
- BUS-BAR SHOULD BE ETCHED. THICKNESS OF BUS-BAR AFTER ETCHING SHOULD NOT BE LESS THAN 0.09mm.
- LOCAL DARKENING AND TEMPER COLOURS ARE NOT ALLOWED.

ALT. EQUIV. MATL:- IS: 1897-2008 (Grade Cu-ETP or Cu-FRHC)
AS PER IS: 191-07 FOR CHEMICAL

MATL:- COPPER BAND MIT,
GOST 1173-77

SCALE:- 4:1

BUS-BAR

2/SET

DRG. NO.:- A47.755.087

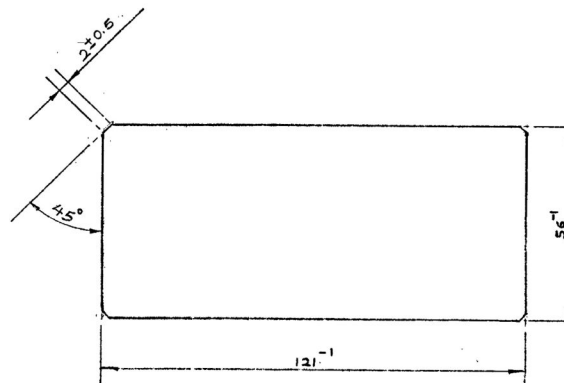

- CHAMFERS ON RIBS 0.6 ± 0.5 x 45° UNLESS OTHERWISE SPECIFIED.
- NONSTRIATION* AND THE REST OF THE TECHNICAL REQUIREMENTS ARE ACCORDING TO ТУ 3-3:834-78.

MATL:- GLASS ПК 105
GOST 3514-76

SCALE:- 1:1

PLATE

1/SET

DRG. NO.:- A48.640.153

Δn _e	5
Δ(n _e ² - n _o ²)	5
HOMOGENITY	5
DOUBLE REFRACTION	4
WEAKENING	8
NON-STRIATION	*
BUBBLING	7E
P	VII

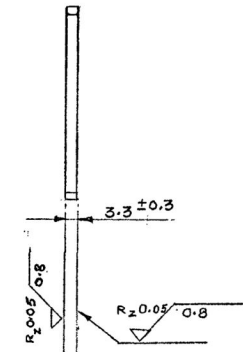

**ORDNANCE FACTORY
DEHRADUN**

DR: G. A. 164
TR:
CH: *[Signature]*
APPROVED
[Signature]
JWM/DO WM/MIS

DRG. No.-
A46.439.038 C5

**PERISCOPE A.V., T.N.P.O.-160 (T-72)
PLATE, HEATING ASSEMBLY**

DT. 9-4-79
MATL TREAT
AS ABOVE AS ABOVE
DANS 45/2016, Dt. 06/12/2016
SHEETS - 1 SHT. NO. 1
AMENDMENTS
OFD/DO/002

SCALE - 1/1
DRAWING No.:-
MCT-1618/1 & MCT-1618A/1