

ENGR. CONVENTIONS CONFORM TO IS: SPECIFICATIONS  
DIMENSIONS ARE IN mm.  
DEM. TOL. METRIC CLASS TO IS:2102.

40

4

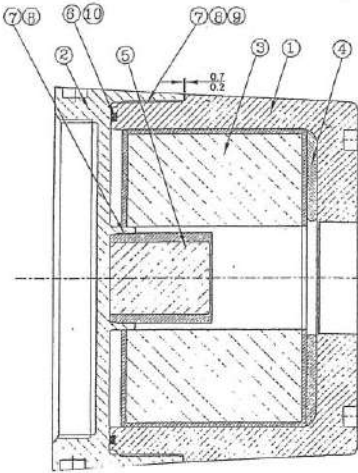

SECTION A-A

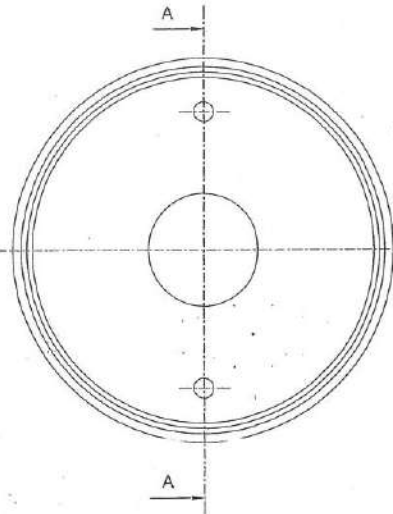

LIST OF COMPONENTS				
ITEM No.	DESCRIPTION	DESIGNER'S REF. No.	PARTY No.	Nos. PER SET
1	BASE BLEED MOTOR (MACHINED)	02676-2000A202	-	1
2	ADAPTOR	02676-2001A003 02676-2001A002 02676-2001A001	-	1
3	GRAN (PROPELLANT 80122)	02676-122001A202	-	1
4	SPACER	02676-2001A203	-	1
5	WASHER	02676-2000A002	-	1
6	10 RIMS NITRILE I. O. 124.5 x 3 SECTION NITRILE WITH SHORE HARDNESS PS (12.7), DOWTY 200 168.4476 INDIGENOUS EQUIVALENT MATERIAL "ACRYLONITRILE BUTADIENE RUBBER" AND MEAS 14 (PROV.) GRADE "D" HARDNESS 72-74" (LATEST REVISION TO BE FOLLOWED)	-	-	1
7	ADHESIVE SEALANT/WASHER ELASTOL 44476	-	-	AS REQUIRED
8	CATALYST/WASHER T27 140	-	-	AS REQUIRED
9	PRIMER - WASHER 5790	-	-	AS REQUIRED
10	GREASE, PNEUMATIC SYSTEM - DOW CORNING DC 55 M	-	-	AS REQUIRED

केवल संदर्भ के लिए

DRG. NO.	DC 3175A	END DESIG/PROV.	REVISED	DATE	03-08-2007 (PROV.)	DRG. VLMY KIRKEE	CHKD. S. KIRKEE	TRD. S. KIRKEE	COMP. S. KIRKEE	ASBY/NO.	155-2010
155mm BASE BLEED MOTOR ASSEMBLY						SCALE: NTS		ESTIMED: 4.00 A0.100		DESIGNER'S REF. 02676-20000A202	
PART NO.						DATE: 01-08-2007		FOR Q/MAN		PART NO.	
DR. CAT NO.						DATE: 01-08-2007		PROTECTIVE PAPER		AHSP: CQA(A) KIRKEE	

Text above is self explanatory. You are requested to make all out efforts to procure/develop the specified sealant at the earliest.

*File  
Louth  
100  
g/m*