

B-B

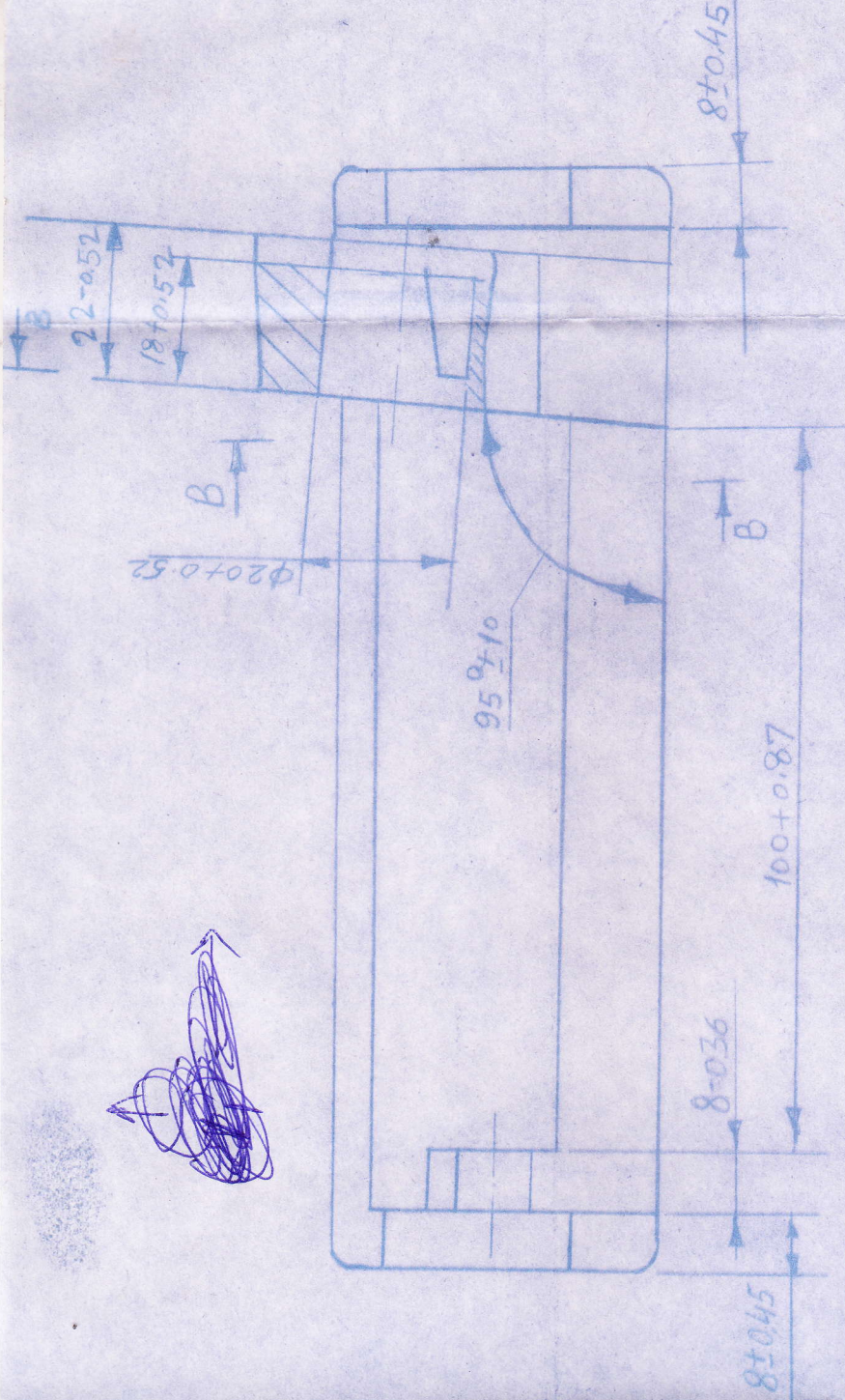

1. PRESSURE DIE CASTING Moulding GROUP I OST 3-4227-79.
2. UNSPECIFIED Moulding RADII ARE UP TO 3±0.5 mm PATTERN DRAFT TO 30° IS GIVEN TO THE DECREASE OF DIMENSIONS
3. PATTERN DRAFT TO 2° IS ALLOWED IN THE HOLE Φ20±0.52 TO THE HOLE OF DECREASE DIMENSION ABOVE TOLERANCE
4. ALTERNATE MATERIAL IS MAGNESIUM ALLOY MA5-D-72 GOST 2856-79.
5. MARK NUMBER OF THE Mould DOUBBER BY TYPE П0-6 GOST 2930-62.
6. ROLL OF MAXIMUM 15 mm HEIGHT IS ALLOWED ON THE EDGE H.

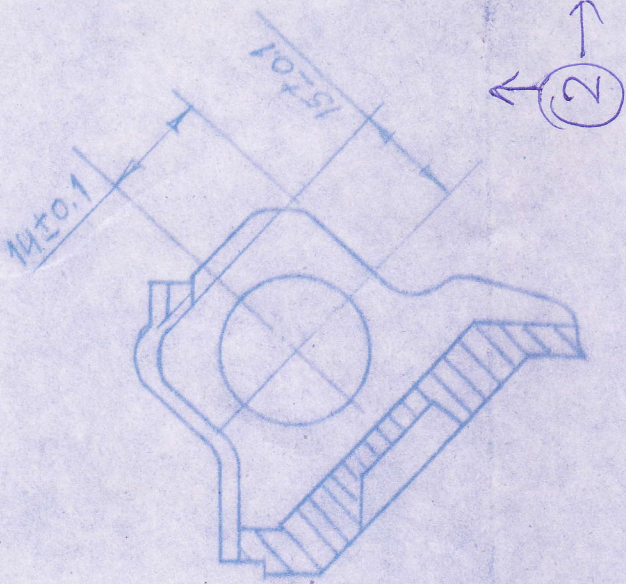

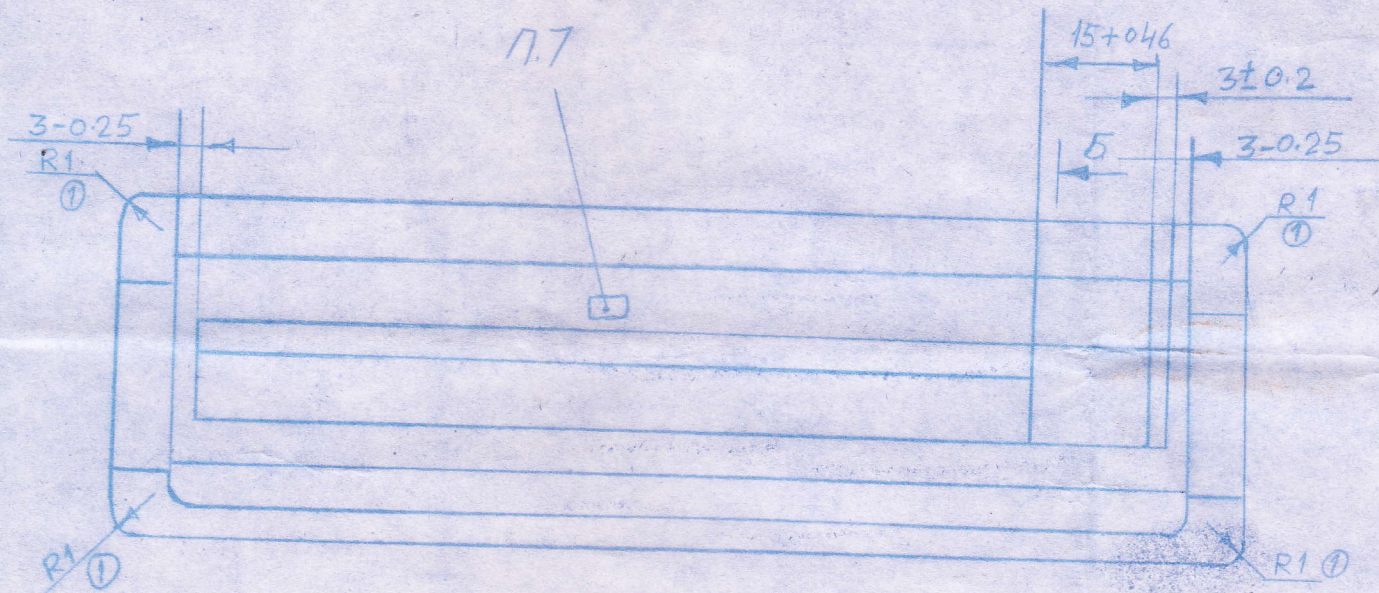
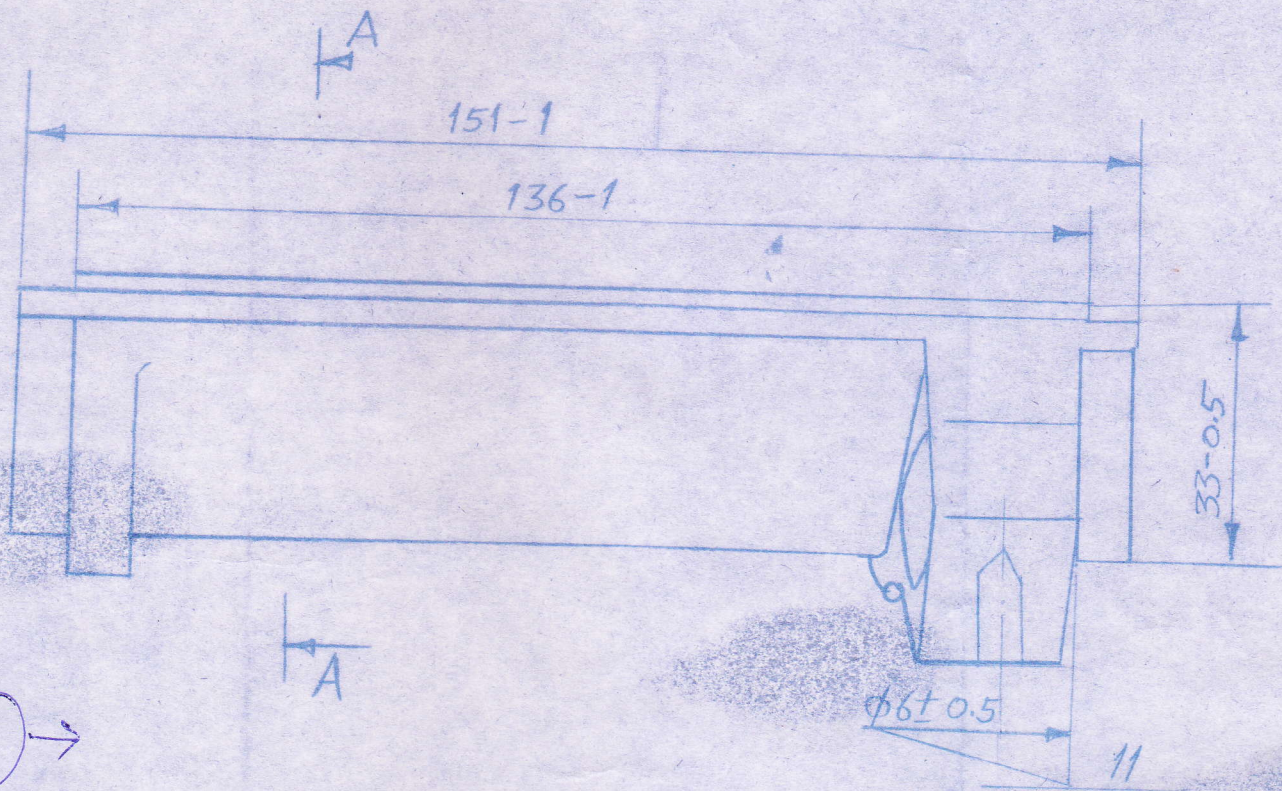
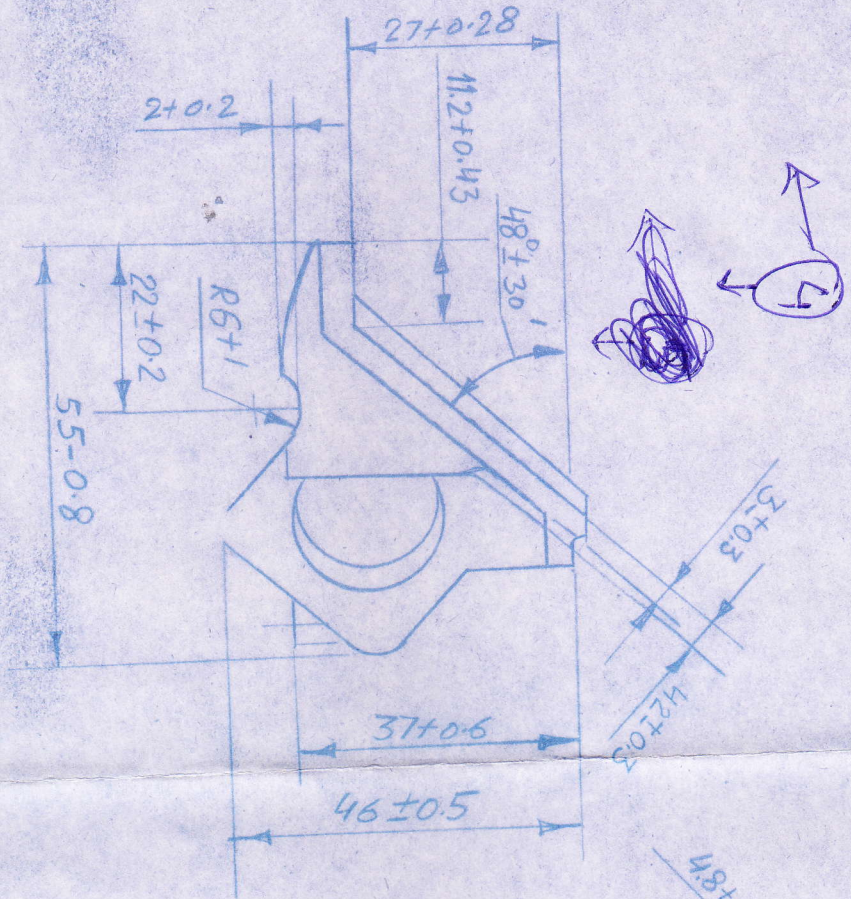

FIRST ANGLE PROJ.

A-A

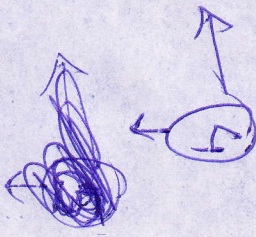
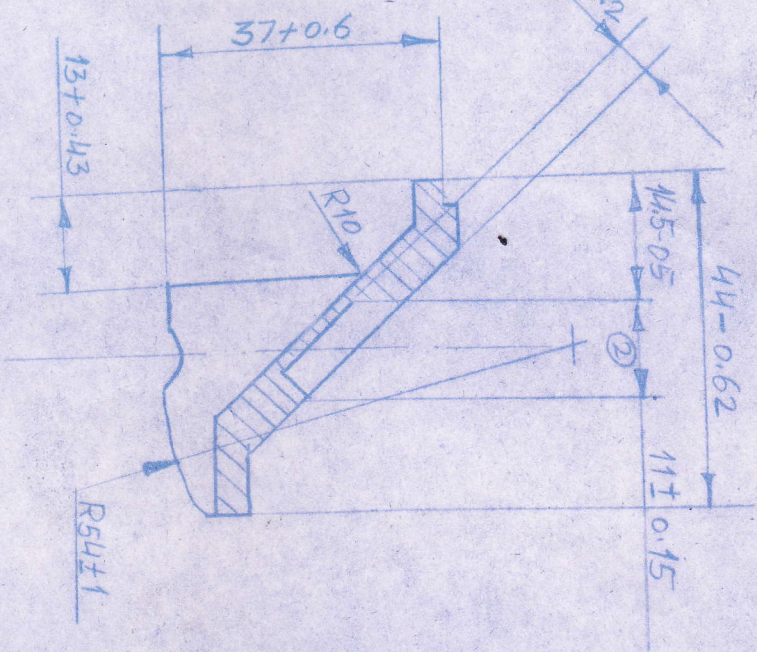

↑  
← (5) ←

S. No.	AMENDMENTS	DT. SIG.

ITEM DESCRIPTION	NO OFF MATERIAL
LIST OF PARTS	

FOR GENERAL MANAGER  
OPTO-ELECTRONIC FACTORY DEHRADUN

*Madhavi (M)*

DRN	TCD	CKD	JWM/QA

MTL. : IS: 617-1994, Gr. 4600A

SCALE : 1:1 DATE 22-2-2013

DRG NO B-26/DC/8040080/174-M3

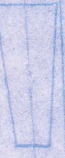

SHEET NO.

BOTTOM  
MOULDING

↑  
← (5) ←

S. No.	AMENDMENTS	DT. SIG.

ITEM DESCRIPTION	NO OFF MATERIAL
LIST OF PARTS	

FOR GENERAL MANAGER  
OPTO-ELECTRONIC FACTORY DEHRADUN

*Welding*

DRN	TCD	CKD	JWM/QA

MTL. : IS: 617-1994, Gr. 4600A  
SCALE : 1:1 DATE 22-2-2013

DRG NO B-26/DC/8040080/174-M3



SHEET NO.

BOTTOM  
MOULDING