

SECTION A-A

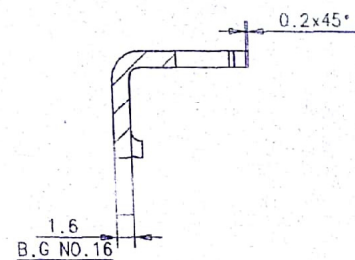

SECTION B-B

NOTE:-

1. ALL DIMENSIONS ARE IN mm.
2. ALL SHARP EDGES AND BURRS TO BE REMOVED.

MATERIAL - STEEL BS:1449 PT 1 1983 GRD.80 CS SEC 4

TREATMENT - HARDENED AND TEMPERED TO 310 TO 350 VPN

FINISH - PHOSPHATED TO SPECN.WPN/GEN 3 CLASS 111

ASSY.DRAWING NO. AR/03-RF1

INDIAN ORDNANCE FACTORIES
RIFLE FACTORY
ISHAPORE

2015	NAME	DATE
DESIGNED	<i>Munira</i>	05/05
DRAWN	<i>[Signature]</i>	
CHECKED	<i>[Signature]</i>	
APPROVED	<i>[Signature]</i>	

ASSAULT RIFLE 7.62x39mm.(GHAATAK)
CHANNEL LEFT.

SCALE
2:1

DRAWING NUMBER

AR/03/6-RF1



SHEET- OF-

बिनामत प्रति / CERTIFIED COPY OF
आइसो / लेआउट / गेज शिड्यूल Her/mem
BRG/LAYOUT/GAUGE SCHEDULE
दिनांक / AT THIS DATE. 26.02.18
* डी डी / CDD
सर्वकल फील्डरी, इशापुर
* RIFLE FACTORY ISHAPORE