

2

DWG NO 062361A-00

SH 1

1

THIS DOCUMENT AND THE INFORMATION CONTAINED IN IT ARE PROPRIETARY AND CONFIDENTIAL TO OFT. NO PERSON OR ENTITY IS ALLOWED TO COPY, REPRINT, REPRODUCE OR PUBLISH ANY PART OF THIS DOCUMENT, NOR DISCLOSE ITS CONTENTS TO OTHERS, NOR MAKE ANY USE OF IT, NOR ALLOW OR ASSIST OTHERS TO MAKE ANY USE OF IT UNLESS BY THE PRIOR WRITTEN EXPRESS AUTHORIZATION OF OFT AND THEN ONLY TO THE EXTENT AUTHORIZED. COPYRIGHT-OFT.

SHEET REV RECORD

ALL SHEETS ARE THE SAME REVISION

REVISION RECORD

REV	ECO	DESCRIPTION	DATE	APVD
01		Freeze	14-Jun-12	
02		Restricted	29-Dec-13	
--	T00120	Identical To Previous Released	20-Sep-18	L. Goldshtein

NOTES:

- INTERPRET THIS DRAWING IAW ASME Y14.100M.
- MATERIAL: STEEL ALLOY PLATE SAE 4130 PER SAE-AMS 6345 OR SAE 4340 PER AMS 6359. (EQUIVALENT STEEL IS PERMITTED AFTER ELBIT APPROVAL).
- HEAT TREATMENT: QUENCH AND TEMPER ENTIRE PART. HARDNESS 35±4 HRC PER AMS 2579/1.
- DEBURR AND REMOVE SHARP EDGES APPROX. 0.3X45°.
- GENERAL TOLERANCES ACCORDING TO ISO 2768-m.
- PHOSPHATE COATING TYPE M, CLASS 2, 0.005-0.010 MM THICK PER MIL-DTL-16232.
- THE DIMENSIONS ARE BEFORE COATING.
- QUALITY ASSURANCE PROVISIONS: 8.1 QUALITY ASSURANCE PROVISIONS FOR THIS ITEM PER RDMQD00012P.
- PACKAGING AND PACKING: THE FINISHED PART SHALL BE PRESERVED AND PACKAGED IN ACCORDANCE WITH COMMERCIAL PRACTICE.
- IDENTIFY PER MIL-STD-130 PARA 4.1.B, BY LABELING ITS CONTAINER WITH THE PART NUMBER. CHARACTERS MINIMUM TEXT HEIGHT 1.25 MM.

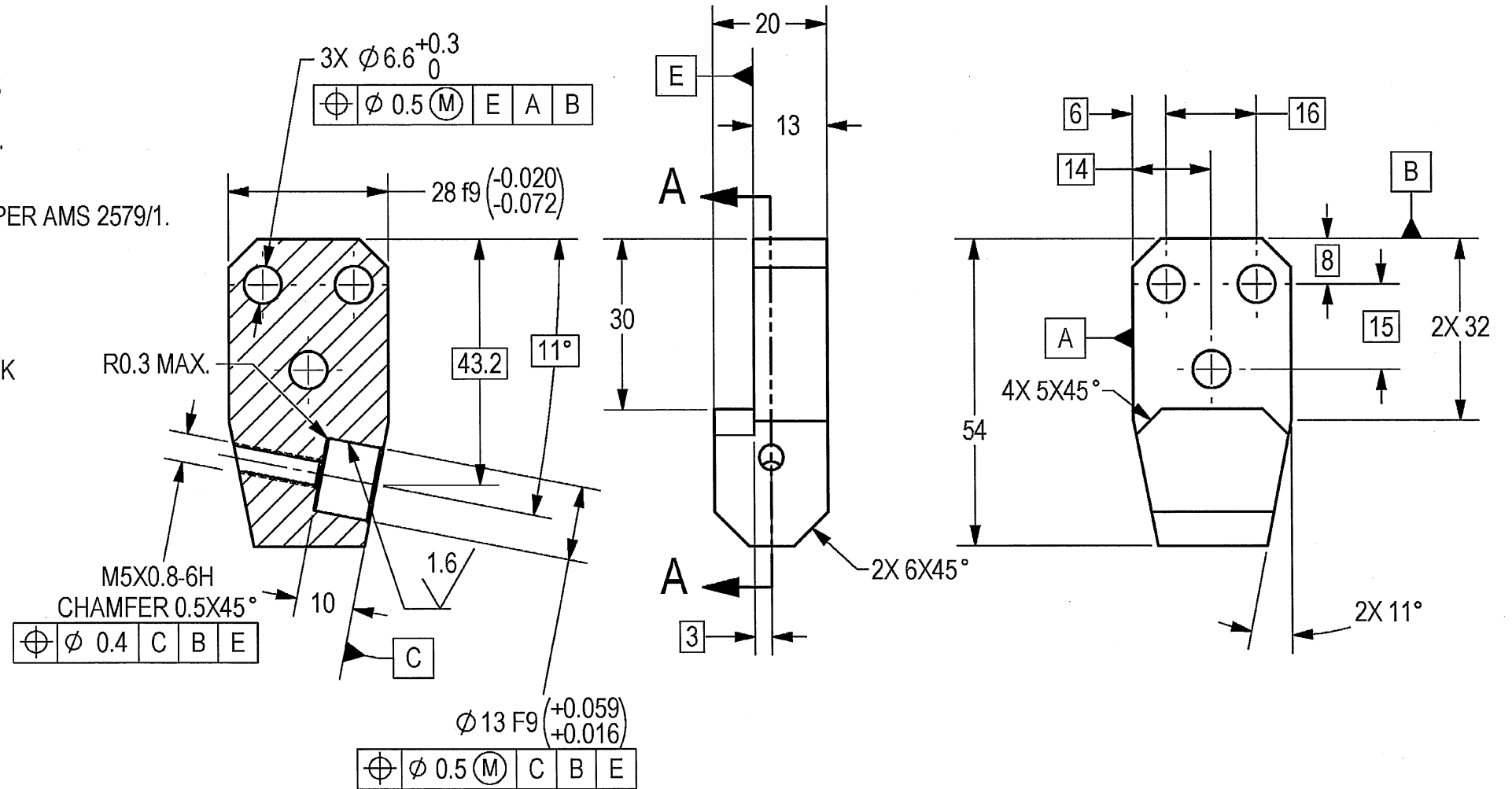

SECTION A-A

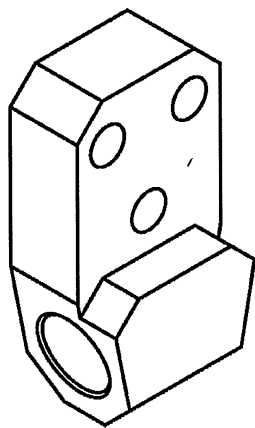

(WEIGHT APPROX.: 0.145 Kg.)

SEE ATTACHED MEDIA

UNLESS OTHERWISE SPECIFIED		SIGNATURE	DATE	<b>ORDNANCE FACTORY</b> TIRUCHIRAPPALLI	
DIMENSIONS ARE IN MM PER ASME Y14.5M-1994		DRAWN	11/9/20		
TOLERANCES		CHECKED		TITLE	
LINEAR	ANGULAR	HOS/DDO	3/9/20	FOR: TRAVERSE ASSY	
SEE NOTE 4	SEE NOTE 4	OFFICER/PRDN		OF: 12.7MM SRCG	
1st. ANGLE PROJECTION		OFFICER/QC		SIZE	CAGE CODE
		OFFICER/DDO		B	2291A
PROJECT OFFICER				DWG NO	062361A-00
SURFACE TEXTURE IN Micro M				SCALE	1:1
				AUTOMATED DRAWING (SW)	
				SHEET 1 OF 1	

PLM Control

1

2