

19

SS	C	Y	YY	S	SS	CI
000	500	411	200	400	300	4020
GENERAL TOL : FINE / MEDIUM / COARSE						
DRG. CONVENTIONS CONFIRM TO INDIAN STANDARDS						
CLASS TO IS: 2102						
DIMENSIONS ARE IN MM UNLESS OTHERWISE STATED.						

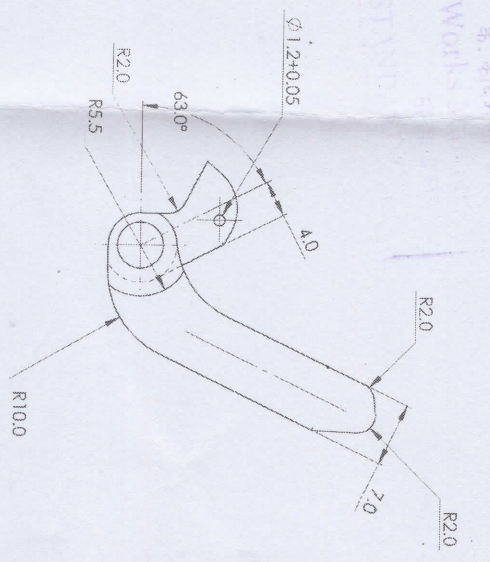
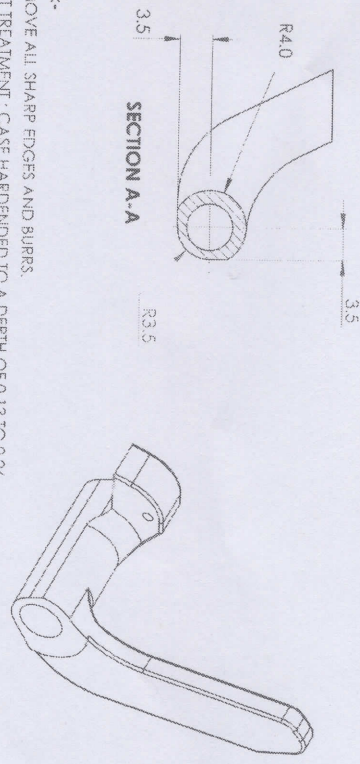
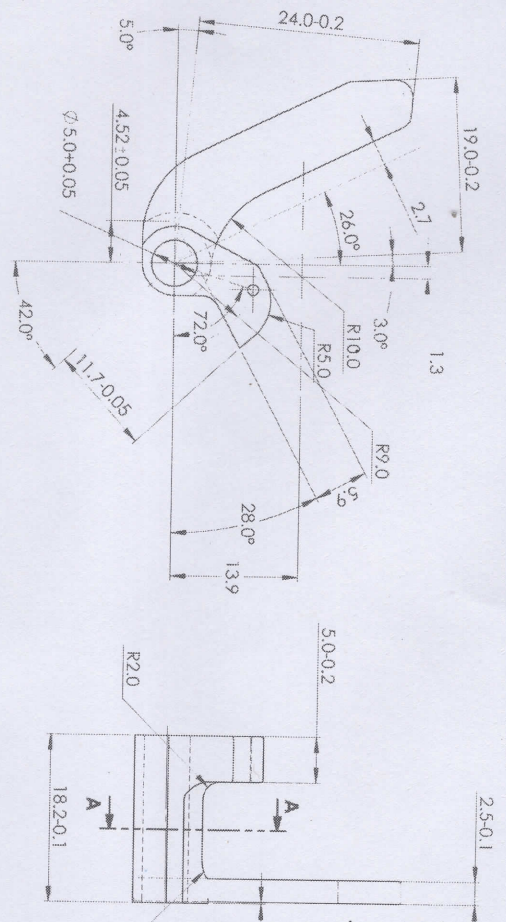

- NOTES:-**
- 1) REMOVE ALL SHARP EDGES AND BURRS.
  - 2) HEAT TREATMENT : CASE HARDENED TO A DEPTH OF 0.13 TO 0.26 HARDENED & TEMPERED TO 500-550 H.V.
  - 3) TOLERANCE FOR ANGLES : 30° UNLESS OTHER STATED
  - 4) IF COMPONENT IS TO BE MANUFACTURED THROUGH MIM ROUTE REFER ARDE SPECN. No. DRDC/ARDE/MIM/TSP/051/2019.
  - 5) ALL PROTECTIVE COATING : PHOSPHATED TO SPECN. IS:3618-1966 CLASS B'

ST. No.	DATE	AUTHORITY	BRIEF RECORD	ZONE	CD	GO
DRW: SOJ/PABH						
SIGN: <i>[Signature]</i>		<i>[Signature]</i>				
DATE: 07/03/2019		CHECKED	MATERIAL:			
			STEEL TO IS: 4437-1988, Gr. 13N13C13			
APPD: <i>[Signature]</i>	DATE: 07/03/2019	WORK DIRECTOR	PROTECTIVE FINISH:			
			ELECTROLESS NICKEL-BORON NITRIDE (NiBN) COATING			
SEALD	DATE:		AS PER ARDE SPECN. No. ARDE/SA/2016/COATING-02			
SHEET SIZE: A3	SCALE: 2:1	EST. MASS	TITLE:			
		9.84 gm	<b>SEAR SAFETY</b>			
DRG No.: 0204	013	04	02	14	005	00DA
JVPC	PART No.	SS	AA	A	C	SS
			DS CATING.			AHSP

*Handwritten notes:*  
 H.S. (Handwritten)  
 28/10 gms  
 J. Works  
 STASH