

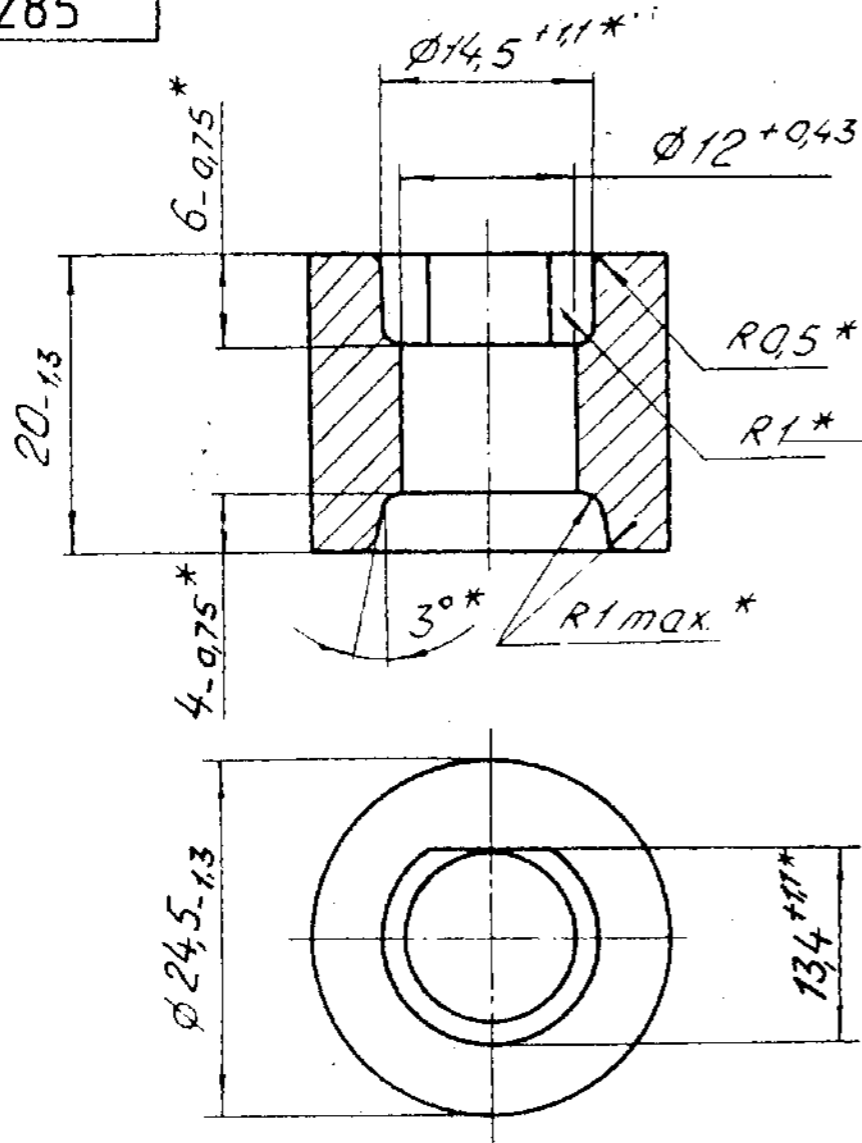

DRAWING NUMBER

8φP 610 285



**EXPLANATORY NOTE:-**

3. REFERENCE MATERIAL QUOTED:- GENERAL PURPOSE CERAMIC PERMANENT MAGNETS OF TYPE ΦBN-1a TO TY 16586 106-75. FOR PRODUCING STATIC MAGNETIC FIELDS IN ELECTRICAL MACHINES AND INSTRUMENTS.

- \* DIMENSIONS ARE ENSURED BY TOOL.
- RESIDUAL MAGNETIC FLUX IN OPEN CIRCUIT NOT LESS THAN 0.35.10<sup>-4</sup> Wb.

MATERIAL: ΦBN-1  
TY 16-586-106-75

PILOT SAMPLE SHOULD BE APPROVED BY A H S P BEFORE BULK PRODUCTION.

EST. MASS. 26g  
TO BE STAMPED OR MARKED WHERE INDICATED THUS # (LETTERS)

ALL SHARP EDGES AND CORNERS TO BE REMOVED UNLESS OTHERWISE STATED MACHINED CORNERS TO HAVE R OUTSIDE R INSIDE EQUIVALENT CHAMFERS ARE PERMISSIBLE.

MATERIAL: ΦBN-1		ALL THREADS TO CONFORM TO SPECIFICATION	STAMP OR ETCH, PART NO. MANUFACTURERS NAME & YEAR OF MFR.
NOT TO BE SCALED		TOLERANCE ON DIMENSIONS UNLESS OTHERWISE SPECIFIED	USED ON:- CP 1005 600CB
SCALE: 2:1	DATE: 22-7-97	8φP 610 285	
WT: (Kg)		MAGNET	
CONTROLLERATE OF QUALITY ASSURANCE (INFANTRY COMBAT VEHICLES)			
8	7	6	ISSUE DATE NATURE OF AMEN

A1/79

44515KPA

SIZE A3

DRAWING NUMBER

8φ P 637 242

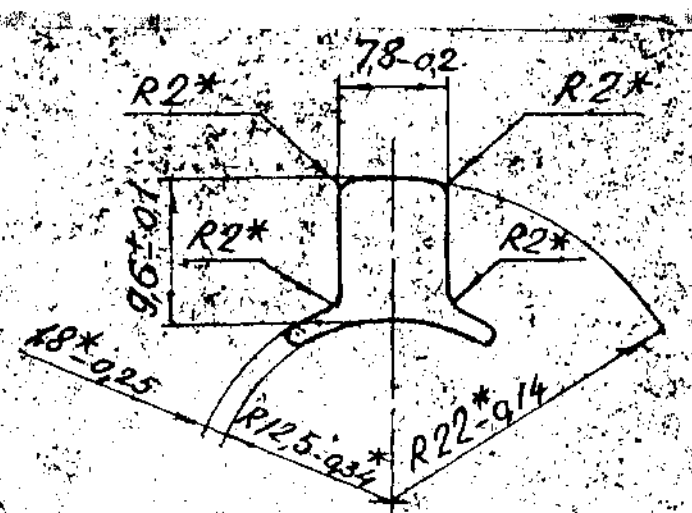

I.  
M 10:1  
SCALE 10:1

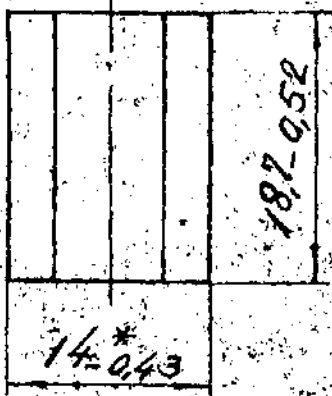
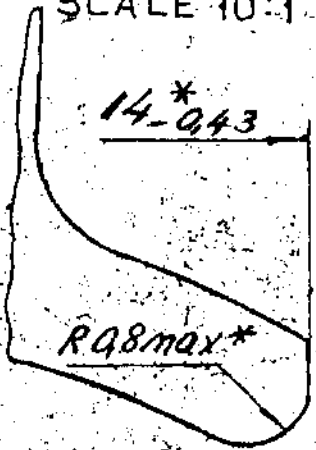

- \* DIMENSION IS ENSURED BY TOOL.
- BURRS HIGHER THAN 0,3mm ARE NOT ALLOWED.

EXPLANATORY NOTE:-

3. FOLLOW SPECIFICATIONS.

NOTE:- IT RELATES TO POLE TO DRG. No. M 304 201.

MATERIAL: MPMK-1 TY 16 S38 225-74

A-1  
110

PILOT SAMPLE SHOULD BE APPROVED BY A H S P BEFORE BULK PRODUCTION.

EST. MASS. 11g	TO BE STAMPED OR MARKED WHERE INDICATED THUS # ( LETTERS)
-------------------	--

ALL SHARP EDGES AND CORNERS TO BE REMOVED UNLESS OTHERWISE STATED MACHINED CORNERS TO HAVE R OUT-SIDE R INSIDE EQUIVALENT CHAMFERS ARE PERMISSIBLE.

ISSUE	DATE	NATURE OF AMEND

MATERIAL	ALL SHARP EDGES & CORNERS TO BE ROUNDED	ALL THREADS TO CONFORM TO SPECIFICATION	STAMP OR ETCH, PART NO. MANUFACTURERS NAME & YEAR OF MFR.
DRG. NOT TO BE SCALED	SCALE :- 2:1	TOLERANCE ON DIMENSIONS UNLESS OTHERWISE SPECIFIED	USED ON:-
DATE :- 22-7-97	WT :- (Kg)	8φ P 637 242	
TO: [Signature]		POLE BLANK	

CONTROLLERATE OF QUALITY ASSURANCE  
(INFANTRY COMBAT VEHICLES)

110



DRAWING NUMBER  
Cn 14 11

TABLE 2

CODE	DESIGNATION	COATING AND ADDITIONAL REQUIREMENTS
457392 1086	СП 14 - 11 *	SURFACE A - BLACK ENAMEL ПФ-163, GOST 5971-78, IV C1 SURFACE B - BLACK ENAMEL ПФ-163, GOST 5971-78, VI C1
457392 1088	СП 14 - 11 - I	CHEMICAL PHOSPHATING, SURFACE A - BLACK ENAMEL ПФ-163, GOST 5971-78, IV SURFACE B - BLACK ENAMEL ПФ-163, GOST 5971-78, VI APPEARANCE AS PER STANDARD PIECE.
457392 1087	СП 14 - 11 - Э	SURFACE A - BLACK ENAMEL ПФ-163, GOST 5971-78, IV C SURFACE B - BLACK ENAMEL ПФ-163, GOST 5971-78, VI C APPEARANCE AS PER STANDARD PIECE.
457392 3522	СП 158 - 012	SURFACE A - BLACK ENAMEL HЦ-11, GOST 9198-76 IV C1 SURFACE B - WHITE ENAMEL HЦ-280, TY6-10-1337-78 OR WHITE ENAMEL AK-1102, TY6-10-1408-78 VI C .
457392 3524	СП 158 - 013 - I	SURFACE A - BLACK ENAMEL HЦ-11, GOST 9198-76 IV 1 SURFACE B - ENAMEL AK-1102, WHITE, TY6-10-1408-78, VI APPEARANCE AS PER STANDARD PIECE.
457392 3523	СП 158 - 013 - Э	SURFACE A - BLACK ENAMEL HЦ-11, GOST 9198-76 IV C1 SURFACE B - WHITE ENAMEL HЦ-280, TY6-10-1337-78 OR WHITE ENAMEL AK-1102, TY6-10-1408-78 VI C1. APPEARANCE AS PER STANDARD PIECE.

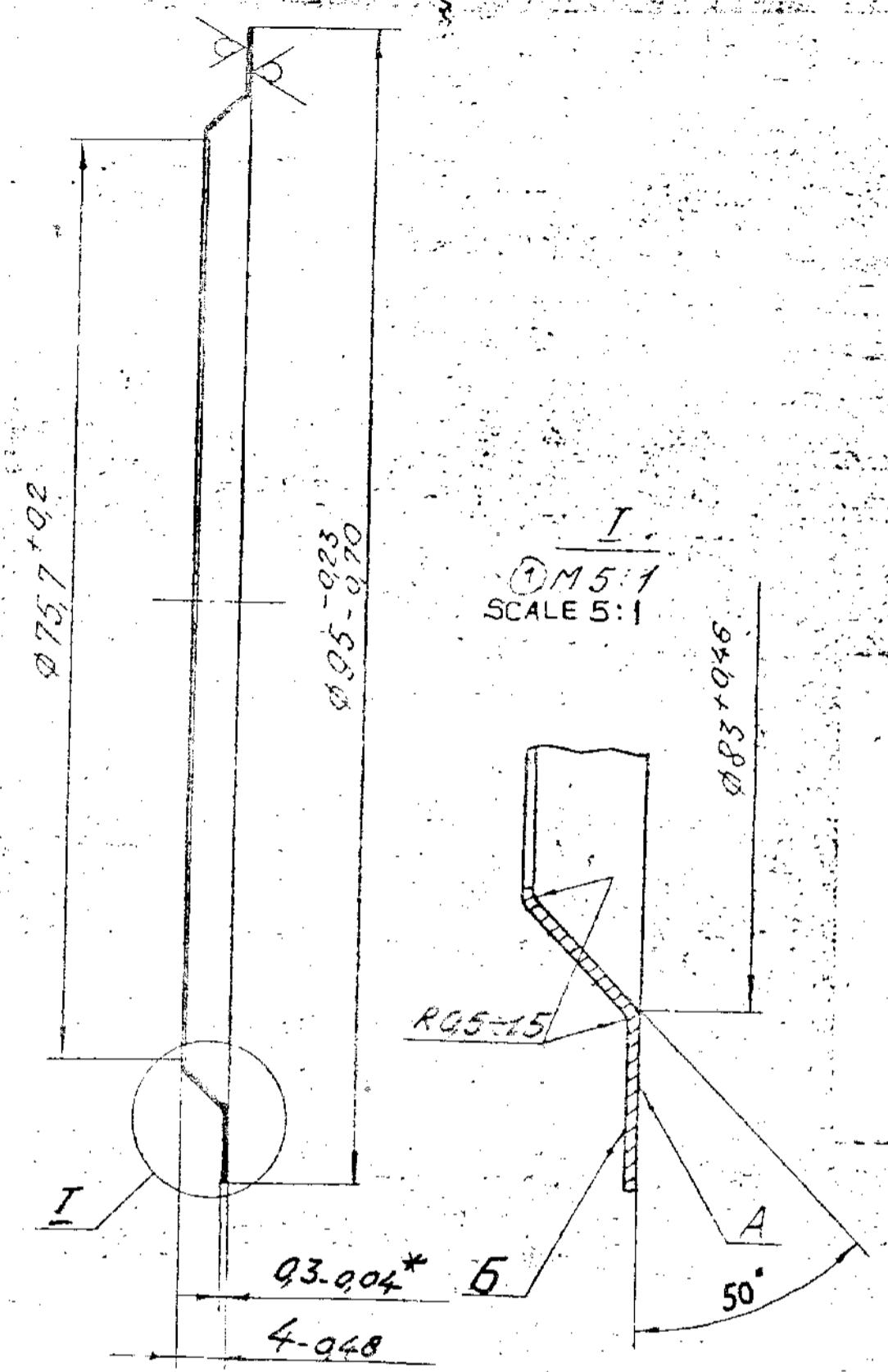

**EXPLANATORY NOTE:-**

3. REFERENCE MATERIAL QUOTED:- COLD ROLLED LOW CARBON STEEL EXTRA SOFT GROUP, NORMAL ACCURACY STEEL GROUP 0.3 mm THICK GRADE 08Kn GOST 503-71.

a) CHEMICAL COMPOSITION:- AS PER GOST 1050-74.

Gde. OF STEEL	CONTENT OF ELEMENTS IN %						
	C	Si	Mn	Cr	Ni	S	P
08Kn	0.05 0.11	0.03 (Max)	0.25 0.50	0.10	0.25	0.04	0.035

b) MECHANICAL PROPERTIES:- AS PER GOST 503-71.

Gde. OF STEEL	CONDITION OF MATERIAL	U T S Kgf/mm <sup>2</sup>
08Kn	0m EXTRA SOFT	(25 TO 40)

- \* DIMENSION FOR REFERENCE.
- UNSPECIFIED LIMIT DEVIATIONS OF ANGULAR DIMENSIONS AS PER AT 17, GOST 8908-81.

TABLE 1

DESIGNATION	LETTER
СП 14-11	Б
СП 158-013	01

PILOT SAMPLE SHOULD BE APPROVED BY A H S P BEFORE BULK PRODUCTION.

EST. MASS. 6.8g	TO BE STAMPED OR MARKED WHERE INDICATED THUS $\#$ LETTERS!	ISSUE	DATE	NATURE
--------------------	--	-------	------	--------

ALL SHARP EDGES AND CORNERS TO BE REMOVED UNLESS OTHERWISE STATED MACHINED CORNERS TO HAVE R OUTSIDE R INSIDE EQUIVALENT CHAMFERS ARE PERMISSIBLE

MATERIAL - BAND 08Kn-0M-WT-2-0-03 GOST 503-71

ALL SHARP EDGES & CORNERS TO BE REMOVED	ALL FINISHES TO CONFORM TO SPECIFICATION	STAMP OR ETCH, PART NO. MANUFACTURERS NAME & YEAR OR MFR.
ORG. NOT TO BE SCALED	TOLERANCE ON DIMENSIONS UNLESS OTHERWISE SPECIFIED	USED ON:- Cn 110 3902010 C5
SCALE :- 2:1	DATE :- 22-7-97	Cn 14 11
WT :- mg	APD	DIAL RIM

CONTROLLERATE OF QUALITY ASSURANCE (INFANTRY COMBAT VEHICLES) 62/110

DRAWING NUMBER

Cn 14 12

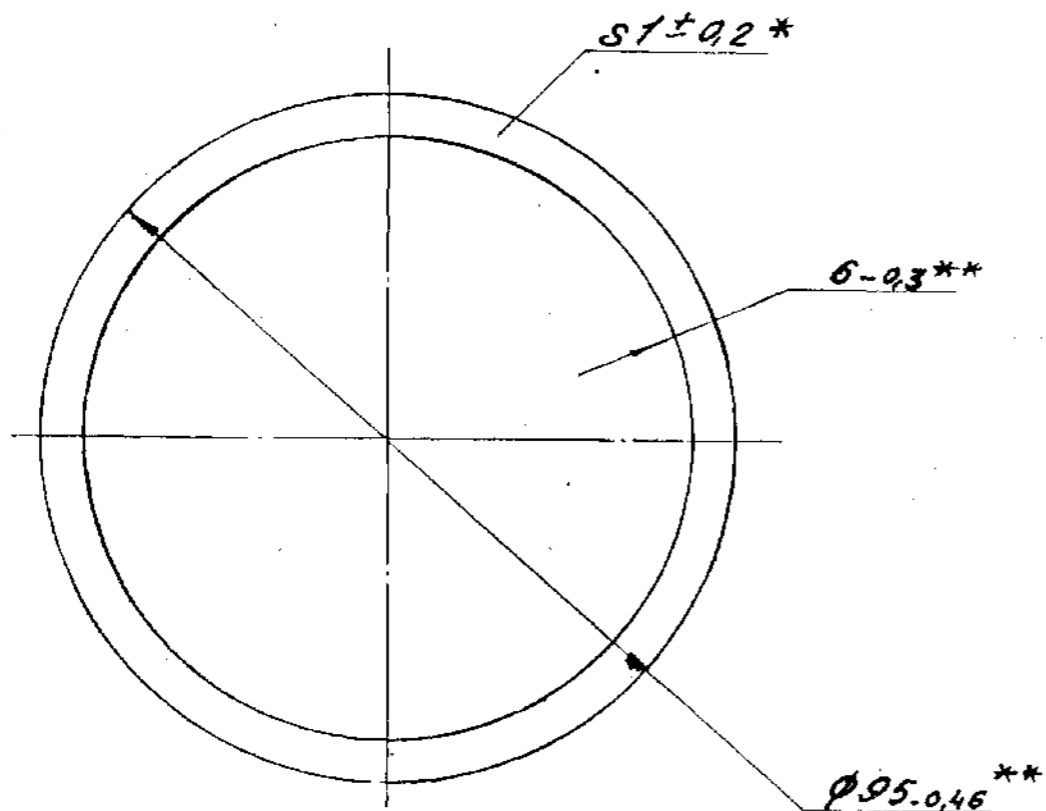

CODE	DESIGNATION	MATERIAL
4573921276	Cn 14-12	PLATE I, ROLLED, TKMЦ-M-1-2.6; 3.6; 9.9, GOST 7338-77. (2) <i>Fact...</i>
4573921277	Cn 14-12-T	PLATE I, ROLLED, TKMЦ-M-1-2.6; 3.6; 9.9, GOST 7338-77, TIN100, GOST 15152-69 (2) <i>Fact...</i>

1. \* DIMENSION FOR REFERENCE.
2. \*\* DIMENSIONS ARE ENSURED BY TOOL.

PILOT SAMPLE SHOULD BE APPROVED BY A H S P BEFORE BULK PRODUCTION.

EST. MASS.  
2.57g

TO BE STAMPED OR MARKED WHERE INDICATED THUS # (LETTERS)

ALL SHARP EDGES AND CORNERS TO BE REMOVED UNLESS OTHERWISE STATED MACHINED CORNERS TO HAVE R OUTSIDE R INSIDE EQUIVALENT CHAMFERS ARE PERMISSIBLE.

MATERIAL :- REFER TO TABLE		
ALL SHARP EDGES & CORNERS TO BE ROUNDED OFF	ALL THREADS TO CONFORM TO SPECIFICATION	STAMP OR ETCH, PART NO. MANUFACTURERS NAME & YEAR OF MFR.
DRG. NOT TO BE SCALED	TOLERANCE ON DIMENSIONS UNLESS OTHERWISE SPECIFIED	USED ON:- Cn 110 380 2010 cB
SCALE :- 1:1		
DATE :- 22-7-97		
DRN. <i>Boon</i>	WT :- (Kg)	Cn 14 12
TCD. <i>Boon</i>		
CHD.		GASKET
APD. <i>Boon</i>		

CONTROLLERATE OF QUALITY ASSURANCE  
(INFANTRY COMBAT VEHICLES)

68/110

ISSUE DATE NATURE OF AMEN

A-1  
93

44515 KA

SIZE: A3

DRAWING NUMBER

Cn 14 13

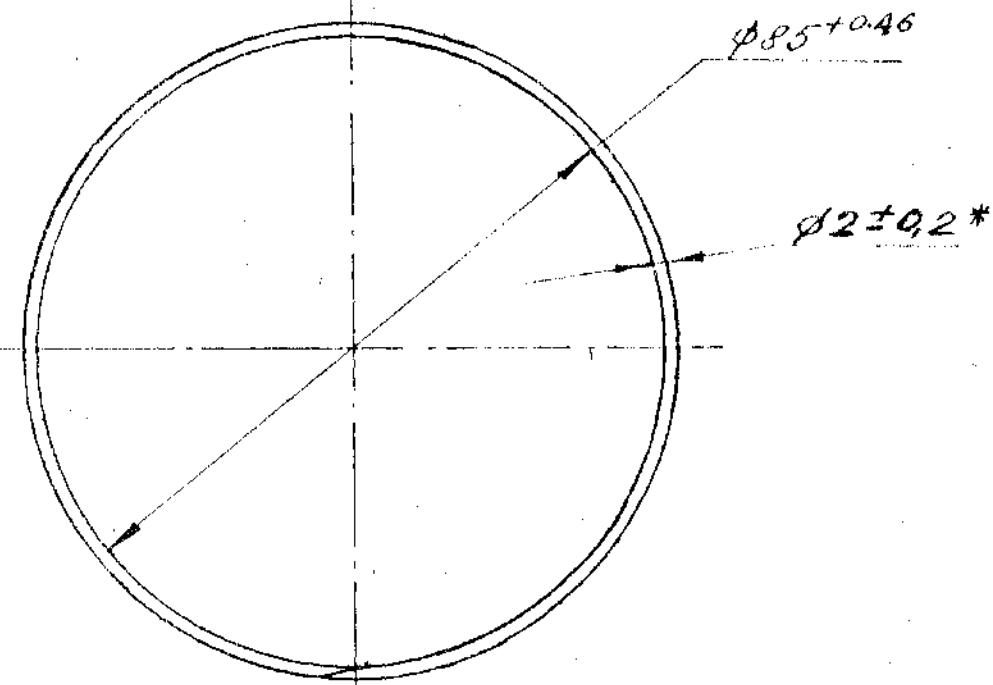

CODE	DESIGNATION	MATERIAL
457392 1278	СН 14-13	CORD GOST ШЛСР 1М $\phi 2$ ГОСТ 6467-88 79
457392 1279	СН 14-13-Т	CORD GOST ШЛСР 1М $\phi 2$ ГОСТ 6467-88 79 T.I.A. 100 ГОСТ 15152-69

1. DIMENSION FOR REFERENCE,
2. LENGTH OF STRAIGHTENED GASKET  $273.2^{+1.35}$  mm

PILOT SAMPLE SHOULD BE APPROVED BY A H S P BEFORE BULK PRODUCTION.

EST. MASS. 1.17g  
TO BE STAMPED OR MARKED WHERE INDICATED THUS # ( LETTERS)

ALL SHARP EDGES AND CORNERS TO BE REMOVED UNLESS OTHERWISE STATED MACHINED CORNERS TO HAVE R OUT-SIDE R INSIDE EQUIVALENT CHAMFERS ARE PERMISSIBLE.

ISSUE	DATE	NATURE OF AME

MATERIAL		
ALL SHARP EDGES & CORNERS TO BE ROUNDED OFF	ALL THREADS TO CONFORM TO SPECIFICATION	STAMP OR ETCH, PART NO. MANUFACTURERS NAME & YEAR OF MFR.
ORG. NOT TO BE SCALED	TOLERANCE ON DIMENSIONS UNLESS OTHERWISE SPECIFIED	USED ON:-
SCALE :- 1:1	DATE :- 22-7-97.	WT :- (Kg)
DRN. <i>KOD</i>	СН 14 13	
TCO. <i>KOD</i>	GASKET	
CHD.		
APD. <i>KOD</i>		

CONTROLLERATE OF QUALITY ASSURANCE  
(INFANTRY COMBAT VEHICLES) 65/110

A1  
94

4,4515 KA

SIZE A3

DRAWING NUMBER

Cn 14 14

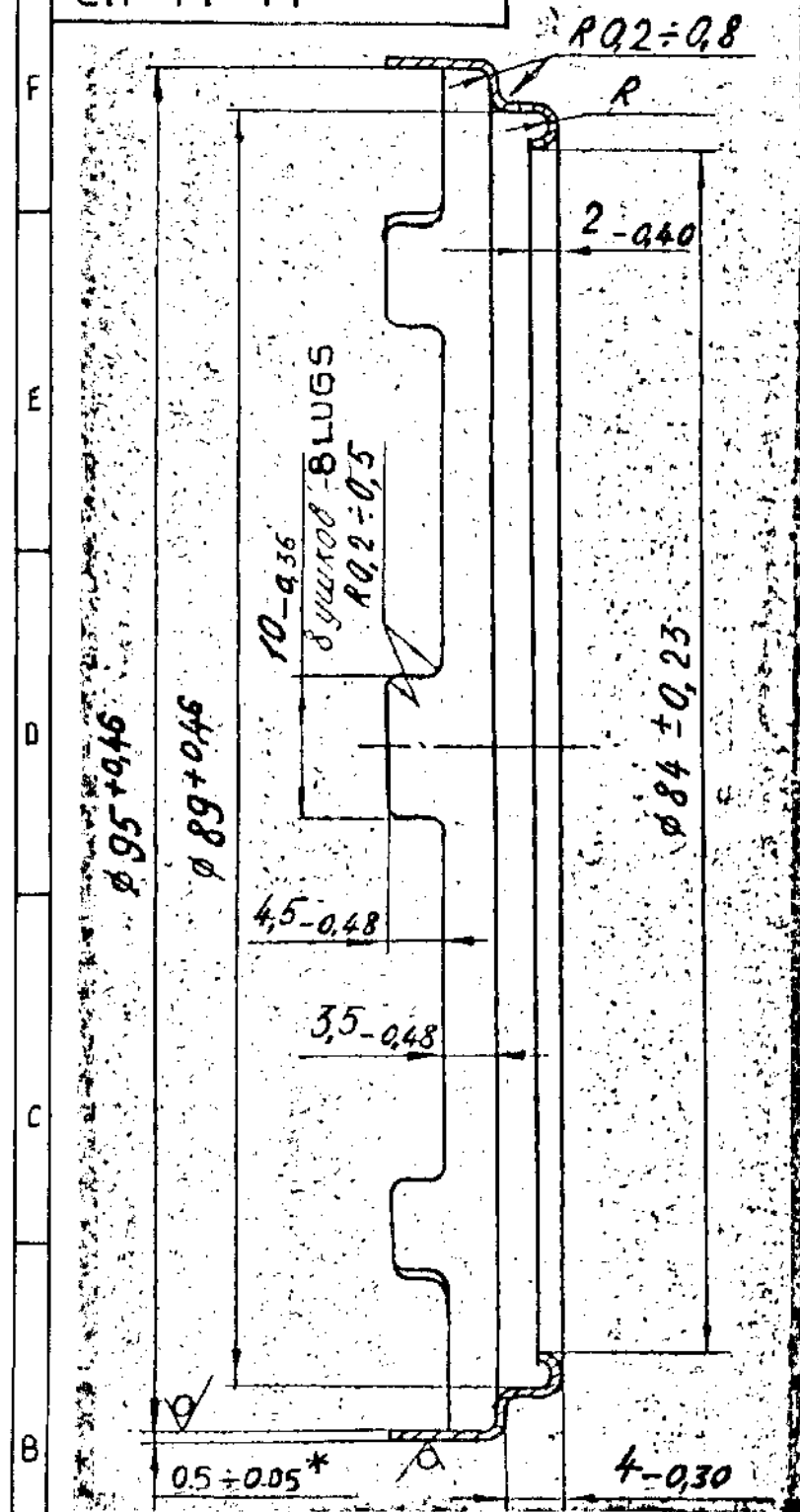

\* DIMENSION FOR REFERENCE.

PILOT SAMPLE SHOULD BE APPROVED BY A H S P BEFORE BULK PRODUCTION.

EST. MASS. 12.5g TO BE STAMPED OR MARKED WHERE INDICATED THUS (LETTERS)

ALL SHARP EDGES AND CORNERS TO BE REMOVED UNLESS OTHERWISE STATED MACHINED CORNERS TO HAVE R OUTSIDE R INSIDE EQUIVALENT CHAMFERS ARE PERMISSIBLE.

CODE	DESIGNATION	COATING AND ADDITIONAL REQUIREMENTS
45 7392 1342	СП 14 - 14	BLACK ENAMEL ПФ-163, GOST 5971-78, IVC1 - FACE SIDE, VI C1 - BACK SIDE.
45 7392 1343	СП 14 - 14 - Э	BLACK ENAMEL ПФ-163, GOST 5971-78, IVC1 - FACE SIDE, VI C1 - BACK SIDE. APPEARANCE AS PER STANDARD PIECE.
45 7392 1344	СП 14 - 14 - Т	BLACK ENAMEL ПФ-163, GOST 5971-78 IV Ж1 - FACE SIDE, VI Ж1 - BACK SIDE. APPEARANCE AS PER STANDARD PIECE.

**EXPLANATORY NOTE:-**

1. REFERENCE MATERIAL QUOTED:- COLD ROLLED LOW CARBON STEEL EXTRA SOFT GROUP, NORMAL ACCURACY STEEL GROUP 0.5-0.05mm THICK GRADE 08Kn GOST 503-71.

a) CHEMICAL COMPOSITION:- AS PER GOST 1050-74.

Gde. OF STEEL	CONTENT OF ELEMENTS IN %						
	C	Si	Mn	Cr	Ni	S	P
08Kn	0.05 0.11	0.03 (Max)	0.25 0.50	0.10	0.25	0.04	0.035

b) MECHANICAL PROPERTIES:- AS PER GOST 503-71.

Gde. OF STEEL	CONDITION OF MATERIAL	U T S Kgf./mm <sup>2</sup>
08Kn	0M EXTRA SOFT	(25 TO 40)

ISSUE	DATE	NATURE OF

MATERIAL: BAND 08Kn-0M-HT-2-0-0.5 GOST 503-71

ALL SHARP EDGES & CORNERS TO BE REMOVED

DRG. NOT TO BE SCALED

SCALE: 2:1

DATE: 22-7-97

DRN: [Signature]

TCD: [Signature]

CHD: [Signature]

APD: [Signature]

WT: (kg)

ALL THREADS TO CONFORM TO SPECIFICATION

TOLERANCE ON DIMENSIONS UNLESS OTHERWISE SPECIFIED

STAMP OR ETCH, PART NO. MANUFACTURERS NAME & YEAR OF MFR.

USED ON:-

СП 14 14

WELT

CONTROLLERATE OF QUALITY ASSURANCE (INFANTRY COMBAT VEHICLES)

64/110

A-1 95

44515 KA

SIZE A3





DRAWING NUMBER  
Cn 15A2 204

Rz 20 (✓)

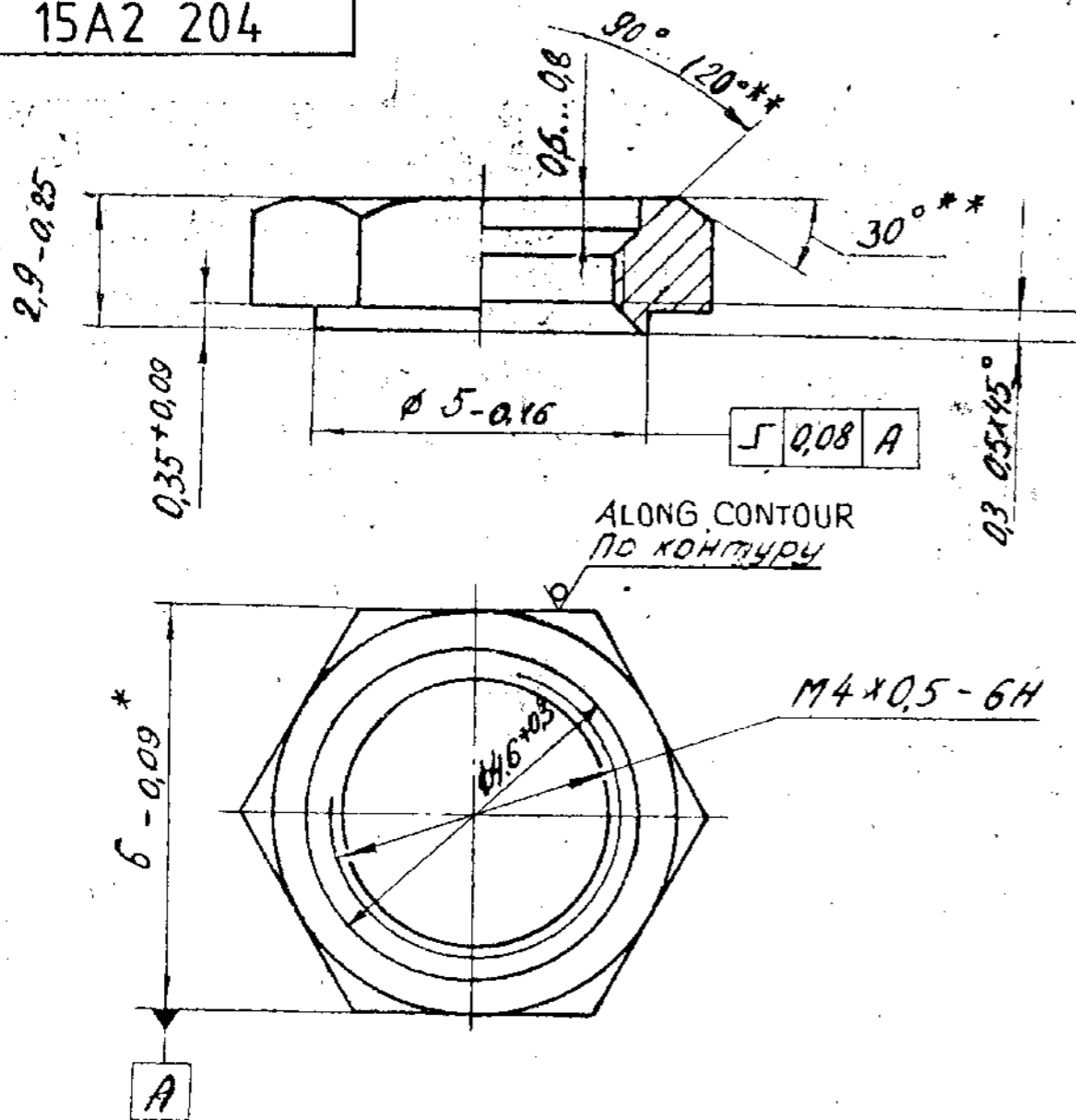

- \* DIMENSION FOR REFERENCE.
- \*\* DIMENSION IS ENSURED BY TOOL.
- COATING: CHEMICAL PASSIVATING.

MATERIAL: BAR 1C59-1 M4x0.5-6H GOST 2060-73

MATERIAL: —		ALL SHARP EDGES & CORNERS TO BE ROUNDED OFF		ALL THREADS TO CONFORM TO SPECIFICATION		STAMP OR ETCH, PART NO. MANUFACTURERS NAME & YEAR OF MFR.	
DRG. NOT TO BE SCALED		SCALE: - 10:1		TOLERANCE ON DIMENSIONS UNLESS OTHERWISE SPECIFIED		USED ON:-	
DATE: - 22-7-97.		DRN: [Signature]		WT: - (Kg)		Cn 15A2 204	
APD: [Signature]		[Symbol]		[Symbol]		NUT	
CONTROLLERATE OF QUALITY ASSURANCE (INFANTRY COMBAT VEHICLES) 58/110							

PILOT SAMPLE SHOULD BE APPROVED BY A H S P BEFORE BULK PRODUCTION.

EST. MASS. 0.34g TO BE STAMPED OR MARKED WHERE INDICATED THUS # (LETTERS)

ALL SHARP EDGES AND CORNERS TO BE REMOVED UNLESS OTHERWISE STATED MACHINED CORNERS TO HAVE R OUT-SIDE R INSIDE EQUIVALENT CHAMFERS ARE PERMISSIBLE.

A1  
109  
44515KA





DRAWING NUMBER  
Cn 15A2 407 A

63  
✓/✓/

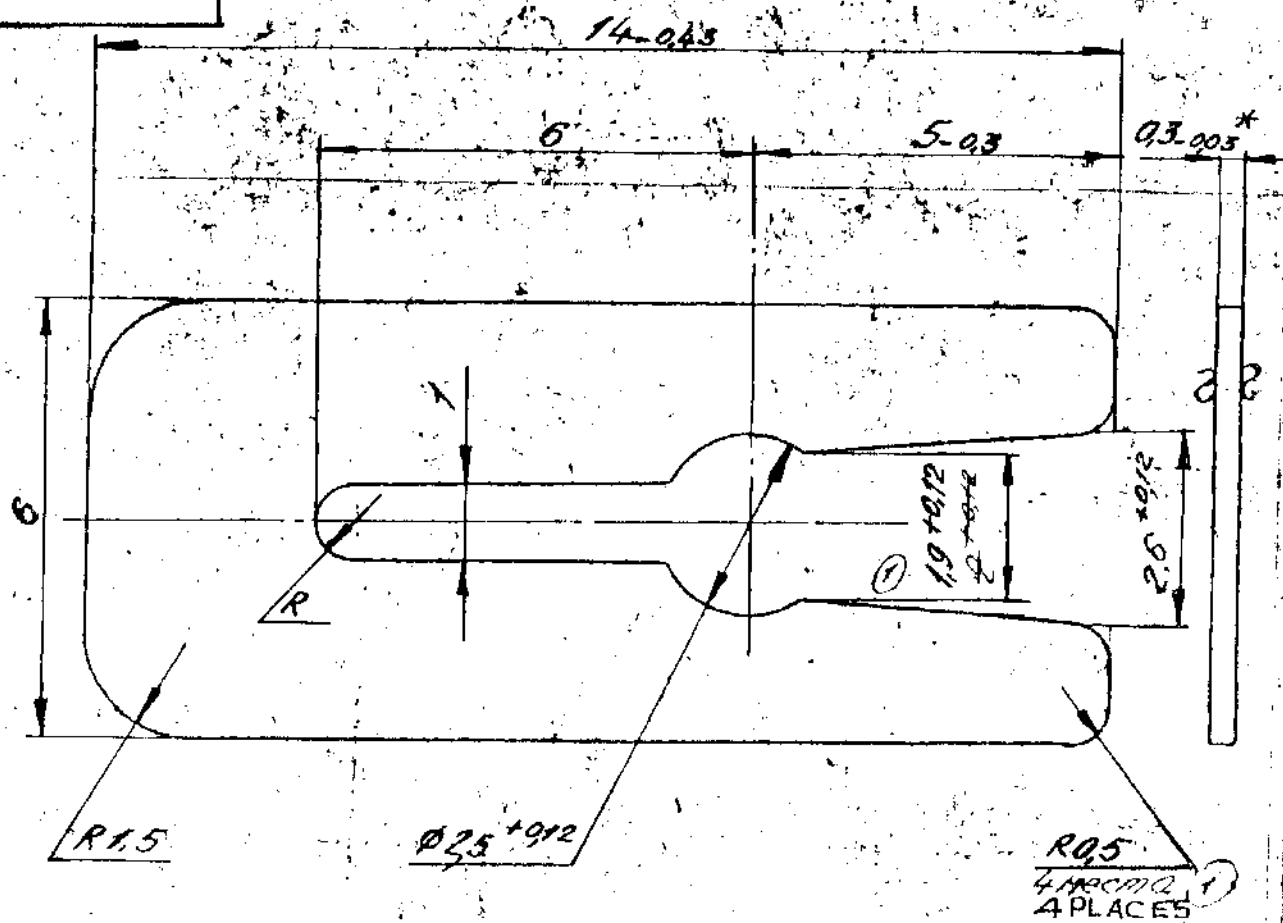

Код CODE	DESIGNATION Обозначение	COATING Покрытие
45 7392 1889	СП15А2-407А-Т	CHEMICAL, NI 9 ХИМ. Н9

- \* DIMENSION FOR REFERENCE.
- UNSPECIFIED LIMIT DEVIATIONS OF DIMENSIONS AS PER PTM 37.453.001-71.
- BURRS ARE NOT ALLOWED.
- COATING: CHEMICAL OXIDIZING WITH INHIBITION.

**EXPLANATORY NOTE:-**

5. REFERENCE MATERIAL QUOTED:- COLD ROLLED HEAT TREATED STEEL STRIP, THIRD GROUP, HIGHER CLASS ACCURACY COLOUR-TEMPERED, 0.3mm THICKNESS TO GOST 21996-76. MANUFACTURED FROM STEEL GRADE 30,60,70,85 TO GOST 1050-74.

a) CHEMICAL COMPOSITION:- AS PER GOST 1050-74.

Gde. OF STEEL	CONTENT OF ELEMENTS IN %						
	C	Si	Mn	Cr	Ni	S	P
	MAXIMUM						
30	0.27 0.35	0.17 0.37	0.50 0.80	0.25	0.25	0.04	0.035
60	0.57 0.65	0.17 0.37	0.50 0.80	0.25	0.25	0.04	0.035
70	0.67 0.75	0.17 0.37	0.50 0.80	0.25	0.25	0.04	0.035
80	0.77 0.85	0.17 0.37	0.50 0.80	0.25	0.25	0.04	0.035

b) MECHANICAL PROPERTIES:- AS PER GOST 21996-76.

STRIP STRENGTH GROUP	TENSILE STRENGTH Kgf/mm <sup>2</sup>	VICKERS HARDNESS NUMBER, HV
3П	OVER 190	OVER 600

PILOT SAMPLE SHOULD BE APPROVED BY A H S P BEFORE BULK PRODUCTION.

EST. MASS. 0.14g TO BE STAMPED OR MARKED WHERE INDICATED THUS # LETTERS)

ALL SHARP EDGES AND CORNERS TO BE REMOVED UNLESS OTHERWISE STATED MACHINED CORNERS TO HAVE R OUTSIDE R INSIDE EQUIVALENT CHAMFERS ARE PERMISSIBLE.

MATERIAL :- BAND 3П-П-К-0.3 GOST 21996-76.		
ALL SHARP EDGES & CORNERS TO BE ROUNDED OFF	ALL THREADS TO CONFORM TO SPECIFICATION	STAMP OR ETCH, PART NO. MANUFACTURERS NAME & YEAR OF MFR.
ORG NOT TO BE SCALED	TOLERANCE ON DIMENSIONS UNLESS OTHERWISE SPECIFIED	USED ON:-
SCALE :- 10:1		
DATE :- 2.2-7-97.		
DRN	WT :- (Kg)	СП 15 А2 407 А
ICD		LOCK PLATE
CHD		
APP		
CONTROLLERATE OF QUALIITY ASSURANCE (INFANTRY COMBAT VEHICLES)		

A1/63

44515KР

SIZE A3

ISSUE DATE NATURE OF A

ITEM	DRAWING NUMBER	D S CAT NUMBER	DESCRIPTION	No. QEE	REMARKS
	CP 15A2-3802231 CB		HAIR SPRING WITH SPLIT BUSHING ASSY.		
1	CP 15A2-3802232		HAIR SPRING WIRE Бр0φ 6.5-0.4-T-0.5, TY48-21-95-72. MASS 0.15	1	NO DRAWING MANUFACTURING DETAILS COVERED IN ASSY. DRG.
2	Cn 101 212		SPLIT BUSHING WIRE АКРНТ-4 DC 59-1, GOST 1066-75. MASS 0.15	1	

DC(1) NO DATE	ISSUE	NATURE OF AMENDMENTS	DC(1) NO DATE	ISSUE	NATURE OF AMENDMENTS
DRN	<i>Boz</i>	CP 15A2-3802231 CB	DATE: -23-7-97		
TCD	<i>Boz</i>		USED ON-CP100-3005CB		
CHD		HAIR SPRING WITH SPLIT BUSHING ASSY	SHEET 1   SHEETS 1		
APPD	<i>AS</i>		OF 32   110		

CONTROLLERATE OF QUALITY ASSURANCE (ICV)

DRAWING NUMBER

Cn 25 103

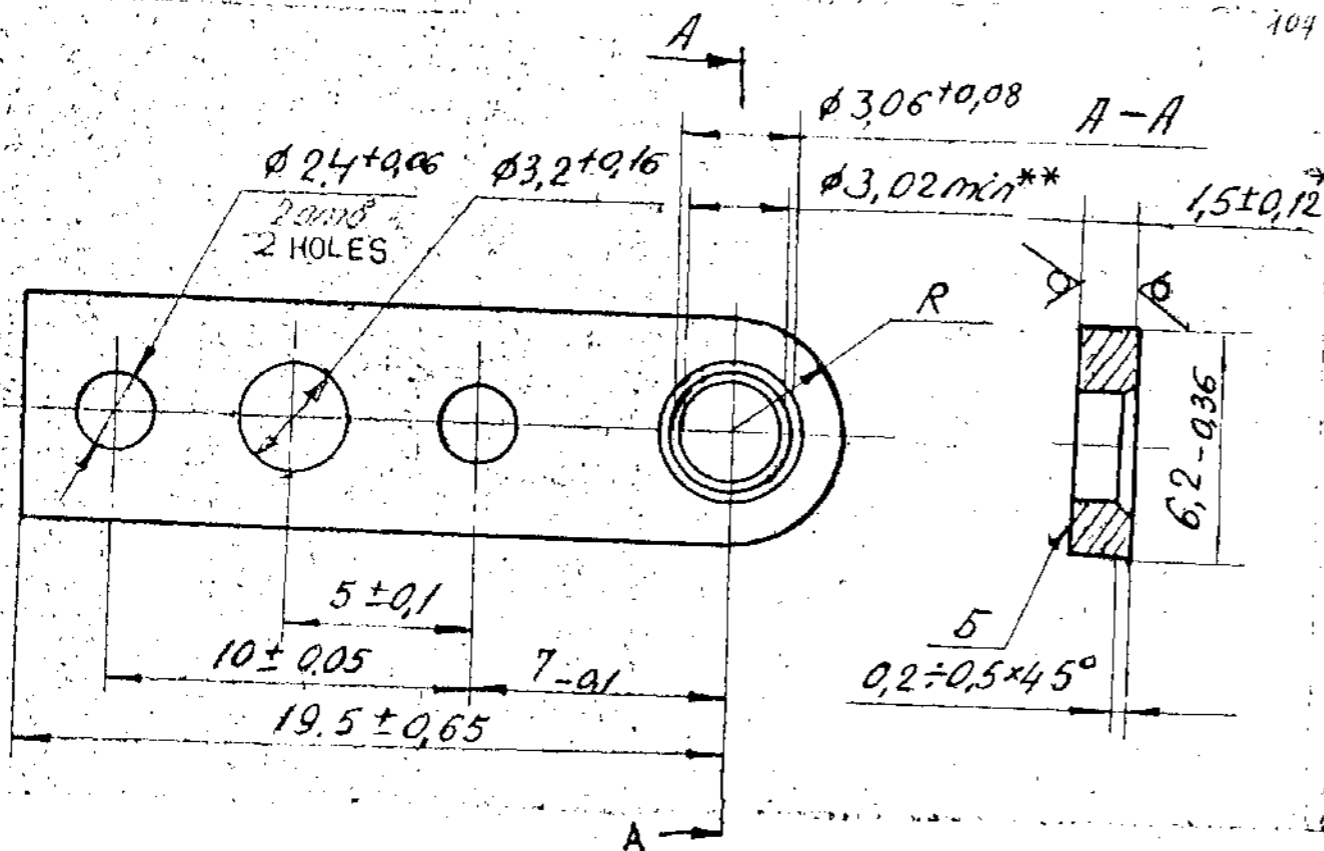

**EXPLANATORY NOTE:-**

4. REFERENCE MATERIAL QUOTED: COLD ROLLED STEEL SHEET WITH STANDARD ACCURACY  $0.5 \pm 0.05$ mm THICK ESPECIALLY HIGH FINISH 1, ORDINARY DRAWN TO GOST 16523-70. MANUFACTURED FROM STEEL GRADE 08Kn TO GOST 1050-74:-

a) CHEMICAL COMPOSITION AS PER GOST 1050-74:-

GRADE OF STEEL	CONTENT OF ELEMENTS %						
	C	Si	Mn	Cr	Ni	S	P
	MAXIMUM						
08Kn	0.05 - 0.11	0.03 (MAX)	0.25 - 0.50	0.10	0.25	0.04	0.035

b) MECHANICAL PROPERTIES AS PER GOST 16523-70:-

GRADE OF STEEL	TENSILE STRENGTH Kgf/mm <sup>2</sup>	ELONGATION % (MAX)
08Kn	27 - 39	26

APP. CODE	DESIGNATION	COATING
45 7392-1783	CN 25 - 103	Z19 CHROMATIZING COLOURLESS
45 7392 1783	CN 25 - 103-7	4.9 xp Decybermice

MATERIAL SHEET 5.5 GOST 19904-74 AT 08Kn GOST 16523-70

- \* DIMENSION FOR REFERENCE.
- "B" SURFACE OF INWARD CAMBER.
- \*\* DIMENSION FOR A COATED PART.

PILOT SAMPLE SHOULD BE APPROVED BY A H S P BEFORE BULK PRODUCTION.

EST. MASS. 1.8g TO BE STAMPED OR MARKED WHERE INDICATED THUS # (LETTERS)

ALL SHARP EDGES AND CORNERS TO BE REMOVED UNLESS OTHERWISE STATED MACHINED CORNERS TO HAVE R OUTSIDE R INSIDE EQUIVALENT CHAMFERS ARE PERMISSIBLE.

MATERIAL		
STAMP EDGES & CORNERS TO BE ROUNDED	ALL THREADS TO CONFORM TO SPECIFICATION	STAMP OR ETCH, PART NO. MANUFACTURERS NAME & YEAR OF MFR.
NOT TO BE SEALED	TOLERANCE ON DIMENSIONS UNLESS OTHERWISE SPECIFIED	USED ON:-
SCALE 1: 5:1	WT 1: (Kgf)	CN 25 103
DATE 22-7-97		BRACKET
CONTROLLERATE OF QUALITY ASSURANCE (INFANTRY COMBAT VEHICLES)		
		54/110

A1  
107

44515K<sub>B</sub>

SIZE A3

ISSUE DATE NATURE OF







DRAWING NUMBER  
Cn25 420 C5

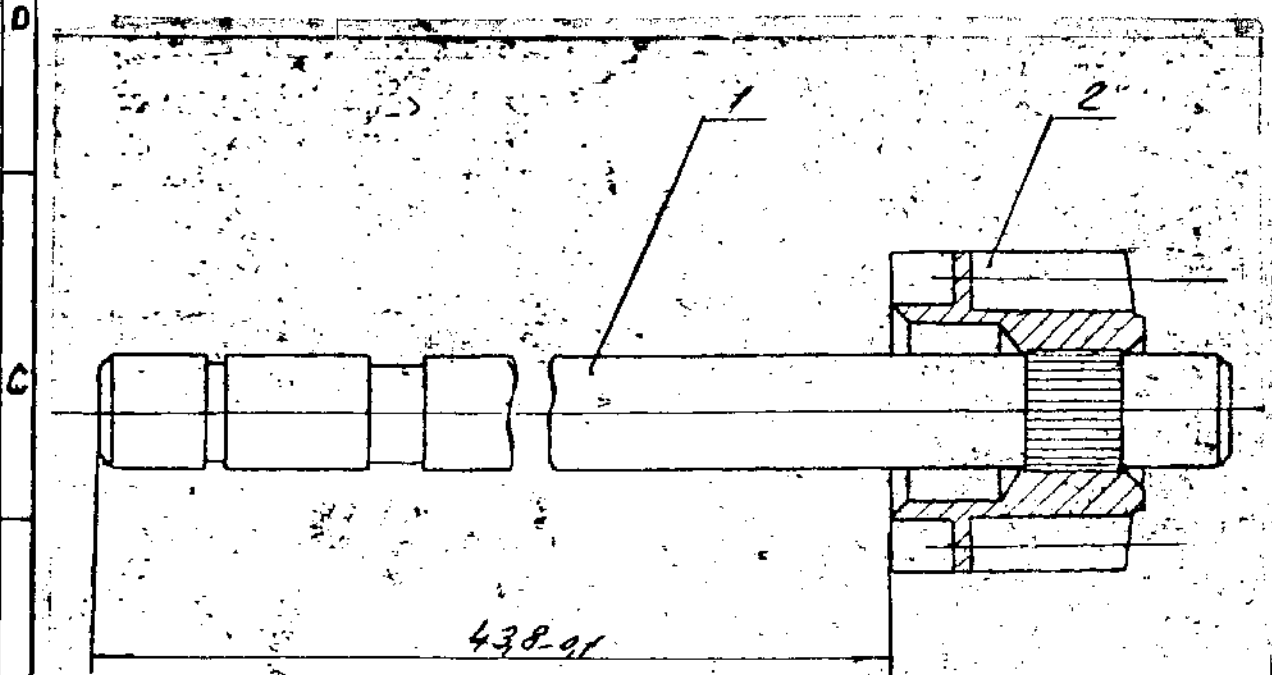

A1  
52

1515 KA A

PILOT SAMPLE SHOULD BE APPROVED BY A H S P BEFORE BULK PRODUCTION.

EST. MASS

4.5g

TO BE STAMPED OR MARKED WHERE INDICATED THUS #

( LETTERS)

ALL SHARP EDGES AND CORNERS TO BE REMOVED UNLESS OTHERWISE STATED MACHINED CORNERS TO HAVE R OUT-SIDE & INSIDE EQUIVALENT FRAMES AND REINFORCEMENT

MATERIAL

ALL SHARP EDGES & CORNERS TO BE ROUNDED OFF

ALL THREADS TO CONFORM TO SPECIFICATION

STAMP OR ETCH, PART NO. MANUFACTURERS NAME & YEAR OF MFR.

DRG. NOT TO BE SCALED

TOLERANCE ON DIMENSIONS UNLESS OTHERWISE SPECIFIED

USED ON:-

SCALE :- 5 : 1

DATE :- 22-7-97.

DRN.

WT :- (Kg)

TCD.

Cn 25 420 C5

CHD.

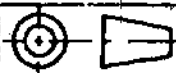

ROLLER AXLE ASSY.

APD.

CONTROLLERATE OF QUALITY ASSURANCE  
(INFANTRY COMBAT VEHICLES)

41/110



DRAWING NUMBER  
Cn 25 432 A

✓/✓/

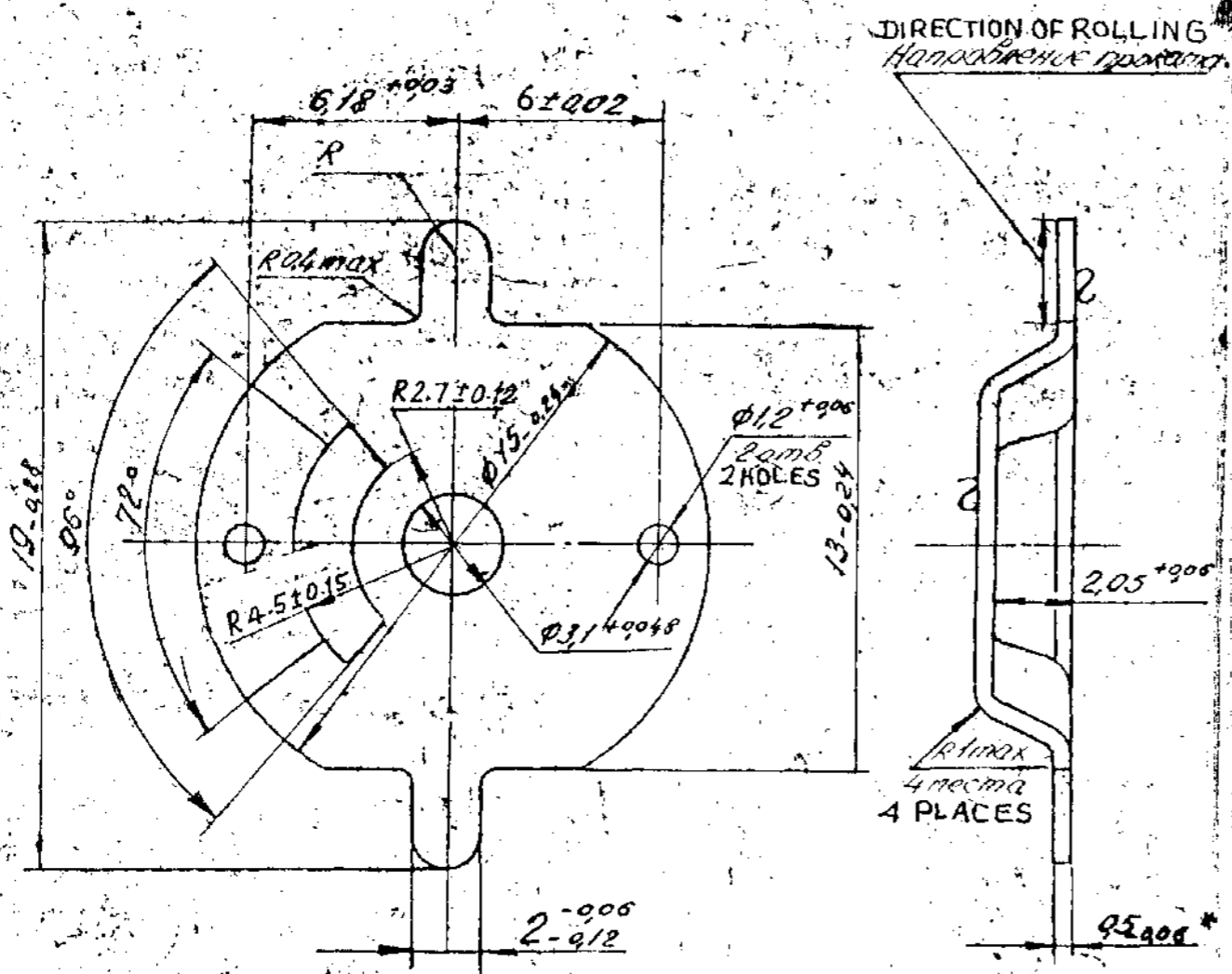

**EXPLANATORY NOTE:-**

5. REFERENCE MATERIAL QUOTED:- COLD ROLLED, SEMI-HARD NORMAL ACCURACY, 0.5 THICK BRASS STRIP GRADE Л63, GOST 2208-75. MANUFACTURED AS PER GOST 15527-70.

a) CHEMICAL COMPOSITION:- AS PER GOST 15527-70.

Gde. OF BRASS	BASIC ELEMENTS		ADMIX					TOTAL
	Cu	Zn	Pb	Fe	Sb	Bi	P	
Л63	62.0 65.0	REMAINING	0.07	0.2	0.005	0.002	0.01	0.5

b) MECHANICAL PROPERTIES:- AS PER GOST 2208-75.

Gde. OF BRASS	MATERIAL CONDITION	TENSILE STRENGTH Kgf/mm <sup>2</sup>	ELONGATION % MINIMUM
Л63	SEMI HARD	42-55	10

- \* DIMENSION FOR REFERENCE.
- UNSPECIFIED LIMIT DEVIATIONS OF DIMENSIONS AS PER PTM 37.453.001-71.
- COATING: CHEMICAL PASSIVATING.
- DIMENSIONS 2 <sup>-0.06</sup>/<sub>-0.12</sub> MAY BE INCREASED TO 1,96 mm.

PILOT SAMPLE SHOULD BE APPROVED BY A H S P BEFORE BULK PRODUCTION.

EST. MASS. 0.6g TO BE STAMPED OR MARKED WHERE INDICATED THUS # ( LETTERS)

ALL SHARP EDGES AND CORNERS TO BE REMOVED UNLESS OTHERWISE STATED MACHINED CORNERS TO HAVE R OUTSIDE R INSIDE EQUIVALENT CHAMFERS ARE PERMISSIBLE.

ISSUE	DATE	NATURE

MATERIAL :- BAND AN PHD 05 HA Л63, GOST 2208-75.

ALL SHARP EDGES & CORNERS TO BE ROUNDED OFF	ALL THREADS TO CONFORM TO SPECIFICATION	STAMP OR ETCH, PART NO. MANUFACTURERS NAME & YEAR OF MFR.
DRG. NOT TO BE SCALED	TOLERANCE ON DIMENSIONS UNLESS OTHERWISE SPECIFIED	USED ON:-
SCALE :- 5:1	WT :- (Kg)	Cn 25 432 A
DATE :- 22-7-97.	APD	CHEEK
DRN.	APD	
TCO.		

CONTROLLERATE OF QUALITY ASSURANCE  
(INFANTRY COMBAT VEHICLES) 97/110

A1  
58

4451SKA



DRAWING NUMBER  
Cп 106 002

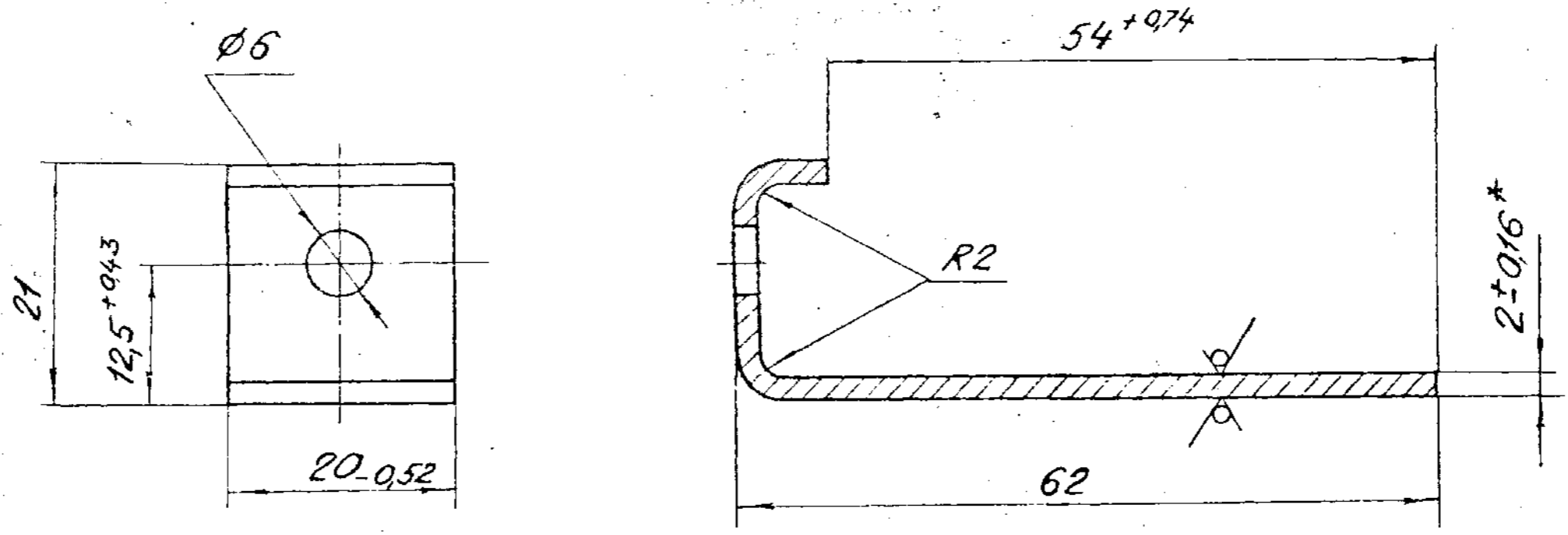

1. UNSPECIFIED LIMIT DEVIATIONS OF DIMENSIONS: FOR HOLES AS PER A7, OTHERS -AS PER CHD.
2. \* DIMENSIONS FOR REFERENCE.

CODE	DESIGNATION	COATING AND ADDITIONAL REQUIREMENTS
<i>Код</i> (A)	<i>Обозначение</i>	<i>Покрывтие и дополнительные требования</i> (B)
* 45 7392 1699	СП106-002	Ц 15 хр 4 Zn 15, CHROMATIZING.
45 7392 1702	СП106-002-Т	cd 21, CHROMATIZING. <i>Код 21 хр 4</i> Внешний вид по эталону APPEARANCE AS PER STANDARD PIECE.
45 7392 1701	СП106-002-Э	Zn 15 CHROMATIZING. <i>Ц 15 хр 4 внешне бесцветн- ное (B)</i> Внешний вид по эталону APPEARANCE AS PER STANDARD PIECE.

PILOT SAMPLE SHOULD BE APPROVED BY A H S P BEFORE BULK PRODUCTION.

EST. MASS. 27g	TO BE STAMPED OR MARKED WHERE INDICATED THUS # (LETTERS)
ALL SHARP EDGES AND CORNERS TO BE REMOVED UNLESS OTHERWISE STATED MACHINED CORNERS TO HAVE R OUT-SIDE R INSIDE EQUIVALENT CHAMFERS ARE PERMISSIBLE.	

ISSUE	DATE	NATURE OF AM

MATERIAL SHEET 19004-74		STAMP OR ETCH PART NO. MANUFACTURERS NAME & YEAR OF MFG.	
ALL SHARP EDGES & CORNERS TO BE REMOVED UNLESS OTHERWISE SPECIFIED		DRG. NOT TO BE SCALED	
SCALE 1- 2:1		DIMENSIONS ON DIMENSIONS UNLESS OTHERWISE SPECIFIED	
DATE 22-7-97		USED ON-	
DRN. <i>WJ</i>	WS 1- 100	СП 106 002	
CHD	APD	CLAMP	
CONTROLLER OF QUALITY ASSURANCE (INFANTRY COMBAT VEHICLES) 63/110			

DRAWING NUMBER

Cn 100 0115

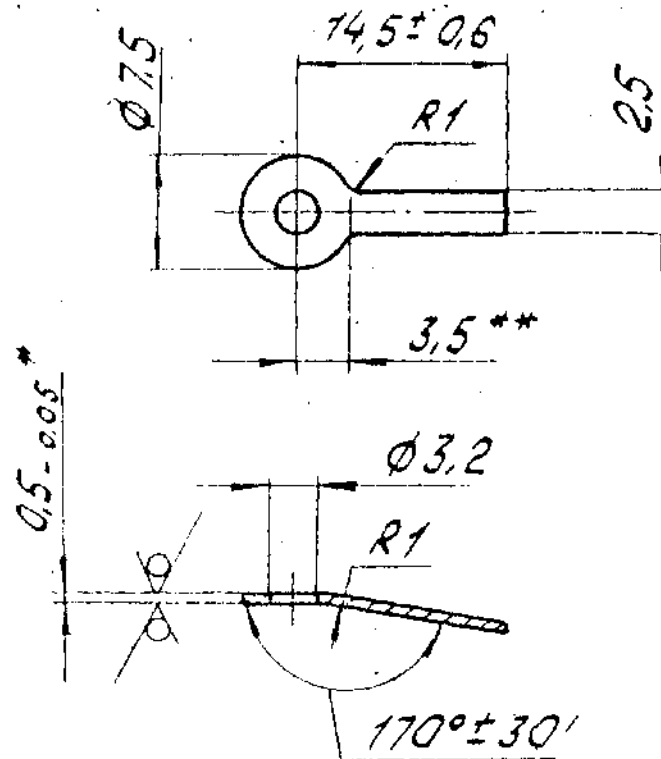

**EXPLANATORY NOTE:-**

3. REFERENCE MATERIAL QUOTED:- COLD ROLLED LOW CARBON STEEL EXTRA SOFT GROUP, NORMAL ACCURACY STEEL GROUP 0.5-0.05mm THICK GRADE 08Kn GOST 503-71.

a) CHEMICAL COMPOSITION:- AS PER GOST 1050-74.

Gde. OF STEEL	CONTENT OF ELEMENTS IN %						
	C	Si	Mn	Cr	Ni	S	P
	MAXIMUM						
08Kn	0.05 0.11	0.03 (Max)	0.25 0.50	0.10	0.25	0.04	0.035

b) MECHANICAL PROPERTIES:- AS PER GOST 503-71.

Gde. OF STEEL	CONDITION OF MATERIAL	U T S Kgf/mm <sup>2</sup>
08Kn	0M EXTRA SOFT	(25 TO 40)

CODE	DESIGNATION	COATING
<i>Kod</i>	<i>Обозначение</i>	<i>Покрытие</i>
457392 1222	СН100-0115	Zn6, CHROMATIZING 46.XP
457392 1223	СН100-0115-1	Cd9, CHROMATIZING Kd 9.XP

- \* DIMENSION FOR REFERENCE.
- \*\* DIMENSIONS ARE ENSURED BY TOOL.
- UNSPECIFIED LIMIT DEVIATIONS OF DIMENSIONS : FOR:  
SHAFTS - AS PER B7, HOLES - AS PER A7, OTHERS - AS PER CM 9.

PILOT SAMPLE SHOULD BE APPROVED BY A H S P BEFORE BULK PRODUCTION.

EST. MASS. 0.28g TO BE STAMPED OR MARKED WHERE INDICATED THUS: ( LETTERS)

ALL SHARP EDGES AND CORNERS TO BE REMOVED UNLESS OTHERWISE STATED MACHINED CORNERS TO HAVE R OUT-SIDE R INSIDE EQUIVALENT CHAMFERS ARE PERMISSIBLE.

MATERIAL :- BAND 08KN -0M-HT-2-0-0.5 GOST 503-71		
ALL SHARP EDGES & CORNERS TO BE ROUNDED OFF	ALL THREADS TO CONFORM TO SPECIFICATION	STAMP OR ETCH, PART NO. MANUFACTURER'S NAME & YEAR OF MFR.
ORG. NOT TO BE SCALED	TOLERANCE ON DIMENSIONS UNLESS OTHERWISE SPECIFIED	USED ON:-
SCALE :- 2:1		
DATE :- 22-7-97		
DRN FED. <i>Kam</i>	WT :- (Kg)	
CHD APP. <i>g</i>		СН 100 0115
		LIMITER

CONTROLLERATE OF QUALITY ASSURANCE

A-1  
90

44515 KA

SIZE : A3

ISSUE DATE NATURE OF AM





DRAWING NUMBER  
Cn 100 023

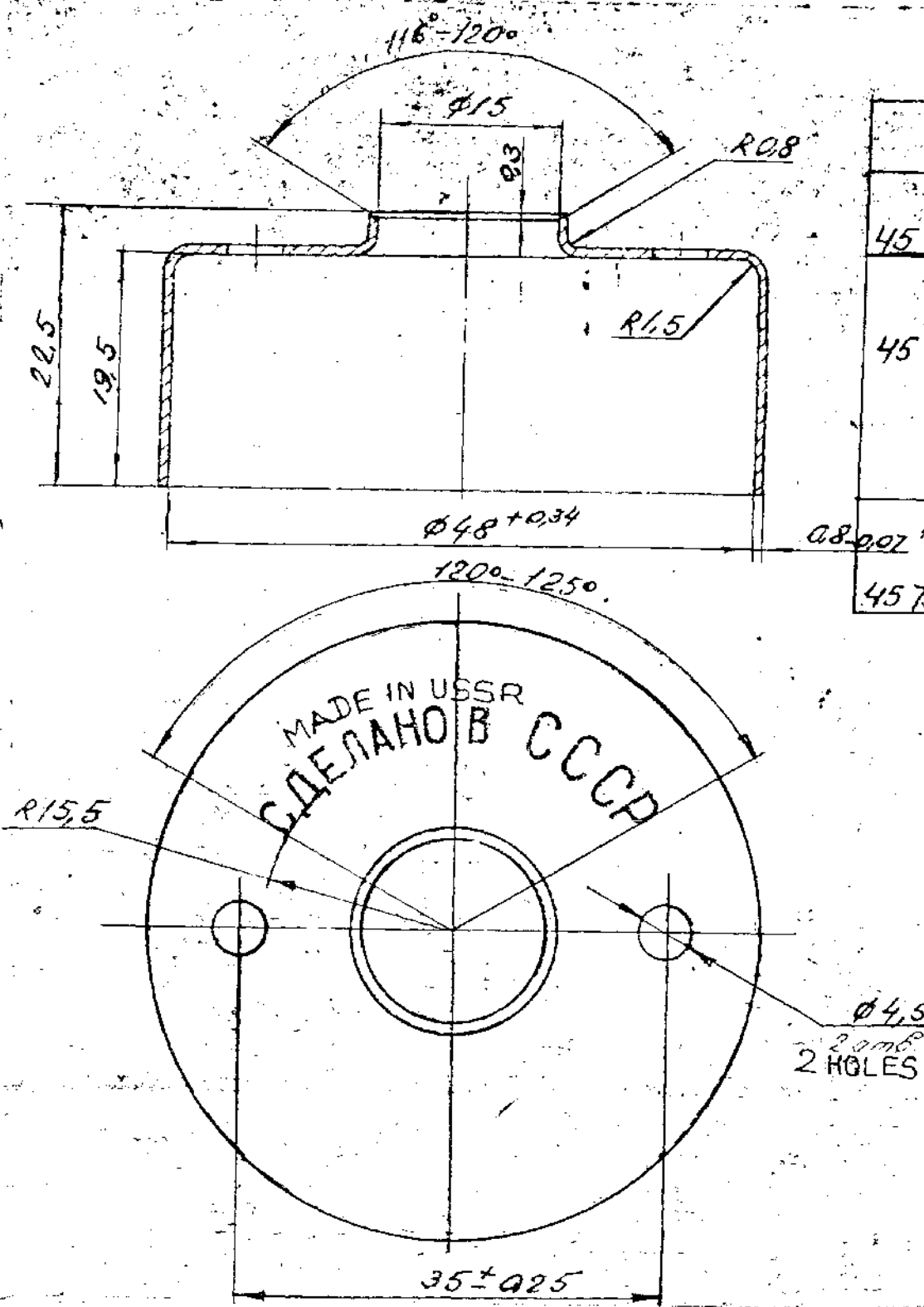

CODE Код	DESIGNATION Обозначение	COATING ADDITIONAL REQUIREMENTS Покрытие и другие нормативные требования
45 7392 1392	CN 100-023	Zn 15 CHROMATIZING ④ 15 XP
45 7392 1394	CN 100-023-7	③ Cd 15 CHROMATIZING EXTERNAL SURFACE COATING: COLOURLESS VARNISH Покрытие цинком по ГОСТ 23832-79 V T2 по ГОСТ 13-83 бесцветный ГОСТ 23832-79 V * T2 APPEARANCE AS PER STANDARD PIECE Внешний вид по стандарту
45 7392 1393	CN 100-023-3	④ 15 Zn 15 CHROMATIZING Внешний вид по стандарту APPEARANCE AS PER STANDARD PIECE

1. INSCRIPTION MADE IN... SHOULD BE POSITIONED SYMMETRICALLY, TYPE NO-3 GOST 2930-62. LETTER DEPTH 0.2mm.
2. UNSPECIFIED LIMIT DEVIATIONS OF DIMENSIONS: FOR  
SHAFTS - AS PER B7.  
HOLES - AS PER A7.  
OTHERS - AS PER CM7.
- 3\* DIMENSIONS FOR REFERENCE.

**EXPLANATORY NOTE:-**

4 REFERENCE MATERIAL QUOTED:- COLD ROLLED LOW CARBON STEEL EXTRA SOFT GROUP, NORMAL ACCURACY STEEL GROUP 0.8-0.07 THICK GRADE 08Kn GOST 503-71

a) CHEMICAL COMPOSITION:- AS PER GOST 1050-74.

Gde. OF STEEL	CONTENT OF ELEMENTS IN %						
	C	Si	Mn	Cr	Ni	S	P
08Kn	0.05 0.11	0.03 (Max)	0.25 0.50	0.10	0.25	0.04	0.035

b) MECHANICAL PROPERTIES:- AS PER GOST 503-71

Gde. OF STEEL	CONDITION OF MATERIAL	U T S Kgf/mm <sup>2</sup>
08Kn	OM EXTRA SOFT	(25 to 40)

PILOT SAMPLE SHOULD BE APPROVED BY A H S P BEFORE BULK PRODUCTION.

EST. MASS. 28g	TO BE STAMPED OR MARKED WHERE INDICATED THUS # ( LETTERS)
-------------------	--

ALL SHARP EDGES AND CORNERS TO BE REMOVED UNLESS OTHERWISE STATED MACHINED CORNERS TO HAVE R OUTSIDE R INSIDE EQUIVALENT CHAMFERS ARE PERMISSIBLE.

ISSUE	DATE	NATURE OF AMEND

MATERIAL: BAND 08Kn-OM-UT-2-D-0.8, GOST 503-71		
ALL SHARP EDGES & CORNERS TO BE ROUNDED OFF	ALL THREADS TO CONFORM TO SPECIFICATION	STAMP OR ETCH, PART NO. MANUFACTURERS NAME & YEAR OF MFR.
ORG. NOT TO BE SCALED	TOLERANCE ON DIMENSIONS UNLESS OTHERWISE SPECIFIED	USED ON:- Cn 110 3802010 CB
SCALE :- 2:1	DATE :- 22-7-97	DRN: [Signature] WT :- (Kg)
CD: [Signature]	CHD: [Signature]	APD: [Signature]
Cn 100 023 COVER		

CONTROLLERATE OF QUALITY ASSURANCE  
(INFANTRY COMBAT VEHICLES) 69/110

DRAWING NUMBER

Cn 100 024

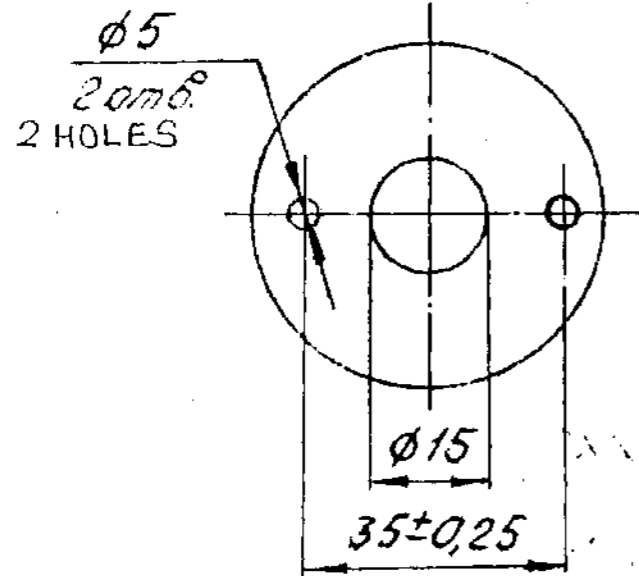
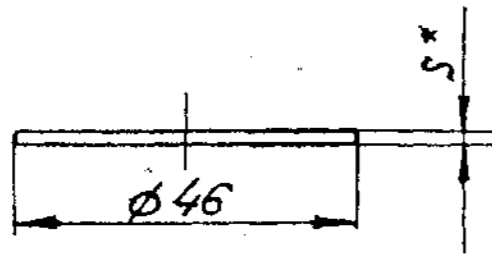

CODE	DESIGNATION	MATERIAL	MASS g	S* MM
45 7392 1307	CN100-024	PAPER BASED LAMINATE I-1 GOST 2718-74	2.1	1±0.13
45 7392 1308	CN 100-024-T	GLASS-CLOTH BASED LAMINATE CT3Φ-I-1 GOST 12652-74	2.5	1±0.25

- \* DIMENSION FOR REFERENCE.
- UNSPECIFIED LIMIT DEVIATIONS OF DIMENSIONS: FOR  
HOLE -AS PER A7  
SHAFTS- AS PER B7.

A1  
99

44515 K<sup>4</sup>

PILOT SAMPLE SHOULD BE APPROVED BY A H S P BEFORE BULK PRODUCTION.

EST. MASS. TO BE STAMPED OR MARKED WHERE INDICATED THUS # (LETTERS)

ALL SHARP EDGES AND CORNERS TO BE REMOVED UNLESS OTHERWISE STATED MACHINED CORNERS TO HAVE R OUT-SIDE R INSIDE EQUIVALENT CHAMFERS ARE PERMISSIBLE.

ISSUE	DATE	NATURE OF AMEND

MATERIAL :+ SEE TABLE		
ALL SHARP EDGES & CORNERS TO BE ROUNDED OFF	ALL THREADS TO CONFORM TO SPECIFICATION	STAMP OR ETCH, PART NO. MANUFACTURERS NAME & YEAR OF MFR.
DRG. NOT TO BE SCALED	TOLERANCE ON DIMENSIONS UNLE -SS OTHERWISE SPECIFIED	USED ON:- CN 110 380 2010CB
SCALE :- 1:1	DATE :- 22-7-97	WT :- (Kg)
DRN.	WT :- (Kg)	CN 100 024
TCO.	WT :- (Kg)	GASKET
CHD.	WT :- (Kg)	GASKET
APD.	WT :- (Kg)	GASKET

CONTROLLERATE OF QUALITY ASSURANCE  
(INFANTRY COMBAT VEHICLES)

70/110

DRAWING NUMBER

Cn 100 028

Rz 80

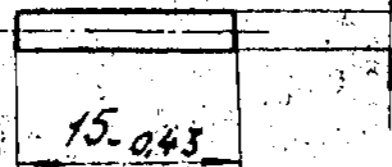

CODE	DESIGNATION	VARIABLE DATA
		COATING
45 7392 1639	Cn 100-028	Zn9, CHROMATIZING, COLOURLESS FILM
45 7392 1641	Cn 100-028-T	Cd9, CHROMATIZING,

DENTS MADE DURING CUTTING ARE ALLOED ON THE ENDS OF PIN IF  $\phi 2$  MAX IS ENSURED ON 1mm MAX LENGTH.

PILOT SAMPLE SHOULD BE APPROVED BY A H S P BEFORE BULK PRODUCTION.

EST. MASS. 0.28g TO BE STAMPED OR MARKED WHERE INDICATED THUS # ( LETTERS)

ALL SHARP EDGES AND CORNERS TO BE REMOVED UNLESS OTHERWISE STATED MACHINED CORNERS TO HAVE R OUT-SIDE R INSIDE EQUIVALENT CHAMFERS ARE PERMISSIBLE.

ISSUE	DATE	NATURE OF

MATERIAL :- WIRE 2-10 GOST 5663-79		
ALL SHARP EDGES & CORNERS TO BE ROUNDED OFF	ALL THREADS TO CONFORM TO SPECIFICATION	STAMP OR ETCH, PART NO. MANUFACTURERS NAME & YEAR OF MFR.
DRG. NOT TO BE SCALED	TOLERANCE ON DIMENSIONS UNLE -SS OTHERWISE SPECIFIED	USED ON:- Cn 110 380 2010 CB
SCALE :- 2 : 1	DRN. <del>Done</del> WT :- (Kg)	Cn 100 028
DATE :- 22-7-97	TCD. <del>Done</del>	PIN
CHD.	APD. <del>Done</del>	

CONTROLLERATE OF QUALITY ASSURANCE (INFANTRY COMBAT VEHICLES)

72/110

A1 / 105

44515K<sup>h</sup>

SIZE A3





DRAWING NUMBER  
Cn 100 200 C5

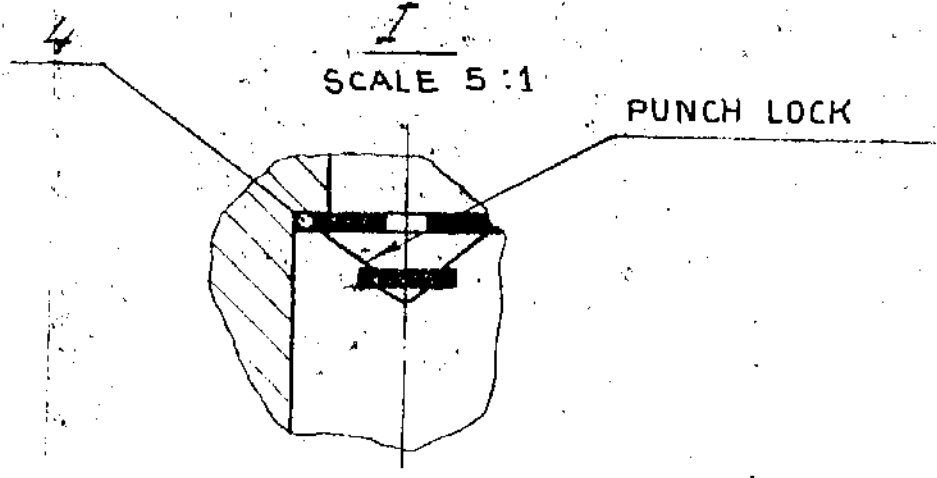
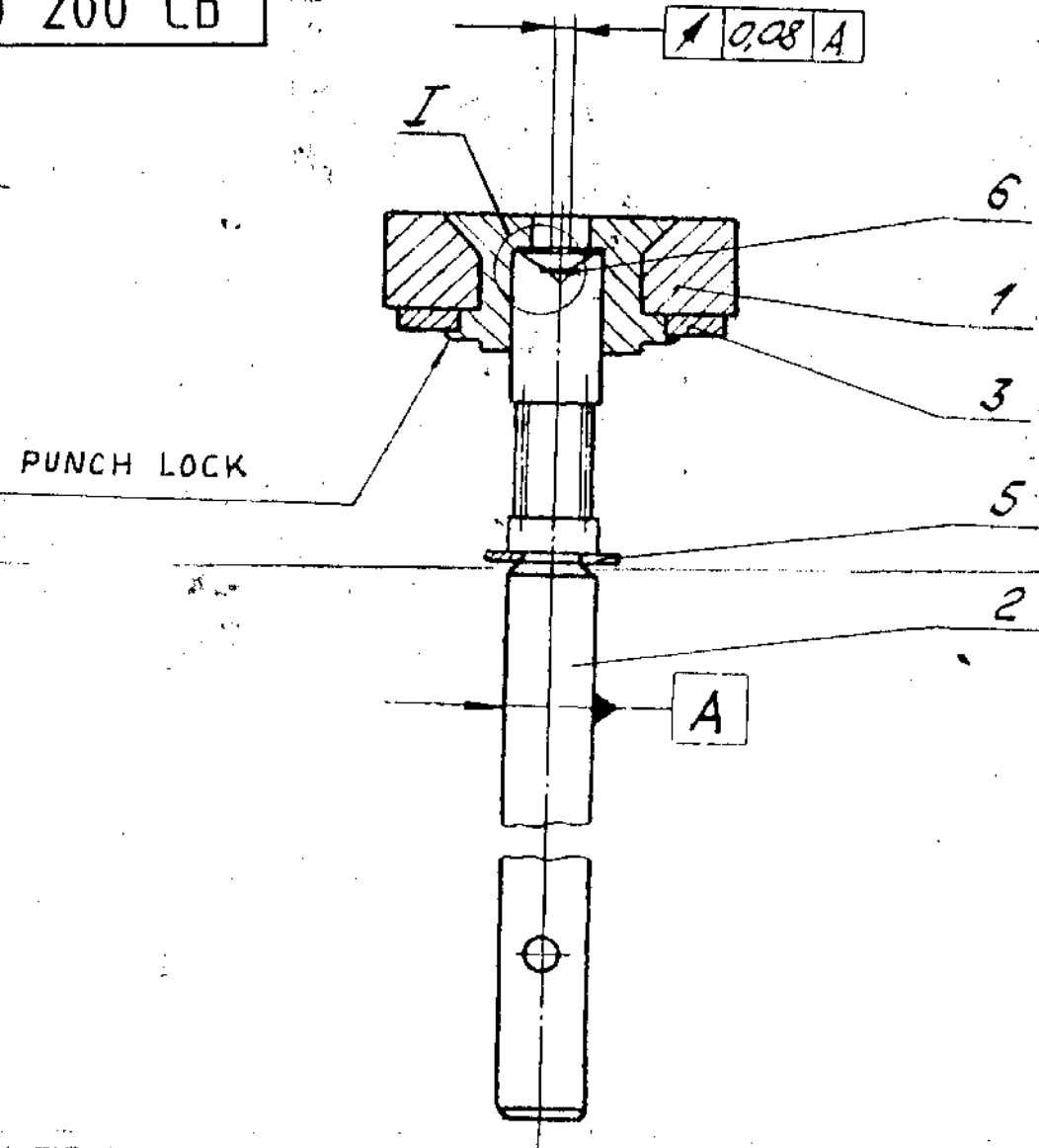

1. MAGNET IS A FOUR-POLE TYPE.
2. MAGNETIZE TO SATURATION.
3. FILL THE SPACE BETWEEN THRUST PLATE 6 AND BEARING 4 WITH IS-OPERAFFIN OIL 1, TY 38.40.128-71.

KOD CODE	DESIGNATION
457392 1735	СП100-200С5
457392 1736	СП100-200-3 С5
457392 1737	СП100-200-Т С5

PILOT SAMPLE SHOULD BE APPROVED BY A H S P BEFORE BULK PRODUCTION.

EST. MASS. 38g TO BE STAMPED OR MARKED WHERE INDICATED THUS # ( LETTERS)

ALL SHARP EDGES AND CORNERS TO BE REMOVED UNLESS OTHERWISE STATED MACHINED CORNERS TO HAVE R OUTSIDE R INSIDE EQUIVALENT CHAMFERS ARE PERMISSIBLE.

ISSUE	DATE	NATURE OF AM

MATERIAL :-		
ALL SHARP EDGES & CORNERS TO BE REMOVED	ALL THREADS TO CONFORM TO SPECIFICATION	STAMP OR ETCH, PART NO. MANUFACTURERS NAME & YEAR OF MFR.
DRG. NOT TO BE SCALED	TOLERANCE ON DIMENSIONS UNLESS OTHERWISE SPECIFIED	USED ON:- СП 110 3802010 С5
SCALE: 2:1	DATE: 22-7-97	СП 100 200 С5
DATE: 22-7-97	WT: 38g	MAGNET AXLE ASSY
CONTROLLERATE OF QUALITY ASSURANCE (INFANTRY COMBAT VEHICLES)		

A1  
22

44515KA

SIZE A3



DRAWING NUMBER

Cn 100 202

S 1.2-0.10 \*

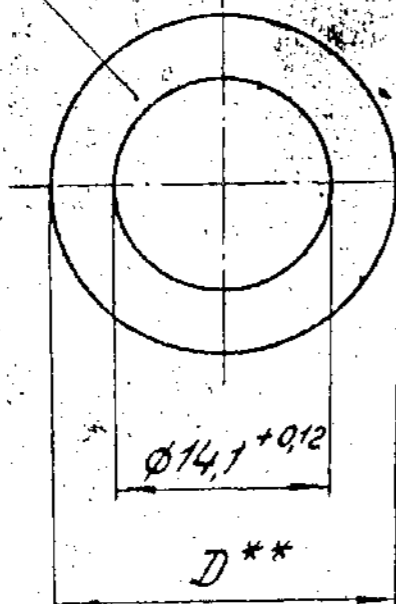

- \* DIMENSION FOR REFERENCE.
- \*\* COMPENSATOR EXTERNAL DIAMETER D MAY VARY DEPENDING ON MAGNETIC PROPERTIES OF MATERIAL. THIS DIAMETER MAY BE 22-0.14 ; 23-0.14 ; 23,5-0.14 ; (ACCORDING TO INSTRUCTIONS OF CHIEF METALLURGIST DEPARTMENT LAB).

PILOT SAMPLE SHOULD BE APPROVED BY A H S P BEFORE BULK PRODUCTION.

EST. MASS  
2.5g

TO BE STAMPED OR MARKED WHERE INDICATED THUS # (LETTERS)

ALL SHARP EDGES AND CORNERS TO BE REMOVED UNLESS OTHERWISE STATED MACHINED CORNERS TO HAVE R OUTSIDE R INSIDE EQUIVALENT CHAMFERS ARE PERMISSIBLE

① KOD CODE	DESIGNATION ОБОЗНАЧЕНИЕ	PULLING-TORQUE OF MOVABLE SYSTEM BY ONE ТЯГОВОЙ МОМЕНТ ПОДВИЖНОЙ СИСТЕМЫ REVOLUTION OF THE DRIVE SHAFT HQ ODLH OOOPOM ПРИБОРОГО ВОЛЖКА	
		N. M	mg M2 CM
45 7392 1481	CN 100-202	(16,856 ÷ 16,954) · 10 <sup>-8</sup>	1,72 ÷ 1,73
45 7392 3015	CN 102-124	(11,368 ÷ 11,564) · 10 <sup>-8</sup>	1,16 ÷ 1,18
45 7385 1566	TX 131-132	(16,66 ÷ 16,758) · 10 <sup>-8</sup>	1,7 ÷ 1,71

### EXPLANATORY NOTE:-

3. REFERENCE MATERIAL QUOTED: COLD ROLLED BAND MADE OF THERMO-MAGNETIC ALLOY 30HF 1.2mm THICKNESS TO TY 14 - 1 - 1168-75.

a) CHEMICAL COMPOSITION:-

GRADE OF ALLOY	C	Si	Mn	S	P	Ni	Fe
30HF	0.05 (MAX)	0.5 (MAX)	1.50 - 2.50	0.025 (MAX)	0.030 (MAX)	29.5 - 31.5	MAJOR PART

b) MAGNETIC PROPERTIES OF ALLOY:-

THICKNESS mm	MAGNETIC INDUCTION B CRAUSS IN THE FIELD OF 100° OERSTED AT TEMPERATURES			MAGNETIC INDUCTION DIFFERENCE CRAUSS			
	-20°C	+20°C	+35°C	B -20°C	-B +20°C	B +20°C	-B +35
1.2	3900 ÷ 5700	2100 ÷ 3500	1600 ÷ 2800	1500 - 2100	350 - 1300		

MATERIAL :- BAND 30-HF 1.2, TY 14-1-1168-75

ALL THREADS TO CONFORM TO SPECIFICATION	STAMP OR ETCH, PART NO. MANUFACTURERS NAME & YEAR OF MFR.
TOLERANCE ON DIMENSIONS UNLESS OTHERWISE SPECIFIED	USED ON:- CN 100 20026
CN 100 202	
COMPENSATOR	

CONTROLLERATE OF QUALITY ASSURANCE  
(INFANTRY COMBAT VEHICLES) 80/110

ISSUE DATE NATURE OF AME







ITEM	DRAWING NUMBER	D S CAT NUMBER	DESCRIPTION	No. OFF	REMARKS
	Cn 100 210 CB		MAGNETIC UNIT ASSY		
1	Cn 100 211		MAGNET	1	REFER CASTING DRG NO АЖБ 01.11408
2	En 100 212		BUSH ALLOY УА4 GOST19424-74	1	WITHOUT DRG.
			ALTERNATIVE MATERIAL ALLOY УАМ 4-1 GOST 19424-74		MASS 6g
	АЖБ 01 11408		MAGNET (CASTING)		THIS DRAWING RELATES TO Cn 100 211

DC(1) NO DATE	ISSUE	NATURE OF AMENDMENTS	DC(1) NO DATE	ISSUE	NATURE OF AMENDMENTS
DRN	<del>2000</del>	СП 100 210 CB			DATE:- 23-7-97
TCD	<del>2000</del>				USED ON-СП100-200CB
CHD		MAGNET UNIT ASSY			SHEET 1   SHEETS 1
APPD	<del>2000</del>				OF 28/110

CONTROLLERATE OF QUALITY ASSURANCE (ICV)

DRAWING NUMBER

Сп 100 210СБ

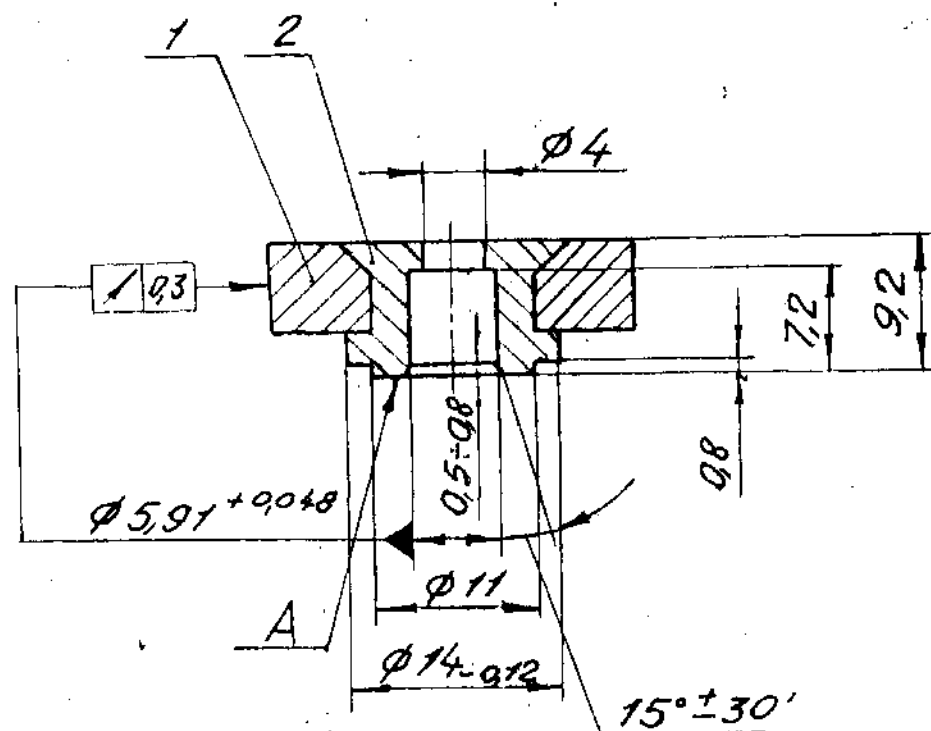

KOD CODE	DESIGNATION 0003H040H0E	CORTIND ПОКРЫТИЕ
4573921986	СП100-210-3	ХРОМАТИЗИНГ Хр.

1. UNSPECIFIED LIMIT- DEVIATIONS OF DIMENSIONS FOR:

HOLES - AS PER A5

SHAFTS - AS PER B5

OTHERS - AS PER CM5.

2. 4 DIMENTRICALLY OPOSED DISTINGUISHING PROJECTIONS ARE ALLOWED ON SURFACE A, WIDTH OF PROJECTIONS - 0,4 TO 0,6 mm, HEIGHT OF PROJECTIONS - 0,3 TO 0,5mm.

A1  
24

PILOT SAMPLE SHOULD BE APPROVED BY A H S P BEFORE BULK PRODUCTION.

EST. MASS.

20g

TO BE STAMPED OR MARKED WHERE INDICATED THUS: #

( LETTERS)

ALL SHARP EDGES AND CORNERS TO BE REMOVED UNLESS OTHERWISE STATED MACHINED CORNERS TO HAVE R OUTSIDE R INSIDE EQUIVALENT CHAMFERS ARE PERMISSIBLE.

MATERIAL	ALL SHARP EDGES & CORNERS TO BE ROUNDED	ALL THREADS TO CONFORM TO SPECIFKATION	STAMP OR ETCH, PART NO. MANUFACTURERS NAME & YEAR OF MFR.
ORG. NOT TO BE SCALED	SCALE :- 2:1	TOLERANCE ON DIMENSIONS UNLE -SS OTHERWISE SPECIFIED	USED ON:- СП 100 200СБ
DATE :- 22-7-97	DRN. <i>Bev</i>	WT :- (Kg)	СП 100 210СБ
TCO. <i>Bev</i>	ENG.	APD. <i>Bev</i>	MAGNET UNIT ASSY

CONTROLLERATE OF QUALITY ASSURANCE  
(INFANTRY COMBAT VEHICLES)

29/110

SIZE A3

ISSUE DATE NATURE OF

DRAWING NUMBER

Cn 100 211

Rz 320

✓(✓)

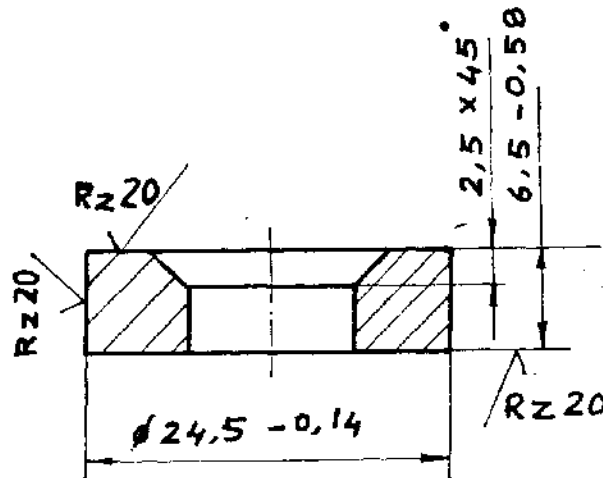

NOTE: REFER CASTING DRAWING No. ДЖБ 01-1-1408.

A1  
25

44515KР

NEAREST EQVT MATERIAL

CASTING ДЖБ 01-1-1408

ORGL MATERIAL

DC(I)No  
A DATE

ISSUE

AMENDMENTS

ALL SHARP EDGES & CORNERS TO BE ROUNDED OFF.

ALL THREADS TO CONFORM TO SPECIFICATION.

STAMP OR ETCH, PART NO, MANUFACTURER'S NAME & YEAR OF MFR.

DRG. NOT TO BE SCALED

SCALE:- 2 : 1

TOLERANCE ON DIMENSIONS UNLESS OTHERWISE SPECIFIED

USED ON:-

CN 100 210C5

DRN. ~~Boon~~

WT : 15 (kg)

MAGNET

TCD. ~~Boon~~

15 g

CHD.

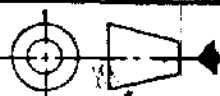

DRAWING NO

CN 100 211

APD. ~~Boon~~

CONTROLLERATE OF QUALITY  
(INFANTRY COMBAT VEHICLE)



DRAWING NUMBER  
Cn 100 3005 C6

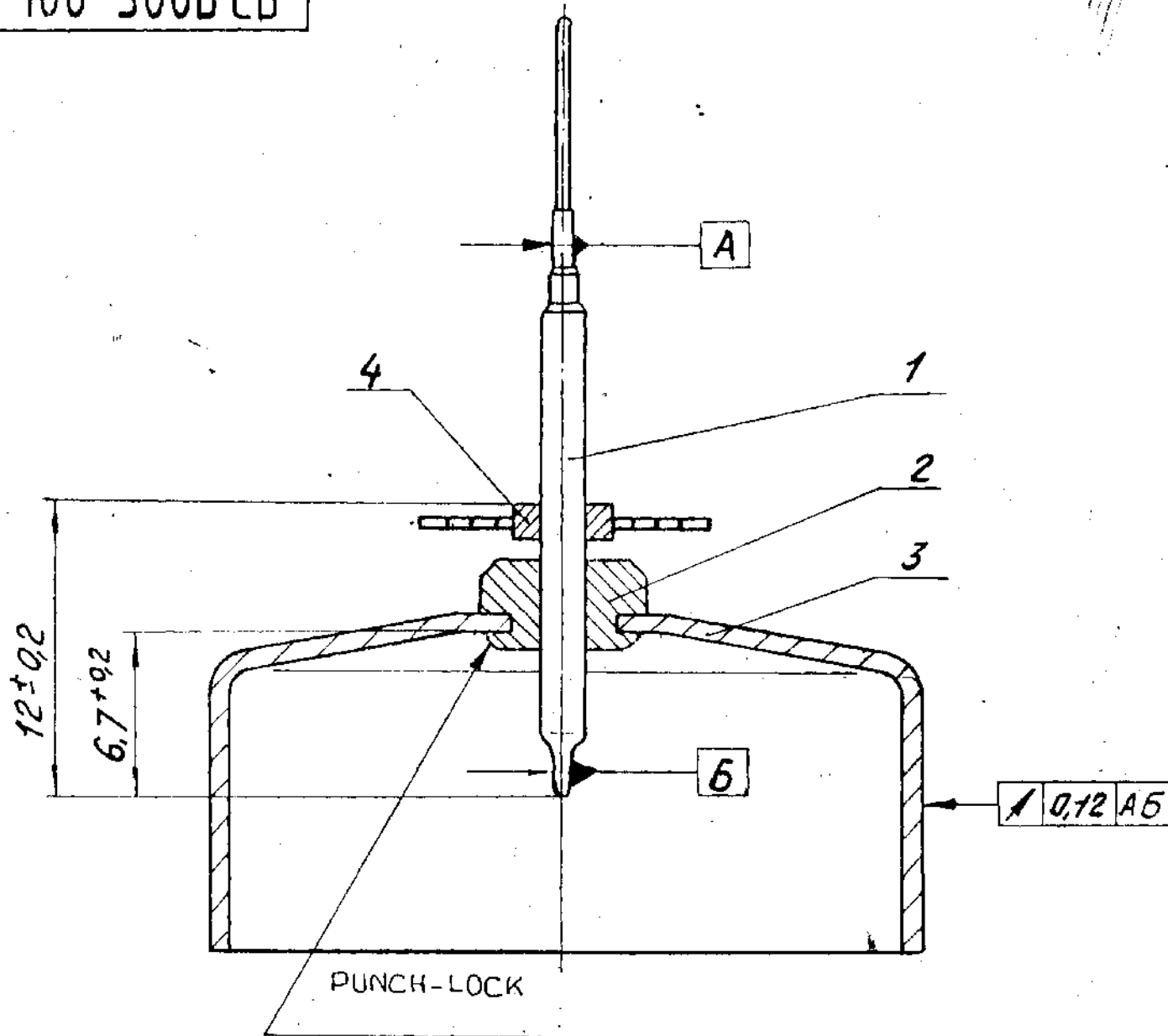

CODE K00	DESIGNATION
45 7392 1584 C6	C7100-3005 C6
45 7392 1585 C6	C7100-3005-3 C6
45 7392 1586 C6	C7100-3005-T C6
45 7385 1355 C6	TX100-3005 C6
45 7385 1361 C6	TX100-3005-3 C6
45 7385 1362 C6	TX100-3005-T C6
	12.3813300 C6
	12.3813300-3 C6
	12.3813300-T C6

Balance the ring by dressing away the metal.

A1  
35

44515KД

PILOT SAMPLE SHOULD BE APPROVED BY A H S P BEFORE BULK PRODUCTION.

EST. MASS. 44g TO BE STAMPED OR MARKED WHERE INDICATED THUS # LETTERS)

ALL SHARP EDGES AND CORNERS TO BE REMOVED UNLESS OTHERWISE STATED MACHINED CORNERS TO HAVE R OUTSIDE R INSIDE EQUIVALENT CHAMFERS ARE PERMISSIBLE.

ISSUE	DATE	NATURE OF AMEND

MATERIAL		STAMP OR ETCH, PART NO.
ALL SHARP EDGES & CORNERS TO BE ROUNDED OFF	ALL THREADS TO CONFORM TO SPECIFICATION	MANUFACTURERS NAME & YEAR OF MFR.
DRG. NOT TO BE SCALED	TOLERANCE ON DIMENSIONS UNLESS OTHERWISE SPECIFIED	USED ON:-
SCALE :- 1:1		Cn 110 380 2010 C6
DATE :- 22-7-97		
DRN. <i>[Signature]</i>	WT :- (Kg)	Cn 100 3005 C6
TCO. <i>[Signature]</i>		RING ASSY
CHD. <i>[Signature]</i>		
APD. <i>[Signature]</i>		

CONTROLLERATE OF QUALITY ASSURANCE  
(INFANTRY COMBAT VEHICLES)

31/110

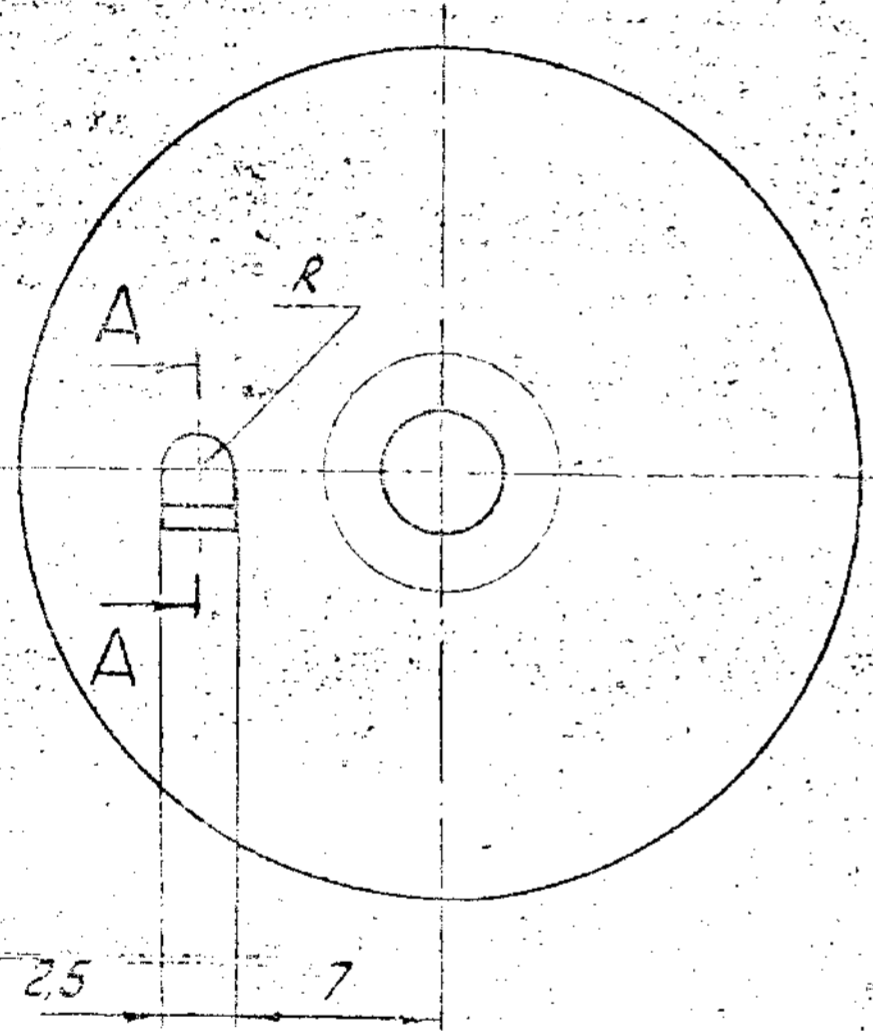
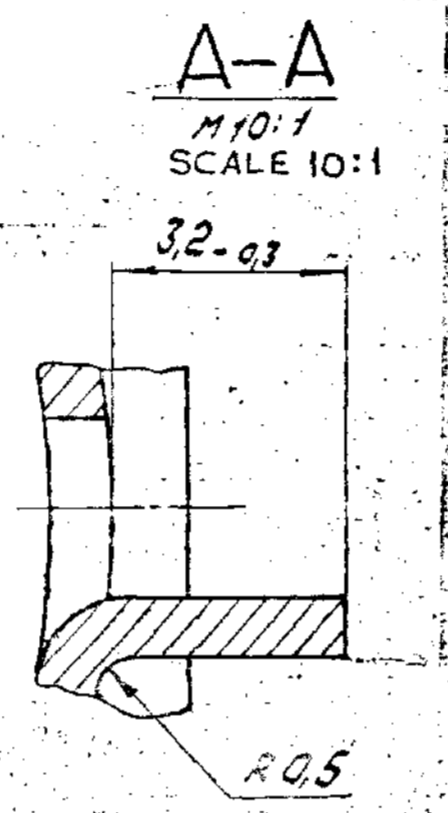
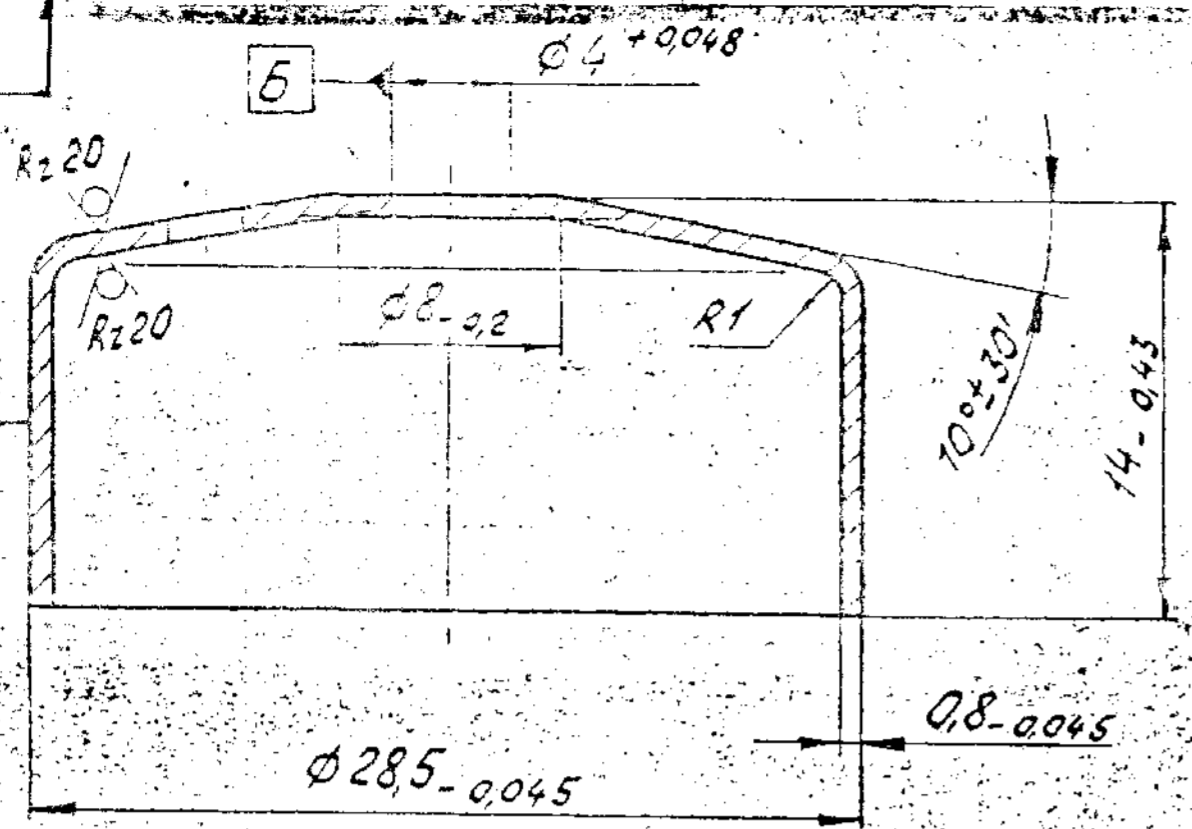

1. ALTERNATE MATERIAL: SHEET ALUM-III-I, GOST 21631-76.
2. MANUFACTURE BY ROLLING.
3. UNSPECIFIED LIMIT DEVIATIONS OF DIMENSIONS FOR:
  - SHAFTS - AS PER B 7
  - OTHERS - AS PER CM7.

**EXPLANATORY NOTE:-**

4. REFERENCE MATERIAL QUOTED:- ALUMINIUM AND ALUMINIUM ALLOY STRIPS 0.8mm. THICK GRADE A51 IN THE ANNEALED CONDITION TO GOST 13726-78.

a) CHEMICAL COMPOSITION:-

Gde. OF ALLOY	ALLOYING COMPONENT	IMPURITIES MAXIMUM								
		Fe	Si	Cu	Mn	Zn	Ti	rig	OTHERS EACH	TOTAL
A51	99.30MIN)	0.30	0.30	0.05	0.025	0.1	0.15	0.05	0.05	0.70

b) MECHANICAL PROPERTIES:-

Gde. OF STEEL	CONDITION OF MATERIAL	U T S	RELATIVE
		Kgf/mm <sup>2</sup>	ELONGATION %
		MINIMUM	
A51	ANNEALED	58.8 (60)	28

CODE	DESIGNATION	COATING AND ADDITIONAL REQUIREMENTS
код	обозначение	покрытие и дополнительные требования
45 7392 1587	СП100-3015	—
45 7392 1588	СП100-3015-Э	APPEARANCE ACCORDING TO STANDARD ITEM. ВНЕШНИЙ ВИД ПО ЭТЭЛОНУ.
45 7392 1589	СП100-3015-Т	ANODIC OXIDATION CHROMATIZING АНОДНОЕ ХРОМ. ПОКР. APPEARANCE ACCORDING TO STANDARD ITEM. ВНЕШНИЙ ВИД ПО ЭТЭЛОНУ.

PILOT SAMPLE SHOULD BE APPROVED BY A H S P BEFORE BULK PRODUCTION

EST. MASS. 3.4g TO BE STAMPED OR MARKED WHERE INDICATED THIS # LETTERS)

ALL SHARP EDGES AND CORNERS TO BE REMOVED UNLESS OTHERWISE STATED MACHINED CORNERS TO HAVE R OUTSIDE R INSIDE EQUIVALENT CHAMFERS ARE PERMISSIBLE.

GOST 13726-78

ORGL MATERIAL BAND AAIMI	DC (No & DATE)	ISSUE	AMENDMENTS
ALL SHARP EDGES & CORNERS TO BE ROUNDED OFF.	DRG. NOT TO BE SCALED	ALL THREADS TO CONFORM TO SPECIFICATION.	STAMP OR ETCH, PART NO. MANUFACTURER'S NAME & YEAR OF MFG.
SCALE:- 4:1	DATE :- 22-7-97	TOLERANCE ON DIMENSIONS UNLESS OTHERWISE SPECIFIED	USED ON:-
DRN. <i>[Signature]</i>	WT :- (Kg)	<b>RING</b>	
ICD. <i>[Signature]</i>		DRAWING NO CN 100 301 5	PART NO
CHD. <i>[Signature]</i>		<b>CONTROLLERATE OF QUALITY ASSURANCE (INFANTRY COMBAT VEHICLES) 87/100</b>	
AID. <i>[Signature]</i>			





DRAWING NUMBER  
 Сп 110 380 2010Г4

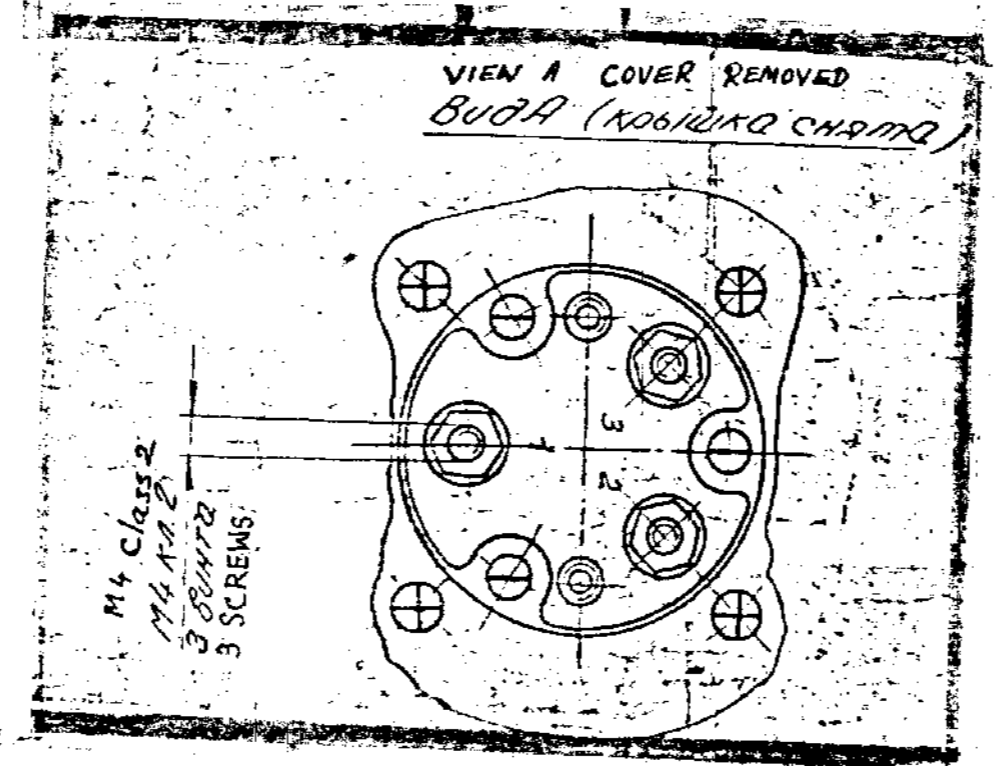
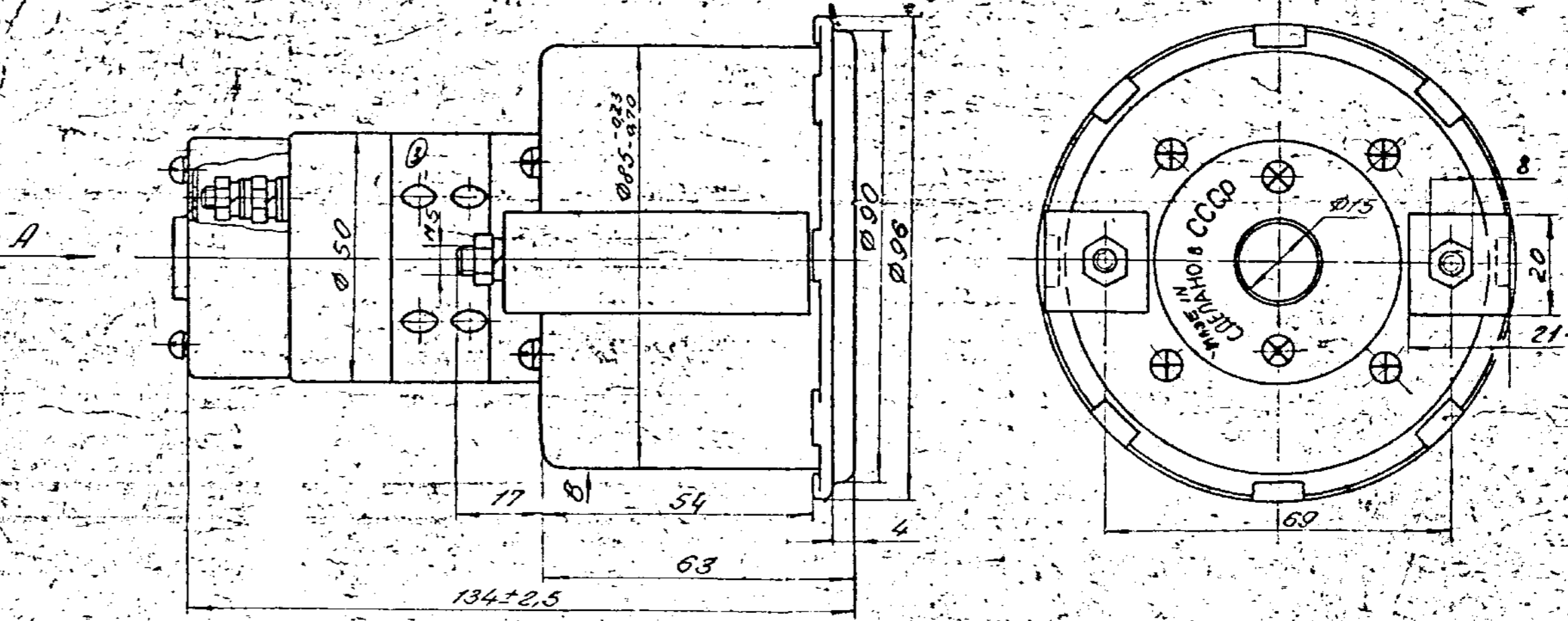
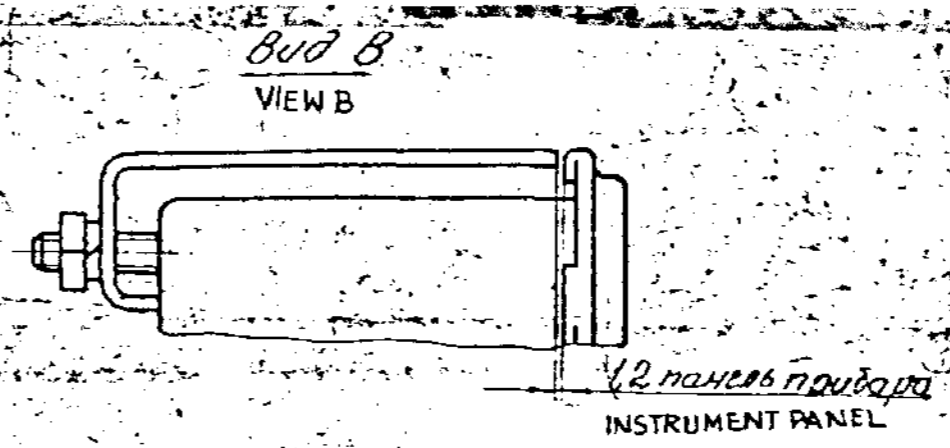
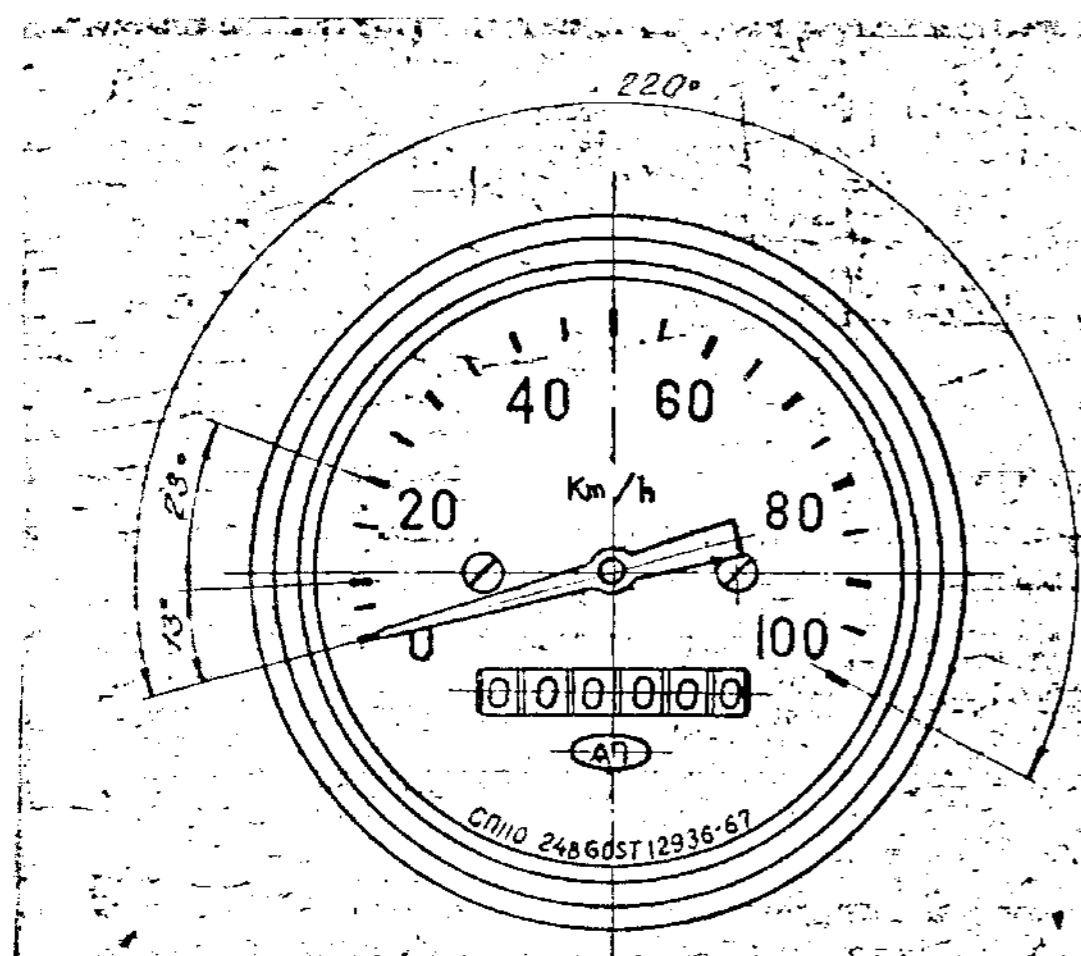

0003100-0000 DESIGNATION OF DRAWING 4000000000 DESIGNATION OF DRAWING	0003100-0000 MAIN SPECS 0000000000	0003100-0000 ADDITIONAL SPECS 0000000000	0003100-0000 DESIGNATION FOR ORDER
СП110-3802010Г4	GHOST		СП110
СП110-3802010Г4-7	10CT12936-67	05T-37003008-72	СП110-7
СП110-3802010Г4-2		05T37003024-74 10CT12936-67	СП110-8

1. ANGLES TOLERANCE  $\pm 2^\circ$ .
2. DIAL BACK GROUND IS BLACK.
3. DIAL MARKS, DIGITS AND INSCRIPTIONS ARE WHITE.
4. POINTER IS WHITE, DIAL RIM IS BLACK.
5. ROLLER DIGITS ARE BLACK; ROLLER BACKGROUND IS WHITE; FIRST ROLLER DIGITS ARE RED OVER WHITE BACK GROUND.
6. GEAR RATIO BETWEEN 1<sup>st</sup> ROLLER OF THE ODOMETER AND SPEEDOMETER DRIVING SHAFT IS 624:1 i.e., 624 REVOLUTIONS OF THE DRIVING SHAFT CORRESPOND TO 1 Km DISPLAYED ON THE ODOMETER.
7. CONNECT THE SPEEDOMETER CH-110 TO THE SENDING UNIT ACCORDING TO THE DIAGRAM, SHOWN IN THE LAY OUT DRAWING OF THE SENDING UNIT.
8. THE INSTRUMENT IS MANUFACTURED DUST-PROOF.

EST. MASS 1.1Kg  
 TO BE STAMPED OR MARKED WHERE INDICATED THUS # LETTERS)  
 ALL SHARP EDGES AND CORNERS TO BE REMOVED UNLESS OTHERWISE STATED MACHINED CORNERS TO HAVE R OUTSIDE R INSIDE EQUIVALENT CHAMFERS ARE PERMISSIBLE

ISSUE	DATE	NATURE OF AMEND

MATERIAL: ALL SHARP EDGES & CORNERS TO BE REMOVED ORG. NOT TO BE BEALED

SCALE: 1:1  
 DATE: 22-7-97

STAMP OR ETCH, PART NO. MANUFACTURERS NAME & YEAR OF MFG.  
 USED ON: СП110 380 2010Г4

СП110 380 2010 Г4  
 SPEEDOMETER INDICATOR СП1106  
 OUTLINE DRAWING

CONTROLLEER OF QUALITY ASSURANCE (INFANTRY COMBAT VEHICLES) 19/110

DRAWING NUMBER  
Cn 100 501A

Rz 40  
✓(✓)

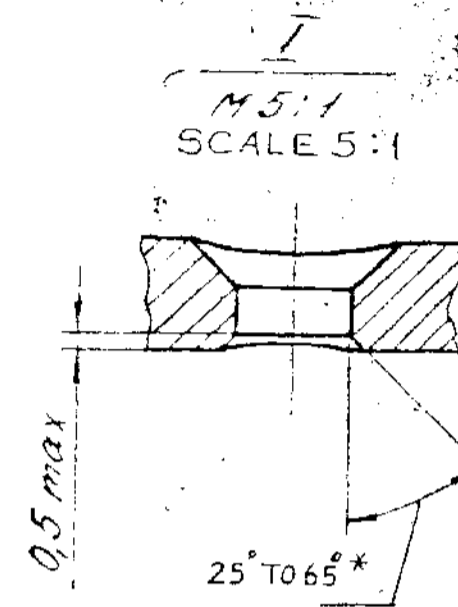
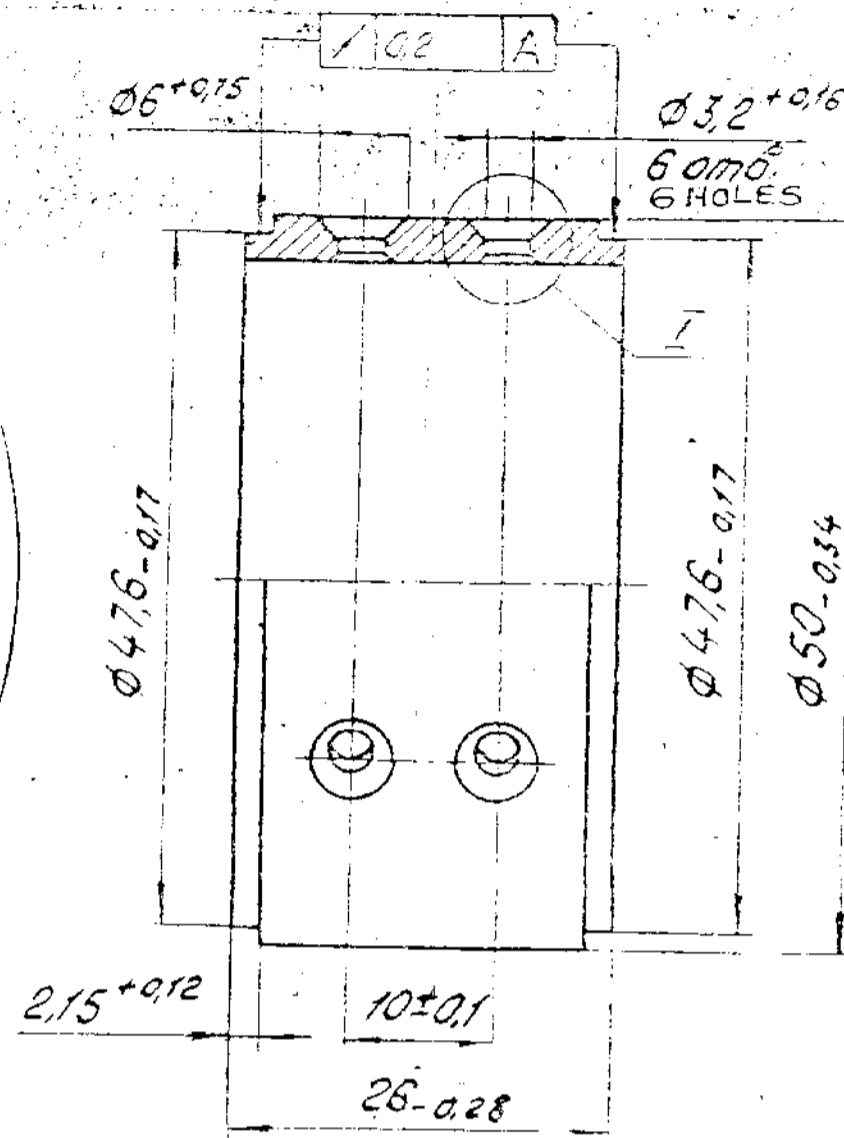
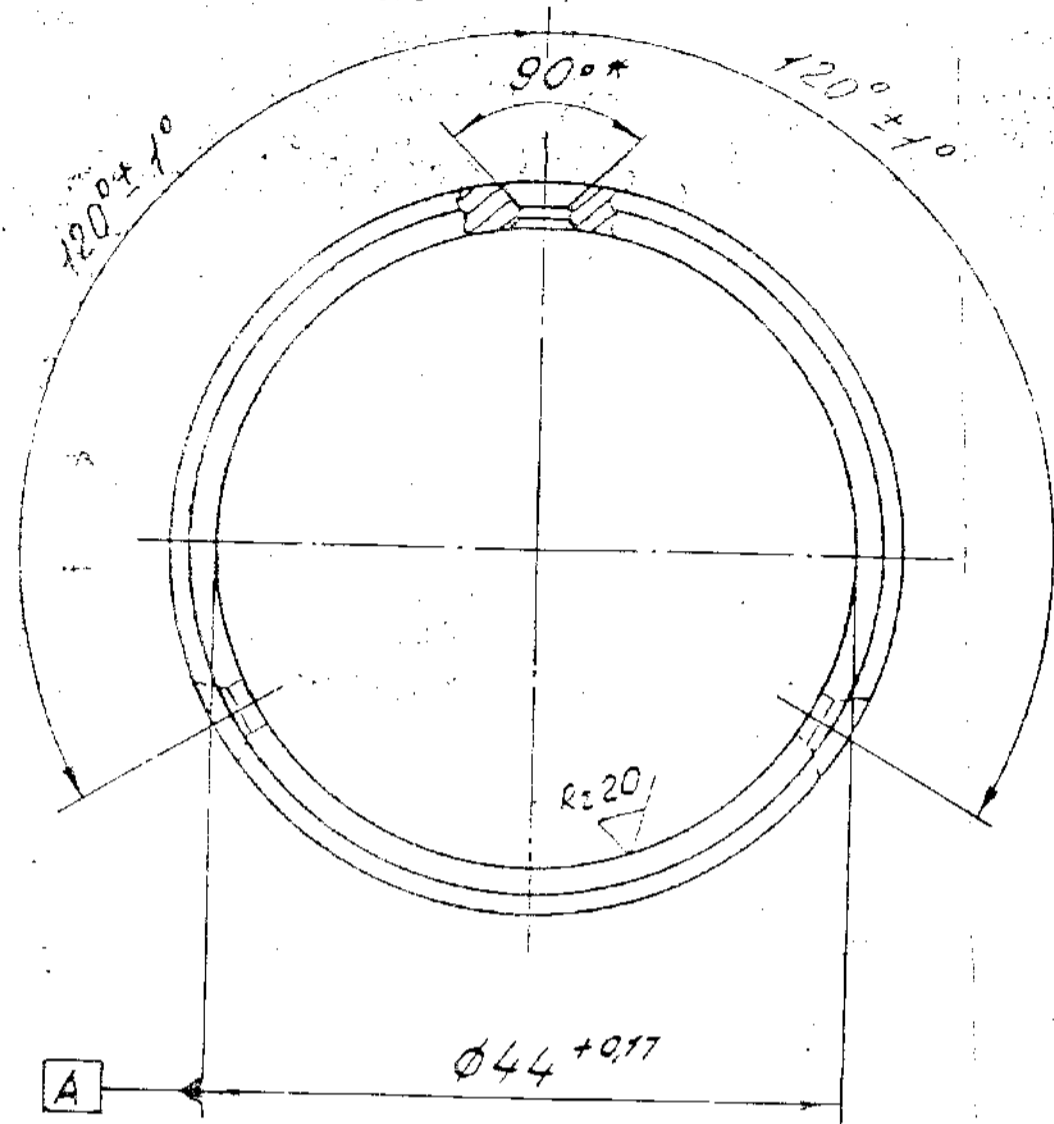

**EXPLANATORY NOTE:-**

4. REFERENCE MATERIAL QUOTED:- TUBE 53x6 GOST 8734-75 B10 GOST 8733-74

COLD DRAWN SEAMLESS TUBE WITH EXTERNAL DIA 53mm WALL THICKNESS 6mm ALTERNATIVELY EXTERNAL DIA 51mm, WALL THICKNESS 5mm TO GOST 8734-75. SUPPLIED WITH MECHANICAL PROPERTIES AS PER GROUP B, GOST 8733-74. MANUFACTURED FROM STEEL GRADE 10 TO GOST 1050-74.

a) CHEMICAL COMPOSITION:- AS PER GOST 1050-74. (KILLED STEEL)

Gde. OF STEEL	CONTENT OF ELEMENTS IN %						
	C	Si	Mn	Cr	Ni	S	P
10	0.07	0.17	0.35	0.15	0.25	0.04	0.035
	0.14	0.37	0.65				

b) MECHANICAL PROPERTIES:- AS PER GOST 8733-74.

Gde. OF STEEL	U T S Kgf/mm <sup>2</sup>	YIELD POINT Kgf/mm <sup>2</sup>	RELATIVE ELONGATION
			%
10	35	21	24
			MINIMUM

1. ALTERNATIVE MATERIAL: TUBE 51x5 GOST 8734-75 B 10 GOST 8733-74.

2. \* DIMENSION IS ENSURED BY TOOL.

3. WELDED CONSTRUCTION IS ALLOWED.

CODE Код	DESIGNATION Обозначение	COATING AND ADDITIONAL REQUIREMENTS Покрытие и дополнительные требования
457392 1423	СП100-501А	Ц15.ХР Zn 15, CHROMATIZING
457392 1425	СП100-501А-Т	КД 15.ХР Cd 15, CHROMATIZING APPEARANCE AS PER STANDARD PIECE Внешний вид по эталону.
457392 1424	СП100-501А-Э	Zn 15 CHROMATIZING. APPEARANCE AS PER STANDARD PIECE Ц15.ХР. Внешний вид по эталону.

PILOT SAMPLE SHOULD BE APPROVED BY A H S P BEFORE BULK PRODUCTION.

EST. MASS. 96g TO BE STAMPED OR MARKED WHERE INDICATED THUS #

LETTERS:  
ALL SHARP EDGES AND CORNERS TO BE REMOVED UNLESS OTHERWISE STATED MACHINED CORNERS TO HAVE R OUTSIDE R INSIDE EQUIVALENT CHAMFERS ARE PERMISSIBLE.

ISSUE	DATE	NATURE OF AM

MATERIAL TUBE 53x6 GOST 8734-75 B10 GOST 8733-74

ALL SHARP EDGES & CORNERS TO BE REMOVED

ALL THREADS TO CONFORM TO SPECIFICATION

STAMP OR ETCH, PART NO. MANUFACTURER'S NAME & YEAR OF MFG. USED ON -

DRG NOT TO BE SCALED

SCALE :- 2:1

DATE :- 22-7-97.

TOLERANCE ON DIMENSIONS UNLESS OTHERWISE SPECIFIED

DRM  
TCO  
CHC  
APD

WT :- (Kg)

СП 100 501 А  
STATOR BODY

CONTROLLERATE OF QUALITY ASSURANCE  
(INFANTRY COMBAT VEHICLES) 99/110

DRAWING NUMBER  
Cn 100 502

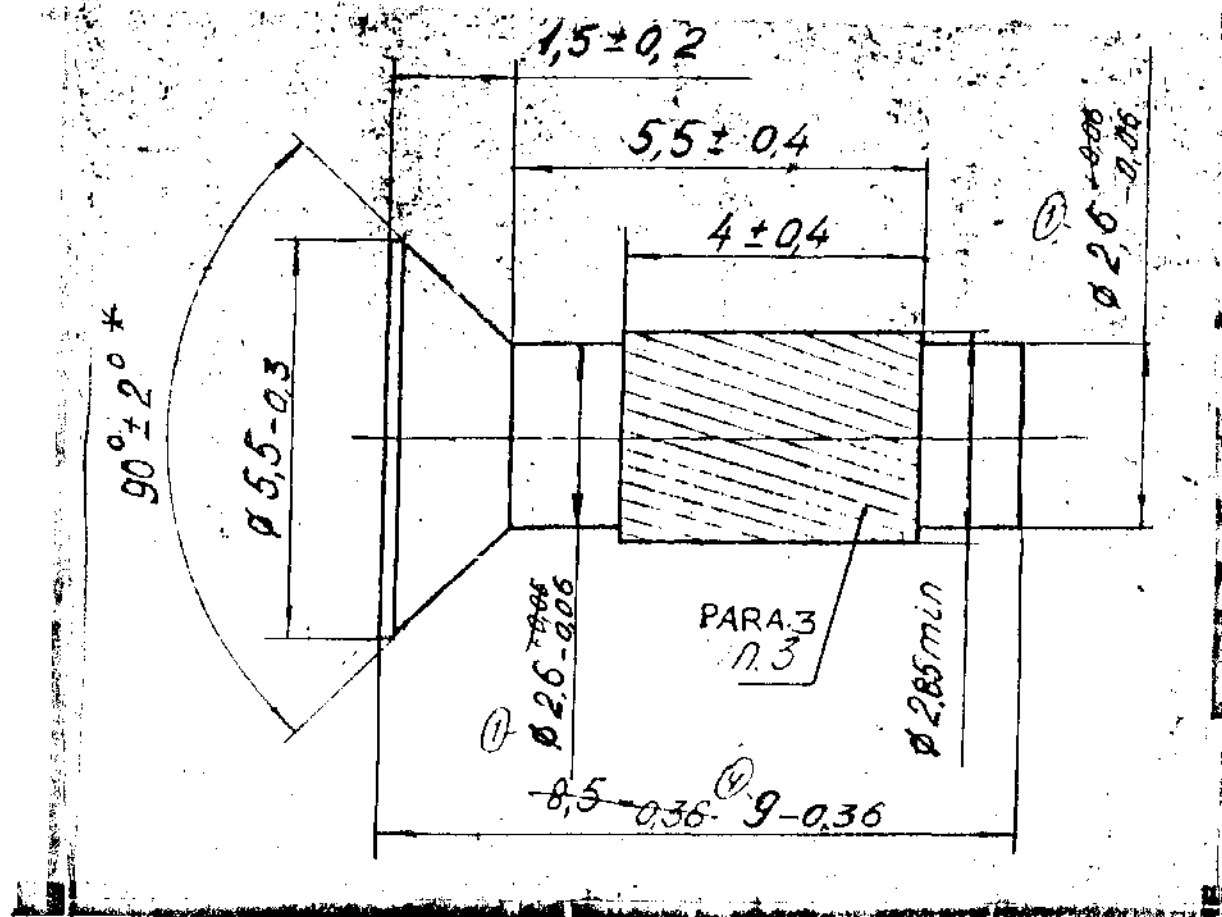

**EXPLANATORY NOTE:-**

6. REFERENCE MATERIAL QUOTED:- COLD HEADING CARBON STEEL WIRE DIAMETER 5.5mm WITH STANDARD ACCURACY, TO GOST 5663-79 MANUFACTURED FROM GRADE 10 TO GOST 1050-74.

a) CHEMICAL COMPOSITION- AS PER GOST 1050-74.

Gde. OF STEEL	CONTENT OF ELEMENTS IN %						
	C	Si	Mn	Cr	Ni	S	P
10	0.07 0.14	0.17 0.37	0.35 0.65	0.15	0.25	0.04	0.035

b) MECHANICAL PROPERTIES:- AS PER GOST 5663-79.

Gde. OF STEEL	U T S Kgf/mm <sup>2</sup>	RELATIVE CONTRACTION % NOT LESS THAN
10	588 (60)	55

1. CYANIDING TO  $h_{0.05} \dots 0.1mm$
2. HRC 45 . . . . . 50.
3. OBLIQUE KNURLING TO  $15^\circ \div 20^\circ$  ANGLE AND 0.8mm PITCH
4. \* DIMENSION IS ENSURED BY TOOL.
5. COATING: Zn9 , CHROMATIZING.

PILOT SAMPLE SHOULD BE APPROVED BY A H S P BEFORE BULK PRODUCTION.

EST. MASS. 0.6g TO BE STAMPED OR MARKED WHERE INDICATED THUS # ( LETTERS)

ALL SHARP EDGES AND CORNERS TO BE REMOVED UNLESS OTHERWISE STATED MACHINED CORNERS TO HAVE R OUT-SIDE R INSIDE EQUIVALENT CHAMFERS ARE PERMISSIBLE.

ISSUE	DATE	NATURE OF

MATERIAL :- WIRE 2.8-10, GOST 5663-79

ALL SHARP EDGES & CORNERS TO BE REMOVED OR DRG. NOT TO BE SCALED	ALL THREADS TO CONFORM TO SPECIFICATION	STAMP OR ETCH, PART NO. MANUFACTURERS NAME & YEAR OF MFG
SCALE :- 10:1	TOLERANCE ON DIMENSIONS UNLESS OTHERWISE SPECIFIED	USED ON:- Cn 100 500 C5
DATE :- 22-7-97	WT :- (Kg)	Cn 100 502
DRN: <i>[Signature]</i>	TCD: <i>[Signature]</i>	RIVET
CMO	APD: <i>[Signature]</i>	

CONTROLLERATE OF QUALITY ASSURANCE (INFANTRY COMBAT VEHICLES) 103/110

A1 / B4

44515K<sup>14</sup>

SIZE A3



DRAWING NUMBER  
Cn 100 700 C5

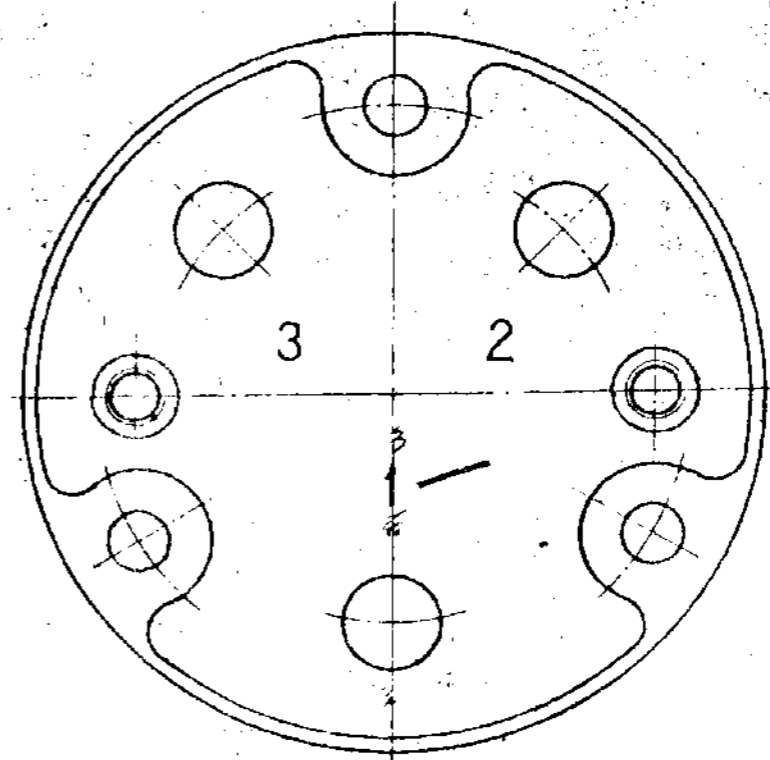
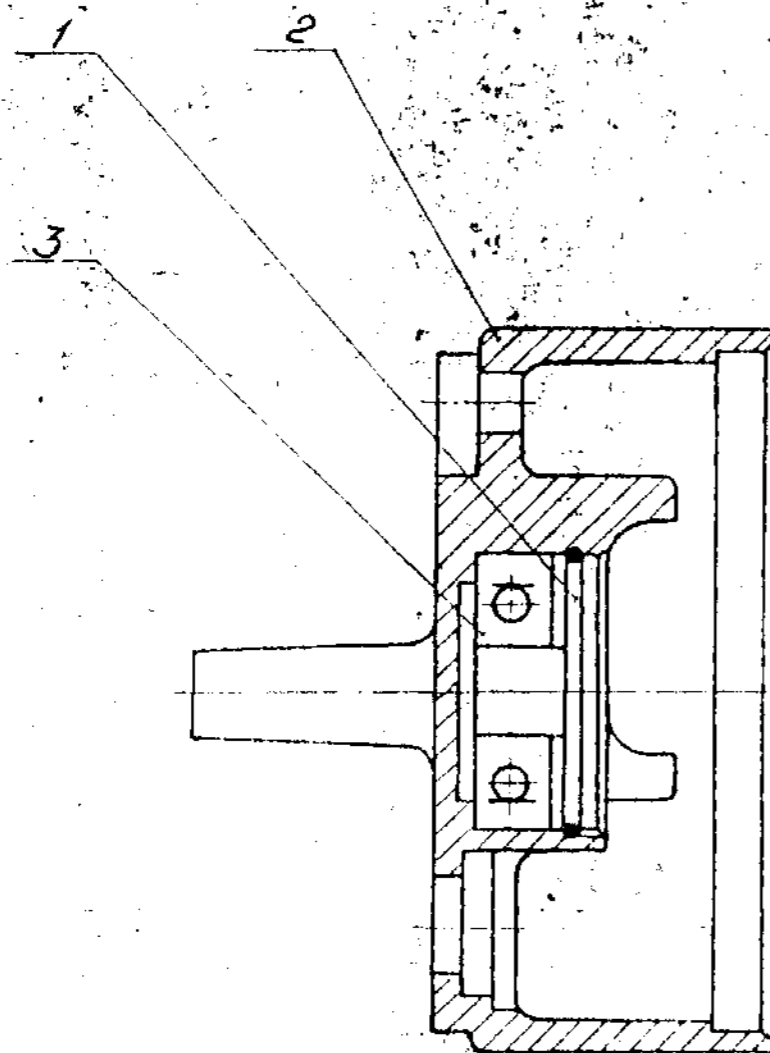

1. PRIOR TO ASSEMBLY FILL THE BEARING WITH LUBRICANT 132-31, TY 6.02-897-74.

PILOT SAMPLE SHOULD BE APPROVED BY A H S P BEFORE BULK PRODUCTION.

EST. MASS — TO BE STAMPED OR MARKED WHERE INDICATED THUS # LETTERS!

ALL SHARP EDGES AND CORNERS TO BE REMOVED UNLESS OTHERWISE STATED MACHINED CORNERS TO HAVE R OUTSIDE R INSIDE EQUIVALENT CHAMFERS ARE PERMISSIBLE.

MATERIAL		ALL SHARP EDGES & CORNERS TO BE ROUNDED OFF		ALL THREADS TO CONFORM TO SPECIFICATION		STAMP OR ETCH, PART NO. MANUFACTURERS NAME & YEAR OF MFR.	
DRG. NOT TO BE SCALED		SCALE :- 2:1		TOLERANCE ON DIMENSIONS UNLESS OTHERWISE SPECIFIED		USED ON:-	
DATE :- 22-7-97		WT :- (Kg)		Cn 100 700 C5		Cn 110 380 2010 C5	
DRN.		TCD.		ENR.		APD.	
				COVER ASSY			
ISSUE		DATE		NATURE OF AM		CONTROLLERATE OF QUALITY ASSURANCE (INFANTRY COMBAT VEHICLES)	

A1/83

44515KA

SIZE A3

51/110

DRAWING NUMBER  
 ЦН 100 701

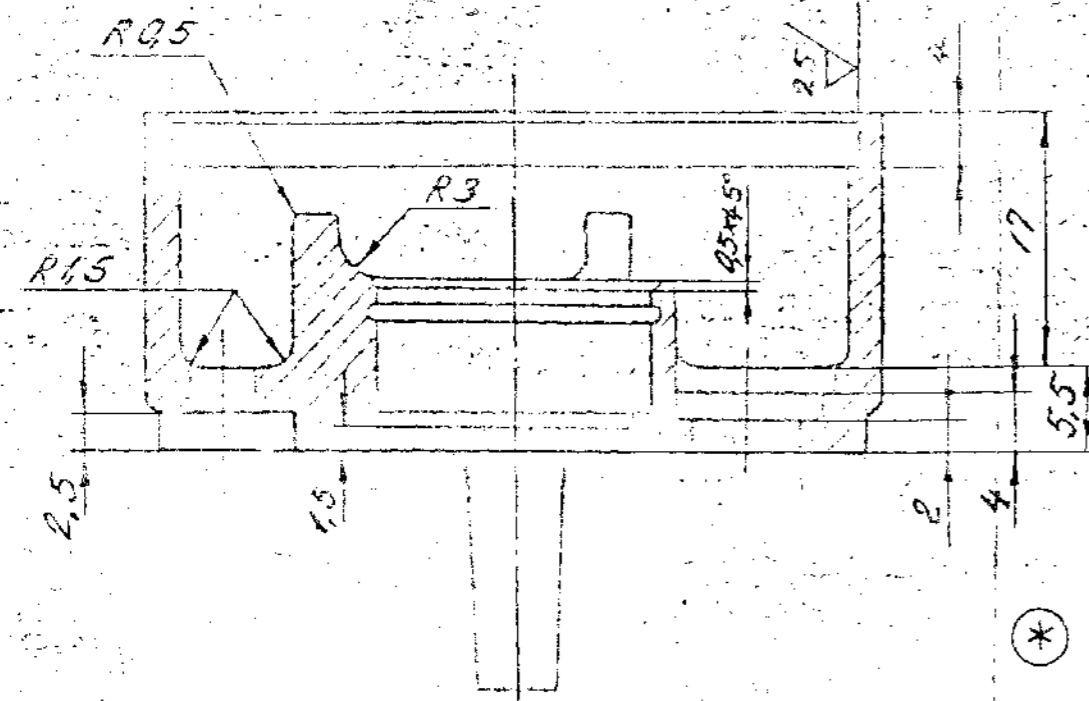
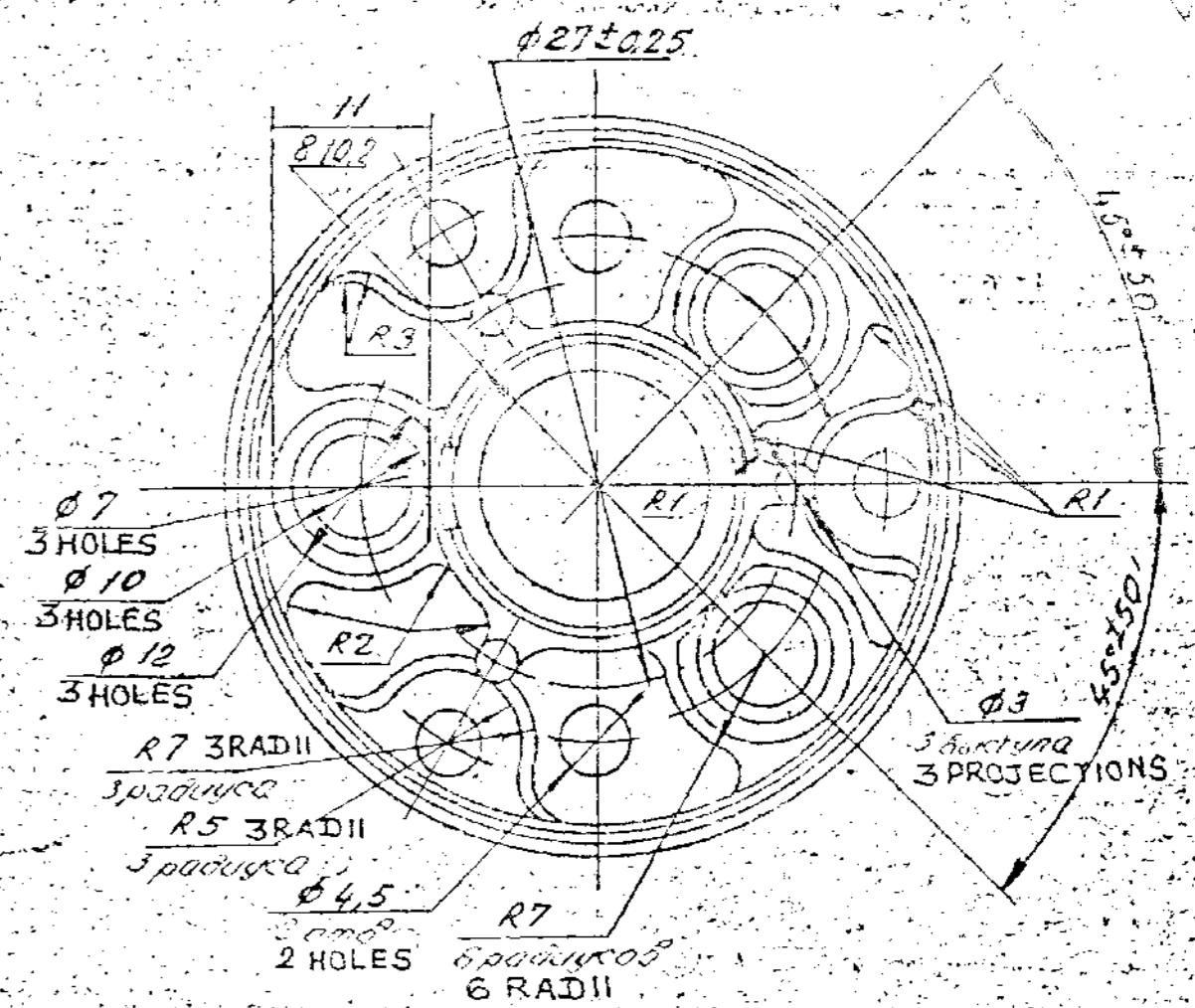
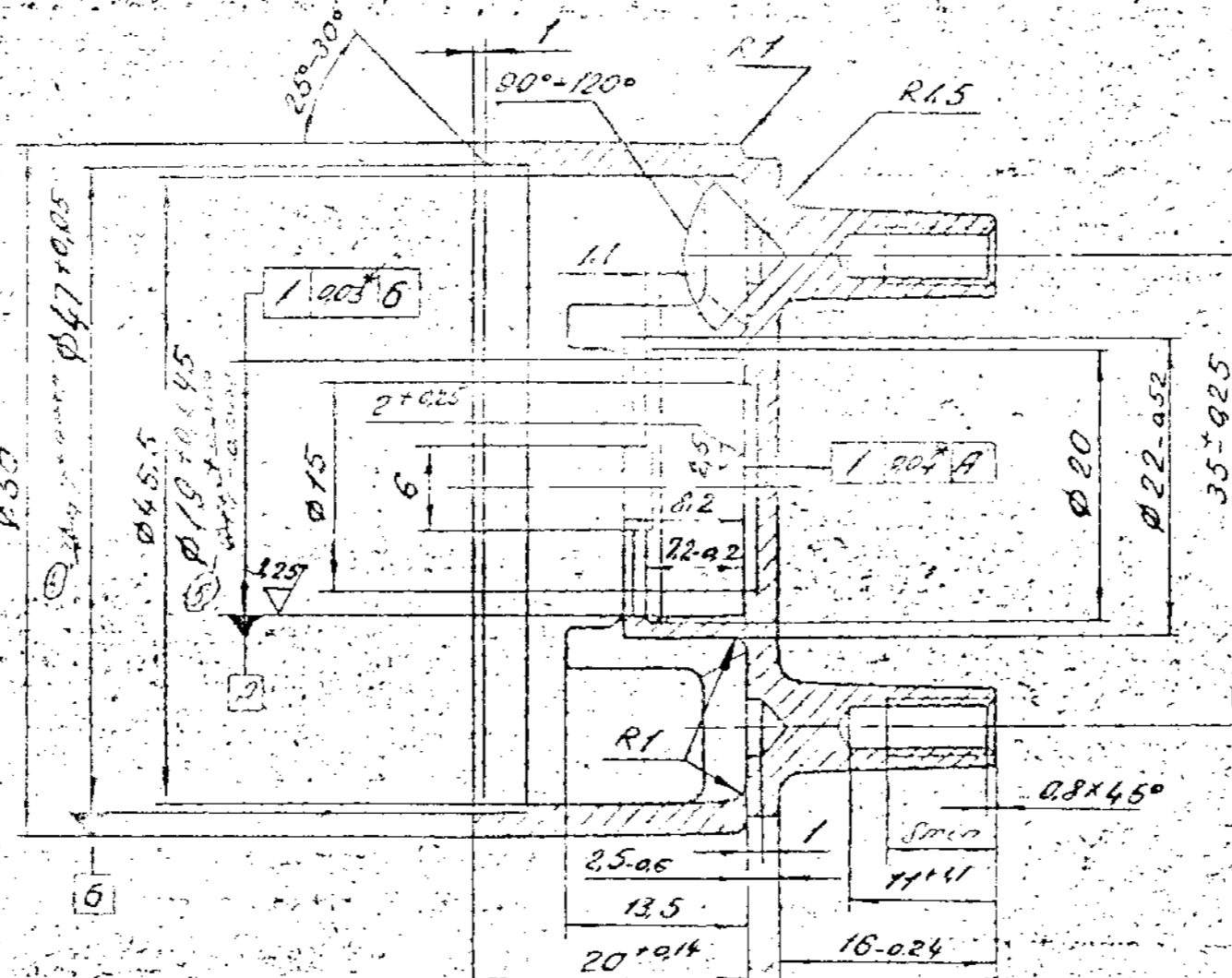
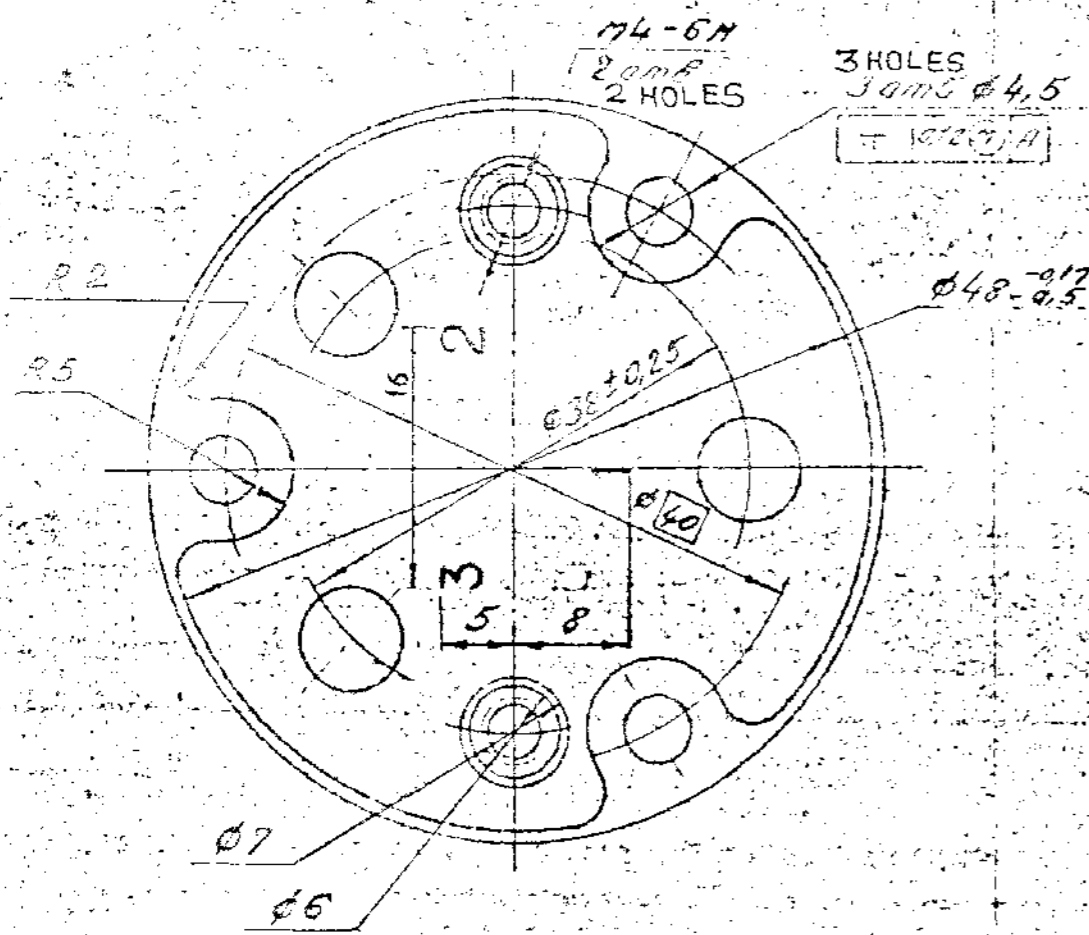

ALTERNATE MATERIAL: ALLOY UA-4 GOST 19424-74  
 (Прометал-цементная сталь UA-4 GOST 19424-74)

1. RAISED DIGITS, HEIGHT 0.3mm, TYPE П-3, GOST 2930-62.
2. UNSPECIFIED LIMIT DEVIATIONS OF DIMENSIONS FOR: SHAFTS-AS PER B5, HOLES - AS PER A5, OTHERS-AS PER CM 7, 0.0115mm.
3. CONICITY AND OVALITY OF SURFACE A SHOULD NOT EXCEED 0.0115mm.
4. \* ENSURED BY TOOL.

CODE	DESIGNATION	COATING AND ADDITIONAL REQUIREMENTS
4573921398	ЦН 100-701	6 CHROMATIZING 6 %
4573921401	ЦН 100 701-Г	6 CHROMATIZING EXTERNAL SURFACE COATING: COLOURLESS VARNISH AK-113, GOST 23832-79 V, T2 APPEARANCE AS PER STANDARD PIECE
4573921399	ЦН 100-701-3	6 CHROMATIZING. APPEARANCE AS PER STANDARD PIECE.

MATERIAL: ALLOY UA-4  
 GOST 19424-74

ALL SHARP EDGES & CORNERS TO BE ROUNDED BY	ALL THREADS TO CONFORM TO SPECIFICATION	STAMP OR ETCH, PART NO. MANUFACTURERS NAME & YEAR OF MFR.
DRG. NOT TO BE SCALED	TOLERANCE ON DIMENSIONS UNLESS OTHERWISE SPECIFIED.	USED ON:- ЦН 100 700 65
SCALE :- 2:1	DATE :- 22-7-97	WT :- 1kg
DRN. [Signature]	TCD. [Signature]	APP. [Signature]
<b>ЦН 100 701</b> <b>COVER</b>		
<b>CONTROLLERATE OF QUALITY ASSURANCE</b> <b>(INFANTRY COMBAT VEHICLES)</b>		

PILOT SAMPLE SHOULD BE APPROVED BY A H S P BEFORE BULK PRODUCTION.

EST. MASS. 75g TO BE STAMPED OR MARKED WHERE INDICATED THUS: LETTERS:

ALL SHARP EDGES AND CORNERS TO BE REMOVED UNLESS OTHERWISE STATED MACHINED CORNERS TO HAVE R OUTSIDE R INSIDE EQUIVALENT CHAMFERS ARE PERMISSIBLE.

ISSUE DATE NATURE OF AM

DRAWING NUMBER

Cn 1005 026

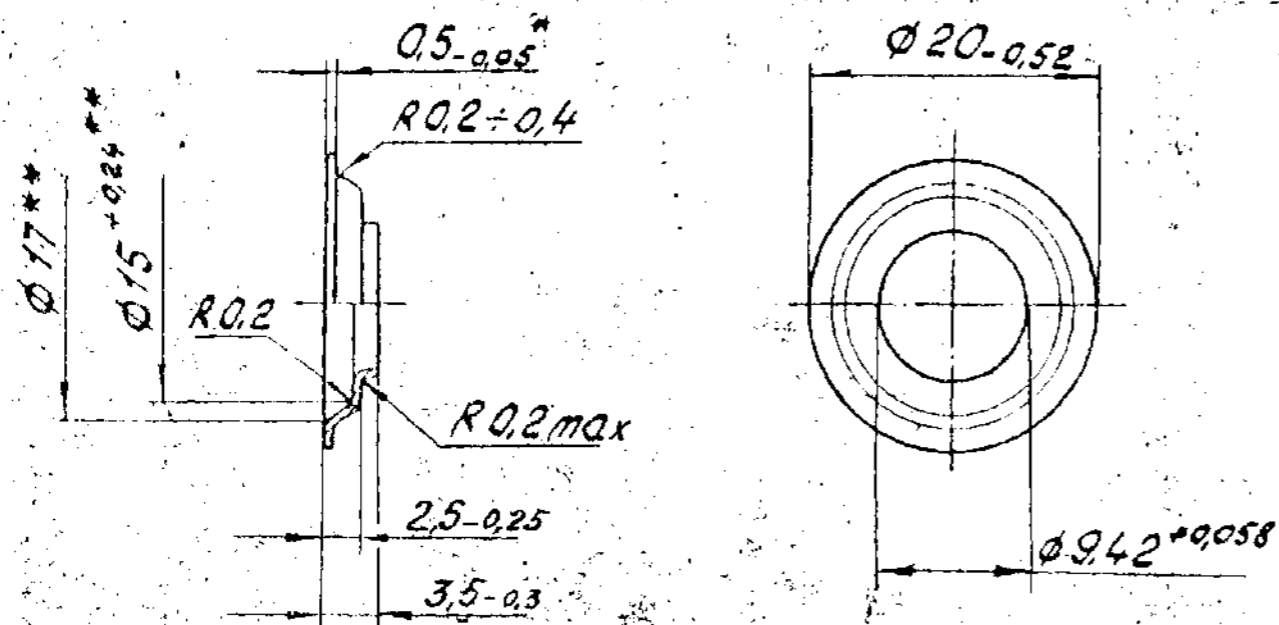

## VARIABLE DATA

CODE Код	DESIGNATION Обозначение	Наименование переменных данных Покрытие (COATING)
45 7392 1411	СП1005-026	Zn 15, CHROMATIZING Ц15,ХР
45 7392 1413	СП1005-026Т	Cd 9, CHROMATIZING Кд 9,ХР

PILOT SAMPLE SHOULD BE APPROVED BY A H S P BEFORE BULK PRODUCTION.

EST. MASS  
1.11g

TO BE STAMPED OR MARKED WHERE INDICATED THUS # LETTERS)

ALL SHARP EDGES AND CORNERS TO BE REMOVED UNLESS OTHERWISE STATED MACHINED CORNERS TO HAVE R OUTSIDE R INSIDE EQUIVALENT CHAMFERS ARE PERMISSIBLE

**EXPLANATORY NOTE:-**

4. REFERENCE MATERIAL QUOTED:- COLD ROLLED LOW CARBON STEEL EXTRA SOFT GROUP, NORMAL ACCURACY STEEL GROUP 0.5<sub>-0.05</sub>mm THICK GRADE 08Kn GOST 503-71.

a) CHEMICAL COMPOSITION:- AS PER GOST 1050-74.

Gde. OF STEEL	CONTENT OF ELEMENTS IN %						
	C	Si	Mn	Cr	Ni	S	P
08Kn	0.05 0.11	0.03 (Max)	0.25 0.50	0.10	0.25	0.04	0.035

b) MECHANICAL PROPERTIES:- AS PER GOST 503-71.

Gde. OF STEEL	CONDITION OF MATERIAL	U T S Kgf/mm <sup>2</sup>
08Kn	EXTRA SOFT	(25 TO 40)

- \* DIMENSIONS FOR REFERENCE.
- \*\* DIMENSIONS ARE ENSURED BY TOOL.
- UNSPECIFIED LIMIT DEVIATIONS OF DIMENSIONS AS PER CM 9.

MATERIAL :- BAND 08Kn-OM-HT-2-0-0.5, GOST 503-71

ALL SHARP EDGES & CORNERS TO BE ROUNDED OFF	ALL THREADS TO CONFORM TO SPECIFICATION	STAMP OR ETCH, PART NO. MANUFACTURERS NAME & YEAR OF MFR.
DRG. NOT TO BE SCALED	TOLERANCE ON DIMENSIONS UNLESS OTHERWISE SPECIFIED	USED ON:- Cn 110 380 201005
SCALE :- 2 : 1	WT :- (Kg)	Cn 1005 026
DATE :- 22-7-97		OIL DEFLECTOR
DRN.		
TCD.		
CHD.		
APD.		

CONTROLLERATE OF QUALITY ASSURANCE  
(INFANTRY COMBAT VEHICLES)

8 7 6 ISSUE DATE NATURE OF AMEN

A1  
101

44515KPA

SIZE A2

7/110





DRAWING NUMBER

Cn 1005 600C5

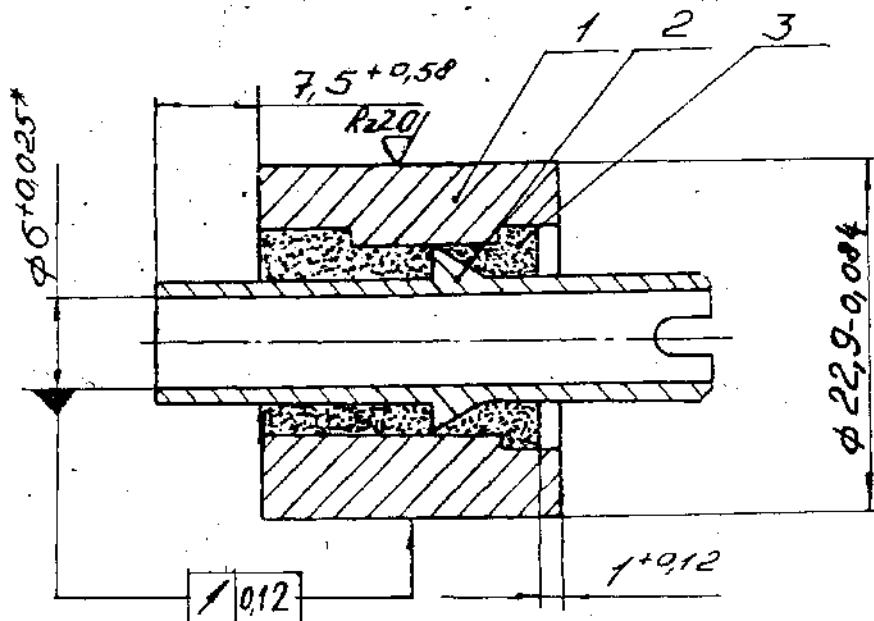

1. \* DIMENSION FOR REFERENCE.

2. MAGNITIZE TO SATURATION ON TWO-POLE INSTALLATION.

PILOT SAMPLE SHOULD BE APPROVED BY A H S P BEFORE BULK PRODUCTION.

A1  
78

44515K<sup>4</sup>

NEAREST EQVT MATERIAL

ORGL MATERIAL

DC(I) No  
A DATE

ISSUE

AMENDMENTS

ALL SHARP EDGES & CORNERS TO BE ROUNDED OFF.

ALL THREADS TO CONFORM TO SPECIFICATION.

STAMP OR ECH. PART NO. MANUFACTURER'S NAME & YEAR OF MFR.

DRG. NOT TO BE SCALED

SCALE:- 2:1

TOLERANCE ON DIMENSIONS UNLESS OTHERWISE SPECIFIED

USED ONLY

DATE :- 22-7-97.

DRN.

WT: (Y8)

ROTOR ASSY

TCD.

349

CHD.

D. AWING NO

PART NO

APD.



CN 1005 600C5

CONTROLLER OF QUALITY ASSURANCE

(INFANTRY COMBAT VEHICLE) 19110

DRAWING NUMBER

Сп 100Б 602

Rz 40 (✓)

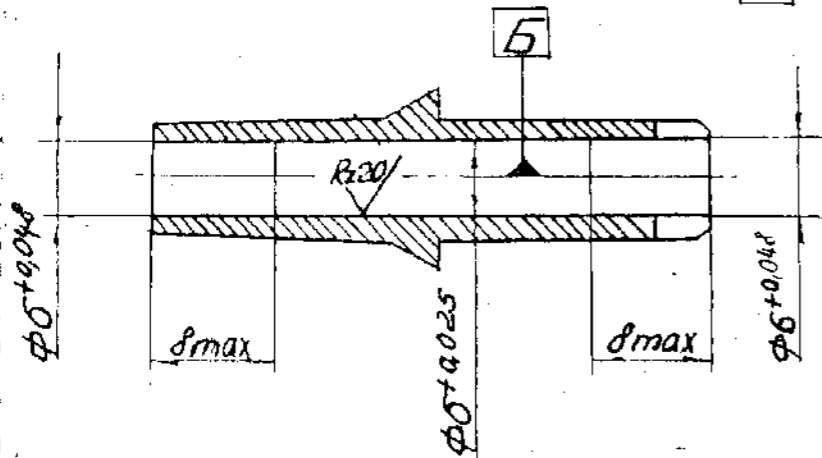
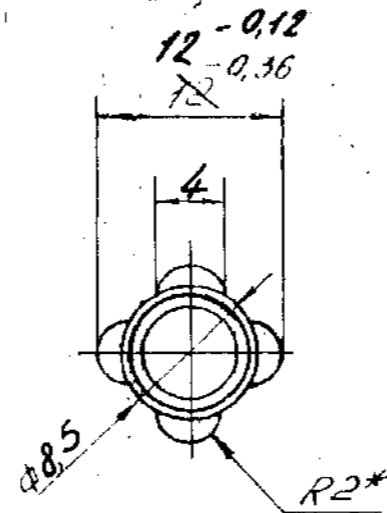
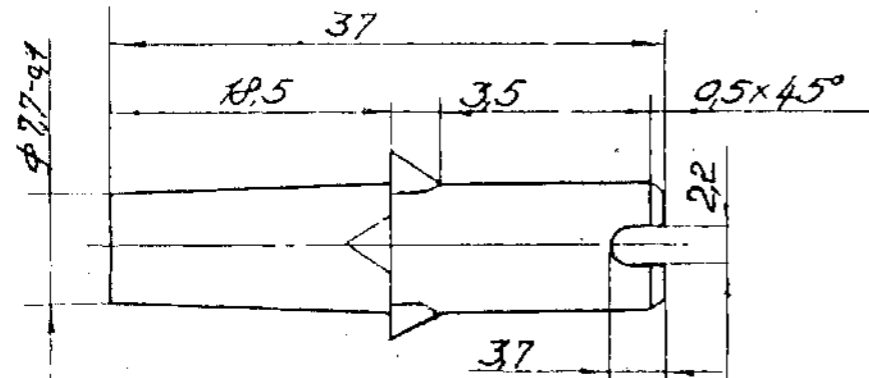

CODE	DESIGNATION	COATING
Код	Ударная	Покраска
4513921240	Сп100Б 602	CHROMATIZING

1. UNSPECIFIED LIMIT DEVIATIONS OF DIMENSIONS FOR:  
HOLES -AS PER A5, SHAFTS -AS PER B5, OTHERS -AS PER CM5.
2. \* DIMENSION FOR REFERENCE.

MATERIAL: ALLOY YA4  
GOST 19424-74  
ALTERNATE MATERIAL: ALLOY ЦАМ 4-1,  
GOST 19424-74

A1  
60

PILOT SAMPLE SHOULD BE APPROVED BY A H S P BEFORE BULK PRODUCTION.

EST. MASS. 5.5g TO BE STAMPED OR MARKED WHERE INDICATED THUS #-(LETTERS)

ALL SHARP EDGES AND CORNERS TO BE REMOVED UNLESS OTHERWISE STATED MACHINED CORNERS TO HAVE R OUTSIDE R INSIDE EQUIVALENT CHAMFERS ARE PERMISSIBLE.

MATERIAL		
ALL SHARP EDGES & CORNERS TO BE REMOVED	ALL THREADS TO CONFORM TO SPECIFICATION	STAMP OR ETCH, PART NO. MANUFACTURERS NAME & YEAR OF MFR
DRG. NOT TO BE SCALED	TOLERANCE ON DIMENSIONS UNLESS OTHERWISE SPECIFIED	USED ON:-
SCALE :- 2:1		Сп 100Б 602
DATE :- 22-7-97		BUSH
DRN. [Signature]	WT :- (Kg)	
TCD. [Signature]		
CNO. [Signature]		
APD. [Signature]		
CONTROLLERATE OF QUALITY ASSURANCE (INFANTRY COMBAT VEHICLES)		
ISSUE	DATE	NATURE OF AMEND

SIZE: A3

106/110