

[Signature]
DO/PISTOL

[Signature]
DO/CDO

		SCALE: NTS	PROJECTION: THIRD ANGLE	COMPONENT- PISTOL ASHANI MK-III	STORE DRG. NO
		DRAWN BY: <i>[Signature]</i>		MAGAZINE ASSEMBLY (SS)	
		CHECKED BY:		DRG. NO: CTM-192	
		APPROVED BY: <i>[Signature]</i>			
DT & SIGN.	DESCRIPTION	CONCURRED BY: JWM/PISTOL		NO. OF SHEETS : 1	
AMENDMENTS	SIGN & DATE	<i>[Signature]</i> 21/9/12		GSF Cossipore	SHEET NO: 1

DRG. NO: CTM -168

PROVISIONAL

ALL DIMNS. ARE IN mm.
UNTOL DIMNS. ARE AS PER IS:2102.

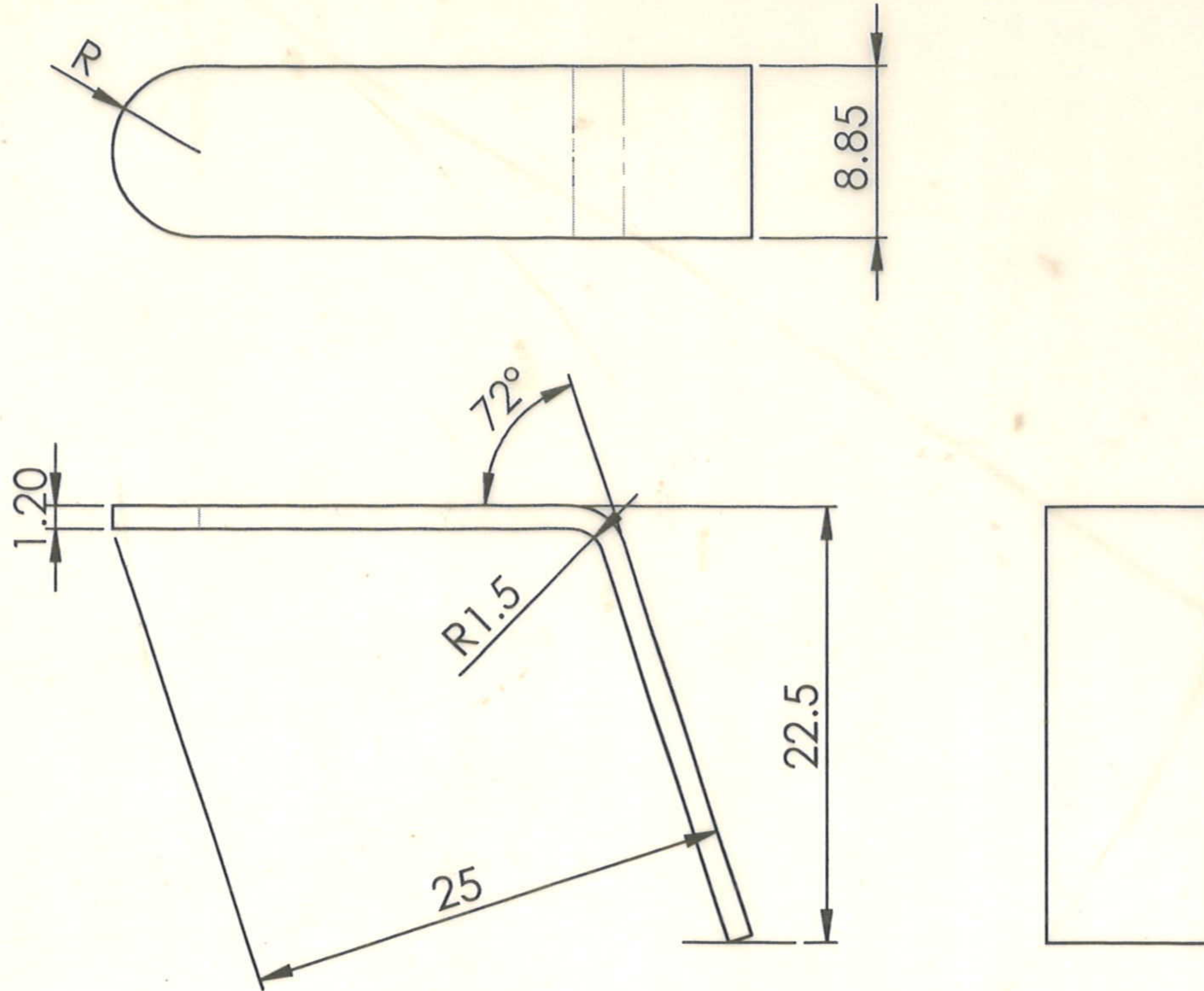

MATL: BS 1449 1955, EN 2A OR 2B

		SCALE- 2:1	PROJECTION: THIRD ANGLE	COMPONENT- MAGAZINE ASSY. ASHANI MK-III	STORE DRG.NO. CTM-158
		DRAWN BY : Shailesh kumar		PLATFORM	
		CHECKED BY: <i>[Signature]</i> 22.10.19			
		APPROVED BY: <i>[Signature]</i> 22/10/19			
DT & SIGN.	DESCRIPTION	CONCURRED BY: JWM/PISTOL		DRG. NO: CTM -168	NO. OF SHEETS : 1
AMENDMENTS		SIGN & DT: <i>[Signature]</i> 21/11/19		GSF COSSIPORE	SHEET NO: 1

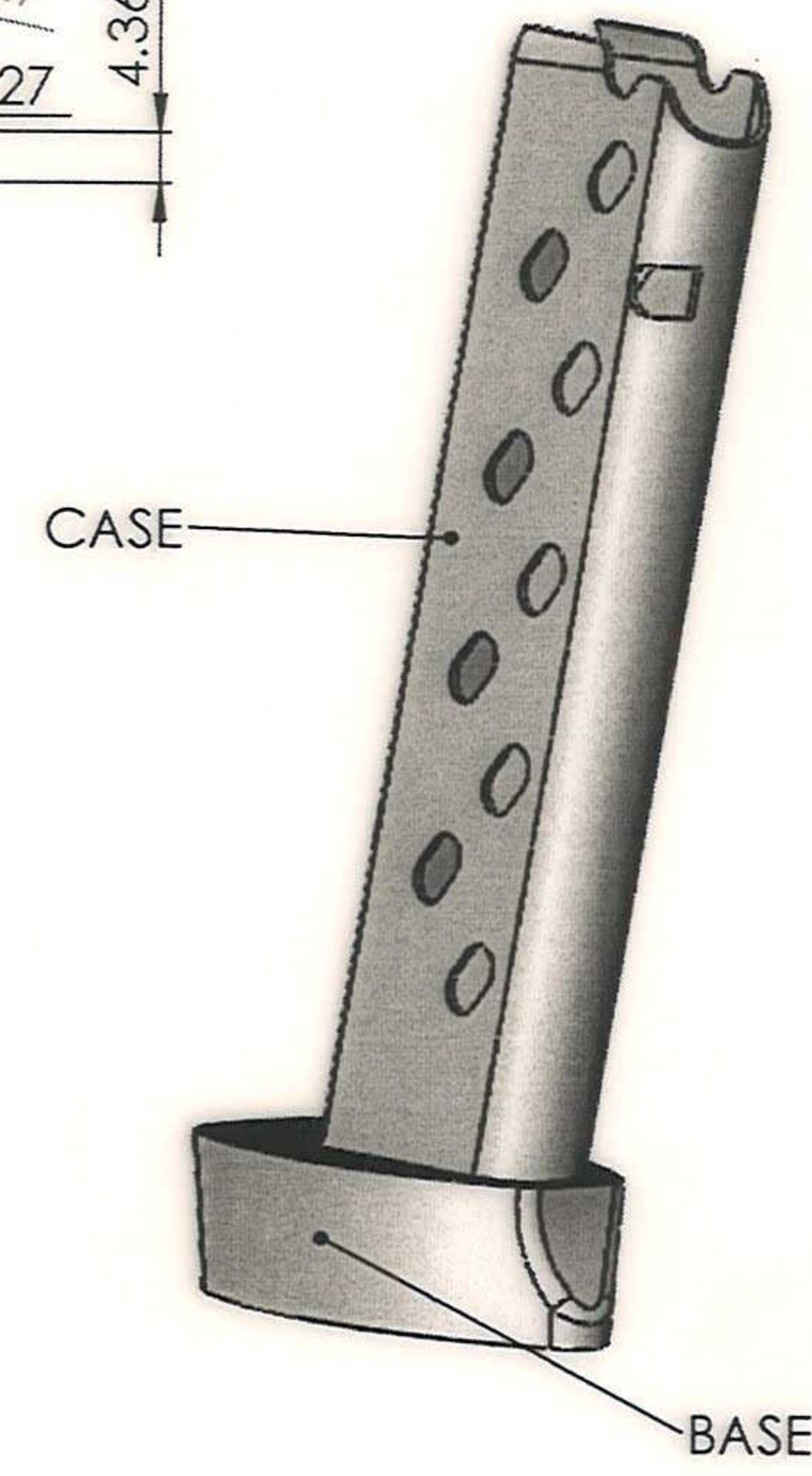
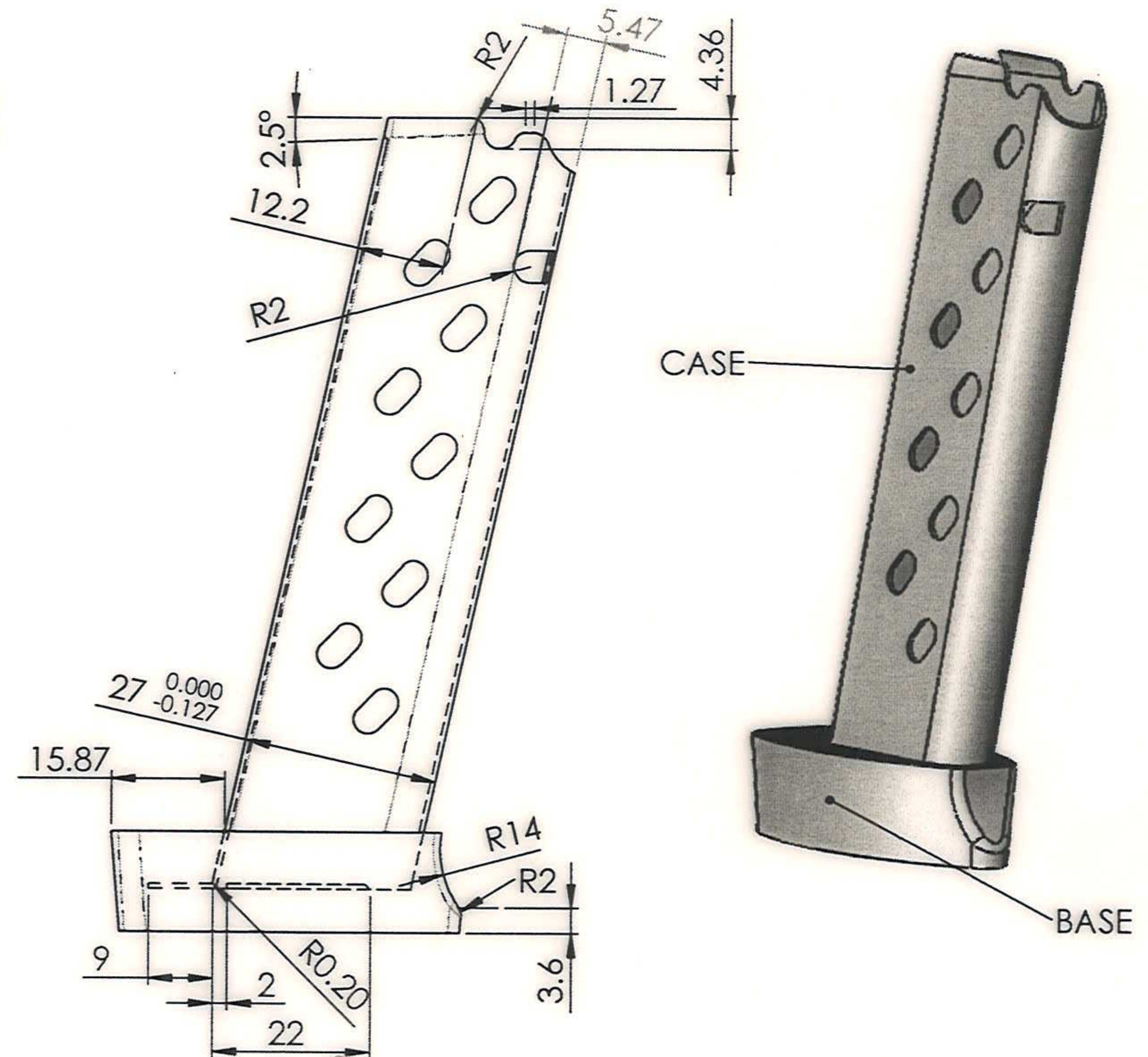
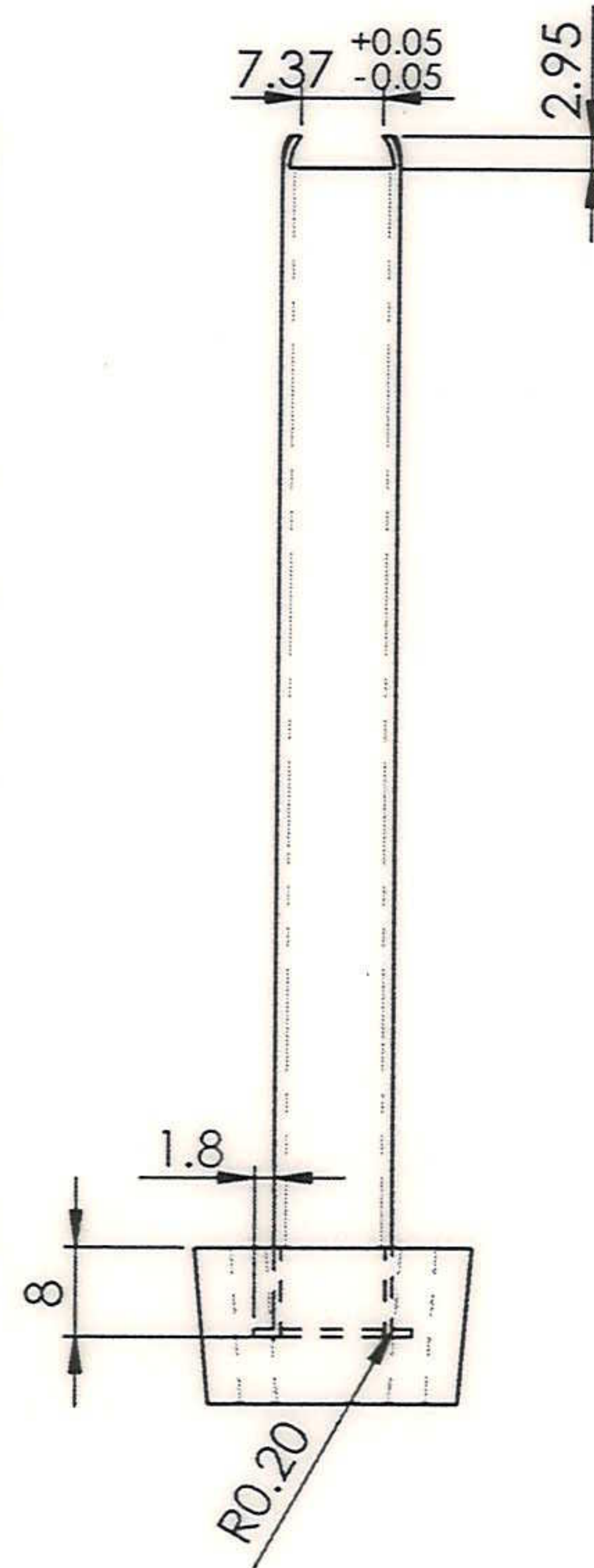
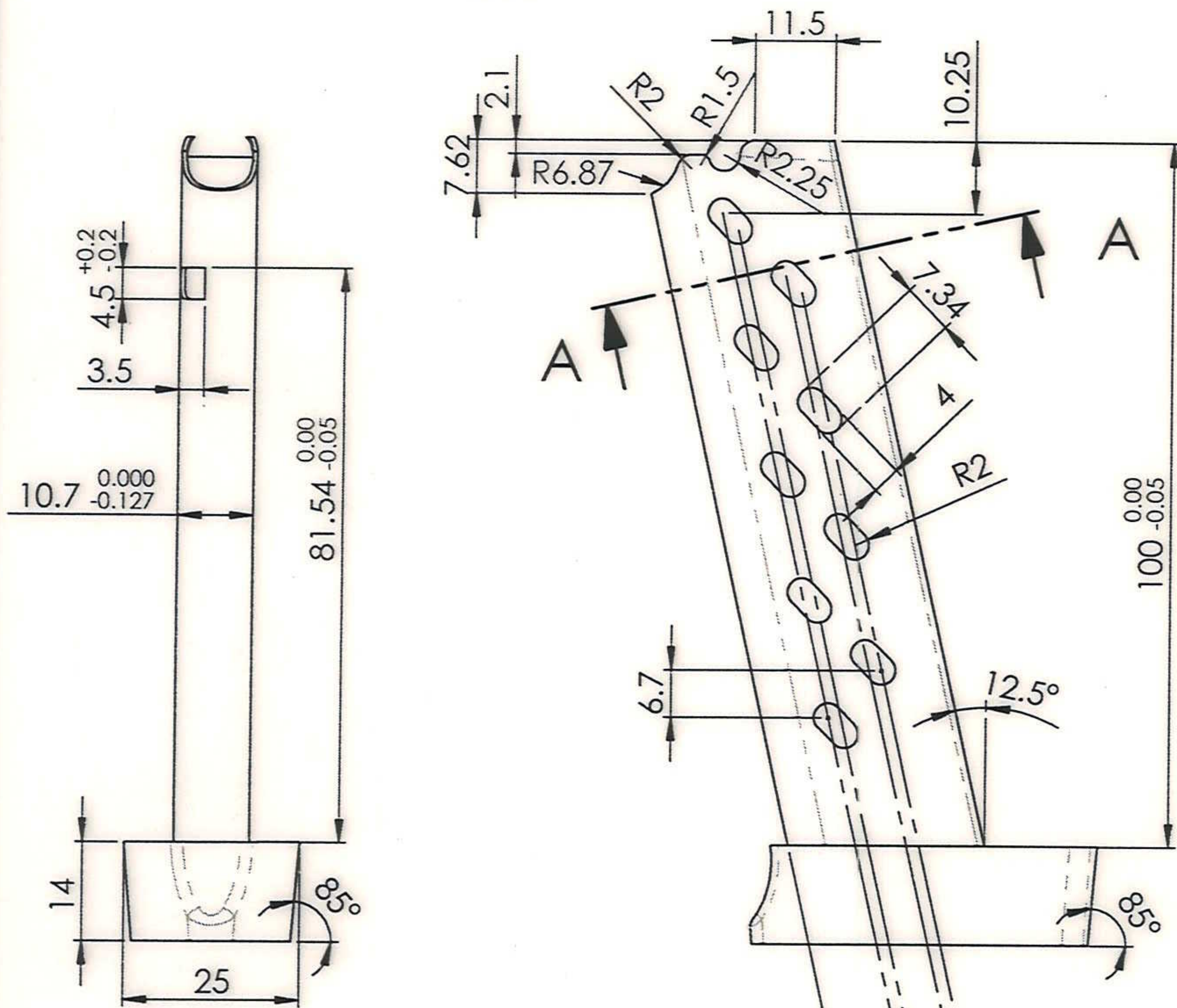

MATERIAL:-

- (1) **FOR CASE- STEEL To:-**
 - (i) JSL-UDD or
 - (ii) EN 10088-2:2005(E) GRADE 1.4372 (C)
 - (iii) ASTM 240 GRADE SS 201

- (2) **FOR BASE- POLYAMIDE 66 (BLACK COLOUR)**

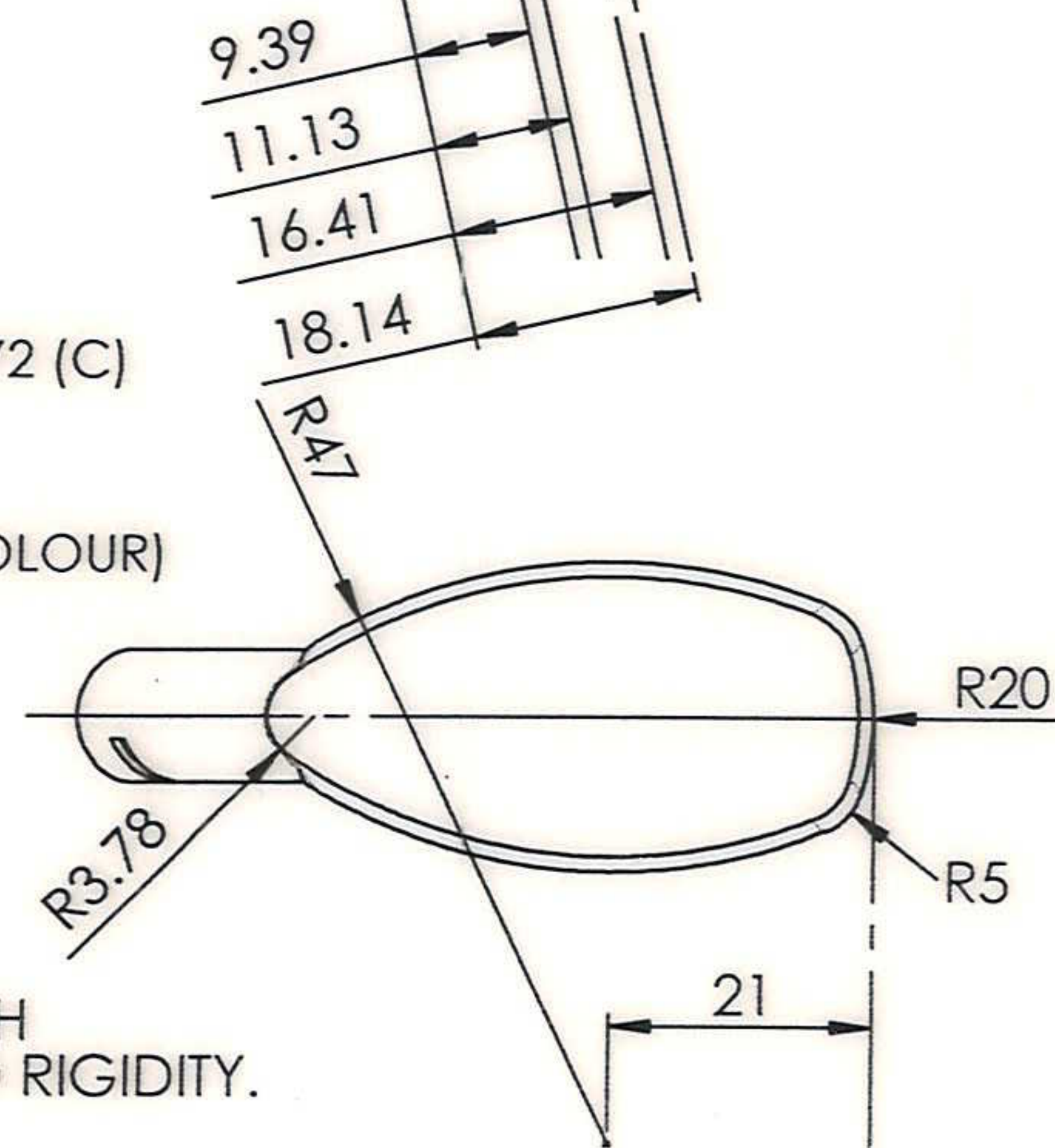

NOTE:- BASE SHOULD BE MOLDED WITH THE CASE INSURING DIMENSIONS AND RIGIDITY.

DO/CDO

DO/PISTOL

		SCALE: NTS	PROJECTION: THIRD ANGLE	COMPONENT	STORE DRG. NO
		DRAWN BY: <i>A 20/9/22</i>		MAGAZINE ASSY FOR ASHANI MK-III	CTM-192
		CHECKED BY:		MAGAZINE CASE (SS) WITH BASE	
		APPROVED BY: <i>M 20/9/22</i>		DRG. NO. CTM-193	
DT. & SG.	DESCRIPTION	CONCURRED BY: JWM/PISTOL	M/C-	NO. OF SHTS: 1	
	AMENDMENTS	SIGN & DATE: <i>20/9/22</i>	GSF COSSIPORE	SHT. NO: 1	

DRG. NO: CTM-194

ALL DIMNS. ARE IN mm.
UNTOL DIMNS. ARE AS PER IS:2102. MEDIUM CLASS

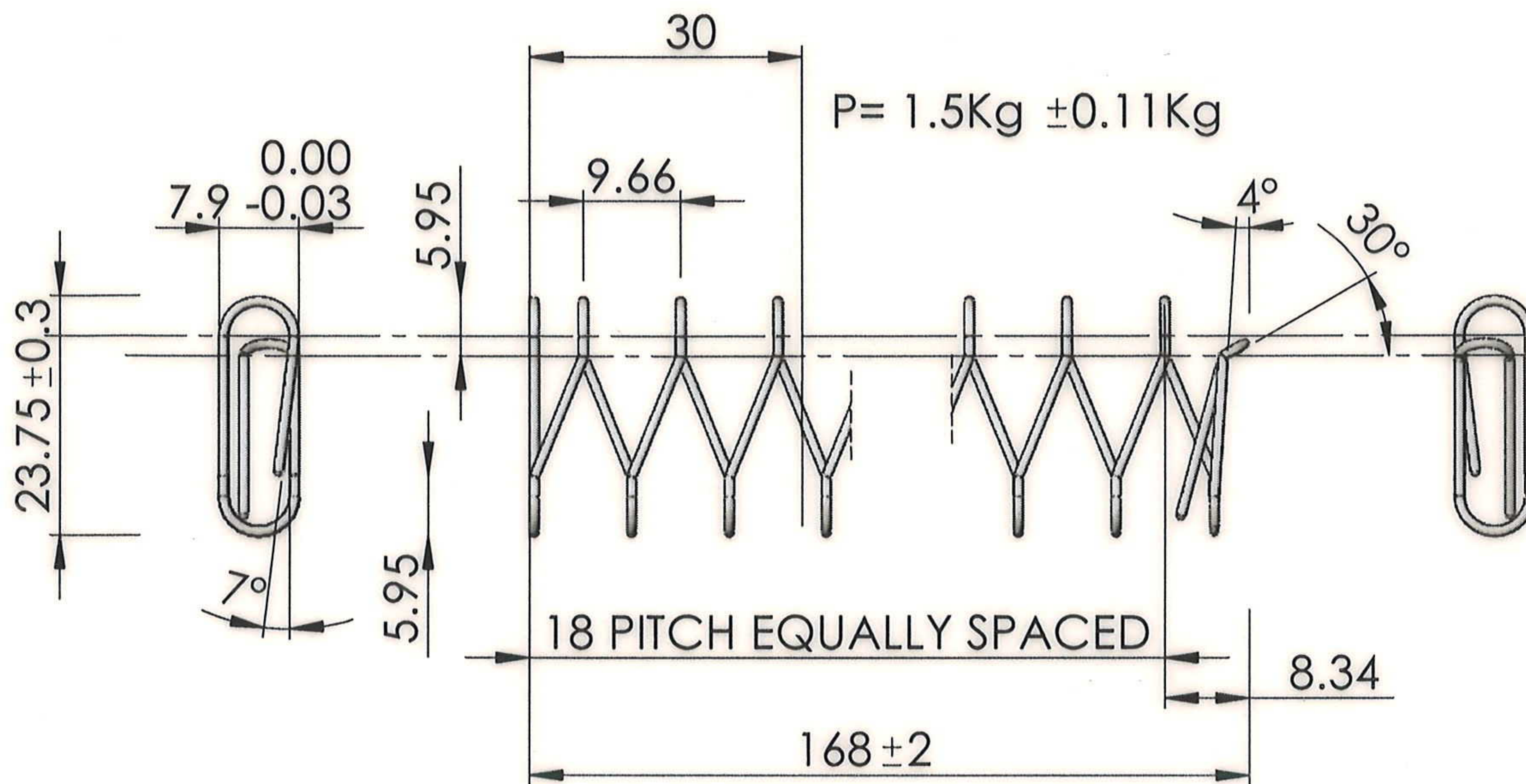

COIL TYPE - LEFT HAND WOUND
TOTAL NO. OF COIL - 18
FREE LENGTH - 168 mm ± 2
WIRE DIA. - 0.9 mm ± 0.015

MATERIAL:- BS 5216 , 1991 CODE-NS, GRADE-3

PROTECTIVE FINISH:- PHOSPHATING TO JSS 0465-01-1988 CLASS-II
(ACCELERATED) OIL FINISH.

[Signature]
DO/PISTOL

[Signature]
DO/CDO

		SCALE - 1:1	PROJECTION: THIRD ANGLE	COMPONENT- MAGAZINE ASSY (SS) ASHANI MK-III	STORE DRG.NO CTM-192
		DRAWN BY: <i>[Signature]</i> 20/9/22		SPRING MAGAZINE DRG. NO: CTM-194	
		CHECKED BY:			
		APPROVED BY: <i>[Signature]</i> 20/9/22			
DT & SIGN.	DESCRIPTION	CONCURRED BY: JWM/PISTOL			NO. OF SHEETS : 1
AMENDMENTS		SIGN & DT: <i>[Signature]</i> 21/9/22		GSF COSSIPORE	SHEET NO: 1