

bw 8 363 012

Pem. No. 01389/75
3-0105875

204u
28



ЕСКА

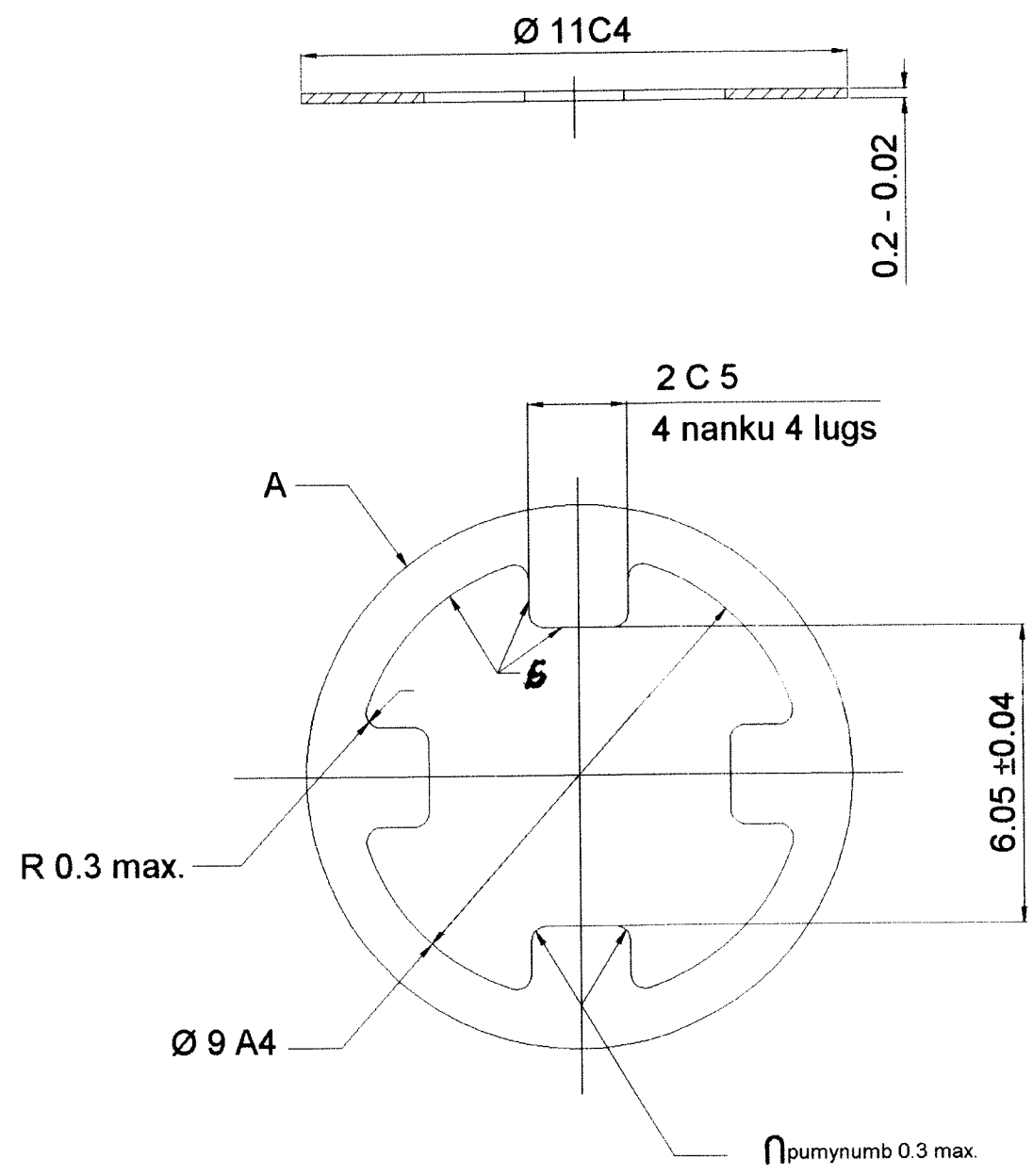

1. Alternate material is 08k11-T-2-0,2 GOST503-81.
2. *Dimension for reference, other dimensions are ensured by tools.
3. Perform surfaces A, B Once clamped only.
4. Coating - Cu3 Sn3
5. The part should be forced through at a load of 7 Kgf and should not at a load of 2.5 Kgf.
6. The following is allowed :
 - a) Presence of burrs on surface A, B as against the standard sample established by manufacture and agreed with customer representative at manufacturing plant
 - b) Coating alloy Cu-Zn(70%-30%) 3 µ Sn 3; or Sn 6 chromated;
 - c) Perform coating of bands
7. Other requirements are as per DST B 84-264-81.
- 8 IS: 513-2008 GR.CR 3 OR Gd. 1CS OF BS 1449 SECTION 1.11.1991

LOCATOR	SHEET	WEIGHT	SCALE
	A	0.93g	10:1
		TOTAL SHEETS	
ROUND BAR FIT GOST 21-488-76		ORDNANCE FACTORY PROJECT HYDERABAD.	

05-01-2011	DGQA S O Sec I Chap 10 para 40	Drg. scan, clean & edit without change & m/c replaced in supersession of existing dilapidated copy of same No		
08-11-2010	DC. 3721-A	INDIGENOUS MATL. ADDED AS Note No. 8		
24-09-87	DCI. 34241-A	DRG. PROV. SEALED.	<i>[Signature]</i>	<i>[Signature]</i>
DATE	AUTHORITY	REVISION	SIG. AHSP.	SIG. D.O.

APPROVED <i>[Signature]</i> FOR CQA(A)		bw 8 363 012	3-0105875
AHSP:- CQA(A) KIRKEE		Membrane	ORDNANCE FACTORY PROJECT HYDERABAD
SNC.SH DOC No	SIGN DATE		
DRAWN			
EDT.CHKD			
F/M, DC.			
D.V.OFFR		Band 08k11-T-1-0,2 GOST 503-81	
	NAME SIGN DATE		