



MASTER SIZE ----- 24 mm.  
 DOT DIA -----  $\begin{matrix} +0.005 \\ -0.002 \end{matrix}$  0.025 mm.  
 LENGTH OF LINE ----- 0.2 mm.  
 THICKNESS OF LINE -----  $\begin{matrix} +0.005 \\ -0.002 \end{matrix}$  0.020 mm.  
 INNER CIRCLE RADIUS ----- 0.5249 mm. AT (12, 11.8130)

LINE 1	LINE 2	LINE 3
X1 - 11.200	X1 - 11.990	X1 - 12.600
X2 - 11.400	X2 - 12.010	X2 - 12.800
Y1 - 12.010	Y1 - 12.500	Y1 - 12.010
Y2 - 11.990	Y2 - 12.700	Y2 - 11.990

RANGE COORDINATES OF DOT

200M	12, 11.8130
400M	12, 11.5687
500M	12, 11.4236
600M	12, 11.2557
700M	12, 11.0648
800M	12, 10.8548

- NOTES:-
- 1- SURFACE ACCURACY -----  $\lambda/4$  OVER THE ENTIRE SURFACE
  - 2- PARALLELISM ----- 30"
  - 3- GRATICULE PATTERN TO BE FILLED WITH BLACK
  - 4- CLEAR APERTURE ----- 21.6mm
  - 5- FIG 1,2,3 ARE NOT TO BE PRODUCED ON THE GRATICULE, THESE ARE JUST FOR REFERENCE TO THE LINE FOR BORE SIGHTING
  - 6- TOLERANCE FOR RANGE DOT CENTRES & CENTRE OF INNER CIRCLE W.R.T. GEOMETRICAL CENTRE OF THE GRATICULE ----- +0.002 mm

**FOR TRADE ONLY**  
 Date of Issue 11-5-2015

MATL :- GLASS BSC 510644 Nd - 15097  
 FINISH :- AS ABOVE

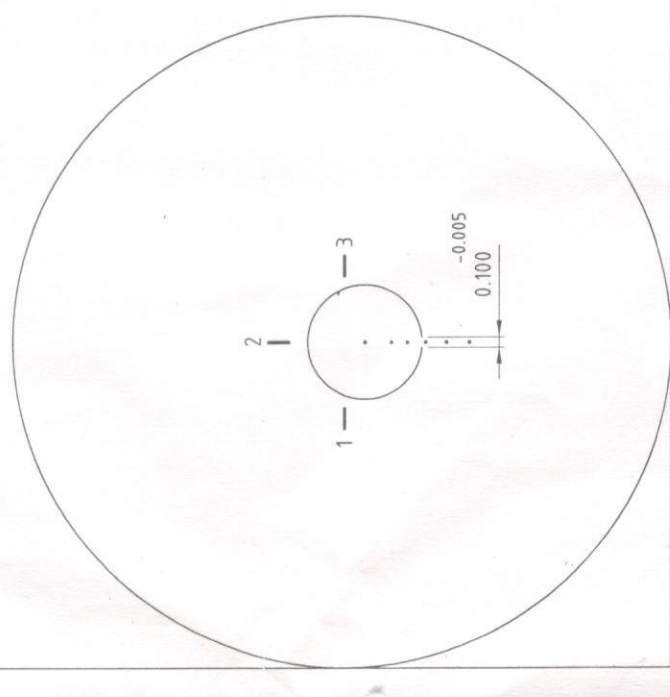

(0,0 REFERENCE POINT)

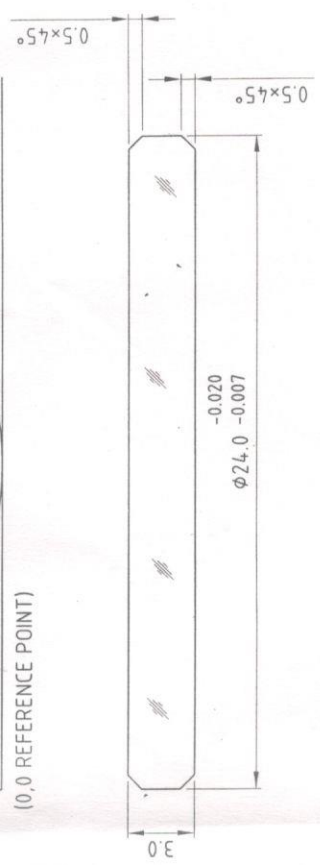

ORDNANCE FACTORY DEHRADUN	DR:- R.K. SHARMA	DATE-19.01.2015	SCALE- N.T.S
	TR:- CH:-	MATL: AS ABOVE	TREAT AS ABOVE
APPROVED: 		SHTS:- 1	SHT. No.:- 1.
AMENDMENTS: CFD/DD/002		DRAWING No. - MCT-3438	

TELESCOPE SIGHTING 5.56mm LMG (INSAS) 101A  
 RETICLE, OPTICAL INSTRUMENT

DRG. No. - IRDE-2605/17

JMM/DD