

UN CONTROLLED COPY
 CERTIFIED CORRECT COPY OF APPROVED
 DRAWINGS AT THIS DATE: 23/08/2022
 DESIGNED & DRAWING OFFICE: *[Signature]*
 ORDNANCE FACTORY, TRUHIRAPPALI - 620 016.

MATERIAL : IS: 5517-1993, GRADE - 42C4M62
 (OR) BS:970, PART-3, 1991, GRADE-709M40
 ALTERNATE MATERIAL : En19 (OR) En19A
 HARDNESS: 32 - 38 HRC
 PROTECTIVE FINISH : PHOSPATED TO SPECIFICATION. JSS : 0465-01-1988
 CLASS-1 (ACCELERATED) OIL FINISH ON ASSY.

MATERIAL FOR CASTING ROUTE:
 BS:3146, PART-1; 1974,
 TYPE - CLASS:5, GRADE-A.

DIMENSIONS ARE IN mm.
 UNTOLERATED DIMNS. AS PER IS : 2102 (MED)
 MARK DRAWING No.

PART NO.		DESCRIPTIONS		NO OFF		MATERIAL		TREATMENT		REMARKS	
DRAWN		SIGNATURE & DATE		SUB: LAUNCHER SHAFT		FOR: HOUSING LAUNCHER ASSY.		SCALE		STORE DRG. NO.	
CHECKED		<i>[Signature]</i>		OR: 40 mm MGL		DES. REF. NO. 30P 1105		1:1		30P 1105	
OIC/D&DO		MODEL OFFICER/ FOR MGL		DRG. NO. 30P 1105 - EXPL.		OPERATION NO.		SHEET NO. 1			
OFFICER/ 2482				ORDNANCE FACTORY							
DATE: 18/06/2018											

DIMENSIONS ARE IN mm.
 UNTOLERATED DIMNS. AS PER IS : 2102 (MED)
 SHARP CORNERS SHOULD BE BLUNT TO R0.5

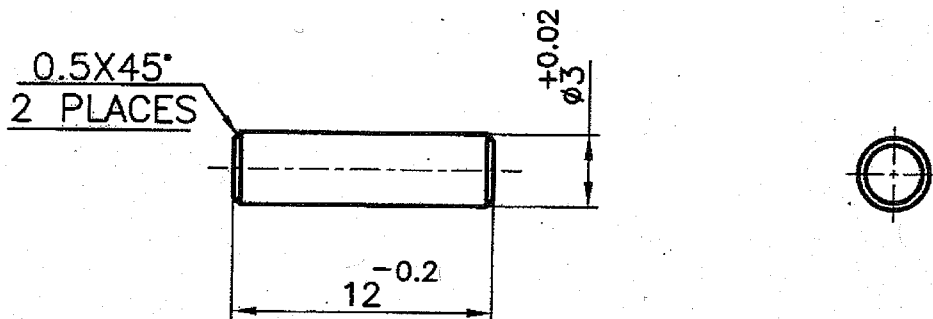

2 NOS. /GUN.

MATERIAL : IS: 1875 -1992, CLASS -4, DESIGNATION - 45C8.
(OR) BS: 970, PART -1, 1983, GRADE - 080M40.
ALTERNATE MATERIAL : En8 (OR) En9
HARDNESS: 32 -38 HRC

UN CONTROLLED COPY
 CERTIFIED CORRECT COPY OF APPROVED
 DRAWINGS AT THIS DATE 23/08/2021
 DESIGN & DRAWING OFFICE,
 ORDNANCE FACTORY, TIRUCHIRAPPALI -620 016.

PROTECTIVE FINISH : PHOSPHATED TO SPEC.
JSS:0465 - 01 - 1988 CLASS I OIL FINISH

PART NO.	DESCRIPTIONS	NO OFF	MATERIAL	TREATMENT	REMARKS
	SIGNATURE & DATE	SUB: <u>DOWEL PIN 3X12</u>			SCALE NTS
TRACED		FOR: <u>BLOCK STOCK LOCATING</u>			STORE DRG.NO.
DRAWN		OF: <u>40mm MGL</u>			OPERATION NO.
CHECKED		DES.REF.NO.			SHEETS: 1 SHEET No.: 1
HOS/D&DO		DRG. No.: <u>30P 5019</u>			
MODAL OFFICER/ FOR MGL.		ORDNANCE FACTORY TIRUCHIRAPPALI-16.			
OFFICER/ D&DO	APPROVED ON. 25/02/2015				

AMENDMENTS SIG. & DATE

1

2

3

4