

DRG. RETRACED AT CII, DEHRA DUN  
 TRACED BY: - *Shamir*  
 CHD. BY: - *Shamir*  
 DATE: - 10.9.80

D.C.(I):-0455-I(P), 2002-I, 2091-I, 3515-I, 5564-I, 5583-I.  
 5773-I, 5839-I.  
 POLYESTER NEGATIVE PREPARED AT COA(I) D DUN  
 PREPARED BY: - *Shamir*  
 CHECKED BY: - *Shamir* DATE: - 7/11/93

LOOP

(a) D.C.(I):-5839-I. FINISH AMENDED.		8.4.94	
D.C. 5773-I. POLY. NEG. PREP. & NEW COPY SEALED IN REPLACEMENT OF EXISTING ONE		9.10.93	
(c) D.C.(I):-5583-I.	MATL. SPECN. AMENDED.	22.8.92	
(b) D.C.(I):-5564-I.	NOTE SHEET AMENDED.	27.4.92	
(a) D.C.(I):-3515-I	CAT/PT. No. ADDED	20.12.76	
D.C.(I):-2091-I:-USE EXTENDED FOR SIGHT BORE AFV 104A & 107A		15.1.71	
D.C.(I):-2002-I:- DRG. SEALED		1.4.70	
D.C.(I):-0455-I (P):- DRG. PROV. SEALED		14.7.69	
AMENDMENTS			
(c) MATL:- STEEL, 19:187B +197B TV REVISION. (d) STEEL CLASS-4. (e) APPLY PRIMER TO IS 2074-1962 AND THEN PAINTED (IS 294 TO IS 5-1978) OF IS: 2982 +1978 EXCEPT BEARING SURFACES.			

DRAWN TRACED APPROVED s.d/- FOR DIRECTOR IRDE DEHRA DUN		CHECKED s.d/- s.d/-	SCALE:- 1:1 DATE:- 29.5.69	DRG. No. IRDE 379/15	CAT/PART. No. 5340-002427	SHS. SH.
--	--	---------------------------	-------------------------------	-------------------------	------------------------------	-------------

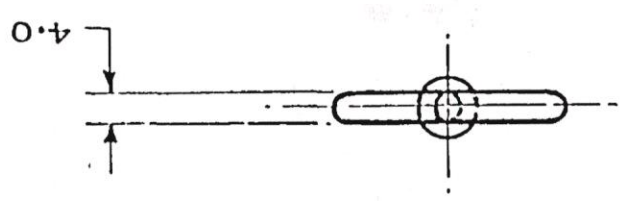
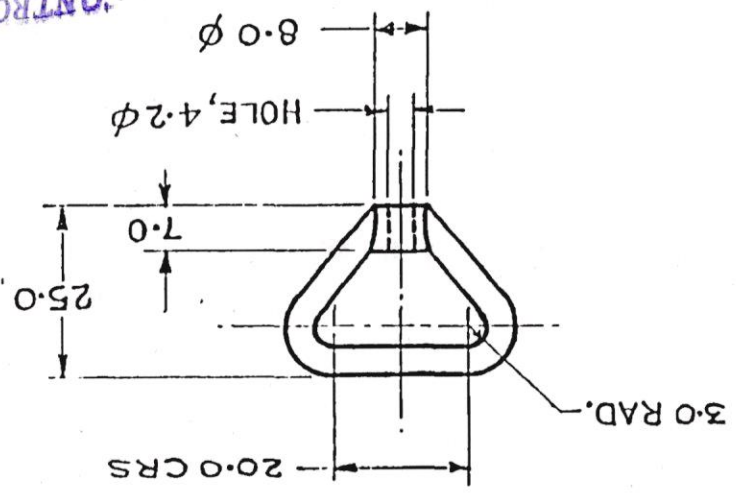

CONTROLLED COPY  
 Copy No. ....  
 Date of Issue 19.11.16

FOR EXPLANATION OF DIMENSIONING ETC., SEE COA(I) GUIDE NO. 001-1992.  
 THIRD ANGLE PROJECTION  
 DIMENSIONS ARE IN mm

92

TRACED AT CII DEHRADUN  
 TRACED BY:-  
 CHECKED BY:-  
 DATE:- 1.9.80

D.C.(I):- 0455-I(P), 2002-I, 2091-I, 3515-I, 5564-I,  
 5583-I, 5773-I, 5839-I.  
 POLYESTER NEGATIVE PREPARED AT CQA(I)-D.DUN  
 PREPARED BY:-  
 CHECKED BY:-  
 DATE:- 7/11/93

(A) D.C.-5839-I FINISH AMENDED.	8-4-94	
D.C.5773-I.POLY.NEG.PREP & NEW COPY SEALED IN REPLACEMENT OF EXISTING ONE.	9.10.93	
(D) D.C.(I):- 5583-I. MATL. AMENDED.	22-8-92	
(D) D.C.(I):- 5564-I. NOTE SHEET AMENDED.	27-4-92	
(D) D.C.(I):- 3515-I. NO. AMENDED & CAT./PT. NO. ADDED.	2012.76	Sd/-
D.C.(I):- 2091-I.- USE EXTENDED FOR SIGHT BORE AFY. 104AR107A.	15.1.71	Sd/-
D.C.(I):- 2002-I. DRG. SEALED.	1-4-70	Sd/-
D.C.(I):- 0455-I(P). DRG. PROV. SEALED.	1-4-70	Sd/-
AMENDMENTS		
MATL:- STEEL ROD, IS17283-1974 CHEMICAL- COMPOSITION 30 C 8 0: IS:1570 PT.II 1979		
APPLY PRIMER TO IS:2074-1962 AND THEN PAINTED (ISC294 TO IS:5-1978) & IS:8982-1978 EXCEPT BEARING SURFACES.		

DRAWN TRACED APPROVED		Sd/-
CHECKED		Sd/-
FOR DIRECTOR		Sd/-
IRDE DEHRA DUN		
SCALE:- 1/1		
DATE:- 29.5.69		
DRG No.		
IRDE 379/16		
CAT/PART No.		
5310-003244		
SHEETS		

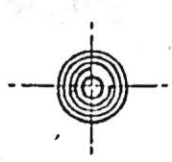
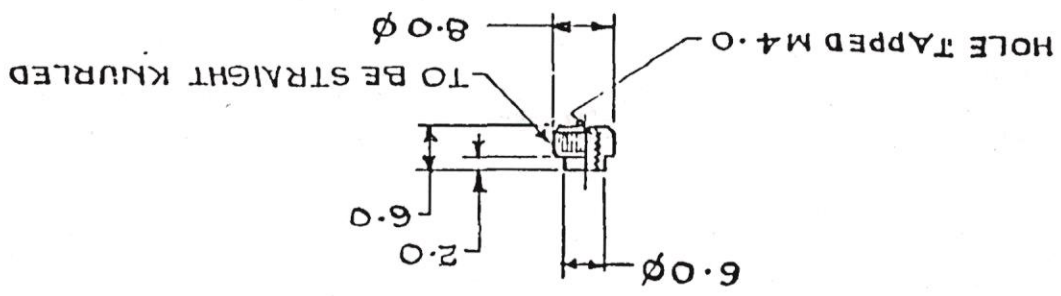

FOR EXPLANATION OF DIMENSIONING ETC., SEE CQA(I) GUIDE No. 001-1992  
 THIRD ANGLE PROJECTION  
 DIMENSIONS ARE IN MILLIMETERS.

CONTROLLED COPY  
 Copy No. ....  
 Date of Issue 19.11.76

23