

DRG. No. GCF/50/41062

FOR OTE (INDIGENISATION) ACTION ONLY

ALL DIMENSIONS ARE IN mm UNLESS OTHERWISE STATED

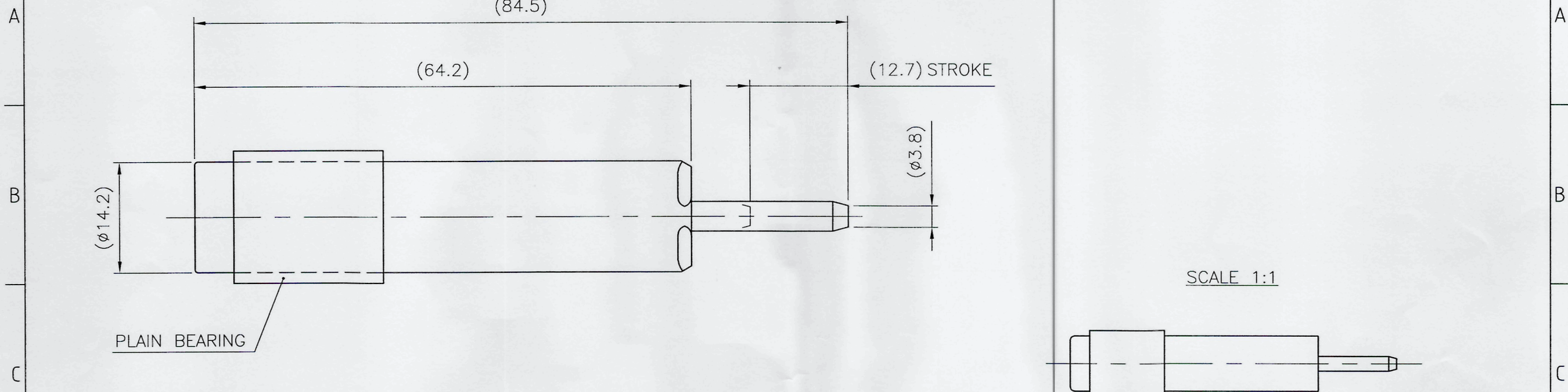

ENERGY CAPACITY: 480 IN.LBS
 SHOCK FORCE: 1200 LBS
 WORKING TEMPERATURE: -20°C-+60°C

P.No.	NOMENCLATURE	No. OFF	MATERIAL	HARDNESS	STANDARD	REMARKS
GEN. TOL. NOT SPECIFIED						FOR Sr. GM G.C.Fy.
LINEAR DIMENSIONS						2022 NAME DATE
0-6	±0.1					DRN. AK 08/03
6-30	±0.2					
30-120	±0.3					
120-315	±0.5					
315-1000	±0.8					CKD.
1000-2000	±1.2					
ANGULAR DIMENSIONS						INDEX AMENDMENTS SIGN DATE APPROVED
0-10°	±1°					
10-50°	±30'					
50-100°	±20'					
>100°	±10'					
~ UNMACHINED						
▽ ROUGH						
▽▽ SMOOTH						
▽▽▽ FINISH						
<h2 style="text-align: center;">SHOCK CARTRIDGE</h2>						MATERIAL
						SCALE REF.DRG.NO.
GUN CARRIAGE FACTORY, JABALPUR						ASSY/SUB ASSY NO. 5187179
						DRG. No. GCF/50/41062 SHEET NO. OF SHEETS