

8009-K 'ON'GRD

DIMENSIONS ARE IN mm.
 UNTOLERATED DIMNS. AS PER IS : 2102 (MED)
 MARK DRAWING No.

NOTE:- REMOVE ALL SHARP CORNERS

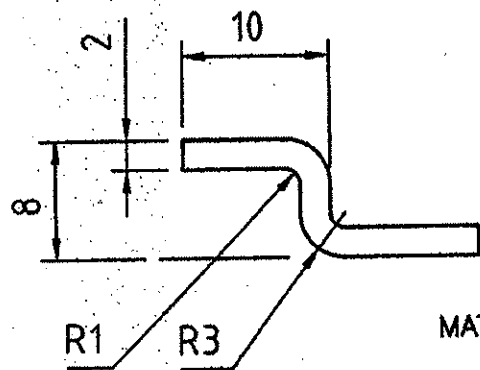
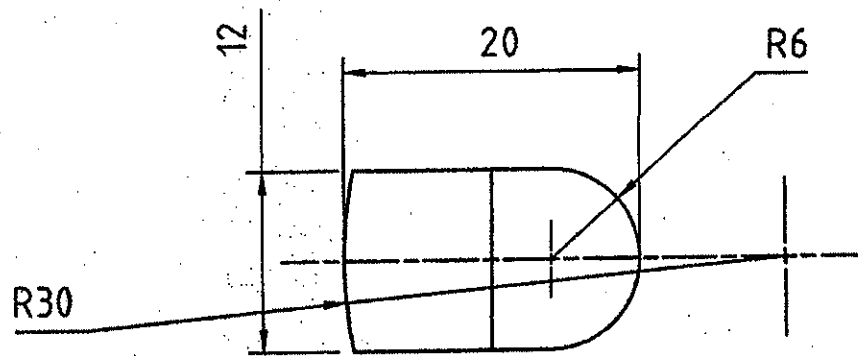

MATERIAL:- BS 7226 C40
 HARDNESS :- 280-330 HV

PROTECTIVE FINISH :-
 PHOSPHATED TO SPECN
 WPN/GEN/3 CLASS II, OIL FINISH

K-6008

Se. Kna
 DGM
 NODAL OFFICER
 (TAR)

PART NO.	DESCRIPTIONS	NO OFF	MATERIAL	TREATMENT	REMARKS
	STOP SHOULDER PAD				
	SIGNATURE & DATE: <i>SK</i>				SCALE NTS
	TRACED				FOR: BUTT FRAME ASSY
	DRAWN				OF: TRICHY ASSAULT RIFLE
	CHECKED				DES.REF.NO.
	HOS/D&DO				DRG. No.: TAR-RB-K-6008
	OFFICER/PRODN.				OPERATION NO. ---
	OFFICER/D&DO				SHEETS: 1
AMENDMENTS	SIG. & DATE				SHEET No.: 1

FT ORDNANCE FACTORY
 TIRUCHIRAPPALLI-16.

8009-K 'ON'GRD

DIMENSIONS ARE IN mm.
 UNTOLERATED DIMNS. AS PER IS : 2102 (MED)
 MARK DRAWING No.

NOTE:- REMOVE ALL SHARP CORNERS
 2 RIVETS PER ONE FRAME ASSY

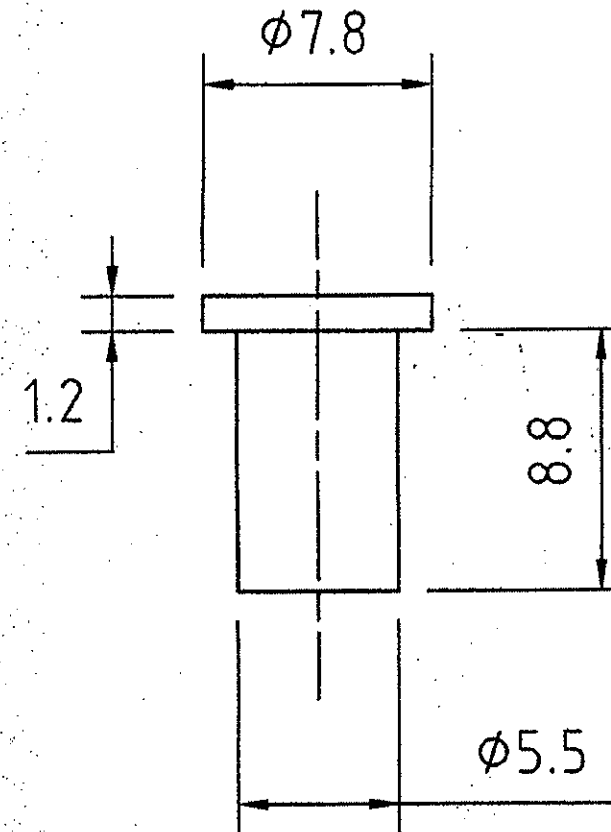

MATERIAL: BS 970 PT.1 SEC. 2 Gr. 080 M40 (En-8)

K-6007

Se. Kna
 DGM
 NODAL OFFICER
 (TAR)

PART NO.	DESCRIPTIONS	NO OFF	MATERIAL	TREATMENT	REMARKS
	RIVET SHOULDER REST				
	SIGNATURE & DATE: <i>SK</i>				SCALE NTS
	TRACED				FOR: BUTT FRAME ASSY
	DRAWN				OF: TRICHY ASSAULT RIFLE
	CHECKED				DES.REF.NO.
	HOS/D&DO				DRG. No.: TAR-RB-K-6007
	OFFICER/PRODN.				OPERATION NO. ---
	OFFICER/D&DO				SHEETS: 1
AMENDMENTS	SIG. & DATE				SHEET No.: 1

FT ORDNANCE FACTORY
 TIRUCHIRAPPALLI-16.

CERTIFIED CORRECT COPY
 OF APPROVED DRAWINGS
 AT THIS DATE: 4.12.17

Design & Drawing Office
 Ordnance Factory,
 Tiruchirappalli-620016