

09L100-51E5

ON FOR EXPLANATION SEE D.D. NOTE SHEET NO. 3
 DIMS. ARE IN MM.

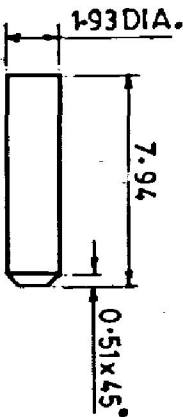

NOTE :-
 WHERE TOLERANCES ARE NOT
 SHOWN DIMENSIONS IN WHOLE
 NUMBER OR WITH ONE DECIMAL
 PLACE ± 1.27mm. DIMENSIONS
 WITH TWO DECIMAL PLACES ± 0.13mm

METRIC

20.4.99	24336-SA	MATERIAL AMENDED						
02-5-98	24094-SA	PROFORMA CHANGED, PROTECTIVE FINISH AMENDED. NEG. RE-TRACED AND DRG. RE-SEALED.						
DATE	AUTHY.	PREVIOUS D.C. NOS. 14976-SA, 15497-SA & 16043-SA.						
		BRIEF RECORD						
SEALED:- D.C. NO. 14976-SA, DT. 7.1.77								
DRN	CHD.	TRD. <i>Steel</i>	COMP. <i>Mason</i>					
SCALE :- 4:1		EST. MASS						
DT. 02-5-98		APPROVED DT. 19.6.67 NEG. RE-TRACED						
MATERIAL :- <i>Steel</i> M20 COLD DRAWN.								
H.T./HARDNESS :-								
PROTECTIVE FINISH :-		PHOSPHATED TO SPECN. JSS:0465-01: 1988 CLASS 1, OIL FINISH.						
NOMENCLATURE :-		PIN, FIXING, GAS CYLINDER.						



1 2 3 4