

SLOT 2.54 ± 0.25 WIDE X
2.54 ± 0.25 DEEP

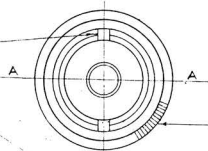

ENLARGED VIEW OF UNDERCUT

SCALE - 2:1

MAJOR DIA 23.393-23.185
EFF. DIA 22.483-22.347
MINOR DIA 21.565-21.316

MILLED PITCH 0.76 AT
BOTTOM, DEPTH 0.25

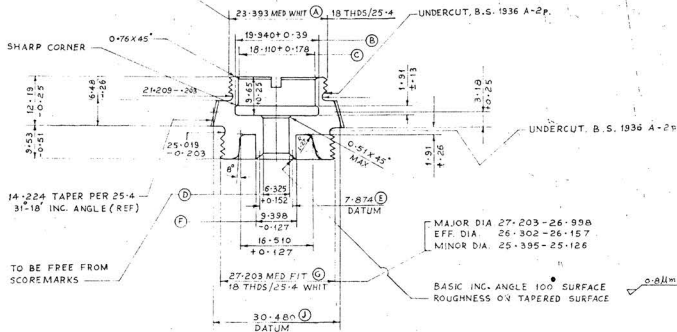

SECTION A A

GEOMETRICAL TOLERANCES				
GROUP	FEATURE	CHARACTERISTIC	TOLERANCE	DATUM
1	DIA (D), (E), (F), (I)	CONCENTRICITY	ZERO	DIA (G) (MMC)
	DIA (A)	CONCENTRICITY	0.051 DIA (MMC)	DIA (G) (MMC)
2	DIA (B), (C)	CONCENTRICITY	ZERO	DIA (A) (MMC)

MATERIAL :-
BRASS BS 249 OR ALTERNATIVELY IN INDIA
BRASS TO BS 2874 - CZ 121 3 PB

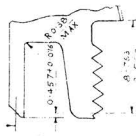

ENLARGED VIEW OF CHAMFER

SCALE - 5:1



ACTUAL SIZE

4.4.03	13-6-67	SCANNED WITHOUT CHANGE RETRACTED WITHOUT CHANGE				DRN.	CHD	TCD DMM	COMP. 2	ASSY. DRG.
		PREVIOUS D.C. (1) NOS - 2 B16-A, 10448-A, 20334-A, 30258-A, 30338-A, 31002-A, 33503-A				C/D/MAN	01/C.D.O	SCALE - 2:1	EST. MASS:-	QX 186 GE, QX 189 GE
R.M.	DATE	AUTHORITY	REVISION	ZONE	ANSP. D. D. SIGN	APPD.	FOR C.I.(A).	GAUGE SCHD:-	DATE:- 8.6.68	
						MAT'L:- AS ABOVE	PROTECTIVE FINISH:-			D. GUNER'S REF LS/9978/E/341
										PART NO QX 1666
										D.S. CAT. NO
										ANSP:- C.I.(A) KIRKEE

BUSH