

DRG. No.

DIMENSIONS ARE IN mm.
UNTOLERATED DIMENSIONS AS PER IS. 2102 (MEDIUM)

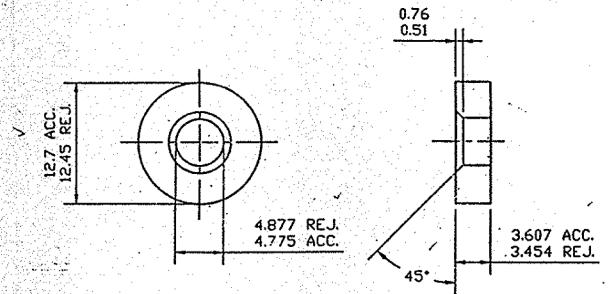

- ✓ MATERIAL: STEEL BS.1449, Pt.1, 1983 CONDITION CS.Gr.4 (OR)
 STEEL BS.970, Pt.1, 1983 SEC.2, Gr.070 M20 CD
- ✓ TREATMENT & FINISH:-
 HARD & TEMPD. ANTIRUST FINISH TO
 SPECN. WPN/GEN CLASS-II. ~~ONE SIDE TO BE PAINTED~~
~~TO SPECN. DEF.1407 WITH GLOSSY FINISH~~
- PROTECTIVE FINISH:-
 ✓ PHOSPHATE TO SPECN. JSS.0465-01:1988
 CLASS-1 OIL FINISH

ok

PART NO.	DESCRIPTIONS	NO OFF	MATERIAL	TREATMENT	REMARKS
	SUB: WASHER, SPRING, BOLT LOCKING				SCALE 2:1
	FOR: .315" SPORTING RIFLE				STORE DRG. No.
	DES. REF. NO: D.S.CAT.No.5310-003184				OPERATION NO.
	DRG. NO: 29 P 0068*				
	ORDNANCE FACTORY TIRUCHIRAPALLI-16.				SHEETS: 1 SHEET NO: 1
AMENDMENTS	SIG. & DATE	APPROVED ON: 10/04			

DA. No.
8996/14/
DDO/01
29.5.09

29

TRACED
 DRAWN *R. Sathya*
 CHECKED *S. Sathya*
 TOIC/D&DO *V. Sathya*
 PROD. OFFICER
 DIV. OFFICER
 D&DO

SIGNATURE & DATE
 FOR: .315" SPORTING RIFLE
 5P-6B
 DES. REF. NO: D.S.CAT.No.5310-003184
 DRG. NO: 29 P 0068*

ORDNANCE FACTORY TIRUCHIRAPALLI-16.