

REFERENCE

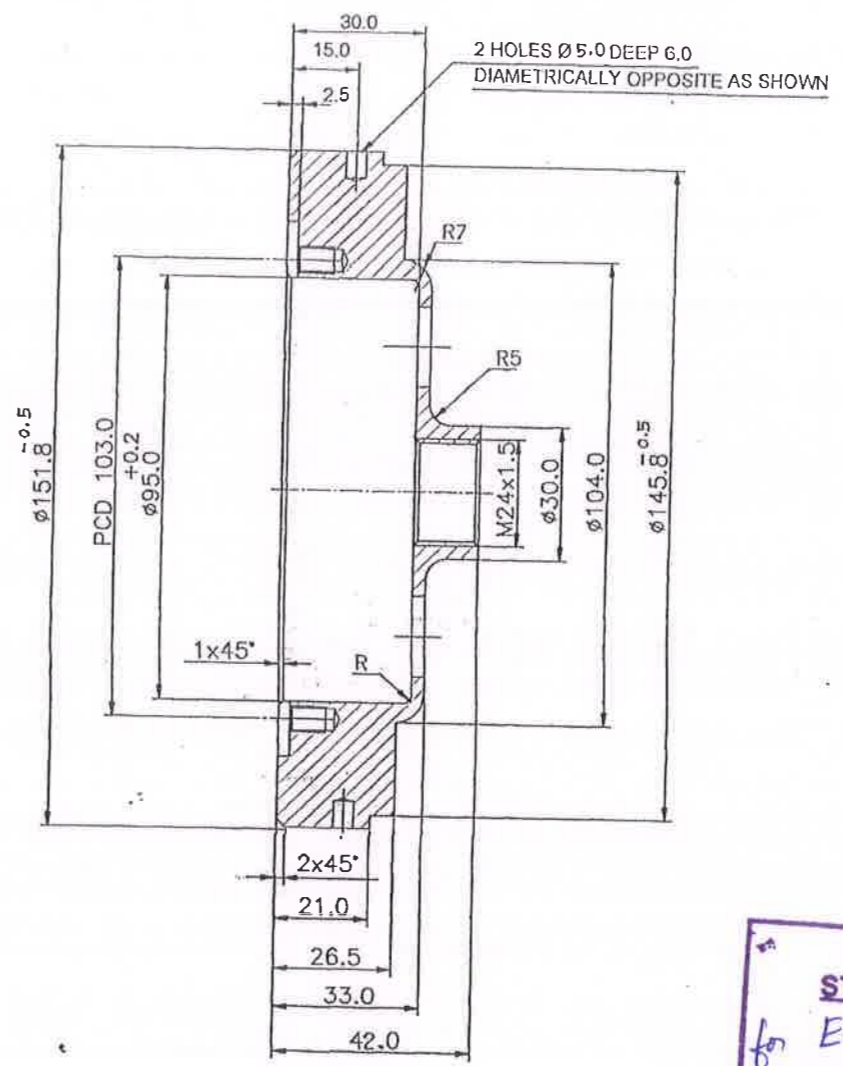

(TO BE DRILLED DURING MANUFACTURING)

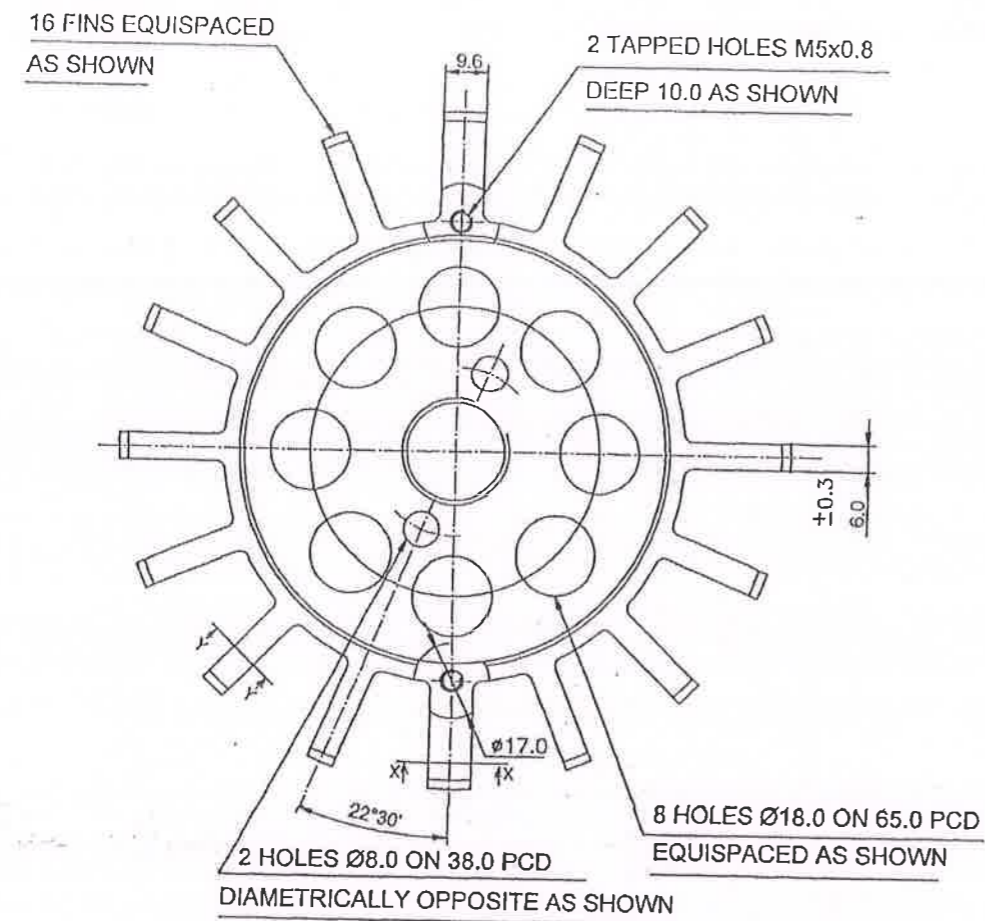
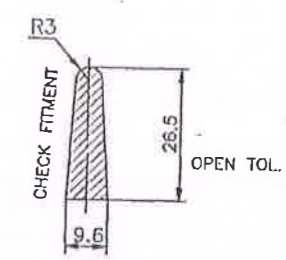

SECTION 'X-X'

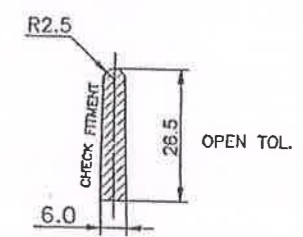

SECTION 'Y-Y'

ISSUED BY
STANDARD CELL
for EOI
DATE: 9/6/19
SIGNATURE:

MATL SPEC:- IS:2856-87, Gde 3 NORMALISED CONDITION

- NOTES:
1. GEN. TOL. SPEC. IS : 2102
 2. Ø95.0 TOL. ON POSITIVE SIDE
 3. CHROMIUM PLATING THICK 40 MICRON TO IS : 1337
 4. BLOW HOLES TO BE REPAIRED AS PER IS: 5530:1969

R NO	DATE	ZONE	BRIEF RECORD	AUTHORITY	INITIALS	SCALE:- 1:1	DIMENSIONS ARE mm	TOL	DS CAT NO	ASSY DRG NO. NASK 1068 (PROV)
21-01-16	F-12 B-7A		DRAWING AMENDED	ARD 2490		DGN	DRN	TCD	COMP	ASSY DRG LIST NO.
13-02-14	D-3&5		DIMENSIONS AMENDED	ARD 2453		PASSED	APPROVED		CHD	
14-1-11			2 HOLES Ø4.5 AMENDED	ARD 2413						
02-06-07			APPROVED	DGNAI						
						MATL:- STEEL CASTING	THREADS TO CONFIRM IS:4218			DTE GEN OF NAVAL
						MATL SPEC:- SEE DRG	STORE SPEC NO:-			ARMAMENT INSPECTION
						PROTECTIVE FINISH: SEE DRG	STORE REF NO:-			IHQ, MOD (NAVY) NEW DELHI
							GAUGE SCH NO:-			

DIAPHRAGM (ASSY ADAPTER)

DRG. NO
NASK 1068/7
(PROV)

TRIM ON THIS LINE WHEN SUPPLY TO TRADE