

DRG NO:
0 ADF 155 2 010

REV	8
-----	---

DRAWING CONVENTIONS CONFORM TO INDIAN STANDARD DIMENSIONS IN MM UNLESS OTHERWISE STATED.

REFERENC

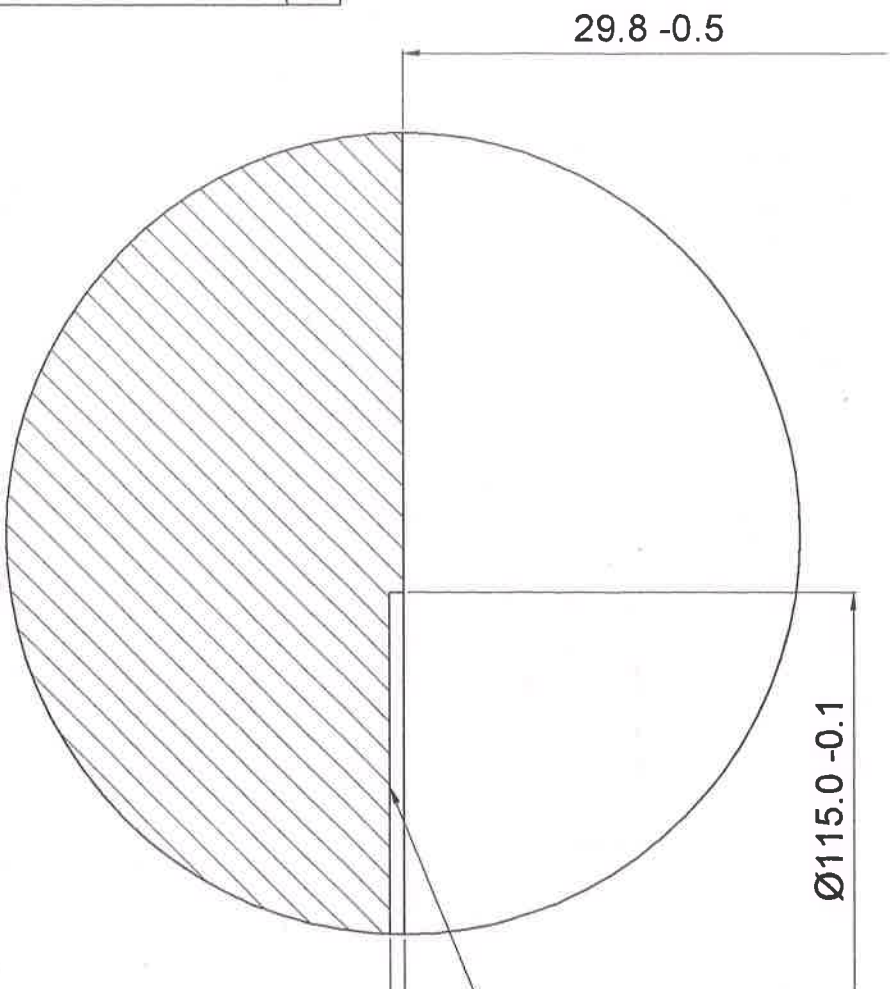

0.2 +0.2 THIS AREA SHALL NOT BE MACHINED

DETAIL - Y

ISSUED BY
STANDARD CELL
DATE: 7/6/19 SIGNATURE: *[Signature]*

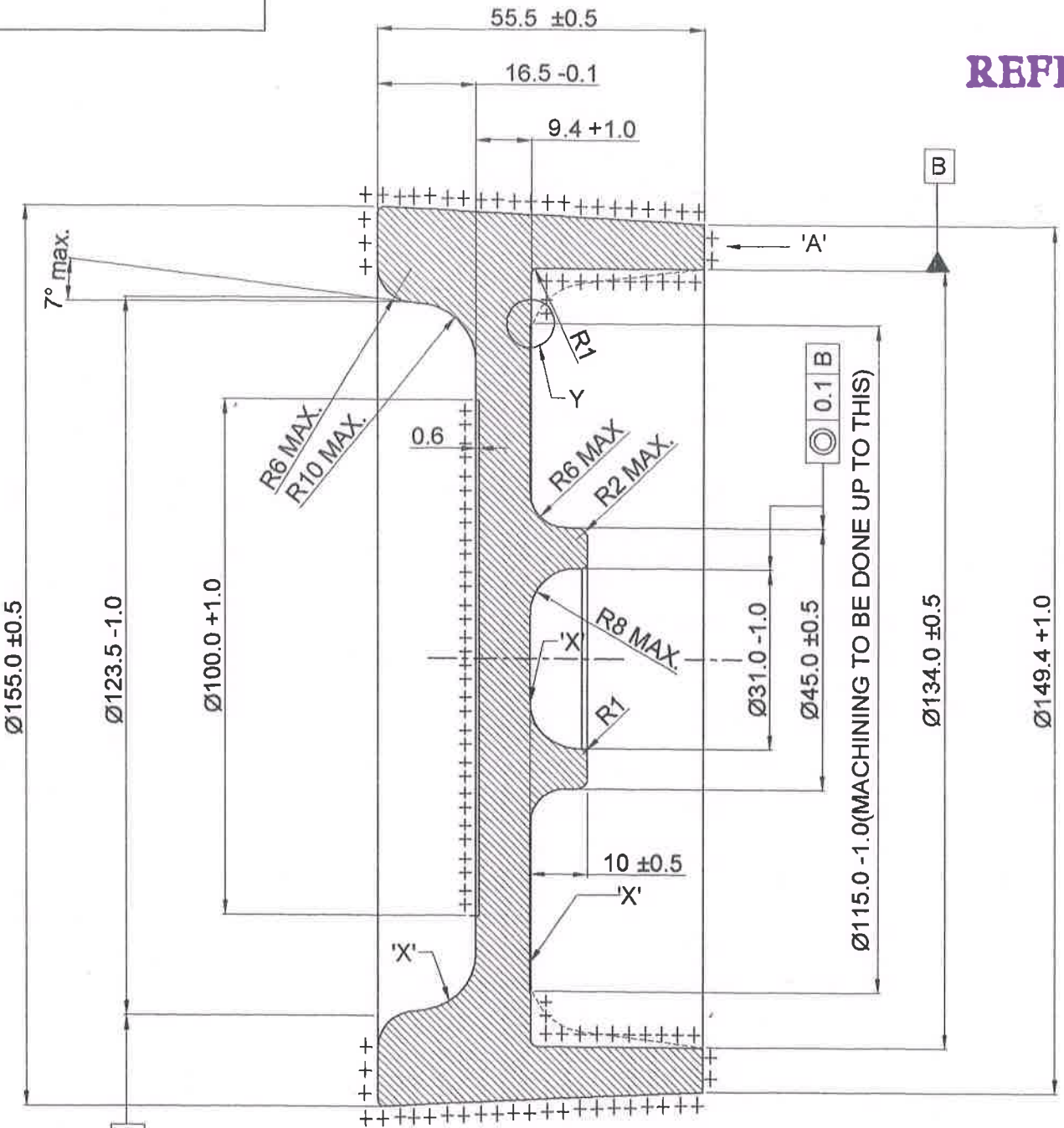

++ PROOF MACHINING MUST BE DONE

REMOVE ALL SHARP EDGES
ALL DIMENSIONS ARE IN mm

NOTES

1. THE FORGING SHOULD BE HEAT TREATED TO OBTAIN MECHANICAL PROPERTIES IN ACCORDANCE WITH CONDITION "V". BS 970 PART I 1983 AND SHOT BLASTED TO REMOVE SCALE IN THE FORGINGS
2. FORGING SHOULD BE SUPPLIED AFTER PROOF MACHINING
3. FORGING SHOULD BE FREE FROM CRACKS & FLAWS
4. 100% MAGNETIC PARTICLE TEST MUST BE DONE FOR CRACK DETECTION
5. 'X' -FORGING WITH PIT / DENT MARKS ON THIS SURFACE IS NOT ACCEPTABLE
6. DIMENSIONS SHOWN IN THE DRG. ARE AFTER PROOF MACHINING

8	CONCENTRICITY WITH RESPECT TO DATUM 'B' ADDED	11-03-10
7	MASS ADDED; NOTE-8 AMENDED; DIM 9.4 +1.0 WAS 9.4 ±0.7	21-11-08
6	IN MATERIAL LIST, OTHER THAN STEEL 709 M40 ARE REMOVED	22-10-08
MATERIAL	5. DIM16.5 WAS 17.1; PROOF MACHINING SURFACES ADDED; DETAIL Y ADDED NOTE-8 ADDED, SIDE VIEW REMOVED; NOTE-1 AMENDED; MATERIAL AMENDED	16/01/08
BS-970 PART-1 1983	4. TOL. ADDED	23/11/07
STEEL 709 M40	3. NOTE 1 AMENDED NOTE 6 DELETED	08/10/07
	2. IN NOTES STRESS RELIEVING ADDED & HARDNESS 32-35 WAS 31-37 HRC. POINTS No.5 & 6 ADDED.	17/9/07
	1. DIM.R6 & R8 WAS R1	23/8/07
REV	ALTERATIONS	DATE
TITLE :		CHECK
ADAPTOR FORGING		HOS/DDO
		APPRD.
HEAVY ALLOY PENETRATOR PROJECT		DATE
		SCALE
TIRUCHIRAPALLI		SHEET
		1 OF 1
EST.MASS		DRG. NO:
3310g +50.0 g		0 ADF 155 2 010
		REV
		8