

(B. JAYAVELU, JTD)
14-07-06

"COMMON TO T-90"
DRG RE-INDIANISED BASED ON RUSSIAN ORIGINAL ISSUE - 5

DRAWING NUMBER 172.45.147 SHEET No 1 OF 1

UNLESS OTHERWISE SPECIFIED Rz 80 ✓(✓)

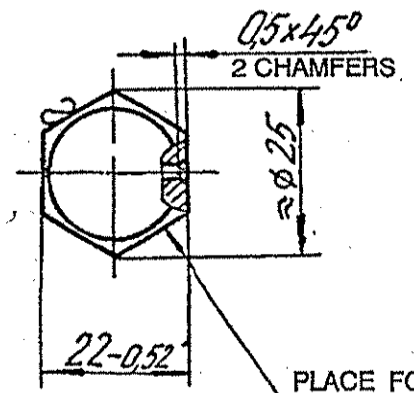
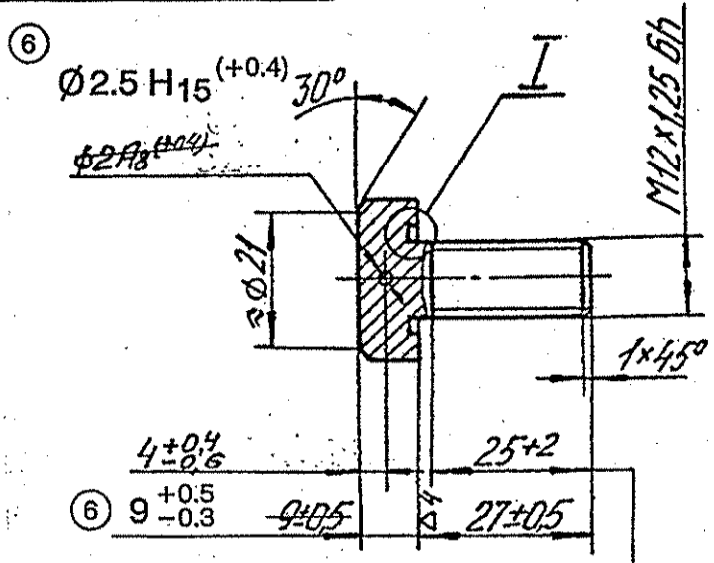

THREADED GAUGE
SHOULD BE SCREWED IN
AT A LENGTH NOT LESS THAN 20 MM

PLACE FOR
MARKING & CHECKING
HARDNESS

SCALE 5:1

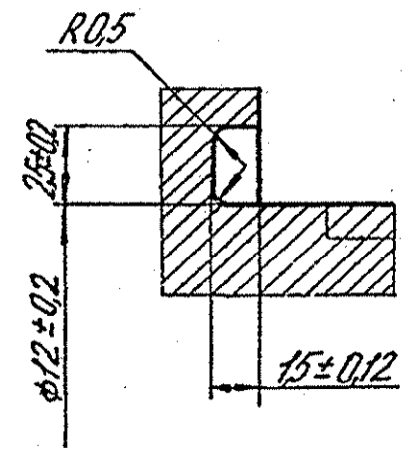

1. COMPONENT MAY BE MANUFACTURED FROM STEEL 35X AND 45X, GOST 4543-71.
2. TO BE HARDENED ON BLANK. BHN 302-255 (DIA OF IND. 3.5-3.8).
3. INDUCTION HARDENING TO OBTAIN BHN 415-311 (DIA OF IND. 3.0-3.45) IS ALLOWED WHEN MANUFACTURING THE COMPONENT FROM STEEL 38XC GOST 4543-71.
4. WHEN MAKING THREAD BY KNURLING IT IS ALLOWED TO MAKE THE UNCUT PARTS OF THE BOLT BODY ACCORDING TO A PITCH DIAMETER OF THE THREAD.
5. TO BE OXIDIZED / PHOSPHATED.

6B ALT. MATL. :- STEEL 817M40 (En 24) TO BS : 970 Part 1 : 1983 6A 188.45.001cb-3Cb

PILOT SAMPLE SHOULD BE APPROVED BY A H S P BEFORE BULK PRODUCTION.

EST. WT. (Kg) 0.047 TO BE STAMPED OR MARKED WHERE INDICATED THUS # (LETTERS)

ALL SHARP EDGES AND CORNERS TO BE REMOVED UNLESS OTHERWISE STATED MACHINED CORNERS TO HAVE R OUTSIDE R INSIDE EQUIVALENT CHAMFERS ARE PERMISSIBLE.

DRN	Sd/=	MATERIAL :-	USED ON :-
CHD	Sd/=	STEEL 38XC	175.45cbCb
APPD	Sd/=	GOST 4543-71	172.45.060cbCb
DATE	12-12-94	CONTROLLERATE OF QUALITY ASSURANCE (HEAVY VEHICLES)	
SCALE:- 1:1		AVADI	
DIMENSIONS IN mm		TITLE :-	
TOLERANCE ON DIMNS UNLESS OTHERWISE STATED IS : 2102-69		BOLT	
6B	07.07.06	AUTHY.LINo.80001/CQA(HV)/GEN/Dt.15.10.05	D S CAT NUMBER
6A	25.10.04	N OF A No.CQA(HV)/T90/45/001	DRAWING NUMBER
6	1.7.91	172M.5 "A" 89 (AL.12 BK / 1)	172.45.147
ISSUE	DATE	NATURE OF AMENDMENTS	

F-86
SIZE A3