

CHEM. COMP. -
 C % = 0.33-0.40
 Mn % = 0.25-0.50
 Si % = 0.17-0.37
 Cr % = 1.20-1.50
 Ni % = 3.00-3.50
 Mo % = 0.35-0.45
 V % = 0.10-0.18
 S % = 0.012 max.
 P % = 0.012 max.

MATL. - STEEL - OKH3MA
 (TEST SAMPLE)
 0.110
 CONFORMING TO SPEN.
 GOST B 5192-78.

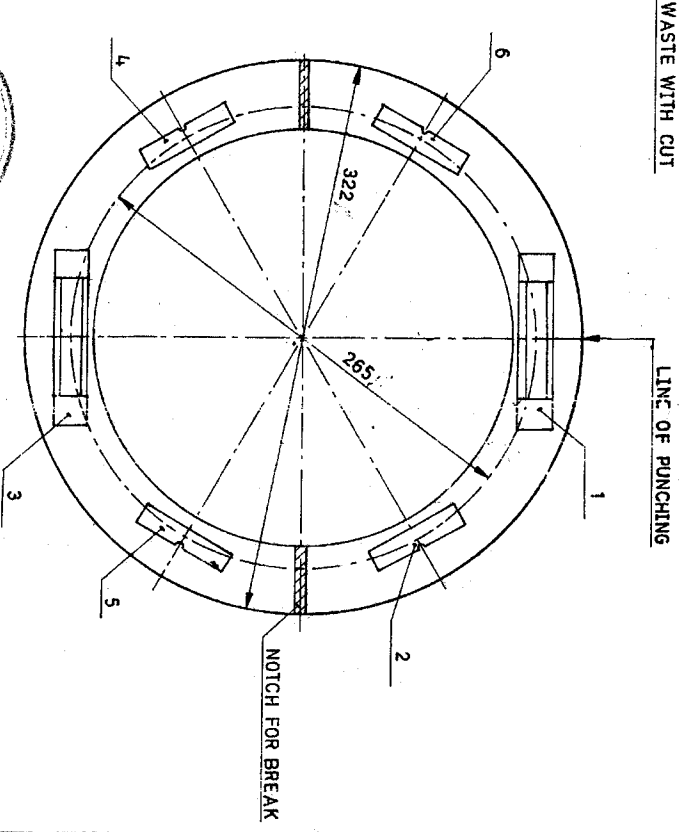

Handwritten signature and date:
 23/7/20
 21.3.90

METAL & STEEL FACTORY
 ISHAPORE
 REGD NO - Sec/352
 DATE 16.5.90.

1079(110)	20	0.28(2.9)	0.20(2.0)
MINIMUM			
LIMIT OF PROPORTION- ALITY MPA (N ₅ /mm ²)	MINIMUM PERCENTAGE REDUCTION	FOR QUALITY FOR HIGH STEEL	FOR QUALITY FOR HIGH STEEL
		AT TEMP +20°C	AT TEMP -50°C
IMPACT STRENGTH - (Kgf/m ² /cm ²)			

DRN - Sd/-	ORD FY KANPUR
TRD - Sd/-	HEAT TREATMENT BLANK
CKD - Sd/-	PYL. FOR CASING
F/DO - Sd/-	DRG. NO-2A26-01-2
F/SHP - Sd/-	APVD.
DRG. NO. - SK 6115	SCALE - 1:2
DATE - 23.8.84.	THIRD ANGLE
SHT	DIVNS IN mm
PROJECTION	

DRG. No. F-1482/A

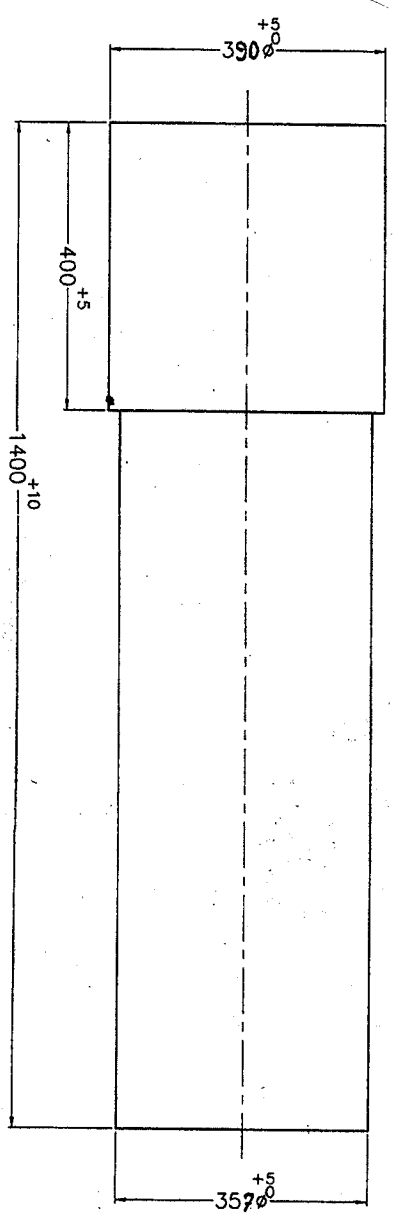

FORGING WEIGHT - 1203 Kgs. (Appx)

FORGING SKETCH

DRG. No. F-1482/B

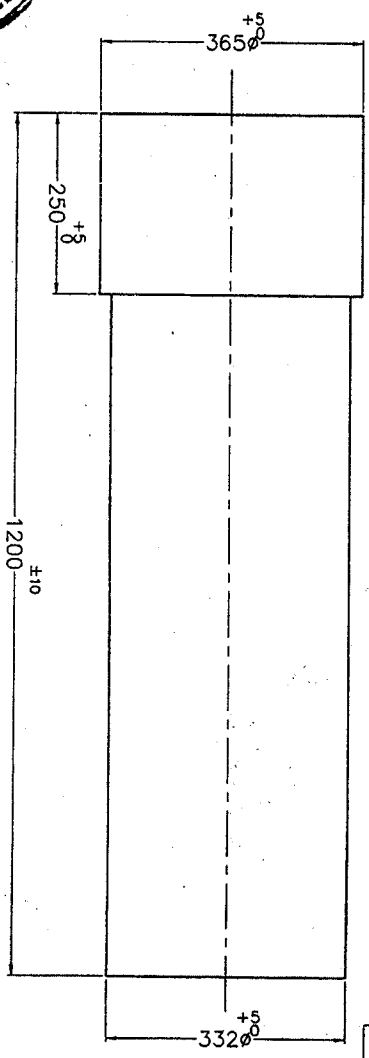

ROUGH MACHINING (U/T PASS) SKETCH

DRG. No. F-1482/C

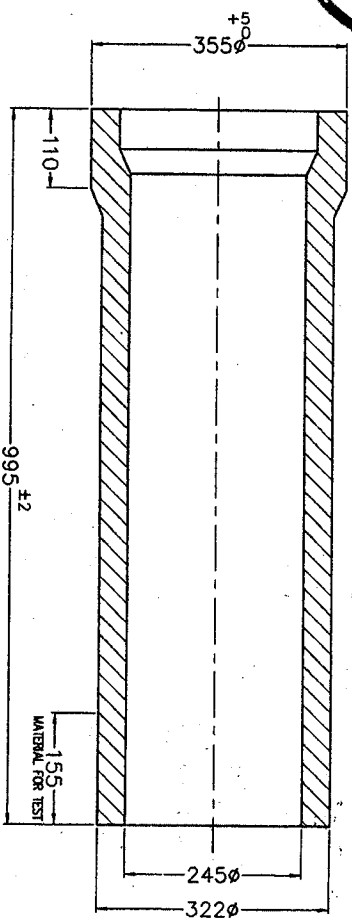

P Y T SKETCH

UN CONTROLLED

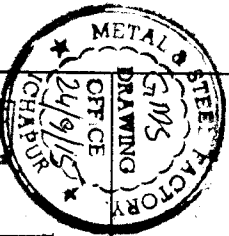

ALL DIMENSIONS ARE IN mm.

MATERIAL :-
STEEL OXH3MØA 0-110
CONFORMING TO SPEN. GOST B5192-78.

NOTES :-

- (a) FORGING SHALL BE FREE FROM PIPING, LAMINATIONS, CRACKS, SEGREGATIONS & OTHER DEFECTS.
- (b) FORGING SHOULD SATISFY ULTRASONIC AND MAGNA FLUX TEST.
- (c) CONCENTRICITY BETWEEN FORGE DIAS. 1mm.
- (d) BEND IN THE CASING NOT TO EXCEED 5mm. THROUGH -OUT THE LENGTH.

MODIFIED CHEMICAL COMPOSITION GOST 5192-78 :-

ELEMENT	C%	Mn%	Cr%	Ni%	Si%	V%	Mo%	S%	P%	(S+P)%
MIN	0.33	0.25	0.85	3.00	0.17	0.10	0.50	-	-	-
MAX	0.40	0.50	1.20	3.50	0.37	0.18	0.70	0.012	0.012	0.022

[Signature]
H.O.S/N.G.

[Signature]
H.O.S/G.M.S.

AMENDMENTS	INDEX

DESCRIPTION	SCALE	DATE	NAME	ZONE
FORGING, ROUGH MACHINING (U/T PASS) & P Y T SKETCH OF CASING T-72	1 : 5	14-03-11	S.K.DALAL	

STORE DRG. No. - 2426-01-9
REF. FOR DRG. NO. - FGK/FORGE/113/3 - EDITION No.2
M.S.F. DRG. REGD. NO. - 17697
METAL & STEEL FACTORY, ISHAPUR

DRG. NO. - F-1482/A, B & C.

APPROVED
[Signature]
HOS/DO

APPROVED
[Signature]
AMM/DC