

IMSA - 0157

COPY ISSUED BY CDD/ICFAJ  
 वर प्रिनि की की/श्री. एच. डी. शी.  
 कार की गई है।  
 दिनांक: श्री. का. र. / श्री. की. श्री.  
 HOS/CDD  
 Date :

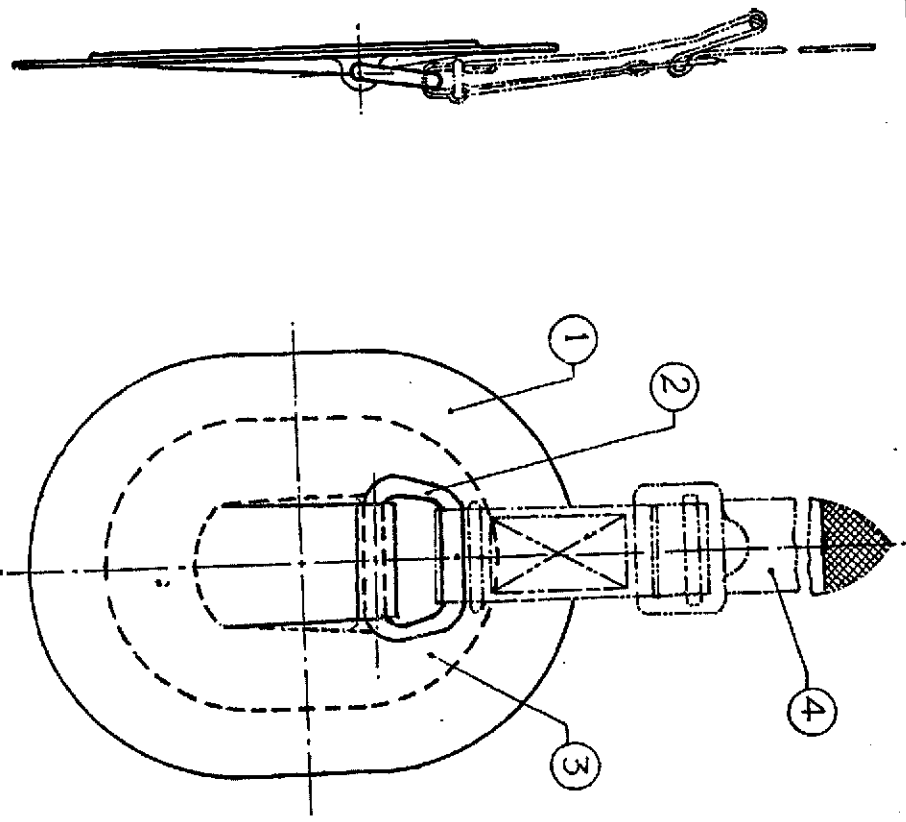

# PATCH STRAP ASSY

CAT/PT No. 14/5420/000069  
 DRG BASED ON 14/242

Sl. No.	DRG PART No.	No. to A SET	NOMENCLATURE
4	IMSA-015B	1	STRAP SADDLE ASSY
3	IMP0-0945/B	1	PATCH OVAL WITH TRAPEZOIDAL RING
2	IMP0-0945/C	1	STRAP, TRAPEZOIDAL
1	IMP0-0944	1	COVER OVAL 280 x 220 mm

DRG NOT TO BE SCALED  
 ALL SHARP EDGES & CORNERS TO BE ROUNDED OFF  
 ALL DIMENSIONS ARE IN mm UNLESS OTHERWISE SPECIFIED  
 NOMENCLATURE

PERTAINS TO :-  
 IMG.A. 0086/D  
 (SHEET 2 OF 2)

AS STATED

SCALE :- 1:2

CONTROLLERATE OF INSPECTION ENGINEERING EQPT

ES/14/275	12 31 9 30	C-2	IN PART LIST IMPD-0948 R.0945 ADVANCED THIS DRG. ADVANCED TO/C	DRN	TCD	CHD	PSD	APPD	DATE	26-6-86
315	12 31 9 30	C-2	DRG. RETRACED WITH ALL AMENDMENTS UP TO/A	Sd	Sd	Sd	Sd	Sd	26-6-86	

DATE BY: - *Heureka*

DATE BY: - *Dansure*

COMMAN: *S. S. Thakur*

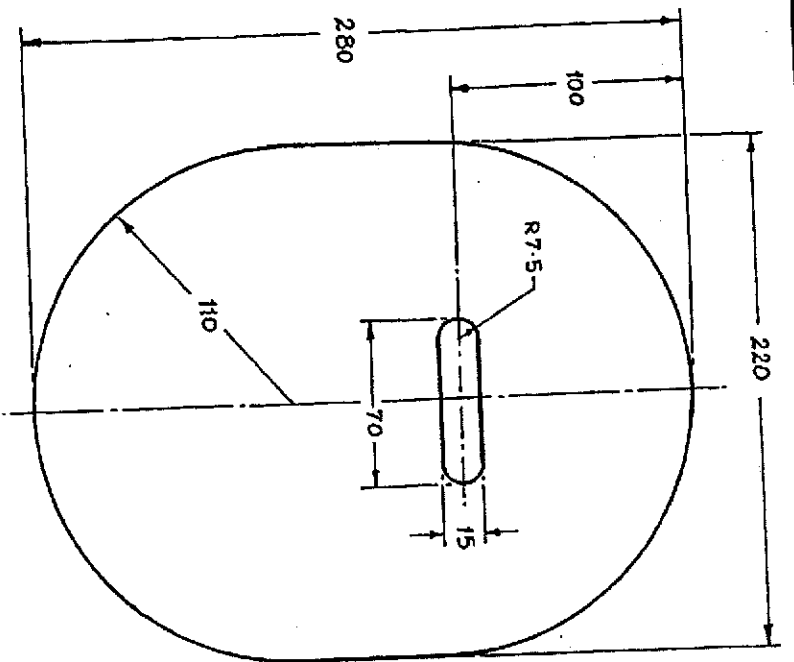

COPY ISSUED BY CDD/CFM/J  
 वर प्रती को. प्र. शि. एम. ए. वी.  
 शर दी गद वी. 1  
 दिनांक: 14/07/22  
 Date: 14/07/22  
 HOS/ICDD

**COVER OVAL 280 x 220 mm**

**MATL:- K-K-200 TO SPECN NO. IND/ENG/PROV/1207**  
 (REFER TO LATEST DEFENCE SPECIFICATION)

D.S. PT No. 14/5420 - 000071

DRG BASED ON 14-242/2

ES/14/4 878	DATE	DRG RE-TRACED	BRIEF RECORDED	DCC()
11 11	11/07/22	DRG. ADVANCE TO/8	DRG. ADVANCE TO/8	
11	11/07/22	IN MATERIAL ADDED SPECN NO.	IN MATERIAL ADDED SPECN NO.	
11	11/07/22	DRG. ADVANCE TO/8	DRG. ADVANCE TO/8	
11	11/07/22	COARSE WAS 15/2102	COARSE WAS 15/2102	
11	11/07/22	NON-EXHAUSTIVE MATERIAL	NON-EXHAUSTIVE MATERIAL	
11	11/07/22	CRANDED, NOT RE-LETTERED	CRANDED, NOT RE-LETTERED	
11	11/07/22	DRG NO. ADVANCED TO/A	DRG NO. ADVANCED TO/A	

DRN	Sd	DRG NOT TO BE SCALED	PERTAINS TO:-
TCD	Sd	ALL SHARP EDGES & CORNERS TO BE ROUNDED OFF	IMSA-0157/c
CHD	Sd	ALL DIMENSIONS IN MM. UNLESS OTHERWISE SPECIFIED	
PSD	Sd	UNLESS OTHERWISE SPECIFIED NOMENCLATURE	
APPD	Sd		
DATE	26-6-86		
TOLERANCE SPECIFIED OTHERWISE	± 1.0 mm		
AS STATED			
SCALE:- 1:2			
CONTROL RATE OF INSPECTION ENGINEERING EADPT			
			IMPD-0944

TCD BY:- *[Signature]* CHD BY:- *[Signature]* CDD/CFM/J

IMPD - 0945

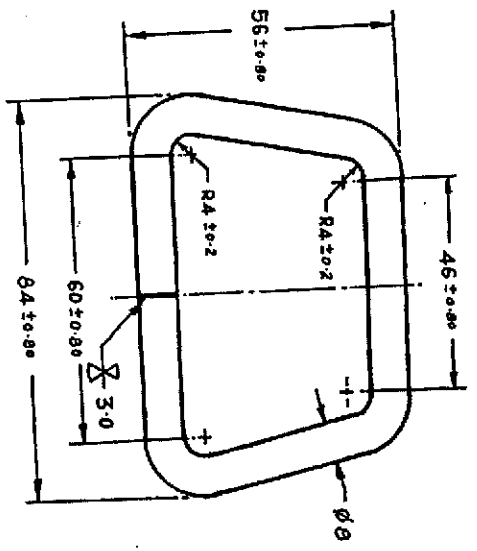

COPY ISSUED BY CDD/OFAJ  
 यह प्रति की संख्या/श्री. एम्. ई. को.  
 शर की संख्या  
 तारीख: 14/07/22  
 Date: 14/07/22  
 for HOSICDD

**STRAP TRAPEZOIDAL**

**MATL :- MILD STEEL GRADE Fe 410 WA IS: 2062  
 GALVANISED AND CHROMATISED TO  
 A THICKNESS OF 50 - 60 μm**

D.S. PT No. 14/5420 - 000104  
 DRG BASED ON 14-242/1/1

ES/14/12/89	1/2	C-4-5	WA/SPRC WAS Fe-410S	DRN	S4	DRG NOT TO BE SCALED	PERTAINS TO:-
115	A-4	K31-425	IS: 226. IN NAME	TCD	S4	ALL SHARP EDGES & CORNERS	IMSA - 0157/C
175	C-5	13:2102	PLATE TOLERANCE WAS (CONSE)	CHD	S4	TO BE ROUNDED OFF	
9/30	B-5	13:2102	DRAWN ADVANCED TO/B	PSD	S4	ALL DIMENSIONS IN 'm'	
			WELDING CORRECTED.	ASST. APPD	S4	UNLESS OTHERWISE SPECIFIED	
			NON-CLATURE WAS STRAP/	DATE	26-6-06	UNLESS OTHERWISE SPECIFIED	
			BRASS TRAPEZOIDAL	SCALE :- 1:1			
			DRG NO ADVANCED TO/B	CONTROL RATE OF INSPECTION			
			DRG RETRAVED WITH: ALL	ENGINEERING EQPT			
			AMENDMENTS UP TO/A				
			BRIEF RECORD				
			DATE				
			SIGN				
			ACC. CR. CELL				
			ASST. APPD				
			DATE				
			TOLERANCE UNLESS				
			OTHERWISE SPECIFIED				
			GEN   DEC   ANG				
			EXTRA COARSE IS: 2102.				

TCD BY: - *[Signature]* CHD BY: - *[Signature]* CIVILIAN FOR SCALE 14/07/22

IMPD-0946

COPY ISSUED BY CDD/OF/AJ  
 बरे प्राणित एके द्वा. एके. र. बरे.  
 कार दी गर्दें कें  
 कार. न. / री. जी. जी  
 दिनांक :  
 Date : 14/07/22  
 HOS/CDD

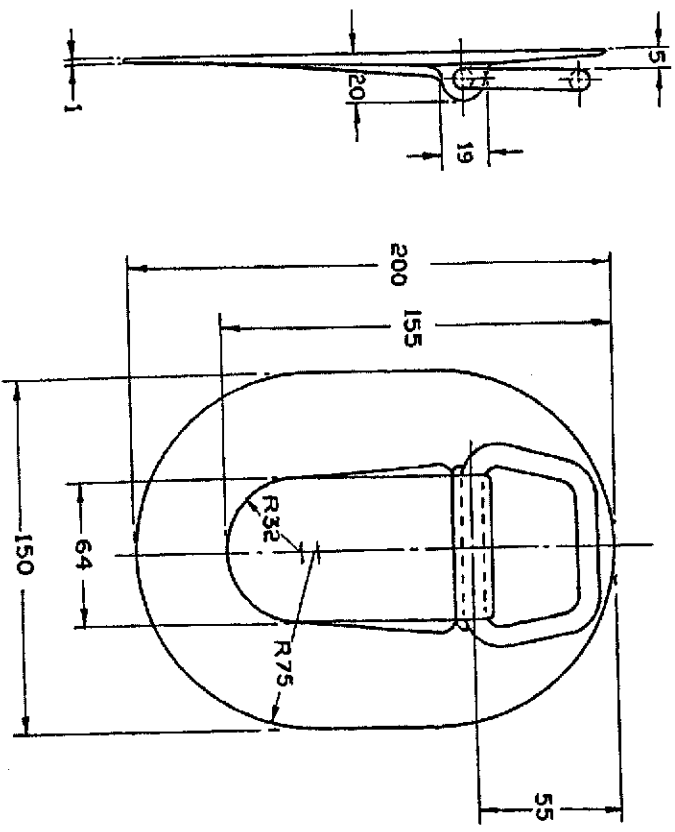

RUBBER SHAPED PARTS FOR SADDLE STRAP TRIMMING  
PATCH OVAL WITH TRAPEZOIDAL RING  
 MATL.: NEOPRENE RUBBER/NYLON  
 GOVERNING SPEC IND/ENG/PROV/1180

NOTE:  
 LATEST VERSION OF DRAWING AND STANDARDS SHALL BE APPLICABLE FOR MANUFACTURE AND SUPPLY.

D.S. PART No. 14/5420-0000070  
 DRG BASED ON 14-242/1

DRN	DRG NOT TO BE SCALED.	PERTAINS TO:-	IMSA-0157/c
TCD	ALL SHARP EDGES & CORNERS TO BE ROUNDED OFF.	SCALE:- 1:2	
CHD	ALL DIMENSIONS ARE IN MM UNLESS OTHERWISE SPECIFIED	CONTROL RATE OF INSPECTION ENGINEERING EPT	
PSD	UNLESS OTHERWISE SPECIFIED NOMENCLATURE		
APPD	AS STATED		IMPD-0946
DATE	26/6/22		
DATE			
TOLERANCE UNLESS OTHERWISE SPECIFIED			
GEN   DEC   ANG			
EXTRA COARSE IS: 2102			
SIG	(Signatures)		
BRIEF RECORD			
DATE			
DATE			
DATE			

COPY ISSUED BY CDD/IO/FAJ  
 यह प्रति सी.डी.डी./सी. प्रो. र. सी.  
 द्वारा दी गई है  
 दिनांक: 14/07/22  
 Date: 14/07/22  
 HOS/ICDD

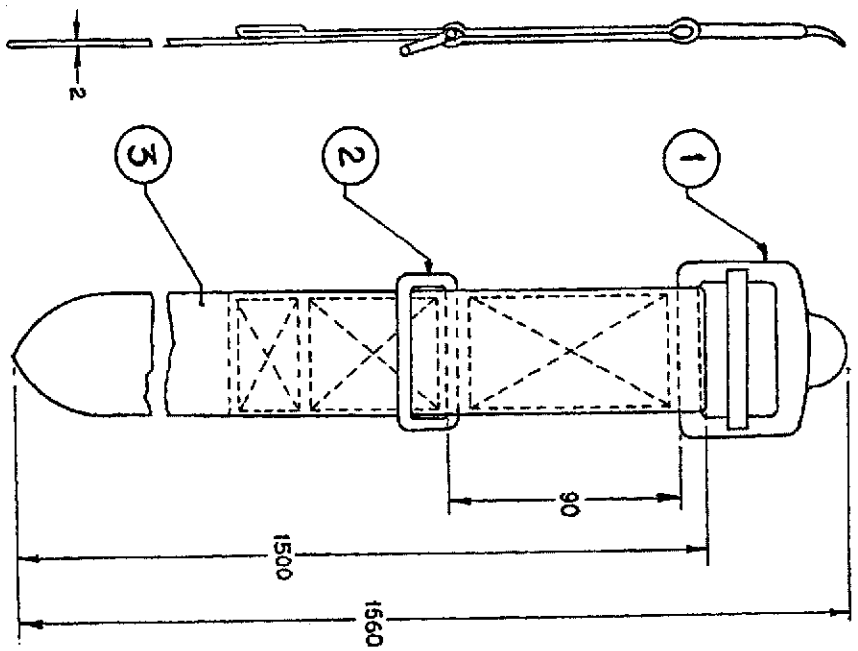

**STRAP SADDLE ASSY**

**NOTE**  
 1) LENGTH OF STRAP (ITEM NO.3) BEFORE FOLDING IS 1750 MM.  
 2) LATEST VERSION OF DRG AND STD SHALL BE APPLICABLE FOR MANUFACTURE AND SUPPLY.

D.S. PART NO 14/5420-000161  
 DRG BASED ON 14-243

ITEM NO.	DRG/PART/No	QTY TO SET	NOMENCLATURE	MATL	REMARKS
3	-	1	SADDLE STRAP LENGTH 1750 WITHOUT FOLD	POLYAMID IND/ENG/PROV/1244	-
2	IMPD-0944B	1	CRAMP FOR SADDLE STRAP	-	-
1	IMPD-09447	1	CLAMPING BUDGE FOR SADDLE STRAP (BUCKLE CLAMPING)	-	-

**PARTS LIST**

DRN	TCO	CHD	PSD	APPD	DATE	TOLERANCE UNLESS OTHERWISE SPECIFIED	GEN	DEC	ANG	COARSE	IS: 2102

**AS STATED**

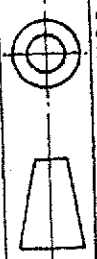

IMSA-0158

SCALE:- 1:1  
 CONTROLLERATE OF INSPECTION ENGINEERING EQPT

PERTAINS TO:-  
 IMGA-0086  
 (SHEET 2 OF 2)

D.C.(1)	DATE	ZONE	BRIEF RECORD	SIGN

\* PART LIST MATERIAL, COLLING STRAP NO. WAS IND/ENG/PROV/1244 DRG. ADVANCED TO/A

14/07/22

14/07/22

14/07/22

14/07/22

14/07/22

14/07/22

8 7 6 5 4 3 2

IMSA - 0157

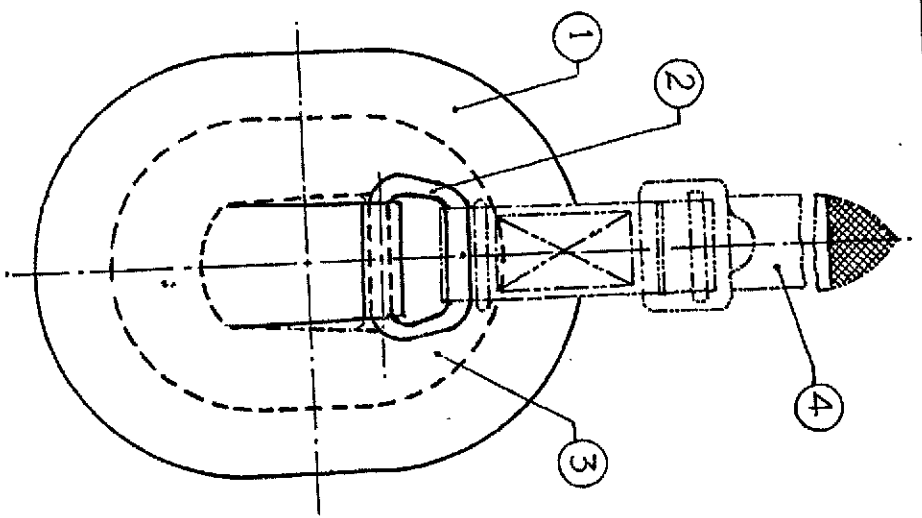

COPY ISSUED BY CDD/OFAJ  
 वर प्रति सी.डी.डी./ओ.एफ.ए.जी.  
 द्वारा जारी है।  
 दिनांक: क.का.म./सी.डी.डी  
 HOS/CDD  
 Date :

**PATCH STRAP ASSY**

CAT/PT No. 14/5420/000069  
 DRG BASED ON 14/242

S.L. No.	DRG PART No.	QTY	DESCRIPTION	REMARKS
4	IMSA-0157	1	STRAP SADDLE ASSY	
3	IMPD-0946/B	1	PATCH OVAL WITH TRAPEZOIDAL RING	
2	IMPD-0945/C	1	STRAP, TRAPEZOIDAL	
1	IMPD-0944	1	COVER OVAL 280 x 220 mm	

ES/44/315	12/79	C-2	IN PART LIST IMPD-0946 DRG. ADVANCED TO/C	DRN	S4	ALL SHARP EDGES & CORNERS TO BE ROUNDED OFF
CS/14/275	9/90	FE 4 B 34 B 5 B 12, 3,	CHANG LINE SHOWN FOR ITEM No 4 NOMENCLATURE CHANGED CAT /PT No. ADDED. IN PART LIST NOMENCLATURE OF SI No. 1, 2, 3 CHANGED. DRG No. ADVANCED TO/B	TCD	S4	ALL DIMENSIONS ARE IN mm UNLESS OTHERWISE SPECIFIED
DC (I)	DATE	ZONE	DRG RETRACED WITH ALL AMENDMENTS UP TO/A	CHD	S4	UNLESS OTHERWISE SPECIFIED NOMENCLATURE
			BRIEF RECORD	PSD	S4	
				APPD	S4	
				DATE	26-6-86	
				TOLERANCE UNLESS OTHERWISE SPECIFIED		
				SCALE :- 1:2		
				CONTROLLERATE OF INSPECTION ENGINEERING EQPT		

**AS STATED**

IMSA - 0157



TCD BY: - *[Signature]* CHD BY: - *[Signature]* C/O/MAJ: *[Signature]*