

DRG. NO. 9102 010 118 002 00DB

DL MEDIUM/GGARSE/FINE CLASS  
S2102

DRAWING CONVENTION CONFORM TO INDIAN STD,  
DIMNS IN MM UNLESS OTHERWISE STATED.

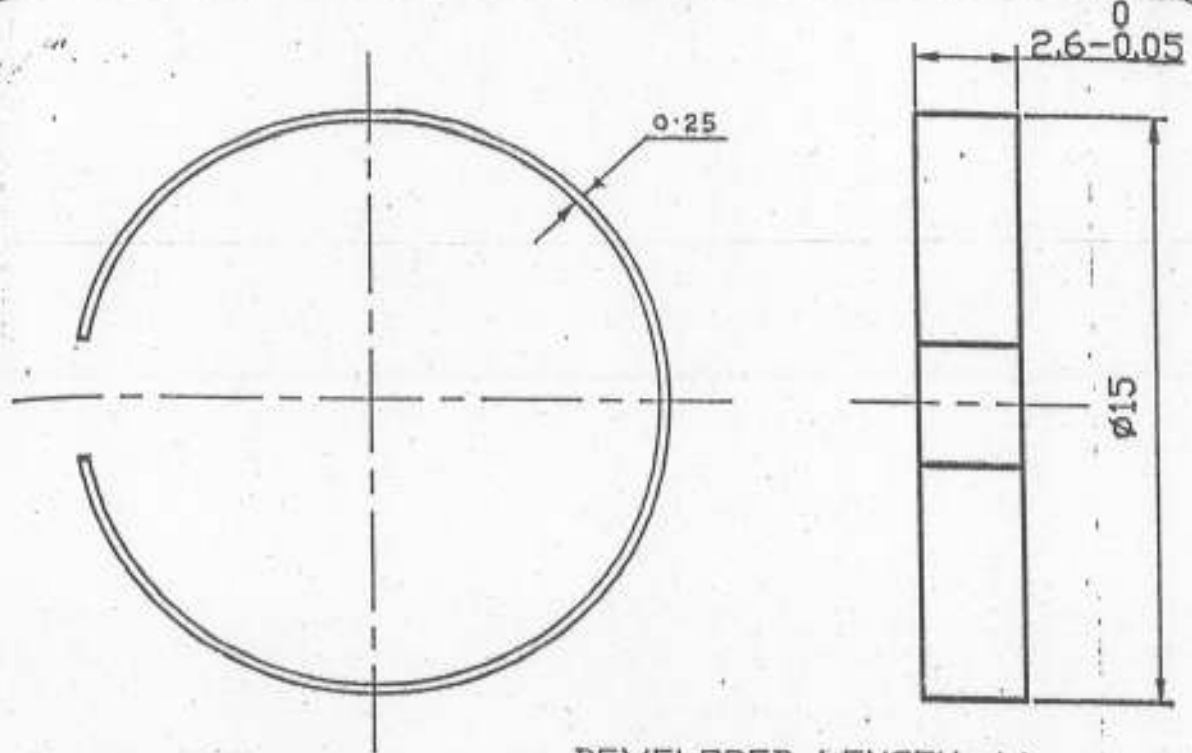

DEVELOPED LENGTH 44

TEST NOTE:

LEAF SPRING WHEN ASSEMBLED IN THE RECESS OF  $\phi 11.5$  :

- 1) SPRING END SHOULD BE OVER LAP PROPERLY
- 2) SPRING SHOULD NOT HAVE PERMANENT SETTING EVEN AFTER 48 HRS.
- 3) SPRING GAP TO EXPAND TO 10mm WHEN A LOAD OF  $225 \pm 15$  gm. IS APPLIED

NOTES:

- 1) BURRS/SHARP EDGES NOT PERMITTED.
- 2) DIMNS. APPLY AFTER PLATING.
- 3) HARDNESS  $450 \pm 50$  VHN/5 Kg

2	27-9-99		SL.No. (3) IN NOTES ADDED			
1	27-9-99		SL.No. (3) IN TEST NOTE ADDED			
R No.	DATE	AUTHORITY	BRIEF RECORD	ZONE	CD	GO
DRN.	SABLE	CHD. <i>[Signature]</i>	MATERIAL: SPRING STEEL STRIP TO SPEC. BS 970 En 42G		SIGN	
APPD.	DATE: 15/6/98	FOR DIRECTOR	(HEAT TREATED CONDITION)			
SEALED	DATE:		PROTECTIVE FINISH:			
SCALE: 5:1	EST. MASS: 0.2 g		PHOSPHATED TO SPEC. JSS-0465-01-1988 CLASS II OIL FINISH.			
DESIGN AUTHORITY			TITLE: <u>LEAF SPRING</u>			
DRG. No.	9102 010 118 002 00DB					
PART No.	DS CAT No.			AHSP		