

773-71-21

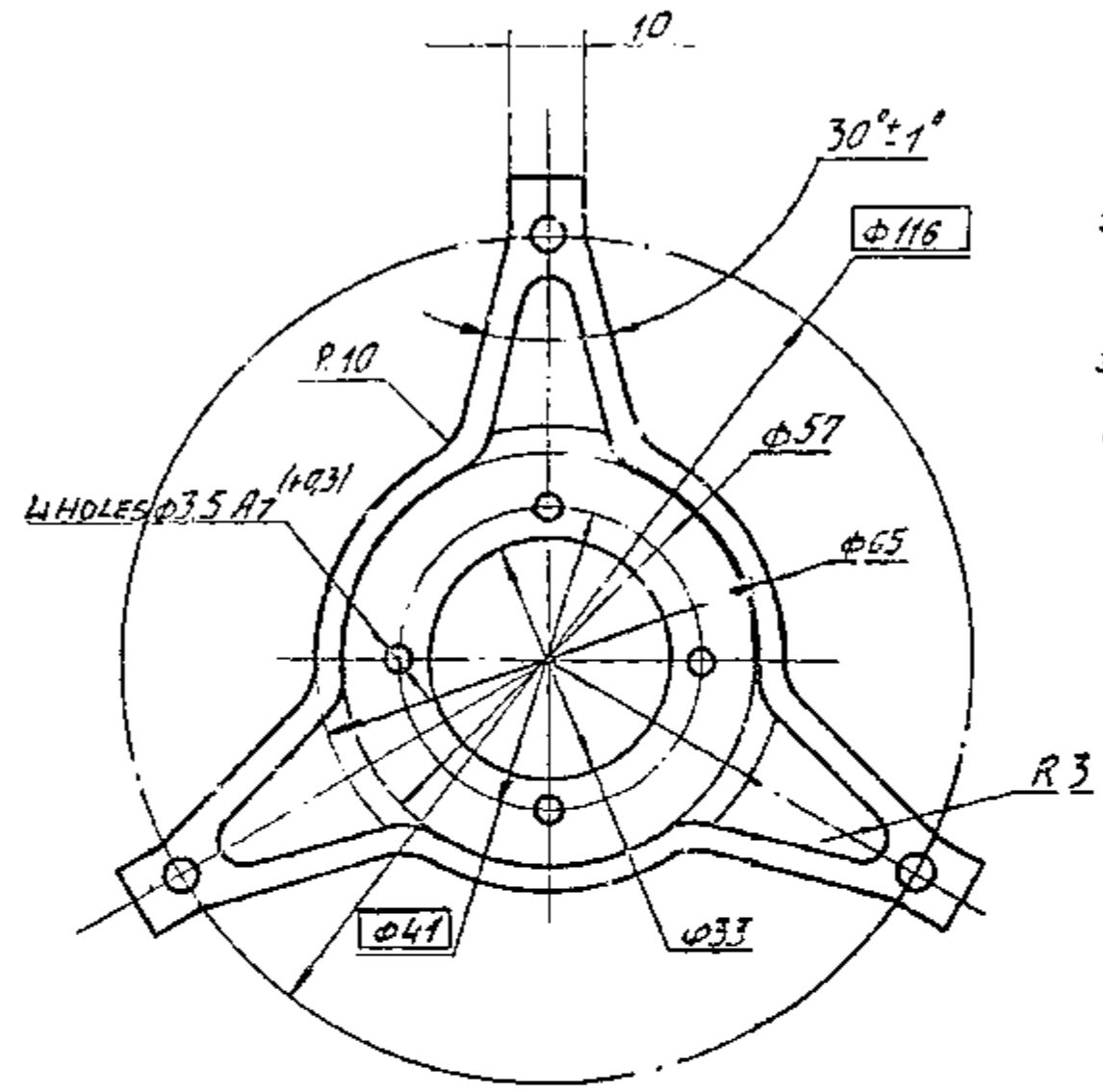
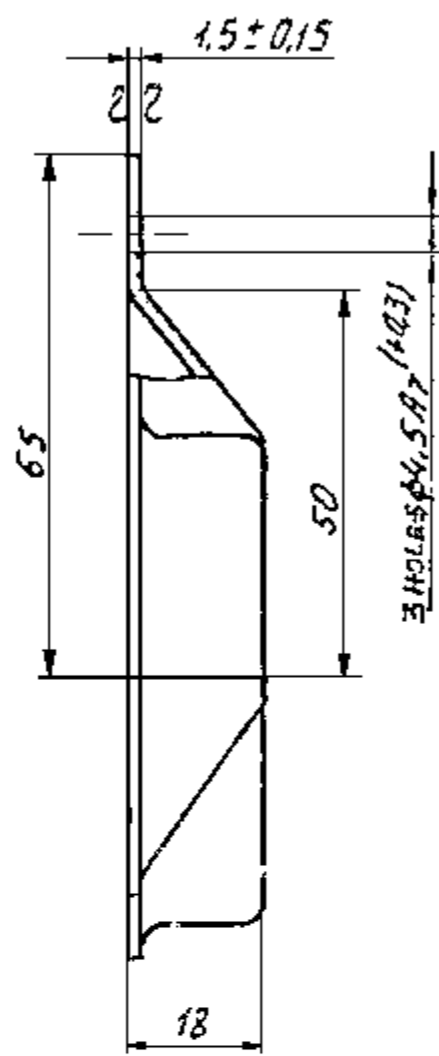

TECHNICAL CONDITIONS

1. WITH PRIMER ПР-03-K GOST 9109-81 PR. ME COAT ALL SURFACES AND PAINT IN ENAMEL ПЭ-223 WHITE GOST 14923-78
2. SHIFT OF HOLES AXIS AGAINST RATED POSITION NOT TO EXCEED 0.3 mm.
3. UNSPECIFIED LIMIT DEVIATIONS OF THE DIMENSIONS ±1mm
4. UNSPECIFIED RADII, NOT TO EXCEED 5mm.
5. MATERIAL SUBSTITUTE: STEEL 08K17, 10K17, 20 GOST 1050-74.

NOTE:-
THE ABBRIVATIONS AND SYMBOLS ARE BASED ON RUSSIAN SPECIFICATIONS.
ALL DIMENSIONS ARE IN mm.

NEAREST EQ. MATERIAL			
STEEL 10 GOST 1050-74			
ORGL MATERIAL:-		DC(1)No. & DATE	ISSUE
ALL SHARP EDGES & CORNERS TO BE ROUNDED OFF		AMENDMENTS	
DRG. NOT TO BE SCALED		STAMP OR ETCH, PART No. MANUFACTURER'S NAME & YEAR OF MFR.	
SCALE: 1:1		TOLERANCE ON DIMENSIONS UNLESS OTHERWISE SPECIFIED	
DATE: 19 APR 94		USED ON: 773-71-Sb103	
DRN. 892807	WT :- (Kg) 0.060	773-71-21	
TCD.			
CHD APPD		SUPPORT	
CONTROLLERATE OF QUALITY ASSURANCE (INFANTRY COMBAT VEHICLES)			

DS CAT No.