

47 AL ON LRVB DRG. CONVERSIONS CONFORM TO IS : SPECIFICATION DIMENSIONS ARE IN mm. GEN. TOL. MEDIUM CLASS TO IS:2102

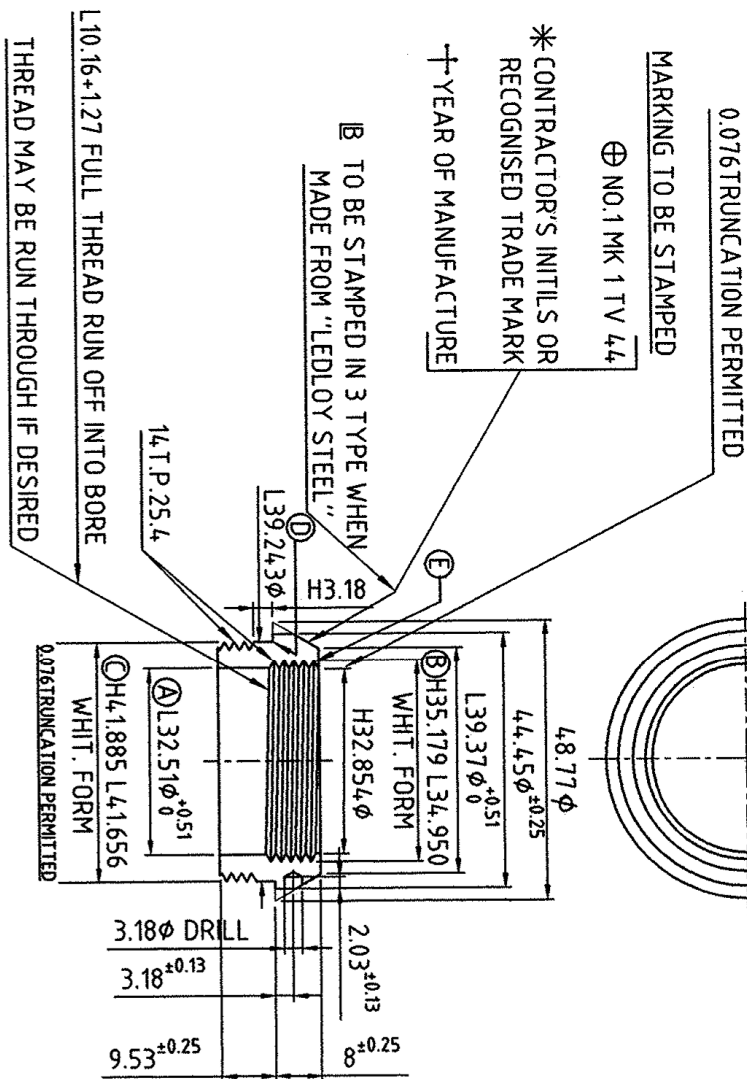
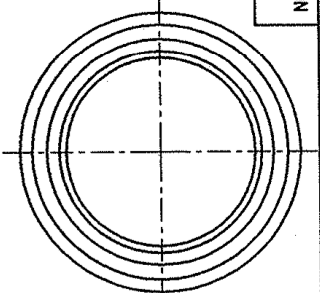

NOTE:- THE WHOLE OF THE NOSE ADAPTER WILL BE RUST PROOFED AS PER SPEC JSS 0465-01, 1988 CLASS IIIT WILL THEN BE COATED ALL OVER WITH APC No. 22110 SPEC JSS 8030-28, FEB 84, AND STOVE D. ALTERNATIVELY MAY BE ZINC PLATED TO SPEC DTD 903 OR IS:1573, 1986 (SECOND REVISION), PLATING THICKNESS SHALL BE DETERMINED BY THICKNESS SHALL BE AS PER GRADE 3 TABLE -2 OF IS:1573:1986. CORROSION RESISTANCE SHALL BE DETERMINED BY SALT SPRAY TEST IN ACCORDANCE WITH IS:9844:1981 AND THE LENGTH OF TIME TO BE APPLICABLE FOR TYPE B OR ABOVE. OF PARA 3.1, IS:9839:1981, FOLLOWED BY CHROMATE PASSIVATION TO SPEC IS:1340:1977 (FIRST REVISION). SCREW THREADS WILL BE COATED WITH LANOLINE SOLUTION TO SPEC IND/SL/2804 OR MINERAL JELLY TO SPEC JSS 8030-09 SEP 82 AFTER STOVING.

NOSE ADAPTER WILL BE PAINTED ALL OVER WITH THE EXCEPTION OF SCREW THREADS WITH READY MIXED PAINT AIR DRYING, SEMI-GLOSSY FOR GENERAL PURPOSE, BUFF MIDDLE TO SHADE ISC 359 TO SPEC IS:168:1986 (SECOND REVISION) (AMENDMENT NO. 3).

RELATIVE TO DIA (A) DIAS (B) & (C) MUST BE CONCENTRIC WITHIN 0.127 FACE (D) MUST BE SQUARE WITH THREADS (E) AND MUST BE FLAT WITHIN 0.127 ON A FULL DIA FACE (F) TO BE SQUARE WITH THREADS (G) AND MUST BE FLAT WITHIN 0.127 ON FULL DIA.

MATERIAL:-
 a) STEEL BAR TO SPECIFICATION IS:226:1975 (FIFTH REVISION) (AMENDMENT NO. 7 Gr Fe 4.05)
 OR
 b) STEEL BAR TO SPECIFICATION IS:1570 PT II 1979 GRADE 20C8 IN COLD DRAWN CONDITION
 OR
 c) STEEL BAR TO SPECIFICATION IS:4431:1978 GRADE 20C8 IN COLD DRAWN CONDITION FREE CUTTING STEEL TO DESIGNATION 14C14S14
 OR
 d) STEEL BAR TO SPECIFICATION BS:970:PT 3 1991 DESIGNATION 070 M20 IN HOT ROLLED AND COLD DRAWN CONDITION

ESTIMATED MASS :- 65.56g ± 4.43g.

TRUE COPY
 JWM/DO
 9/11/04

METAL & STEEL FACTORY
 SHAPORE
 DRG. REGD. NO. 17244/1
 DATE 15-10-2004

20.6.03.	DC. 36904-A	ALL REFERENCE TO ZINC BASE ALLOY AND DRG. PART NO. TV 59 IS DELETED AND NEW DRG. SEALED IN SUPERSESSION OF THE EXISTING SEALED DRAWING WHICH HAS SINCE BEEN ENDORSED "SUPERSSEDE" & NEW M/COPY REPLACED.	Sd/-	Sd/-	25.7.03
		PREVIOUS DCS NO.: 22608-A, 22731-A, 23256-A, 23786-A, 23953-A, 25177-A, 25188-A, 26598-A, 26636-A, 29903-A, 30007-A, 30008-A, 30041-A, 30412-A, 31273-A, 32153-A, 32223-A, 32636-A, 32747-A, 33245-A, 33369-A, 33586-A, 33609-A, 35508-A, 35702-A & 36845-A.			
R. NO.	DATE	AUTHORITY	REVISION	ZONE	AHSP DO SIG.
			DRG. SEALED:- 24-3-41 ; 16-6-93		

PV COPY

ADAPTER NOSE MORTAR BOMB, No. 1

MARK 1/L/STEEL:- FOR BOMBS NOT FITTED WITH EXPLODER CONTAINERS

ASSY. DRG. ITV 14 GF/ITV 15GF/ITV 16 GF

DESIGNER'S REF. DD(L) 11855

PART NO:- TV 44

D.S. CAT NO. NOT APPLICABLE

AHSP:- COA(A) KIRKEE