

2

DWG NO 066866A-00

SH 1

1

SHEET REV RECORD

ALL SHEETS ARE THE SAME REVISION

REVISION RECORD

REV	ECO	DESCRIPTION	DATE	APVD
01		Freeze	05-Sep-12	
02		Restricted	25-Dec-13	
--	T00065	Identical To Previous Released	09-Apr-18	L. Goldshtein

THIS DOCUMENT AND THE INFORMATION CONTAINED IN IT ARE PROPRIETARY AND CONFIDENTIAL TO OFT. NO PERSON OR ENTITY IS ALLOWED TO COPY, REPRINT, REPRODUCE OR PUBLISH ANY PART OF THIS DOCUMENT, NOR DISCLOSE ITS CONTENTS TO OTHERS, NOR MAKE ANY USE OF IT, NOR ALLOW OR ASSIST OTHERS TO MAKE ANY USE OF IT UNLESS BY THE PRIOR WRITTEN EXPRESS AUTHORIZATION OF OFT AND THEN ONLY TO THE EXTENT AUTHORIZED.  
COPYRIGHT-OFT.

NOTES:

1. INTERPRET THIS DRAWING IAW ASME Y14.100M.
2. MATERIAL: ALUMINUM ALLOY PLATE 6061-T651 PER QQ-A-250/11. (EQUIVALENT ALUMINUM IS PERMITTED AFTER ELBIT APPROVAL).
3. FINISH:  
3.1 CHEMICAL CONVERSION COATING PER MIL-DTL-5541 F TYPE II, CLASS 3.3. DEBURR AND REMOVE SHARP EDGES APPROX. 0.3X45°.
4. QUALITY ASSURANCE PROVISIONS:  
4.1 QUALITY ASSURANCE PROVISIONS FOR THIS ITEM PER RDMQD00012P.
5. PACKAGING AND PACKING:  
THE FINISHED PART SHALL BE PRESERVED AND PACKAGED IN ACCORDANCE WITH COMMERCIAL PRACTICE.
6. IDENTIFY PER MIL-STD-130 PARA 4.1.B, BY LABELING ITS CONTAINER WITH THE PART NUMBER. CHARACTERS MINIMUM TEXT HEIGHT 1.25 MM.

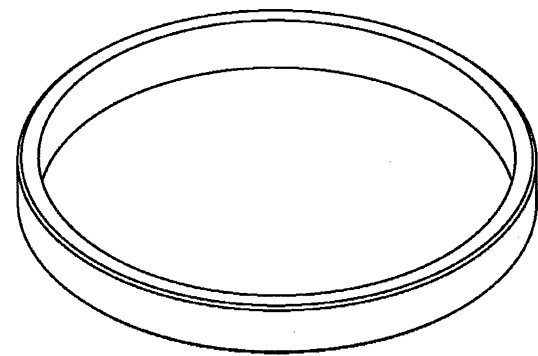
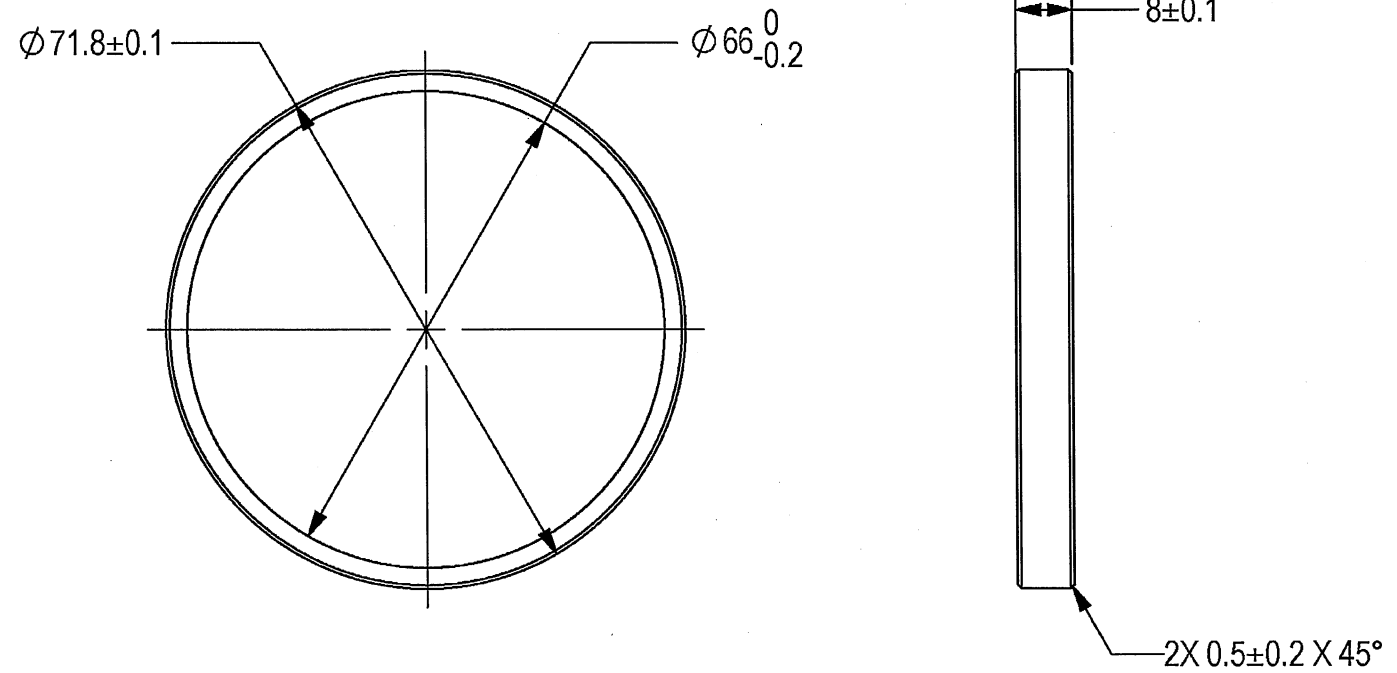

(WEIGHT APPROX.: 0.01 Kg.)

SEE ATTACHED MEDIA

UNLESS OTHERWISE SPECIFIED		SIGNATURE	DATE	<b>ORDNANCE FACTORY</b> TIRUCHIRAPPALLI	
DIMENSIONS ARE IN MM PER ASME Y14.5M - 1994		DRAWN	11/9/20		
TOLERANCES		CHECKED		TITLE	
LINEAR	ANGULAR	HOS/DDO	P. T. 3/9/20	FOR: ELEVATION BEARING ASSY	
±0.2	±0.5°	OFFICER/PRODN		<b>SPACER, OIL RETAINER</b>	
1st ANGLE PROJECTION		OFFICER/QC		SIZE	CAGE CODE
		OFFICER/DDO		<b>B</b>	<b>2291A</b>
SURFACE TEXTURE IN Micro M		1.6		DWG NO	
PROJECT OFFICER		PLM Control		<b>066866A-00</b>	--
		SCALE 1:1		AUTOMATED DRAWING (SW)	SHEET 1 OF 1

2

1