

AL 25/80 (✓)

- 1- ALTERNATE MATERIAL - GLASS K100 GOST 3514-76
GLASS K110 OST 3-28-77.
- 2- ANGLE BETWEEN SURFACES A AND A' B AND A, C AND A' -90° ± 30'
- 3- CHAMFERS ON EDGES 1±0.5 X 45° EXCEPT PLACES INDICATED SPECIALLY CHAMFER ON ANGLES 2±10 X 45°
- 4- WEDGE ALONG DIMENSIONS LAND E SHOULD BE WITHIN LIMIT OF HALF THE TOLERANCE ON DIMENSIONS.
- 5- Ø 25 P. 3E. 72 Ø OST 3-1901-85
- 6- COATING OF SILVERED AND ROUND SURFACES BY BACKELITE VARNISH ABC-1 GRADE 1 GOST 901-78 WITH FILLERS INDUSTRIAL CARBON GRADE П-803 GOST 19729-74.
- 7- AFTER THIS BACKELITE VARNISH THE ANGLE BROADENED P-02 OR A-1 GOST 9808-84 AND TALC TP74H INSULATION RESISTENCE OF VARNISH COATING IN RELATION TO COPPER LAYER SHOULD BE NOT LESS THAN 20 MEGA OHM.
- 8- NONSTRIATION AND THE REST TECHNICAL REQUIREMENTS AS PER TV 3-5834-78.

6. COATING OF SILVERED & DULL SURFACES BACKELITE VARNISH ABC-1, GRADE 1, GOST 901-78 WITH FILLERS: INDUSTRIAL CARBON OF GRADE П 803, GOST 7885-77E, AND TALC TP74H, GOST 19229-74, AND AFTER THAT BACKELITE VARNISH ABC-1 GRADE 1 WITH FILLERS: TITANIUM DI-OXIDE P-02 OR A-1 GOST 9808-84 AND TALC TP74H.

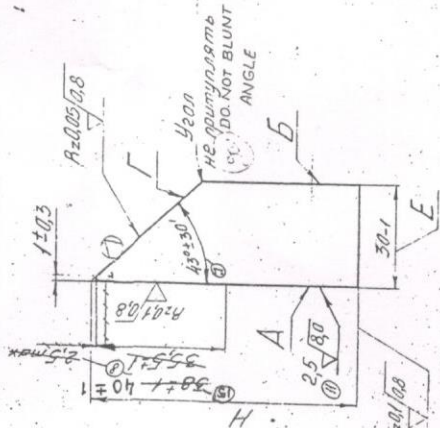
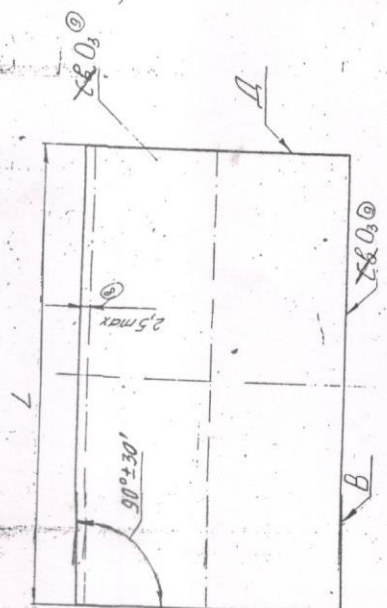

Δ ПС	5
Δ (ПФ - ПС)	5
HOMOGENEITY	5
DOUBLE REFRACTION	5
ATTENUATION	7
NONSTRIATION *	
BUBBLING	8T
P	VII

GROUP No.	40021 KD
DRG. No.	AU 7.200.068
SHEET	PRISM
WEIGHT	GLASS K 108, GOST 3514-76
SCALE	
MATERIAL	
OPTO ELECTRONICS FACTORY	
DEURADIN	

DESIGNATION	H, MM (NOMINAL)	L, MM (NOMINAL)	Mached WEIGHT
ALU. 200.068	78	135	0,65
	99	134,5	0,85

FOR TRADE ONLY
DATE OF ISSUE 03/06/72
Kopyu

ALU. 7.200.068