

ON GRD 2 3 4 5 6 7 8

NOTE: 1) REMOVE ALL SHARP EDGES AND BURRS

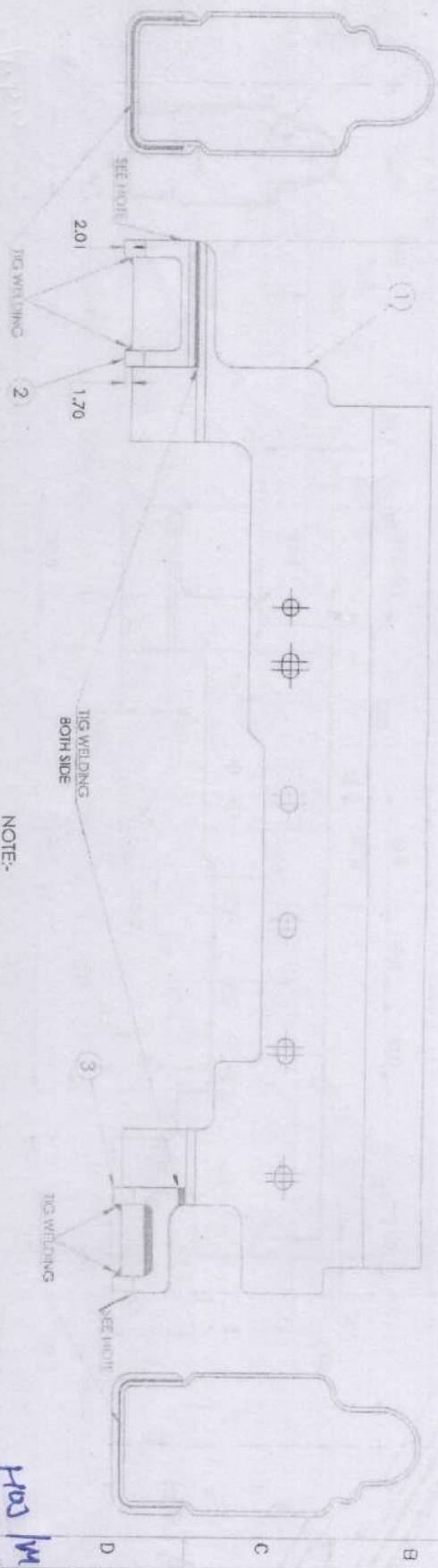

(390.8)

D.A. NO.
25/19
04/22

NOTE:-
1) EDGES OF MATING COMPONENTS ARE IN THE SAME PLANE.
2) TO BE FILE FLUSHED AFTER WELDING.

* S. NO. 1 DRAWING REVISED BY ARDE
** S. NO. 2 & 3 DRAWING NO. REVISED BY ARDE, OLD DRAWING NO. WAS 0204 03 03 31 33 002 00DB AND 0204 03 03 31 33 003 00DB RESPECTIVELY
*** S. NO. 4, 5 & 6 DRAWING AND DRAWING NO. REVISED BY ARDE, OLD DRAWING NO. WAS 0204 03 02 38 41 002 00DD, 0204 03 02 38 41 003 00DD & 0204 03 02 01 15 001 00DD RESPECTIVELY

S.NO.	DESCRIPTION	DRAWING NO.	QTY.
1	BODY HOUSING UPPER *	0204 03 04 19 24 001 00DA	1
2	BRACKET FRONT, BODY HOUSING UPPER **	0204 03 04 19 24 002 00DA	1
3	BRACKET REAR, BODY HOUSING UPPER ***	0204 03 04 19 24 003 00DA	1
4	CHANNEL LEFT ***	0204 03 04 11 19 001 00DA	1
5	CHANNEL RIGHT ***	0204 03 04 11 19 002 00DA	1
6	TUBE SPACER ***	0204 03 04 11 19 003 00DA	2

ITEM NO. 4, 5 & 6 SHOULD BE SUPPLIED LOOSE

SCALE

1 : 1

BODY HOUSING UPPER WELDING
WITH BRACKET FRONT AND
BRACKET REAR

JVPC 5.56X30 mm

SMALL ARMS FACTORY
KANPUR

DRG. NO.

SK-5729 *X2

DRAWN, TRACED, CHECKED
DATE 20-02-2016
APPROVED

J.W.M./K.D.

SHT. 1 OF 1

Handwritten notes and stamps:
H00 WWP
Certified copy
13/10/22
Mr. Manoj Kumar
Work Manager

GENERAL TOL: FINE / MEDIUM / COARSE
 CLASS TO IS: 2102
 DRG. CONVENTIONS CONFIRM TO INDIAN STANDARDS
 DIMENSIONS ARE IN MM UNLESS OTHERWISE STATED.

DRG No. 0 2 0 4 0 3 0 6 1 4 0 2 4 0

IC SS C AA V C

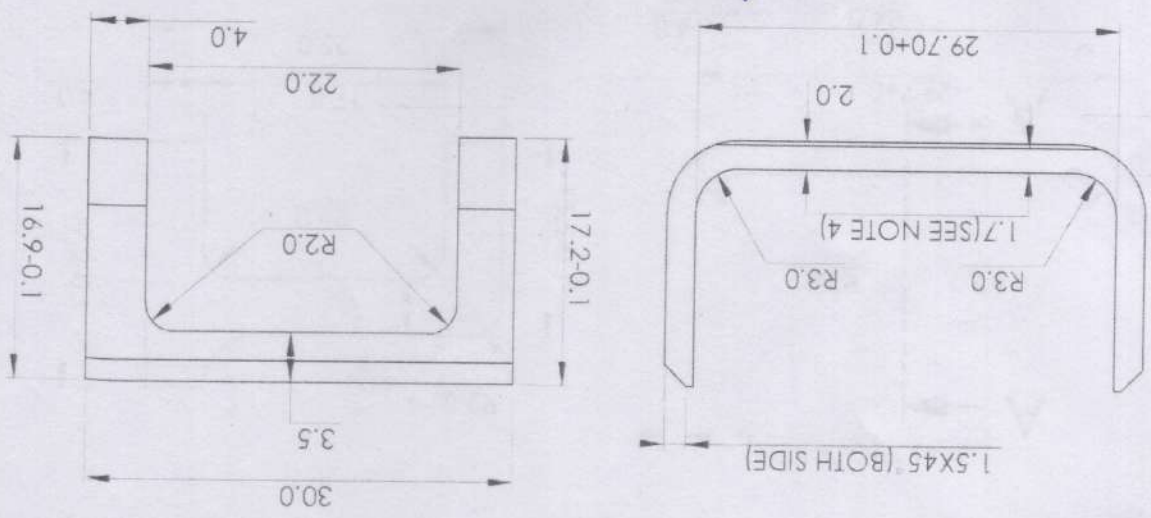

NOTES:-
 1) SHEET THICKNESS: 2mm
 2) REMOVE ALL SHARP EDGES AND BURRS.
 3) HARDENED :- 210-260 HV. Dr. Works Manager
 4) TO BE FINISHED BY GRINDING POST BENDING

Handwritten: 12/10/23
Handwritten: Hos/MD

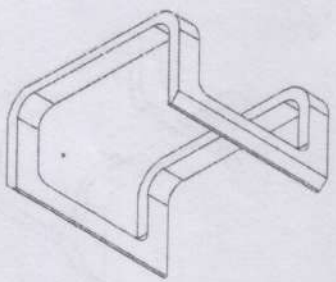

Sr. No. DATE AUTHORITY

BRIEF RECORD ZONE SIGN

CD GO

DRN: SOURABH
 SIGN: *Handwritten signature*
 DATE: 07/03/2019 CHECKED

MATERIAL: STEEL TO IS: 7226-1974, Gd. C40

APPD. *Handwritten signature*
 DATE: 07/03/2019 FOR DIRECTOR

PROTECTIVE FINISH: PHOSPHATED TO SPECN. IS: 3618-1966, CLASS 'B'

SHEET SIZE: A4
 EST. MASS 9.14 gm

TITLE: BRACKET FRONT, BODY HOUSING UPPER

DESIGN AUTHORITY: ARDE
 PUNE 411021

DRG No. 0 2 0 4 0 3 0 4 1 9 2 4 0 0 2 0 0 D A

IC SS S AA AA A C SS

JVPC PART No. DS CAT No. AHSP

GENERAL TOL. FINE / MEDIUM / COARSE
 CLASS TO IS: 2102

DRG. CONVENTIONS CONFORM TO INDIAN STANDARDS
 DIMENSIONS ARE IN mm UNLESS OTHERWISE STATED.

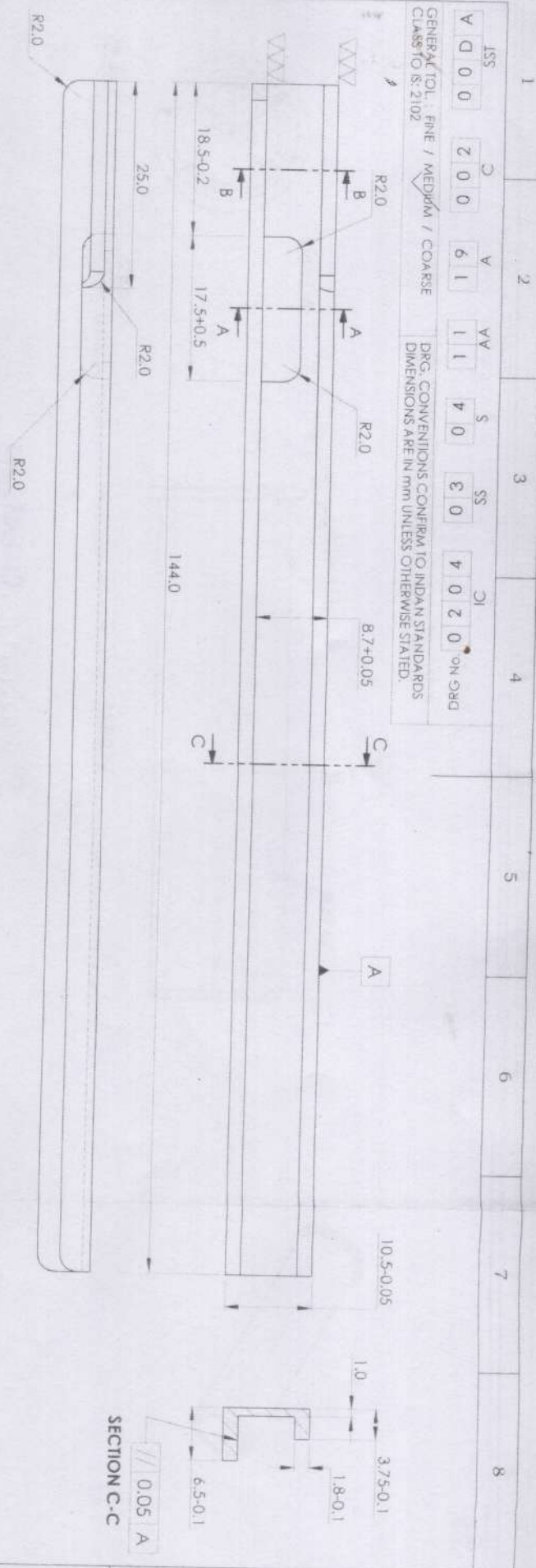

HoSH MD

श्रीवृत्त की श्री प्रशिक्षित
 प्रशिक्षित निरीक्षक

Certified as correct
 of drg. on. 13/12/23

Arvind J.
 क. गोपाशक्ति
 Jr. Works M.
 SCALE: 1:2.1

- NOTES:-**
- 1) REMOVE ALL SHARP EDGES AND BURRS.
 - 2) HARDENED AND TEMPERED TO 260-310 HV.
 - 3) IF THE COMPONENT IS TO BE MANUFACTURED THROUGH MIM ROUTE, REFER ARDE SPECN No. DRDO/ARDE/MIM/TSP/051/2019.
 - 4) SURFACE FINISH $\nabla\nabla$ ALL OVER EXCEPT WHERE SPECIFIED.

DRG No.	0 2 0 4	IC	0 3	SS	0 4	1 1	1 9	0 0 2	0 0 0 D D A
JVPC	PART No.	DS CAT No.	AHSP						
DESIGN AUTHORITY		EST. MASS		TITLE					
ARDE		26.09 gm		CHANNEL RIGHT					
PUNE 411021									
APPD. DATE 07/03/2019		PROTECTIVE FINISH:		PHOSPHATED TO SPECN. IS:361B-1966, CLASS 'B'					
DRN. ANKIT		MATERIAL:		STEEL TO IS: 5517-1993, Gd, 55C8					
DATE 07/03/2019		BRIEF RECORD		ZONE					
CHECKED		CD		SIGN					
AUTHORITY		GO							
No. DATE		SIGN							

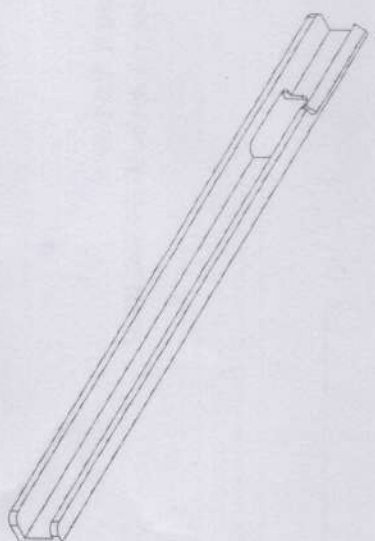

1 2 3 4 5 6 7 8

