

765-94-244

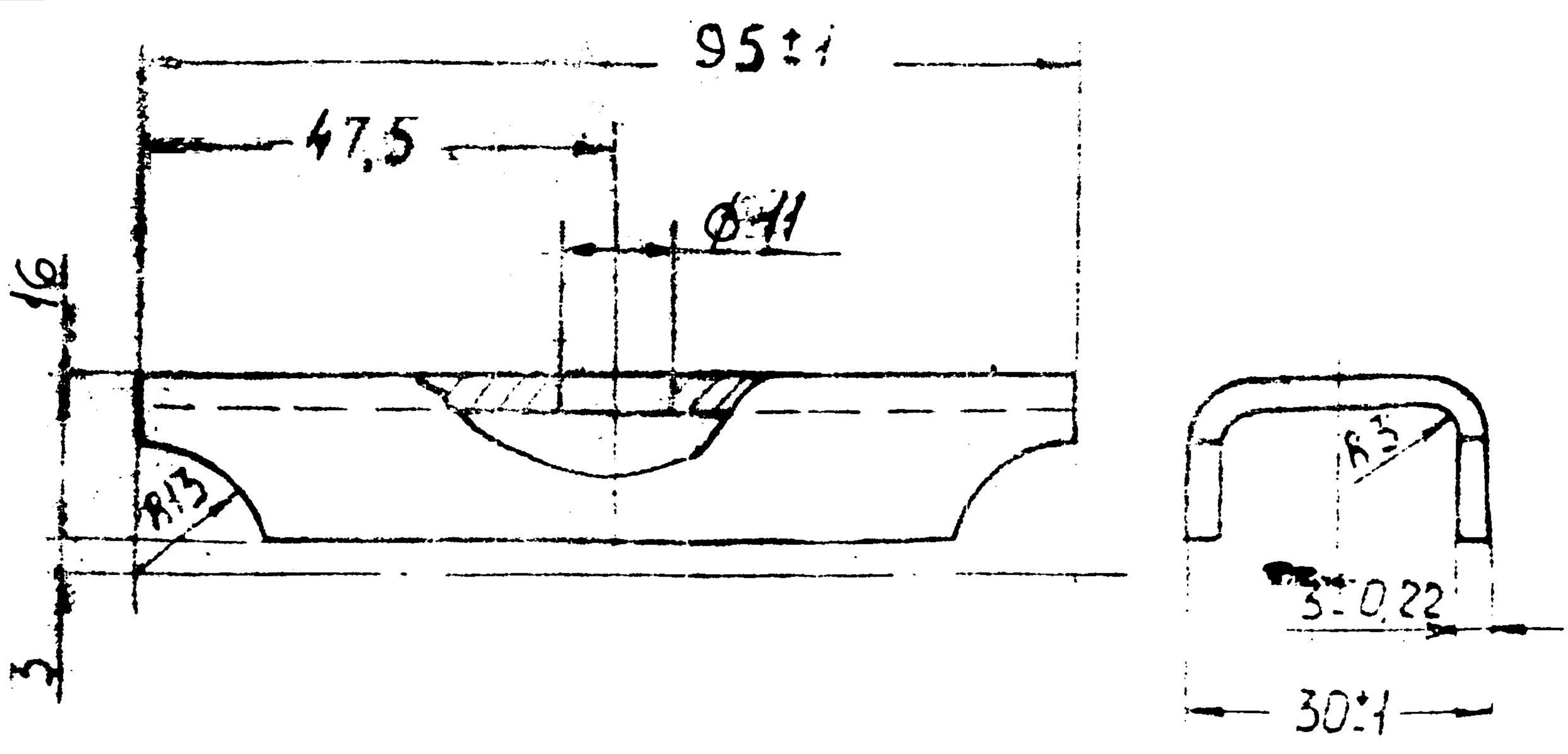

1. Provide dimensions specified without deviations with an accuracy of $\pm 0,5\text{mm}$.
2. Blunt sharp edges.
- ③ ~~3. Prime with primer $\phi 1$ 03 K, brown, GOST 9109-81 and paint with enamel XB-518, khaki, TY6-10-966-75.~~
4. Alternate material is steel cm3, steel cm5, GOST 380-71 and 20,25, and 30 GOST 1050-74.
- ⑤ 5. APPLY TWO COATS OF PRIMER (AFTER FIRST COAT IS DRIED, THE SECOND COAT SHOULD BE APPLIED) USING PAINT AS PER SPECN. JSS: 347-13 (D/S CAT/PART No. H1-8010-000110) AND ALLOW IT TO DRY COMPLETELY. THEN APPLY ONE COAT OF DARK GREY ENAMEL; PAINT TO SPECN. IS: 133 (D/S CAT/PART No. H1-8010-000144)
Basic grade of material is steel cm3cn GOST 380-71.

00498-ICV By 25-1-95	⑤ by	NOTE No. 3 DELETED. NOTE No. 5 ADDED FOR PAINTING.
DC (I) No. & DATE	ISSUE	NATURE
AMENDMENTS		

APPROVED	765-94-244		
CHECKED	STRAP		
CONTROLLERATE OF INSPECTION (ICV)			
	SHT	SHTS	
	94	219 OF 289	

765-94-359

2

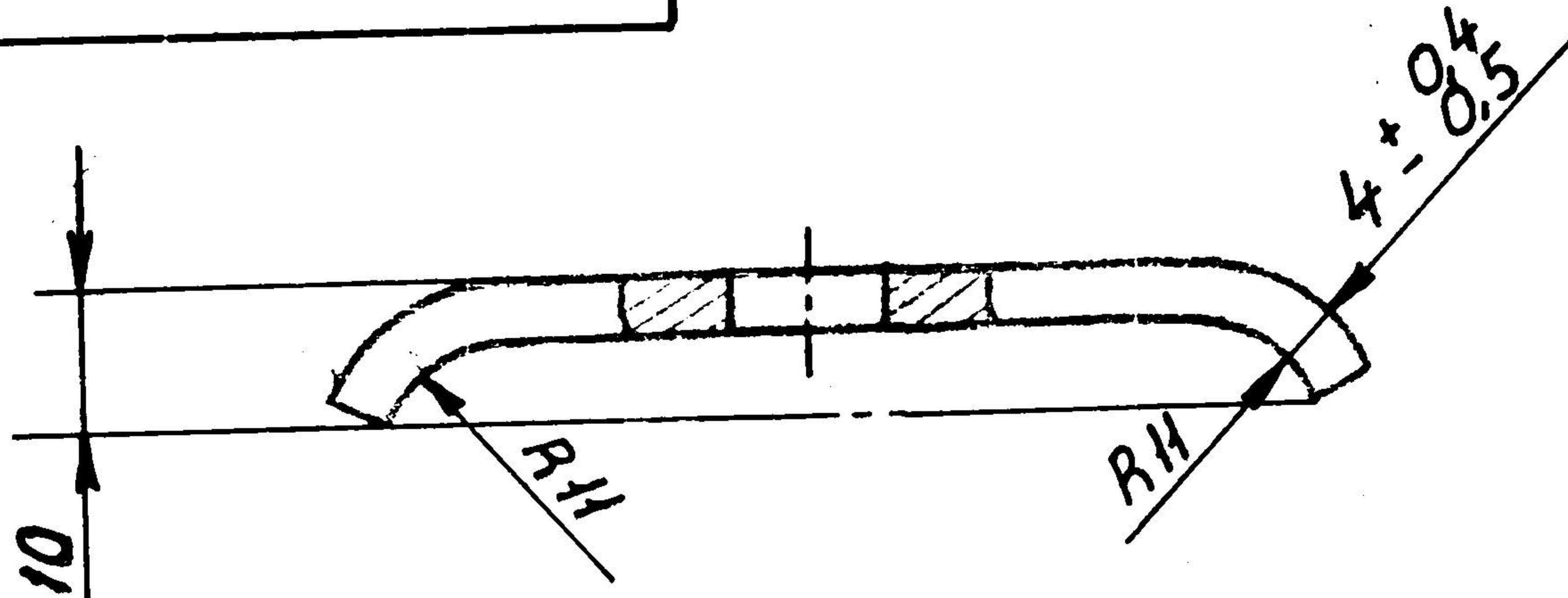

AMENDMENTS	DC(1) NO. & DATE	00498-1 CV 25-1-95
	ISSUE	(A)
	NATURE	NOTE NO. 3 DELETED. NOTE NO. 5 ADDED FOR PAINTING.

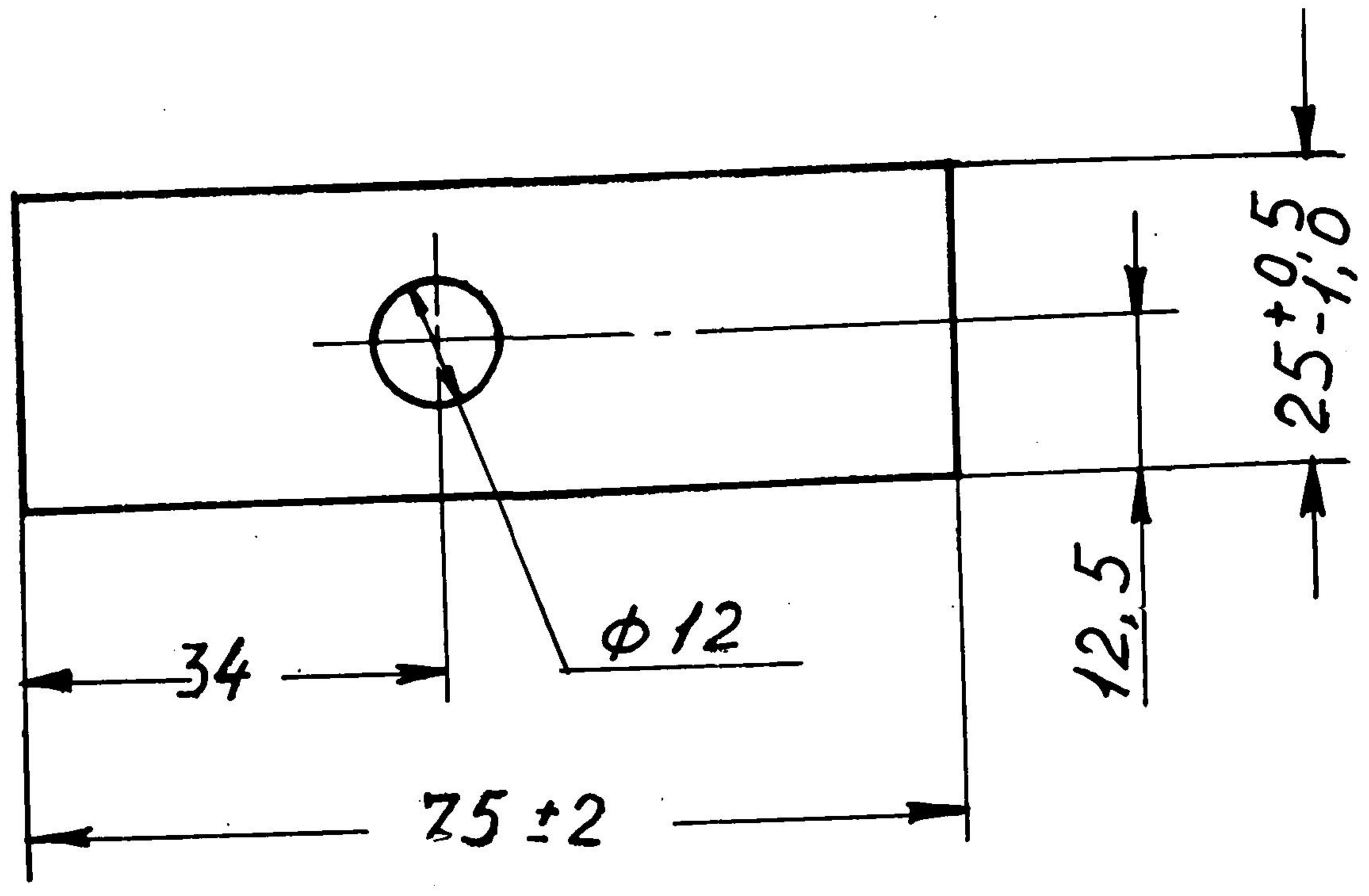

- 1). Blunt sharp edges.
- 2). Provide dimensions without deviations with an accuracy of ±1.
- (A) ~~3). Prime with primer 0A-0 3k, GOST 9109-81 and paint with enamel XB-518, khaki, TY6-10-966-75.~~
- 4). Alternate material is steel cm3. cn, GOST 380-71, 10, 15, 25, GOST 1050-74, and 15Г, 20Г, GOST 4543-71.
- (A) 5) APPLY TWO COATS OF PRIMER (AFTER FIRST COAT IS DRIED, THE SECOND COAT SHOULD BE APPLIED) USING PAINT AS PER SPECN. JSS: 347-13 (D/S CAT/PART NO. H1-8010-000110) AND ALLOW IT TO DRY COMPLETELY THEN APPLY ONE COAT OF DARK GREY ENAMEL PAINT TO SPECN. IS: 133 (D/S CAT/PART NO. H1-8010-000114)

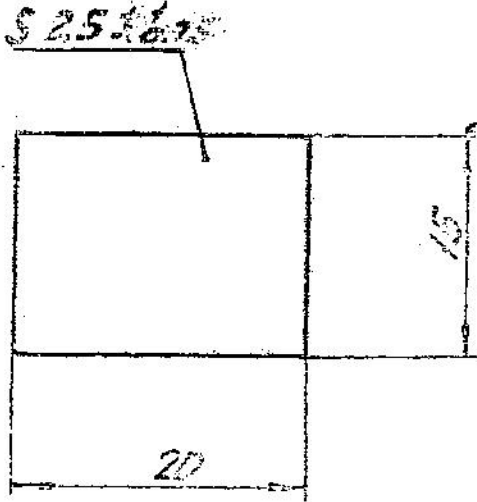

APPROVED		765-94-359		
CHECKED				
CONTROLLERATE OF INSPECTION (ICV)	STRAP		WEIGHT	SCALE
			0,06	1:1
			SHT	SHTS
		20 GOST 1050-74 94	226 OF 289	

899-76-501

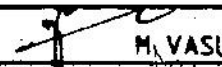

1. Alternate material is leather hardness type "K", GOST 1904-70, and industrial leather, type 8, weighting, chrometanned, GOST 20836-75.
 2. Other requirements and deviations ^{of dimensions} are as per technical specifications TY38-105 816-75.
- Ⓐ EQUIVALENT MATERIAL - HARNESS LEATHER TO IS:580-73

00790 -ICV ✓ Remold 28.5.2000	Ⓐ Gum	EQ. MATERIAL ADDED.
DC(1) NO & DATE	ISSUE	NATURE OF AMENDMENTS

APPROVED	 M. VASU	765-94-648	
CHECKED		STRAP	WEIGHT SCALE
CONTROLLERATE OF INSPECTION (ICV)			0.0007 2:1
		SHT	SMTS
		leather hardness "K" GOST 1904-70	

✓(✓)

765-94-660

765-94-660

Исполнитель: [illegible]
Инженер: [illegible]

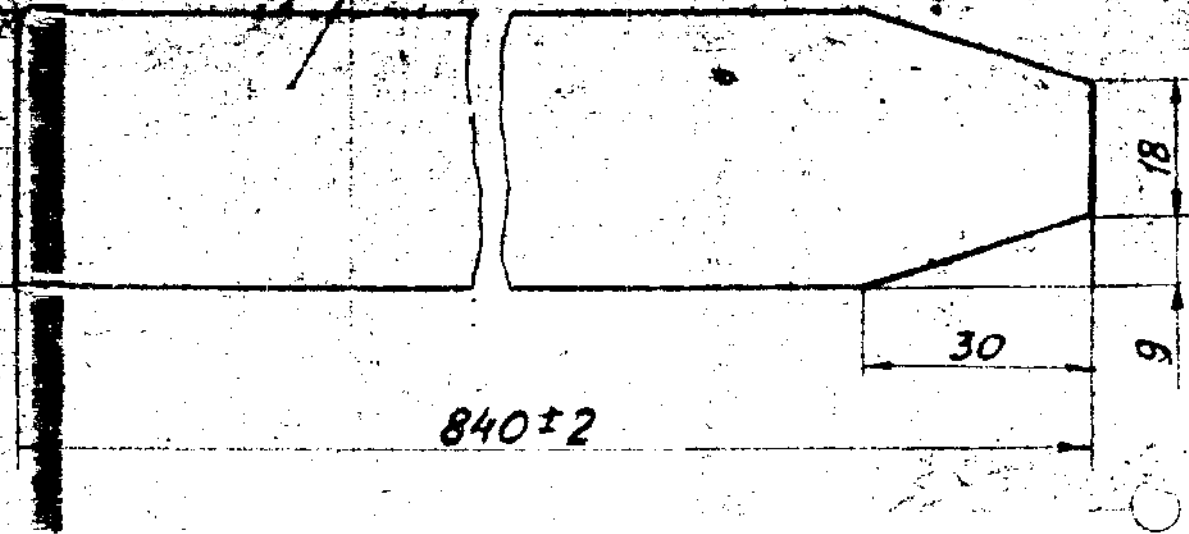

1. Alternate material is steel 08kn and 08nc, GOST 1050-74.
2. Unspecified limit deviations of dimensions are $\pm 1\text{mm}$.
3. It is allowed to provide dimensions A equal to S 1.5 ± 0.15 , in this case, surface finish should be \checkmark

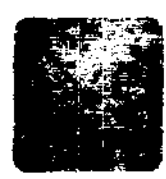

APPROVED	<i>C. D. [illegible]</i>	765-94-660	
CHECKED	<i>[illegible]</i>		
CONTROLLERATE OF INSPECTION	BAND	WEIGHT	SCALE
		0,35	1:1
		SHT	SHTS
	10. GOST 1050-74	260 OF 289	

765-94-732

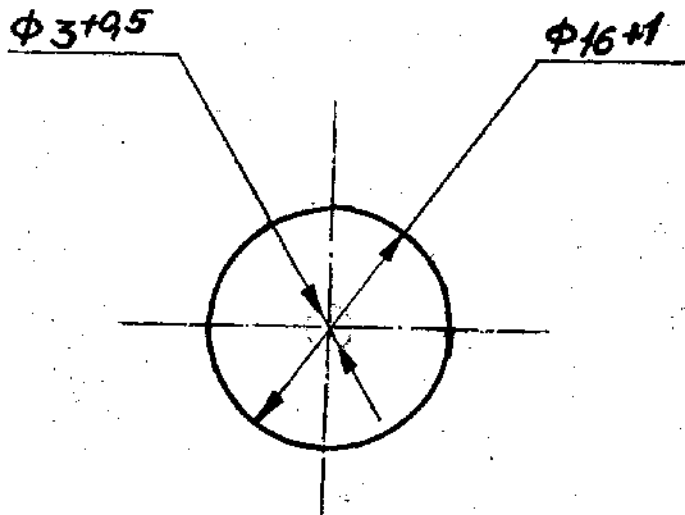

- 1) Alternate material is leather vinylis kozha - T B0-1 upholstery brown, with fabric base, grade I, GOST - 23367-78.

267 of 289

APPROVED		765-94-732	
CHECKED		STRAP	
CONTROLLERATE OF INSPECTION (ICV)		WEIGHT	SCALE
		0,001	2:1
		S/IT	S/TS
		267 OF 289	

765-94-768

Rz 320 / (M)

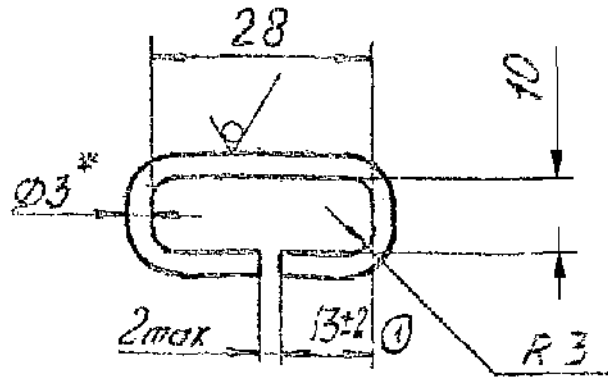

1. Unspecified limit deviations of dimensions are ±1mm.
2. Misalignment of edges should not exceed 1mm.
3. * Dimension is given for reference.

Ⓐ EQ. MATERIAL:- MILD STEEL WIRE, GALVANISED,
SAFT DRAWN OR 1/4 HARD TO IS: 280-78 WITH
TENSILE STRENGTH 37 kg/mm² MINIMUM.

00749-ICV Ramesh 23-12-99	Ⓐ	EQ. MATERIAL ADDED.
DC(I)No. & DATE	ISSUE	AMENDMENTS

APPROVED *[Signature]* H VASU
CHECKED *[Signature]* D. Kadivela

765-94-768

CONTROLLERATE
OF
QUALITY ASSURANCE
(ICV)

STRAP

	WEIGHT	SCALE
	0.005	1:1
SHT 1	SHTS 1	

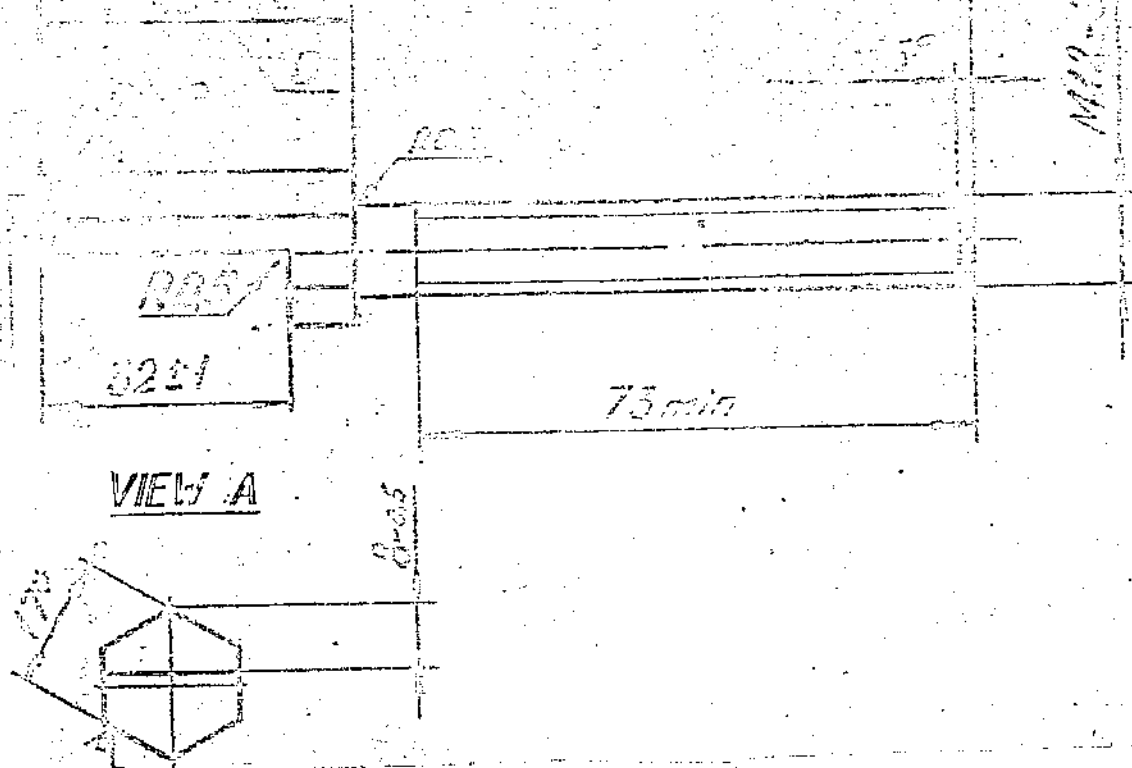

- 1) Alternate material is hexahedral bar $\frac{17-5 \text{ GOST } 8560-78}{45-H \text{ B GOST } 1051-73}$.
- 2) Unspecified limit deviations of dimensions are as per follows :-For shafts - as per B7, others - as per CM7.
- 3) Thread may be made by rolling, in this case, unthreaded part of the rod should be equal to the angle diameter of the thread.
- 4) Coating : Zinc-plated, 9 microns thick, chromated.
- 5) Section B may be free of coating.
- 6) * Dimension is given for reference.

APPROVED	765-94-774			
CHECKED				
CONTROLLERATE OF INSPECTION (ICV)	STUD		WEIGHT	SCALE
			0,09	1:1
			SHT	S-TS
	HEXAGONAL 17-5 GOST 8560-78 BAR 20H-B GOST 1051-73		273 OF 289 0.2p	

132

9LL-H6-59L

Rz 320
√(√)

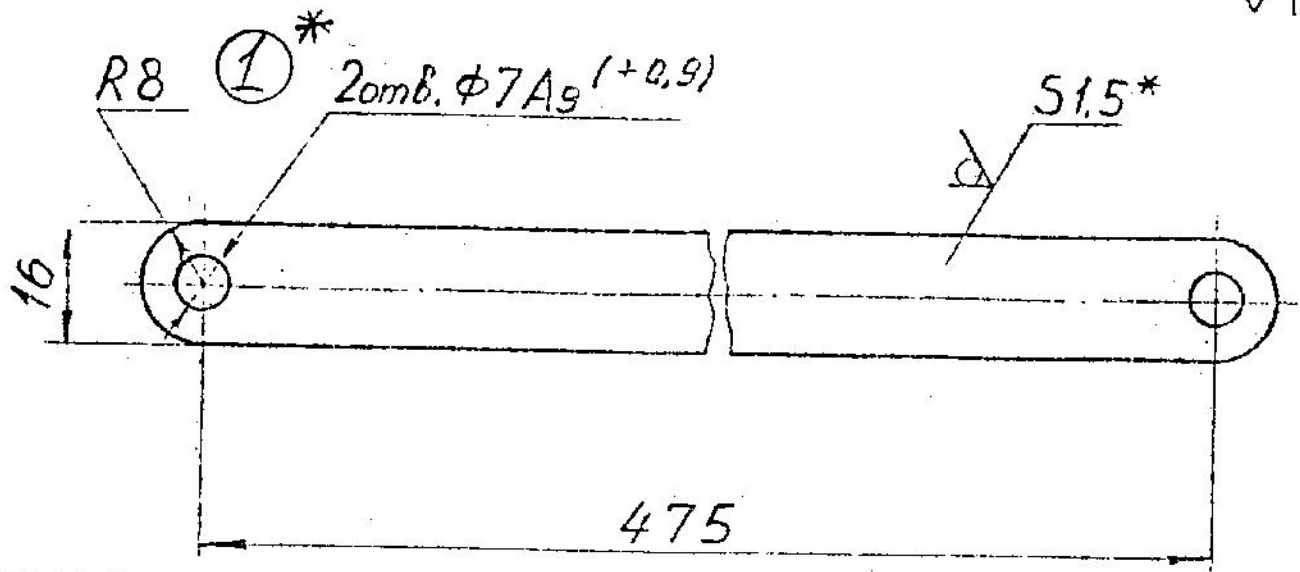

- * (1) Two holes
- (2) 1. HRC 27 to 37.
- 2. Unspecified limit deviations of sizes - ± 0.5 mm.
- 3. Coating: zinc 9 Cr. Remove hydrogen embrittlement.
- 4. * Size is given for reference.

(A) EQ. MATERIAL: Gde 75C6 TO IS: 2507-75.

230283
 24519
 6/5/9
 24 OCT 05
 DC (I) NO. & DATE
 ISSUE
 AMENDMENTS
 EQ. MATERIAL ADDED

230283
 24519
 6/5/9
 24 OCT 05
 DC (I) NO. & DATE
 ISSUE
 AMENDMENTS
 EQ. MATERIAL ADDED

01005 10Y	(A)	EQ. MATERIAL ADDED
24 OCT 05	ISSUE	AMENDMENTS

APPROVED
[Signature]

CHECKED
[Signature]

CONTROLLERATE OF INSPECTION (ICV)

765-94-776

STRAP

WEIGHT SCALE	
0.09	1:1
SHT	SHTS
121	

A-ПУ-0-1, 5 ГОСТ 19904-74
II-65Г ГОСТ 1542-71

822-46-59L

450±3

S10±1.5
1.0

200±3

1. Marked with asterisk is spongy rubber, group I, pressed, TV 38-105817-81
2. It is allowed to manufacture of several parts by banding with cement 88-HH TV 38-105540-73.

278 of 289

APPROVED

[Signature]

765-94-778

CHECKED

[Signature]

CONTROLLERATE
OF
INSPECTION
(ICV)

FILLER

WEIGHT SCALE

0.58 1:5

SHT SMTS

RUBBER *

94

278 OF 289

Handwritten notes on the left margin, including "b.u. 8/20/82" and "CH-1/2/82".

6LL-46-59L

1330±5

50±2

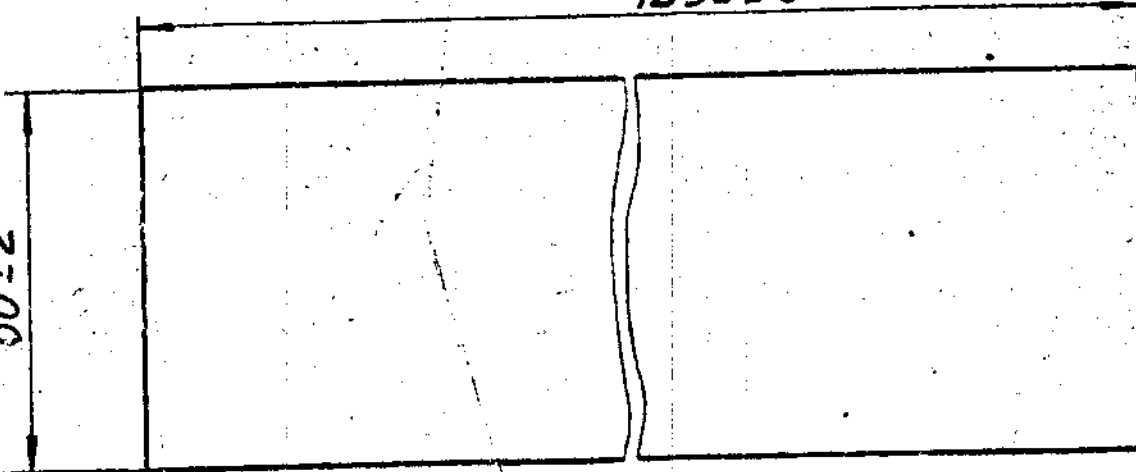

1. Marked with asterisk is semi-flax canvas, impregnated, No. 2 CKIB, khaki, article 11205 FOCT 15530-76.
2. Substitute for material - semi-flax canvas, impregnated, No. 5 CKIB, khaki, article 11201 or 11245 FOCT 20712-75.

Инв. № 40353
 Инв. № 42075
 Инв. № 40353

APPROVED

[Signature]

765-94-779

CHECKED

[Signature]

WEIGHT SCALE

**CONTROLLERATE
OF
INSPECTION
(ICV)**

SIDE PIECE

0.04

1:1

SHT

SHTS

CANVAS *

08L-46-99L

450±5

S 20*

200±5

1. It is allowed to manufacture of several parts by bonding with cement 88-III TV 38-105540-73.
2. *Size is given for reference.

40 48.60 48.83
 49. Мубеы 05.03.83
 01. 02. 03. 04. 05. 06. 07. 08. 09. 10. 11. 12.

40 48.60 48.83
 49. Мубеы 05.03.83
 01. 02. 03. 04. 05. 06. 07. 08. 09. 10. 11. 12.

APPROVED
CHECKED
CONTROLLERATE OF INSPECTION (ICV)

765-94-780

FILLER

ЛЛУ-40-0,8 ОСТ 6-05-407-75

| WEIGHT SCALE | |
|--------------|-----|
| 0.03 | 1:5 |

SHT SHTS

Утб

Формат А4

765-94-783

62320/ ✓ (M)

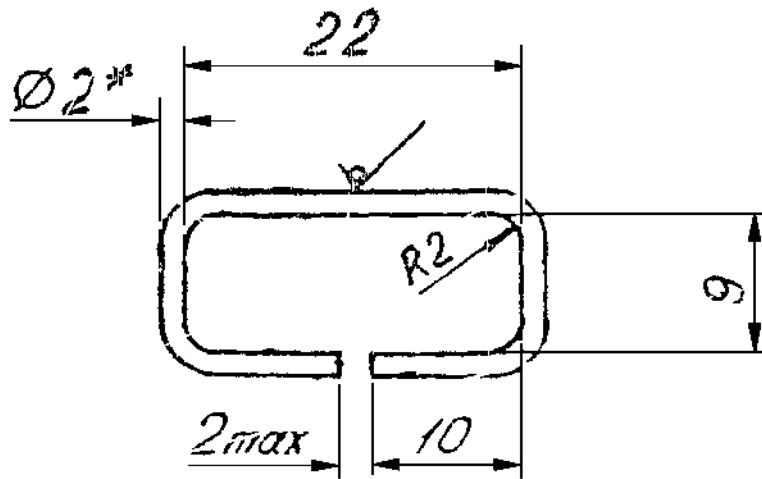

TECHNICAL CONDITIONS

1. Unspecified limit deviations of dimensions are ± 1 mm
 2. Misalignment of edges should not exceed 1 mm.
 3. *Dimension is given for reference.
- Ⓐ EQ.MATERIAL: M.S.WIRE BRIGHTSOFT TO IS:280-73

| | | |
|--------------------------------|-----------|---------------------------------------|
| 00720-ICV
V-Rama
31-8-99 | Ⓐ
Gv-m | EQ. MATERIAL ADDED
IN THE DRAWING. |
| DC(I)No.
& DATE | ISSUE | AMENDMENTS |

APPROVED
CHECKED *[Signature]*
CONTROLLERATE
OF
QUALITY ASSURANCE
(ICV)

765-94-783

BUCKLE

WEIGHT SCALE

0.001 2:1

SHT SHTS

WIRE KO 2.0, GOST 792-67

765-94-Sb276

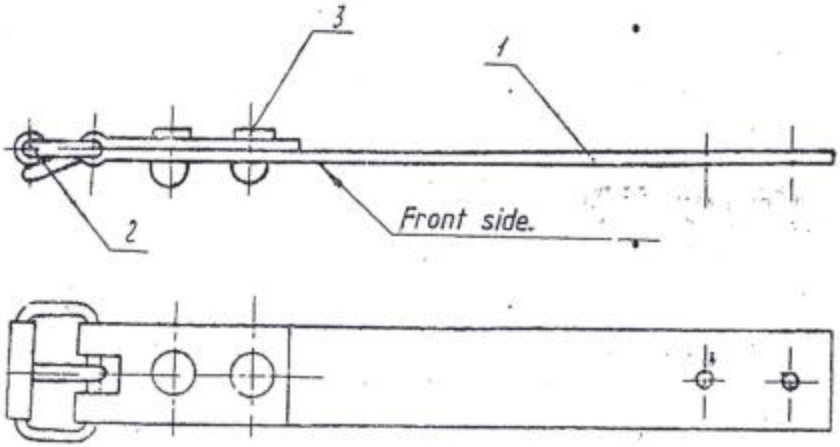

| REF NO | DESIGNATION. | DESCRIPTION. | QTY | REMARKS. |
|--------|--------------|--|-----|-----------------------------|
| 3 | | Rivet-kholniten, steel, nickle-plated. | 2 | |
| 2 | | STAINLESS Steel buckle, zinc-plated. | 1 | Without drawing commercial. |
| | Gr. AISI-316 | | | Ref. DC(I) 01130-ICV |
| 1 | 701-77-13 | Belt | 1 | |

01013-ICV (A) DS CAT PT No. ADDED AND DESCRIPTION 'STRIP LEATHER' WAS 'BELT'
 19-01-06
 DCT No. & DATE ISSUE AMENDMENTS

APPROVED
 CHECKED *MLB*

(A) DS CAT PART NO: 5340-017087
765-94-Sb276

CONTROLLERATE OF QUALITY ASSURANCE (ICV)

(A) **BELT STRAP LEATHER**

| WEIGHT | SCALE |
|--------|--------|
| 0.013 | 1:1 |
| SHT 1 | SHTS 1 |

| FORMAT | ZONE | REF. NO. | DESIGNATION. | DESCRIPTION. | QTY | REMARKS |
|--------|------|----------|--------------------------------------|--------------------------|-----|---|
| | | | | <u>Technical papers.</u> | | |
| 12 | | | 765-94-c8301c8 | Assembly drawing | | |
| | | | | <u>Parts.</u> | | |
| 11 | 1 | | 700-10-c8446 | Strap-assembly | | 1 Piece may
be replaced
by Ref.No.1 |
| | 2 | | | | | |
| 11 | 3 | | 701-267-162 | Strap | 1 | |
| 11 | 4 | | 765-94-768 | Strap | | 1 Piece may
be replaced
by Ref.No.1 |
| | | | | <u>Other items</u> | | |
| | 5 | | Ⓢ Zinc-plated, steel | | | |
| | | | STAINLESS STEEL buckle | | 1 | Commercial |
| | | | Gr. AISI-316 11-10-08 | | | |
| | | | OCT 17-602-81 | | | Ref. DC(t)
01130-ICV |
| | 7 | | Ⓢ BUTTON TYPE Rivet-kholmiten, steel | | 3 | REF Dd2720
01002-ICV |
| | | | nickel-plated 3x25 | | | |
| | | | OCT 17-600-76 B1 | | | |

| | | | | |
|--|--------------------------------|---------------------|----------------------|-----------|
| APPROVED | | 765-94-c8301 | DS CAT PART NO. | |
| CHECKED | | | LV 2/ICV 5540-017078 | |
| CONTROLLERATE
OF
INSPECTION
(ICV) | BELT Ⓢ
STRAP WEBBING | WEIGHT | SCALE | |
| | | SHT 1 SHTS 4 | | |
| | | 94 | | 92 OF 289 |

| FORMAT | ZONE | REF. NO. | DESIGNATION. | DESCRIPTION. | QTY | REMARKS |
|--------|------|----------|---|-------------------------------|-----|---------|
| | | | | <u>Materials.</u> | | |
| | | 8 | | Belt tape /PT 25x3,1 | | |
| | | | | Grade I, GOST 16996-71 | 1 | |
| | | | | l=270 MM | | |
| | | | | <u>Gde</u> | | |
| | | | | <u>Bakelite Varnish</u> JBC-1 | | |
| | | | | GOST 901-78 | | |
| | | | <u>Variable data for modifications.</u> | | | |
| | | | | 765-94-cδ301-01 | | |
| | | | | <u>Materials</u> | | |
| | | 8 | | Belt tape /PT 25x3.1 | | |
| | | | | grade I, GOST 16996-71 | | |
| | | | | l=230 mm | 1 | |
| | | | | 765-94-cδ301-02. | | |
| | | | | <u>Materials</u> | | |
| | | | | Belt tape /PT-25x3,1 | | |
| | | | | grade I, GOST 16996-71. | | |
| | | | | l=210 mm | 1 | |

| | | | | |
|---|--|----------------------------------|---------------------------------------|--------|
| APPROVED | | 765-94-cδ 301 | DSCAT PART NO.
LV2/ICV 5340-017078 | |
| CHECKED | | | WEIGHT | SCALE |
| CONTROLLERATE
OF
INSPECTION
(IC V) | | BELT
STRAP WEBBING | SHT 2 | SHTS 4 |
| | | | 94 | 61 |

| FORMAT | ZONE | REF. NO. | DESIGNATION. | DESCRIPTION. | QTY | REMARKS |
|--------|------|----------|--------------|---|-----|---------|
| | | | | <u>765-94-cδ301-03</u> | | |
| | | | | <u>Materials</u> | | |
| | | 8 | | Belt tape LPT 25x3,1
grade I, GOST 16996-71
l=270 mm | 1 | |
| | | | | <u>765-94-cδ301-04</u> | | |
| | | | | <u>Materials.</u> | | |
| | | 8 | | Belt tape LPT 25x3,1
grade I, GOST 16996-71
l=480 mm. | 1 | |
| | | | | <u>765-94-cδ301-05</u> | | |
| | | | | <u>Parts.</u> | | |
| 11 | | 9 | J 765-94-648 | Cover plate. | 1 | |

| | | | | |
|--|--|--------------------------------------|--|--------|
| APPROVED | | 765-94-cδ301 | DSCAT PART NO:
LV2/ICV
5340-017078 (A) | |
| CHECKED | | | WEIGHT | SCALE |
| CONTROLLERATE
OF
INSPECTION
(ICV) | | BELT (A)
STRAP WEBBING | SHT 3 | SHTS 4 |
| | | | | 62 |

| FORMAT | ZONE | REF. NO. | DESIGNATION. | DESCRIPTION. | QTY | REMARK |
|--------|------|----------|--------------|---|-----|--------|
| | | | | <u>Materials.</u> | | |
| | | 8 | | Belt tape LPT25x3,1
grade I GOST 16996-71
l=200 mm | 1 | |
| | | 10 | | Glossy cotton threads
N1 black GOST 6309-80

765-94-C5301-06 | | |
| | | | | MATERIALS | | |
| | | 8 | | BELT TAPE
LPT 25X3.1, GRADE I
GOST 16996-71, L: 155mm | 1 | |

| | | | | |
|--|--|--------------------------------|---|--------------|
| APPROVED | | 765-94-C5301 | DS CAT PART NO.
Lv2/icv 5340-017078
Ⓐ | |
| CHECKED | | | WEIGHT | SCALE |
| CONTROLLERATE
OF
INSPECTION
(ICV) | | BELT Ⓐ
STRAP WEBBNG | | SHT 4 SHTS 4 |
| | | | | 94 95 OF 289 |

| Format | Zone | Ref No. | Designation | Description | Qty | Remarks |
|--------|------|---------|----------------|---|-----|---------|
| | | | | Technical papers | | |
| 12 | | | 765-94-cb303CB | Assembly drawing | | |
| | | | | <u>Parts</u> | | |
| 11 | 1 | | 765-94-82 | Cover plate | 1 | |
| | 2 | | | | | |
| 11 | 3 | | 701-267-161 | End-piece | 1 | |
| | | | | <u>Other items</u> | | |
| | 4 | | | Rivet-kholuiten, steel,
nickle-plated. | 2 | |
| | | | | <u>Materials</u> | | |
| | 5 | | | Belt tape ЛPT25x3,1
grade I GOST
16996-71, $\ell=260$ | 1 | |
| | 6 | | | Glossy cotton threads
N1 black GOST6309-80 | | |

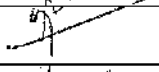
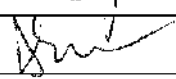
APPROVED 
CHECKED 
CONTROLLERATE
OF
QUALITY ASSURANCE
(ICV)

765-94-Sb303

BELT

| | WEIGHT | SCALE |
|-------|--------|--------|
| SHT 1 | | SHTS 3 |

| Format | Zone | Ref No. | Designation | Description | Qty | Remarks |
|--------|------|---------|--|---|-----|--------------------------|
| | | | | Bakelite varnish | | |
| | | | | ЛБс-1 | | |
| | | | | GOST 901-78 | | |
| | | | <u>VARIABLE DATA FOR MODIFICATIONS</u> | | | |
| | | | | <u>765-94-cb303-01</u> | | |
| | | | | DB CAT NO: LV21CVS 5340-135192
STRAP LEATHER | | REF DCU NO:
01023-1CV |
| | | | | <u>Materials</u> | | |
| | | 5 | | Belt tape | | |
| | | | | ЛPT25x3.1 grade I | | |
| | | | | GOST 16996-71 $\ell=435\text{MM}$ | 1 | |
| | | | | <u>765-94-cb303-02</u> | | |
| | | | | DB CAT NO: LV21CVS 5340-017084
STRAP LEATHER | | REF DCU NO:
01023-1CV |
| | | | | <u>Materials</u> | | |
| | | 5 | | Belt tape ЛPT25x | | |
| | | | | 3.1, grade I GOST | | |
| | | | | 16996-71, $\ell=340\text{MM}$ | 1 | |

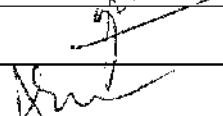
APPROVED
 CHECKED 
 CONTROLLERATE
 OF
 QUALITY ASSURANCE
 (ICV)

765-94-Sb303

BELT

| | WEIGHT | SCALE |
|-------|--------|-------|
| SHT 2 | SHTS 3 | |