

DETAIL 3-C TO BE FIRMLY
SWAGED IN POSITION.

PACKING :- EACH HOUSING SUB ASSEMBLY ATTACHED WITH A

3

LABEL SHOWING NOMENCLATURE OF STORE, YEAR OF MANUFACTURE, TRADE NAME, ADDRESS AND INSPECTOR'S STAMP SHALL BE KEPT IN A POLYTHENE BAG OF SUITABLE SIZE OF 150 GAUGE OR AN APPROVED GAUGE. THE OPEN END OF THE BAG SHALL THEN BE ELECTRICALLY HEAT SEALED. 4 Nos OF SUCH BAGS SHALL BE KEPT IN A CARTON OF SUITABLE SIZE OF APPROVED QUALITY. EACH CARTON SHALL THEN BE IDENTIFIED BY A LABEL OVER IT SHOWING NOMENCLATURE, TRADE MARK/INITIAL OF THE MANUFACTURER, YEAR OF MANUFACTURE, QTY. IN THE CARTON. 10 CARTONS SHALL THEN BE PACKED IN A C.W.P. OF SUITABLE SIZE OF APPROVED QUALITY.

BEFORE DESPATCH EACH PACKING CASE SHALL BE LEGIBLY AND INDELIBLY MARKED WITH THE FOLLOWING DETAILS:-

- NOMENCLATURE, CAT.No. AND YEAR OF MANUFACTURE OF THE STORE.
- TOTAL No. OF PACKING CASES AND No. OF INDIVIDUAL PACKING CASE IN A CONSIGNMENT.
- MASS OF THE PACKING CASE IN KG.
- ADDRESS OF THE CONSIGNEE.
- ADDRESS OF THE CONSIGNER.

DETAIL INDEX

DETAIL No.	SHEET No.	NOMENCLATURE	No. OFF
3	5	HOUSING, SUB-ASSEMBLY	1
3-A	6	WIRE WOVEN HOUSING.	1
3-B	7	SLEEVE	2
3-C	8	FERRULE	2

COUNTERSIGNED LT. COL. DIR. DIR. ADRDE, AGRA.	DATE	NAME
	DGN	
	DRN	(BAGWAN)
	CHD	31.75
	TRD	Lee Jammie
	COMP	22.876
	AD/DD	8.6.5
	PRO OFFR	31.75
SCALE 2:1		

27L/3502 DROGUE WITHDRAWAL LINE
(HOUSING, SUB-ASSEMBLY)

DIMENSIONS IN MILLIMETRES

APPROVED

LT. COL.
DIR. DIR.

PROV

DBS No. ADRDE/7663A2

3-A

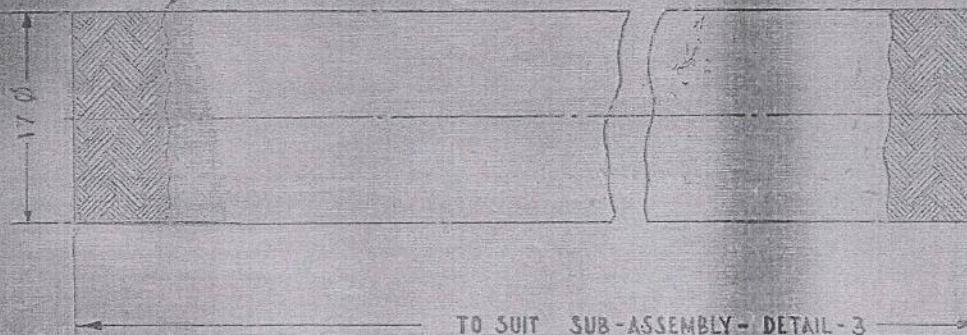
6X6 CONSTRUCTION, 0.234 mm ϕ WIRE.MATERIAL:-

STAINLESS STEEL WIRE TO SPECN IS: 6528-1972,
GRADE 04, Cr-18, Ni-10 IN ANNEALED CONDITION.

WORKMANSHIP & FINISH:-

TO BE SMOOTHLY FINISHED AND POLISHED
BRIGHT, AND THE WEAVING SHOULD BE TIGHT.

TOLERANCES:-

± 0.4 mm. UNLESS OTHERWISE SPECIFIED.

WIRE WOVEN HOUSING

1-OFF

COUNTERSIGNED

[Signature]
Lt. Col.
DIRECTOR,
AD/DE, AGRA.

	DATE	NAME
DGN		
DRN		
CHD	3-4-75	
TRD		
COMP	22-8-77	
AD/DO		
PRO. OFFR	2/11/77	

SCALE: 2:1

27L/3502 DROGUE WITHDRAWAL LINE
(HOUSING, SUB-ASSEMBLY)

DIMENSIONS IN MILLIMETRES

APPROVED

BY: DIR

PROV.

DRG No. AD/DE/7865A-21

Date: 17/

(3-B)

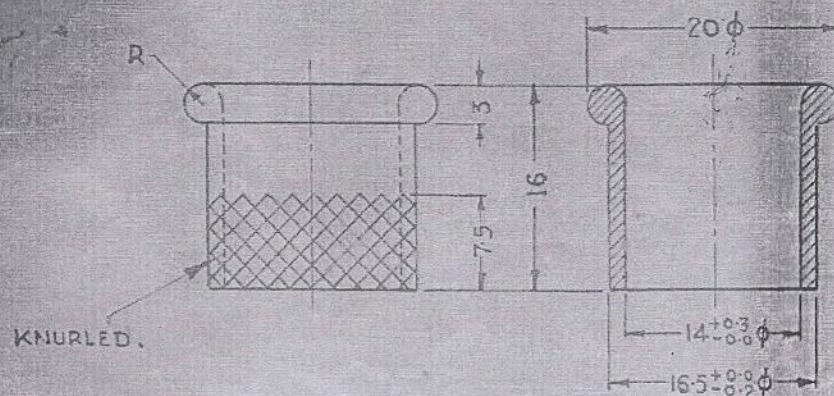

SLEEVE
2-OFF

MATERIAL :- STAINLESS STEEL TO SPECN.
IS: 680-1972 GRADE 02, Cr-18, Ni-11

HARDNESS :- 220 TO 240 V.P.N.

WORKMANSHIP & FINISH :- TO BE
SMOOTHLY FINISHED & POLISHED BRIGHT

TOLERANCES :- ± 0.4 mm UNLESS
OTHERWISE SPECIFIED.

COUNTERSIGNED, <i>[Signature]</i> Lt Col DIRECTOR, ADRDE, AGRA	DATE	NAME	27L/3502 DROGUE WITHDRAWAL LINE (HOUSING, SUB-ASSEMBLY)	THIRD-ANGLE PROJECTION
	DGN			DIMENSIONS IN MILLIMETRES
	DRN	<i>[Signature]</i>		APPROVED
	CHD	<i>[Signature]</i>		<i>[Signature]</i> DY. DIR
	TRD	<i>[Signature]</i>		PROV
	COMP	<i>[Signature]</i>		CRG-NGADRDE/786-AN-2
	AD/DO	<i>[Signature]</i>		
PRO OFFR				
SCALE: 2:1				

Do/07/77

3-C

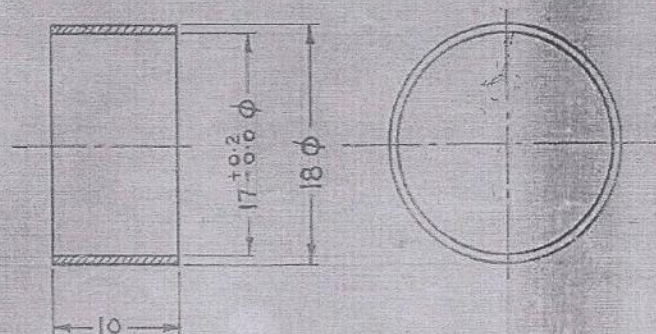

FERRULE
2-OFF

MATERIAL:- STAINLESS STEEL TO SPECN.
IS: 6603-1972, GRADE 02, Cr. 18, Ni-11

HARDNESS:- 220 TO 240 V.P.N.

WORKMANSHIP AND FINISH:- ONLY
OUTER SURFACE TO BE SMOOTHLY FINISHED
AND POLISHED BRIGHT.

TOLERANCES:- ± 0.4 mm UNLESS
OTHERWISE SPECIFIED.

COUNTERSIGNED.	DATE	NAME
DGN		
DRN		
CHD		
TRD		
COMP		
AD/DO		
PRO. OFFR		

LT. COL.

offe
DIRECTOR,
ADRD, AGRA

27L/3502 DROGUE WITHDRAWAL LINE
(HOUSING, SUB-ASSEMBLY)

SCALE: 2:1

THIRD-ANGLE PROJECTION

DIMENSIONS IN MILLIMETRES

APPROVED.

LT. COL.
DY. DIR.

PROV.

DGN No. ADRD/7885A-2

DO/19/77