

BLANK DRAWING

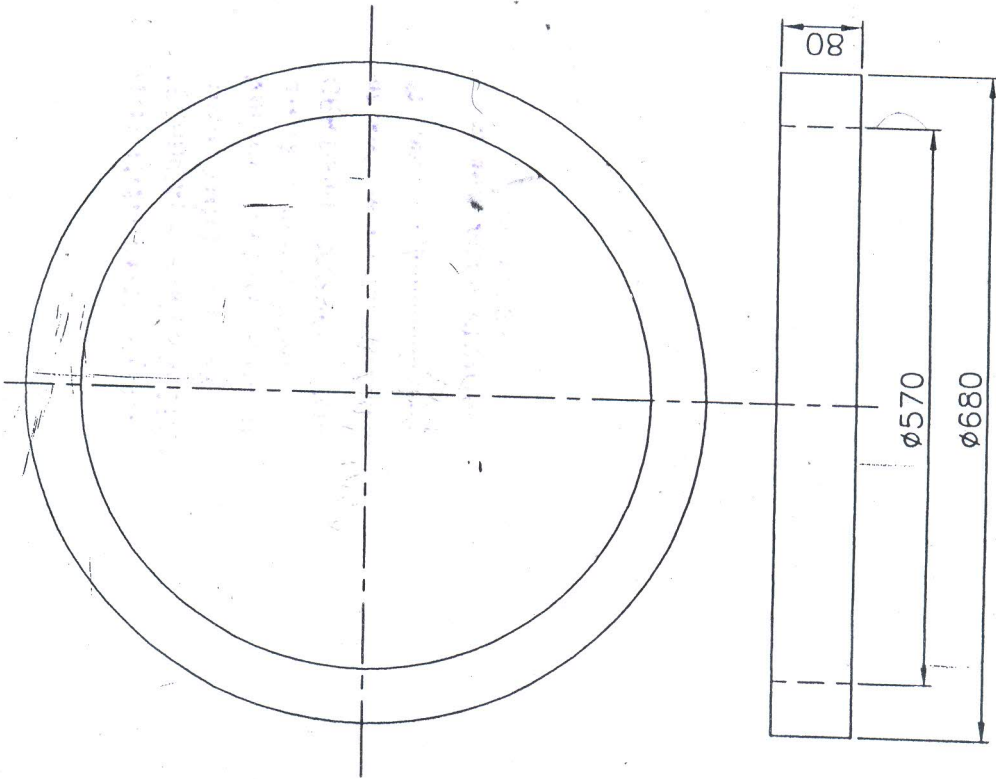

NOTE:

1. STEEL - SAND CASTING.
2. UNSPECIFIED LIMIT DEVIATIONS ARE AS PER IS: 1:166.
3. DRAFT - 2° MAX.
4. ALL DIMENSIONS ARE IN mm.
5. BLOW HOLES ARE NOT ALLOWED.

ⓑ -6- MATERIAL :

STEEL CASTING TO IS: ~~2644-79~~, GRADE-3, CS 840

ⓑ 7- ALTERNATE MATERIAL :

STEEL BS: 970 Gr. 817 M40 (EN24)

ⓑ 8. FOLLOWING PHYSICAL PROPERTIES ADDED.

a) TENSILE STRENGTH: 102 kg/mm² (MIN)

BLANK SIZE: $\phi 680 \times 570 \times 80$ mm THK

b) ELONGATION : 11% (min)

c) HARDNESS : 250 - 310 BHN.

15/10

QTY./VEH 01
USED ON 645-01-7307-1

16/7/20 APPROVED 19/8/20 15/10	ⓑ	6. DELETED. 7. MATERIAL WAS ALTERNATE MATERIAL 8. TECH. NOTE ADDED.	IN TECH. NOTE ADDED. USED ON COLUMN AMENDED. MATERIAL COLUMN AMENDED. DWG. AMENDED TO 11RD ANGLE PROJECTION.	NATURE OF AMENDMENT
Ⓐ				
ISSUE	APPROD.			
APRD. SKV				
CHKD. MVL				
DRWN. D.V.R.				
NAME	SIGN	DATE		
DRG. NO: 645-01-7311+2/AB				
BLANK, UPPER RACE RING (CASTING DRAWING)				
ORDNANCE FACTORY MEDAK				
MATERIAL:				
11rd: ANGLE PROJECTION				
SHEET NO SCALE WEIGHT				

PROPRIETARY INFORMATION CONTAINED IN THIS DOCUMENT IS PROPRIETARY TO ORDNANCE FACTORY, MEDAK (OFMK). ANY USE, REPRINTING, ASSIGNMENT OR DISCLOSURE IN WHOLE OR IN PART IS SUBJECT TO THE PRIOR WRITTEN CONSENT OF THE GENERAL MANAGER, ORDNANCE FACTORY, MEDAK.
DATE: 22/08/07 D.G.HGS