

GEN. TOL. FINE / MEDIUM / COARSE CLASS TO IS:2102
 DRG. CONVENTIONS CONFIRM TO INDIAN STD. DIMM. IN mm UNLESS OTHERWISE STATED

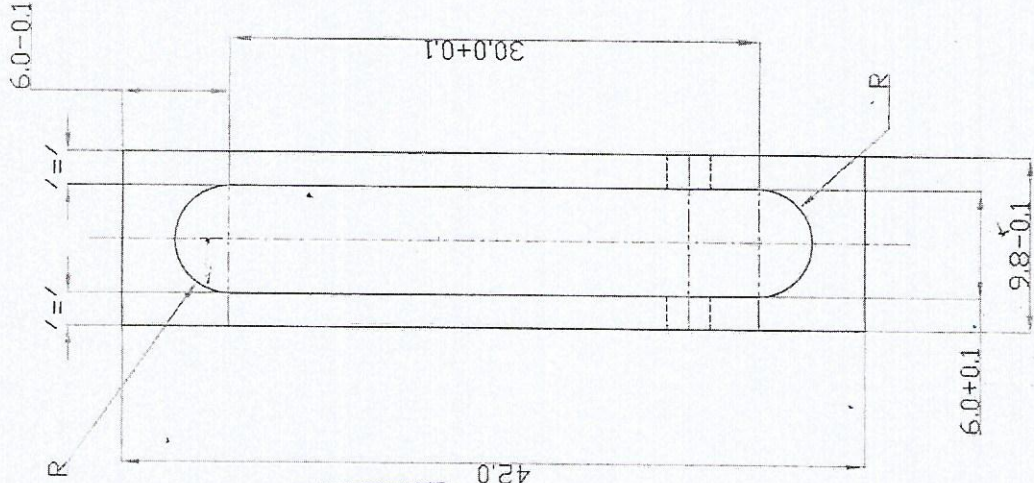

NOTES: 1) REMOVE ALL SHARP EDGES AND BURRS
 2) HARDNESS : 250-300 HV
 3) ALT. MATERIAL :

MIM ST (AISI EQUIVALENT)
 (3.0) HARDNESS : 500-600HV

आरेखण की सही प्रमाणित प्रतिलिपि दिनांक...
 Certified as correct copy of drg. on.....
 Jr. Works Manager
 STANDARD CELL

Latest drg as on 10/12/15
[Signature]

4	14/7/15	M-27	ALT. MATERIAL ADDED	A-10/11
3	10/4/14	M-22	DRG. REVISED	
2	7/3/14	M-21	DMR 1.3-0.1 WAS DMN 1.3 DMN 32.0±0.1 WAS 32.0±0.05	G-3 G-5
1	08/08/2011	M-18	DMN 27.0±0.1 WAS 27.0±0.1 DMN 30.0±0.05 ADDED DMN 32.0±0.05 ADDED NEW APPROVED DIMENSIONALITY	G-3 G-5
ST. No.	DATE	AUTHORITY	BRIEF RECORD	ZONE
DRN. KSD	04-10-15	<i>[Signature]</i>		CD
APPR. DATE	14/7/15			GD
SEALED DATE				SGN
SCALE	5:1	EST. MMS	MATERIAL:	
DESIGN AUTHORITY			STEEL TO IS: 5517-1993, Gd-4008 (En-8)	
ARDE PUNE-411021			PROTECTIVE FINISH: PHOSPHATED TO SPECN IS:3618-1966, CLASS 'B'	
DRG. No.	012014	03	02	118
PART No.	IC	SS	S	AA
				A
				C
				SST
				ASIP

TITLE
 HOUSING LEVER CATCH MAGAZINE

49