

UN CONTROLLED COPY

FILE FINISHED ON P.55Y.

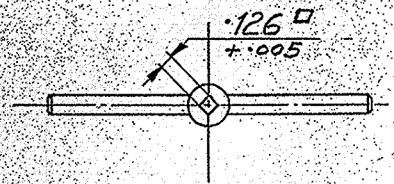

DIMS. ARE IN INCHES

| ITEM No. | DESCRIPTIONS | QTY | MATERIAL | TREATMENT | REMARKS |
|----------|--------------------------------------|-----|------------------------------|-----------|-------------|
| 5 | PIN 3/32 phi D.F. | 1 | BS-970 PL-1-83 080 M40 (ENB) | - | - |
| 4 | WRENCH ADJUSTING LOCK NUT FORE SIGHT | 1 | BS-970 PL-1-83 080 M40 (ENB) | HRD & GRD | 300-350 HV. |
| 3 | ROD 3/16 phi x 1 1/8 LG. | 2 | BS-970 PL-1-83 080 M40 (ENB) | - | - |
| 2 | WRENCH ADJUSTING FORE SIGHT | 1 | BS-970 PL-1-83 080 M40 (ENB) | HRD & GRD | 300-350 HV. |
| 1 | ROD 5/32 phi x 2 3/4 LG. | 1 | BS-970 PL-1-83 080 M40 (ENB) | HRD | 300-350 HV. |

| | | | |
|-----------------|--------------------|---|---------------------------------|
| 3RD PROJN | SIGNATURE & DATE | SUB. WRENCH ADJUSTING | SCALE 1:1 |
| DRAWN | <i>[Signature]</i> | FORE SIGHT & LOCK NUT FORE SIGHT | STORE DRG. NO. |
| CHECKED | <i>[Signature]</i> | FOR RIFLE 7.62 M.M. IAI | OPERATION NO. |
| TRACED | | DRG. No. R.F.1. SK. NO. 1051 (MODIFIED) | |
| TRACING CHECKED | | 1972 APPROVED | |
| AMENDMENTS | SIGNATURE AND DATE | DRAWING OFFICE | ORDNANCE FACTORY TIRUCHIRAPALLI |
| | | | SHEETS 1 SHEET No. 1 |