

THIS DOCUMENT AND THE INFORMATION CONTAINED IN IT ARE PROPRIETARY AND CONFIDENTIAL TO OFT. NO PERSON OR ENTITY IS ALLOWED TO COPY, REPRINT, REPRODUCE OR PUBLISH ANY PART OF THIS DOCUMENT, NOR DISCLOSE ITS CONTENTS TO OTHERS, NOR MAKE ANY USE OF IT, NOR ALLOW OR ASSIST OTHERS TO MAKE ANY USE OF IT UNLESS BY THE PRIOR WRITTEN EXPRESS AUTHORIZATION OF OFT AND THEN ONLY TO THE EXTENT AUTHORIZED. COPYRIGHT-OFT.

SHEET REV STATUS  
ALL SHEETS ARE THE SAME REVISION

REVISION RECORD				
REV	ECO	DESCRIPTION	DATE	APVD
--		Released	08-Oct-18	L. Goldshstein

- NOTES:
- INTERPRET THIS DRAWING IAW ASME Y14.100M.
  - MATERIAL: ALUMINUM ALLOY SHEET 5086-H32 per AMS-QQ-A-250/7 OR 5052-H32 per AMS-QQ-A-250/8 OR EQUIVALENT AFTER ELBIT APPROVAL.
  - GENERAL TOLERANCES ACCORDING TO ISO-2768-c.
  - UNLESS OTHERWISE SPECIFIED, UNDEFINED MACHINED FILLET MAX RADII SHALL BE 0.2.
  - DEBURR AND REMOVE SHARP EDGES, APPROX. 0.2X45 Deg.
  - WELDING:
    - WELDING PER AWS D1.2 GTAW OR GMAW CLASS C USING ELECTRODE ER5356 PER AWS A5.10 OR EQUIVALENT.
    - AFTER WELDING APPLY VISUAL INSPECTION.
  - FINISH:
    - CHROMATIC CONVERSION COATING PER MIL-DTL-5541F, TYPE I, CLASS 3.
    - INSTALL INSERTS PER NASM-33537 USING PRIMER PER MIL-PRF-23377 TYPE I CLASS C2.
  - PAINT:
    - PRIMER: LEAD AND CHROMATE FREE EPOXY PRIMER PER MIL-DTL-53022 THICKNESS: 25-40 MICRONS. OR EQUIVALENT APPROVED BY ELBIT.
    - INTERMEDIATE: APPLY TWO LAYERS OF HIGH SOLID EPOXY POLYAMIDE PER MIL-PRF-22750 TYPE II CLASS H. EACH LAYER 30-50 MICRONS. SEAL WELDED AREA WITH MS SOUDAL 250 OR SIKAFLEX 529.
    - TOP COAT: APPLY TWO LAYERS OF ALIPHATIC POLYURETHANE PER MIL-PRF-85285 OR MIL-C-83286 RAL 9016 MATT. EACH LAYER 30-50 MICRONS.
    - SPECIFIED THREADS AND HOLES MUST BE PROTECTED FROM PAINT.
  - QUALITY ASSURANCE PROVISIONS:
    - QUALITY ASSURANCE PROVISIONS FOR THIS ITEM PER RDMQD00012P.
  - PARENTHETICAL FIGURES ARE FOR REFERENCE ONLY.
  - IDENTIFY PER MIL-STD-130 PARA 4.1.B, BY LABELING ITS CONTAINER WITH THE PART NUMBER. CHARACTERS MINIMUM TEXT HEIGHT 1.25 MM.
  - PACKAGING AND PACKING: THE FINISHED PART SHALL BE PRESERVED AND PACKAGED IN ACCORDANCE WITH MANUFACTURER'S BEST COMMERCIAL PRACTICE.

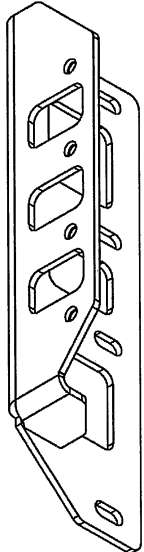
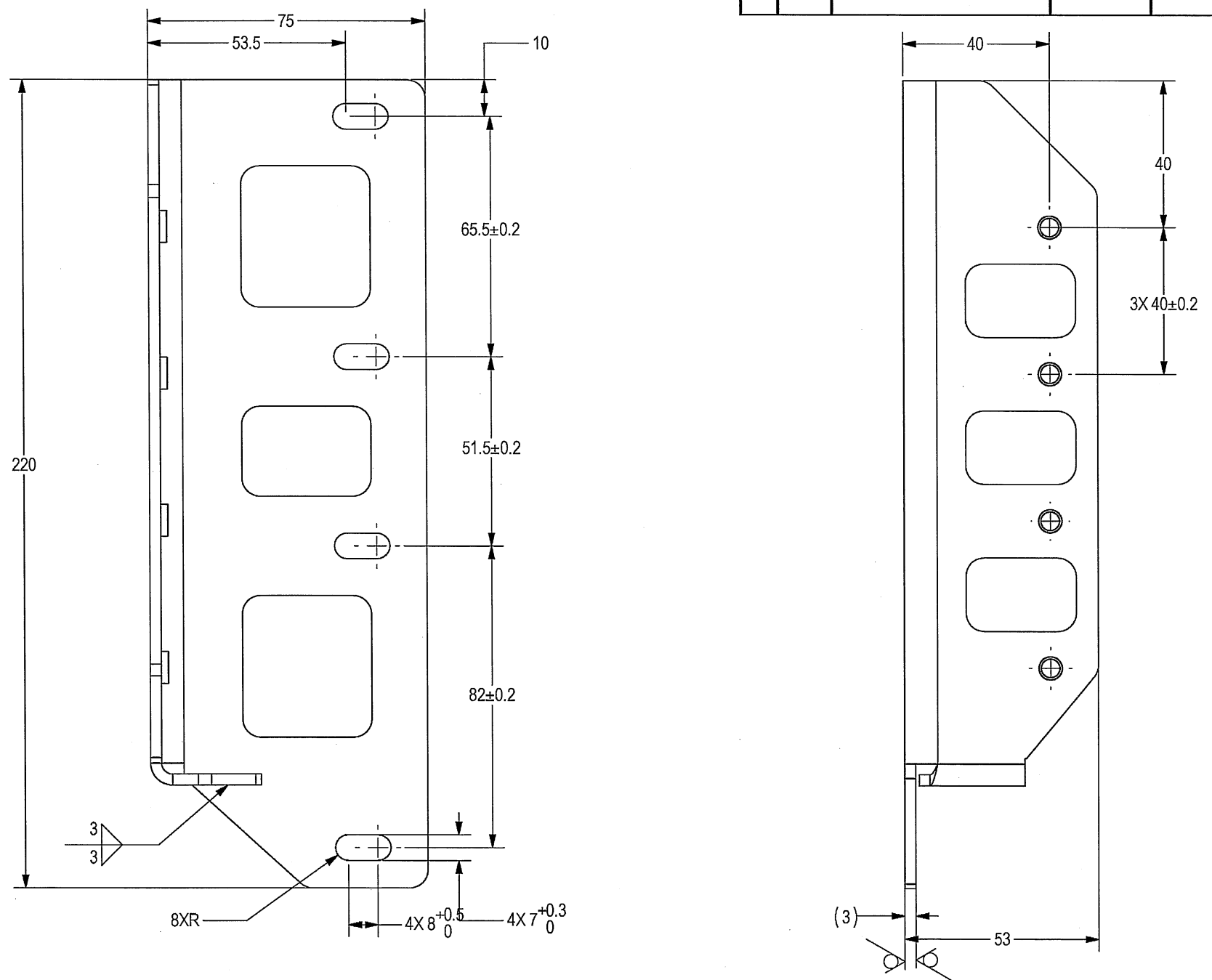

(WEIGHT APPROX.: 0.15 Kg.)

SEE ATTACHED MEDIA  
SEE SEPARATE PARTS LIST

UNLESS OTHERWISE SPECIFIED		SIGNATURE	DATE	ORDNANCE FACTORY TIRUCHIRAPPALLI	
DIMENSIONS ARE IN MM PER ASME Y14.5 - 2009		DRAWN	17/12/18	FOR: MECH. STRUCTURE ASSY	
TOLERANCES		CHECKED		TITLE	
LINEAR	ANGULAR	HOS/DDO		ARM COVER RIGHT	
SEE NOTE 3	SEE NOTE 3	OFFICER/PRODN		SIZE	CAGE CODE
1st ANGLE PROJECTION		OFFICER/QC		C	2291A
SURFACE TEXTURE IN MicroMeter		OFFICER/DDO		SCALE	1:2
				AUTOMATED DRAWING (SW)	Y25686A-00
				SHEET	1 OF 1

DWG NO  
Y25686A-00  
SH  
1

OFT

**ASSEMBLY PARTS LIST**

Assembly Parts List For: Y25686A-00

Rev: -

Status: Released

Description: ARM COVER RIGHT

FN	CMD	PART NUM	ECO	DESCRIPTION	MB	QTY	U/M	REF. DES./REMARKS	MFG. PN / CUSTOMER	LA	LI
1	HM	99986873M		NUT PLAIN CLINCH CRES M5 GRIP	P	4	Each		56384-CLS-M5-1		