

ЕСКА

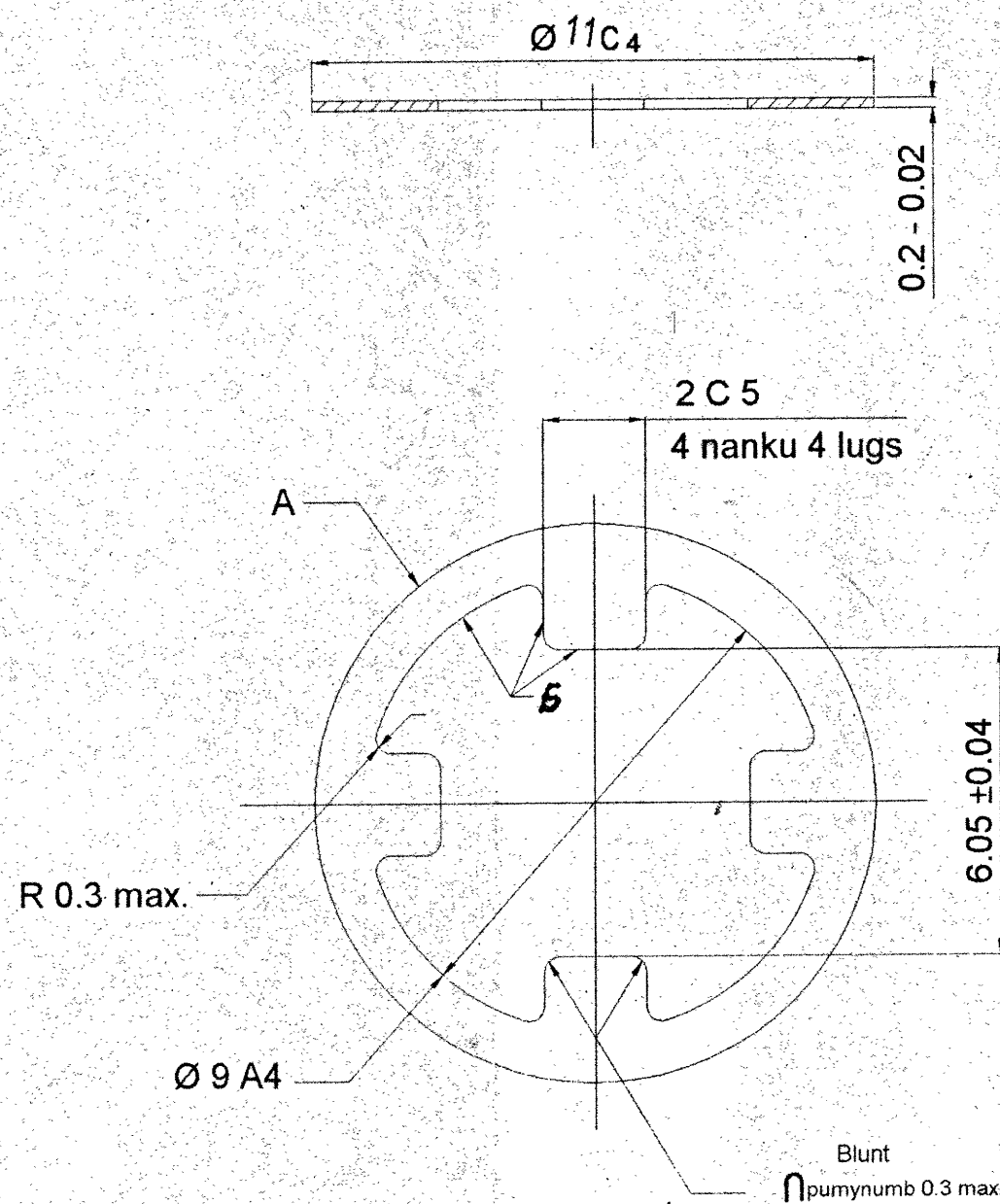

1. Alternative material is 08k II-OM-T-2-O.2 GOST 503-81.
2. * Dimension for reference other dimensions are ensured by tools
3. Perform surface A.6 once clamped only.
4. Coating - Cu3 Sn3
5. The part should be forced through at a load of 7 Kgf and should not at a load of 2.5 Kgf.
6. The following is allowed :
 - a) Presence of burrs on surface A.6 as against the standard sample established by manufacture and agreed with customer representative at manufacturing plant.
 - b) Coating alloy Cu-Zn (70%-30%) 3 μ Sn3 or Sn6 Chromatized:
 - c) Perform coating of bands
7. Other requirements are as per OST B 84-264-81
8. **INDIGENOUS MATL :-**
IS : 513 - 2008 GR CR 3 OR Gd ICS OF BS 1449 SECTION 1.1 .1991

| | | | | |
|----------------------------------------------|-----------------------------------|-------------------------------------------------------------------------------------------------------------------|-------------------------------------|--------------|
| 05-01-2011 | DGQA S O Sec I Chap 10 para 40 | Drg. scan, clean & edit without change & m/c replaced in supression of existing dilapidated copy of same No | | |
| 08-11-2010 | DC 3721-A | INDIGENOUS MATL. ADDED AS Note No. 8 | | |
| 24-09-87 | DCI. 34241-A | DRG. PROV. SEALED. | | |
| DATE | AUTHORITY | REVISION | SIG. AHSP | SIG. D.O. |
| APPROVED <i>[Signature]</i> FOR CQA(A) | | 3-0105875 | A3-BE-032h | |
| | | bw 8.363.012 | | |
| AHSP:- CQA(A) KIRKEE | | | SHEET | WEIGHT |
| SNC SH DOC No. | SIGN | DATE | A | 0.06r |
| DRAWN | | | | NTS |
| EDT.CHKD | | | TOTAL SHEETS | |
| F/M, DC | | | ORDANCE FACTORY | |
| D.V.OFFR | | | PROJECT | |
| | NAME | SIGN | HYDERABAD | |
| | | DATE | Band 08kII-T-1-0-2 GOST 503 - 81 | |