

DIMENSIONS ARE IN MM.  
 UNTOLERATED DIMENSIONS AS PER IS: 2102 (MED)

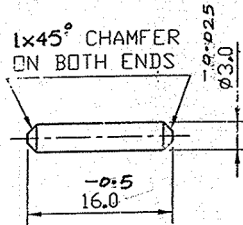

NOTE - FOR TRADE PROCUREMENT 10-15 NOS. OF SAMPLES MUST BE APPROVED BEFORE BULK SUPPLY TO ACHIEVE BARREL SUB-ASSY.

FINISH: PHOSPHATE TO SPECN. WPN/GEN/3  
 CLASS II

PART NO.	DESCRIPTIONS	NO OFF	MATERIAL	HRD & TEMP	TREATMENT	REMARKS
			BS 970 EN 8		350-400 HV	
	SIGNATURE & DATE: TRACED: DRAWN: <i>Jig</i> CHECKED: <i>Jayaram</i> OIC/D&DO: <i>V. Valluraj</i> OFFICER/PRODN.: OFFICER/D&DO:		SUB: <i>DIV. FIXING BAND</i> BACK SIGHT FOR: <i>.315" SPORTING RIFLE</i> OF: DES. REF. NO. <i>SP-6</i> DRG. No.: <i>29 P. 0006</i>			SCALE: <i>2:1</i> STORE DRG. NO. OPERATION NO.
AMENDS	<i>5194 DT</i>	APPRD. ON:	ORDNANCE FACTORY TIRUCHIRAPPALLI - 16			SHEETS: 01 SHEET No. 01