

M7X.75 PITCH-6H
 8-START - L.H.
 (LEAD=6.0)
 MAJOR ϕ = 7.00
 PITCH ϕ = 6.512^{+0.132}
 MINOR ϕ = 6.188^{+0.190}

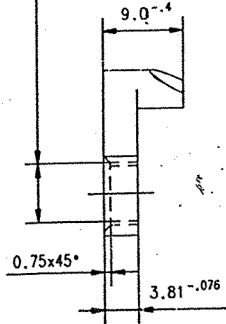

ALTERNATIVE THREAD
 ϕ 6.909 X 6.350 LEAD
 8 START L.H. ENFIELD STD.

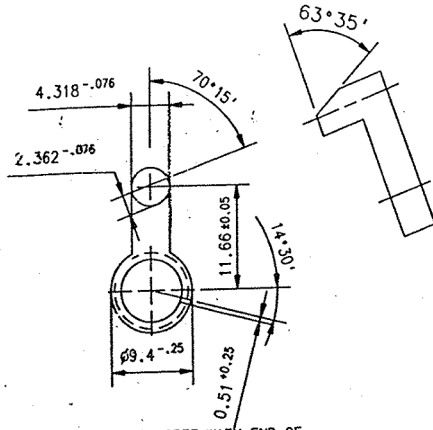

THIS LINE TO AGREE WITH END OF LOCKING BOLT WHEN ASSEMBLED

- 10 NOS. OF SAMPLES TO BE SUBMITTED BY THE SUPPLIER/MANUFACTURER FOR FITMENT AND FUNCTIONAL TEST BEFORE BULK SUPPLY.
- ALL SHARP EDGES TO BE REMOVED.

① - ALT. MATL. FOR MIM ROUTE ONLY.
 MATL. SPECN.: MIM 4650.

C - 0.3 TO 0.6 Si - 0.5 MAX.
 Ni - 1.5 TO 2.5 Mn - 0.3 MAX.
 Cr - 0.5 MAX. P - 0.03 MAX.
 Mo - 0.5 MAX. Fe - BALANCE.

NOTE :- HARDENED AND TEMPERED GENERALLY STEM PORTION TO GIVE A H.V. 400-500
 FINISH :- PHOSPHATE TO SPECN. JSS.0465 01:1988 CLASS-1, PAINT KFU STOVING BLACK TO SPECN. JSS.8010-37 MATT FINISH.

MATL. STEEL B.S.970 PT.1:1983
 Gr. 070 M-55

DIMENSIONS ARE IN mm.
 UNTOLERATED DIMNS. AS PER IS : 2102 (MFD)
 IMPORTANT DIMNS. MARKED THUS

MARK DRAWING No.

8996/14/08 DDO/01 24.5.09	6084
8996/14/1 DDO/04 DT. 1.04.08	
AMENDMENTS	SIGNATURE & DATE

ITEM NO.	DESCRIPTIONS	NO OFF	MATERIAL	TREATMENT	REMARKS
1		1	AS ABOVE		
	SIGNATURE & DATE	SUB: CATCH SAFETY.			SCALE NTS
TRACED	<i>[Signature]</i>	FOR: <i>[Signature]</i>			STORE DRG.NO.
DRAWN		OF: 0.315" SPORTING RIFLE			
CHECKED	<i>[Signature]</i>	DES. REF. NO. SP-46			OPERATION NO.
TOIC / DDO	V. Valuradhu	DRG. NO. 29 P 0046 2			
OFFICER PRODN.					
OFFICER D&DO					
APPROVED ON. 11/04.		DIV. OFFICER			SHEETS: 1
		ORDNANCE FACTORY TIRUCHIRAPPALLI-16.			SHEET NO. 1