

261 X 0

DRG. CONVENTIONS CONFORM TO IS 696

DIMNS ARE IN mm

D.C.I 11243-A, 6-U.A.

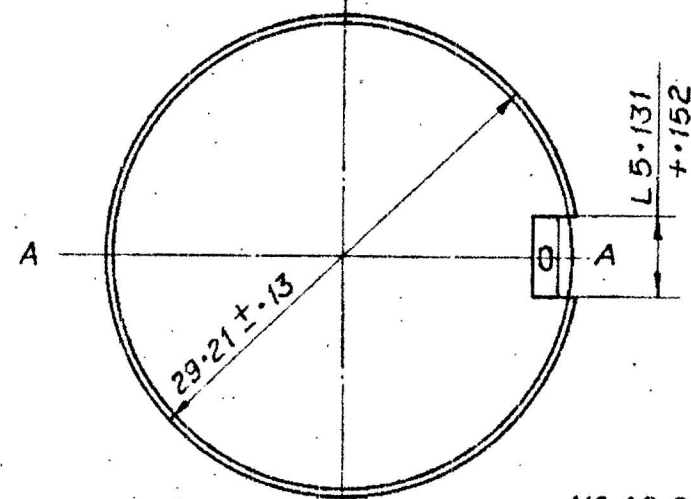

№ 40 DRILL (2.489) DIA. HOLE FOR RIVET.

HOLE TO BE CENTRAL WITHIN ± .13

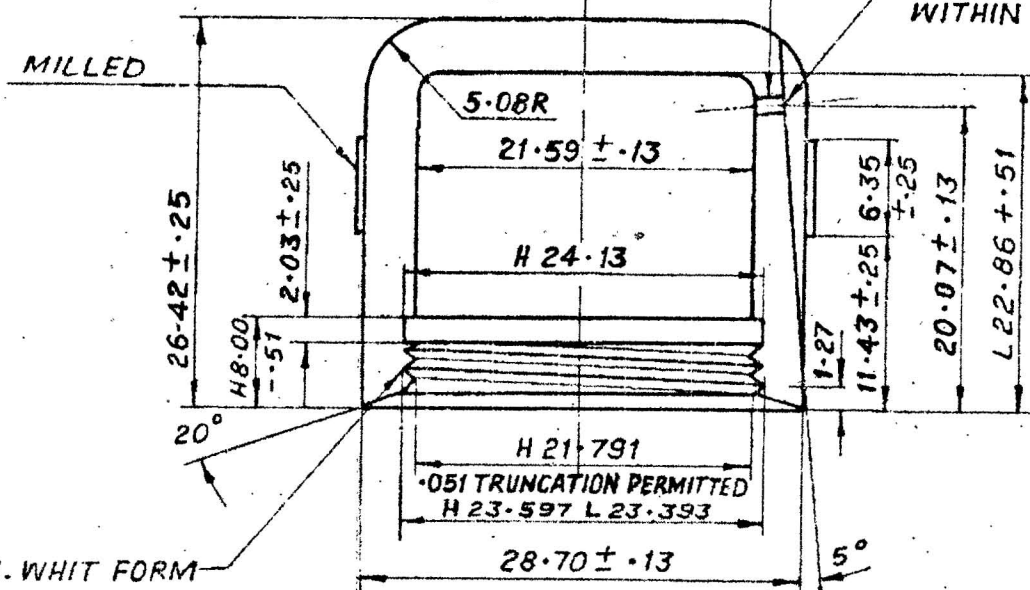

18 T P 25.4 R.H. WHIT FORM

SECTION A-A

NOTE:-

TOL. ON UNTOL. DIMNS. FOR ONE DECIMAL PLACE ± 1.3 FOR TWO OR MORE DECIMAL PLACES ± .13

MATERIAL:-

STEEL, BS 970: PART 1: 1972 1983
~~GRADE 215 M 18 COLD DRAWN~~
 OR GRADE 220 M 07 COLD DRAWN.
 OR GRADE 070 M 20 COLD DRAWN

PROTECTIVE FINISH:-

THE SAFETY CAP MANUFACTURED OF STEEL SHALL BE PHOSPHATED TO SPECIFICATION CLASS II WITH A SUPPLEMENTARY FINISH OF BLACK PAINT READY MIXED, QUICK DRYING, SEMIGLOSSY OR MATT FINISH TO SPECIFICATION IS 168 AS PER PARA 13 (a) *JSS 0465-01:1994 REV No 1

UNDERCUT MAY BE OMITTED IF DESIRED LENGTH OF FULL THREAD NOT TO BE LESS THAN 6.35

R No	DATE	AUTHORITY	REVISION	AHSP	D D	SIGN
20-5-86		D.C.I. 33942-A	UNDER COLUMN PROTECTIVE FINISH SPECIFICATION ADDED.			
8-10-85		D.C.I. 33833-A	MATE SPECN. YEAR & GRADE AMENDED.			
13-1-84		D.C.I. 33539-A	MATERIAL AMENDED			
17-12-83			RETRACED WITHOUT CHANGE			
			PREVIOUS DCS(I) NOS. - 6-U.A, 582-U.A, 892-U.A, 17793-A, 19973-A, 20685-A, 21823-A, 22051-A, 23417-A, 27364-A, 28104-A, 30146-A, 30721-A AND 31316-A.			

DRG. SEALED :- 23-5-30

DRN	CHD	TCD HDW	COMP
C D MAN	O/C D O.	SCALE:- 2/1	EST MASS. -
APPD.		GAUGE SCHD -	DATE -
FOR C I (A)			
MATT :- AS ABOVE			
PROTECTIVE FINISH :- AS ABOVE			

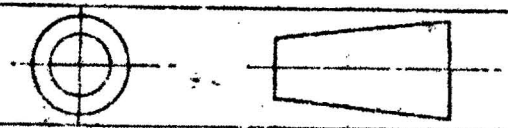

DESIGNER'S REF. F. D. No 894

CAP

PART No
QX 197
 D.S. CAT No 1390-000238
 DESIGN DEPARTMENT (L)
 AHSP :- C.I.(A) KIRKEE

5.7.2000 DC.36685-A IN PRO FINISH SPEC. IS AMENDED.
 27.6.87 DCI.34168-A DS CAT No ADDED.
 7-10-86 D.C.I. 34006-A NOMENCLATURE AMENDED.